

REC'D BY
MMB

MAR 08 2004

**TOWN OF JAMESTOWN,
BLUE EARTH COUNTY, MINNESOTA
CITY OF MADISON LAKE,
COUNTY OF BLUE EARTH, MINNESOTA**

RESOLUTION NO. 2004-223

STATE OF MINNESOTA)
COUNTY OF BLUE EARTH) ss
TOWN OF JAMESTOWN)

JOINT RESOLUTION FOR ORDERLY ANNEXATION

WHEREAS, all the owners, Theodore H. Wolfe, Jr. and Rita L. Wolfe, have petitioned the City of Madison Lake for annexation of the following described real property legally described, to-wit:

All that part of Government Lot 7 in Section 27 Township 109 North Range 25 West, lying southeasterly of the southeasterly line of Shorewood East, according to the plat thereof on file and of record with the Blue Earth County Recorder; All that part of Government Lot 8 in Section 27 Township 109 North Range 25 West, Blue Earth County, Minnesota lying westerly of the East 37.80 acres of said Government Lot 8 and southeasterly and southerly of the southeasterly and southerly line of Shorewood East, according to the plat thereof on file and of record with the Blue Earth County Recorder. The Northwest Quarter of Section 34 Township 109 North Range 25 West, Blue Earth County, Minnesota excepting therefrom Shorewood east, according to the plat thereof on file and of record with the Blue earth County Recorder, lying westerly of the westerly right of way line of County Road No. 187 as described in Book 277 Blue Earth County Records, page 372 and recorded July 25, 1984, and northerly of the northerly right of way line of Blue Earth County State Aid Highway No. 26 as described in Document No. 439CR739 and recorded December 31, 2003.

This said property is unplatted and does not exceed 200 acres in area. The acreage of such area is 158.10 acres, and subject to any and all easements of record.

WHEREAS, the owners wish to obtain sanitary sewer and water services; and,

WHEREAS, the City of Madison Lake has sanitary sewer and water facilities adjacent to said tract; and,

WHEREAS, the Town of Jamestown does not have the ability to provide sanitary sewer and water services to the above tract; and,

WHEREAS, the above tract is adjacent to the City's sanitary sewer and water lines; and,

WHEREAS, the owners intend to improve the premises with the construction of residential and commercial buildings; and

WHEREAS, the area is appropriate for such construction; and,

WHEREAS, the land abuts Blue Earth County State Aid Highway No. 26 and Blue Earth County Highway No. 187 and therefore provides adequate and appropriate transportation for the tract;

WHEREAS, the City is better able to provide government services to the property including sewer and water service, fire rating and protection, law enforcement, street improvements and maintenance, administrative services, and recreational facilities;

WHEREAS, annexation will allow the City to better control the environmental impact of improvement of the properties;

WHEREAS, the Town of Jamestown is less able to provide the above government services to the property.

NOW THEREFORE, THE TOWN BOARD OF THE TOWN OF JAMESTOWN AND THE CITY COUNCIL OF THE CITY OF MADISON LAKE, BLUE EARTH COUNTY, MINNESOTA, DOES HEREBY RESOLVE AS FOLLOWS:

1. That the following described real estate legally described as follows, to-wit:

All that part of Government Lot 7 in Section 27 Township 109 North Range 25 West, lying southeasterly of the southeasterly line of Shorewood East, according to the plat thereof on file and of record with the Blue Earth County Recorder; All that part of Government Lot 8 in Section 27 Township 109 North Range 25 West, Blue Earth County, Minnesota lying westerly of the East 37.80 acres of said Government Lot 8 and southeasterly and southerly of the southeasterly and southerly line of Shorewood East, according to the plat thereof on file and of record with the Blue Earth County Recorder. The Northwest Quarter of Section 34 Township 109 North Range 25 West, Blue Earth County, Minnesota excepting therefrom Shorewood east, according to the plat thereof on file and of record with the Blue earth County Recorder, lying westerly of the westerly right of way line of County Road No. 187 as described in Book 277 Blue Earth County Records, page 372 and recorded July 25, 1984, and northerly of the northerly right of way line of Blue Earth County State Aid Highway No. 26 as described in Document No. 439CR739 and recorded December 31, 2003.

This said property is unplatted and does not exceed 200 acres in area. The acreage of such area is 158.10 acres, and subject to any and all easements of record.

- 2. State Agency Jurisdiction: That upon approval by the respective governing bodies of the Town and the City. This Joint Resolution and Agreement confers jurisdiction upon the Minnesota Municipal Board so as to accomplish the merger and orderly annexation in accordance with the terms of this Joint Resolution and Agreement.
- 3. No Alterations of Boundaries: The Town and the City mutually state that no alterations by the Municipal Board of the boundaries of the area designated herein for merger and orderly annexation is appropriate.
- 4. Review and Comment by State Board: The Town and the City mutually state that this Joint Resolution and Agreement sets forth all the conditions for the merger of the area designated herein for such merger and orderly annexation, and that no consideration by the Municipal Board is necessary. The Municipal Board may review and comment, but must, within thirty (30) days of receipt of this Joint Resolution and Agreement, order merger and orderly annexation in accordance with its terms and conditions.

Adopted by the City Council this 1st day of March, 2004

Steve Bjerke
Steve Bjerke, Mayor Pro Tem

ATTEST:

Debra DeVlaeminck
Debra DeVlaeminck, City Clerk

Adopted by the Jamestown Board of Supervisors this 18 day of Feb, 2004..

Adam Frederick
Adam Frederick, Chair

ATTEST: Miko Bisch

Michael Bisch, Clerk

I, Debra DeVlaeminck, Clerk of the City of Madison Lake, do hereby certify that I have compared the attached copy of Resolution with the original on file in the office of the City Clerk and that it is a true and correct transcript therefrom and the whole of such original.
In Witness Whereof, I have set my hand and affixed the Seal of the City of Madison Lake this 1st day of March, 2004
Debra DeVlaeminck
City Clerk

Wolfe
Property

MAR 08 2004

REC'D BY
MAMB

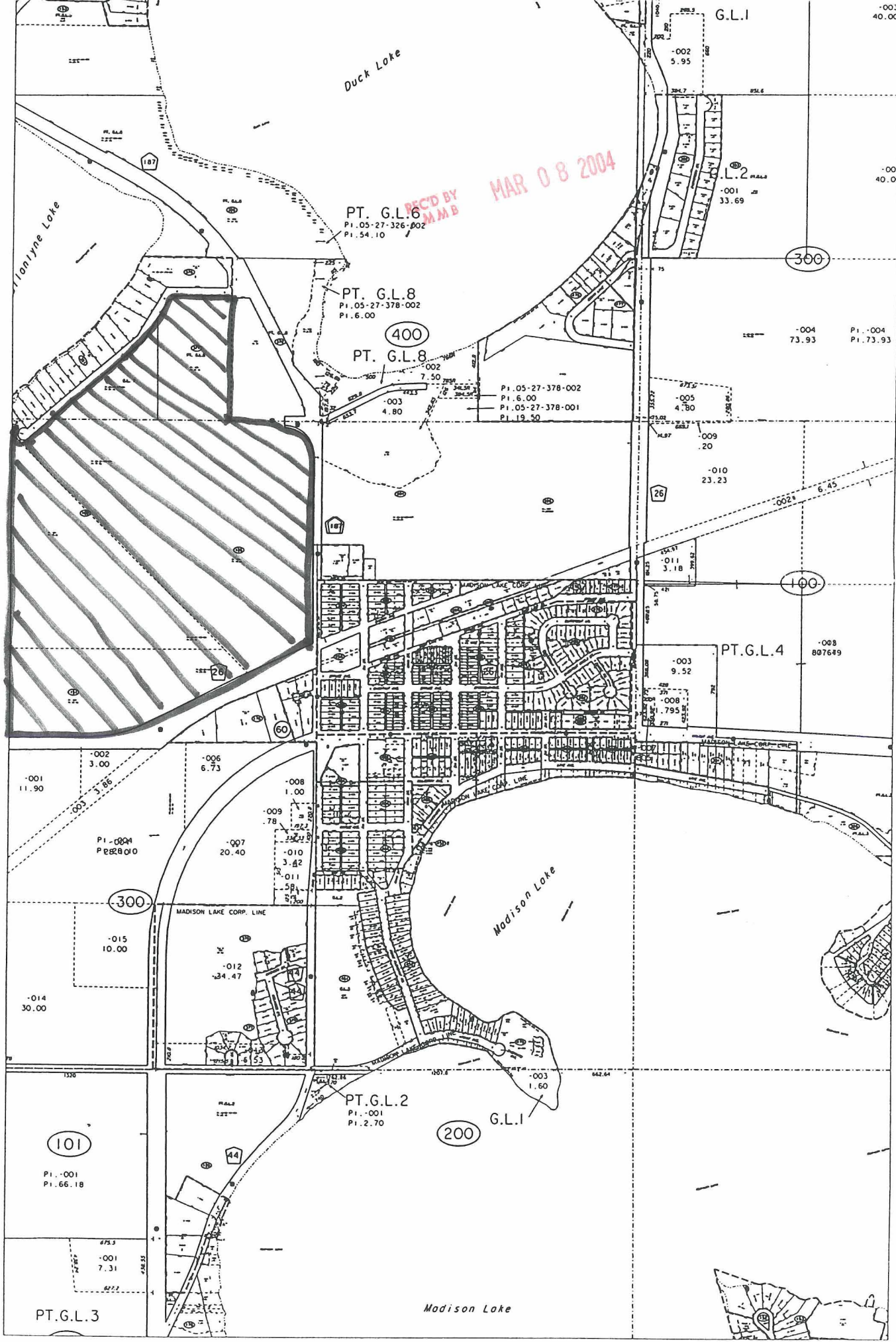

PT. G.L. 6
P1. 05-27-326-002
P1. 54.10

PT. G.L. 8
P1. 05-27-378-002
P1. 6.00

(400)
PT. G.L. 8
P1. 05-27-378-002
P1. 6.00
P1. 05-27-378-001
P1. 19.50

G.L. 1

L. 2

(300)

(100)

PT. G.L. 4

PT. G.L. 2
P1. 001
P1. 2.70

(200)

(101)

PT. G.L. 3

Madison Lake

-003
40.00

-002
40.00

-004
73.93
P1. 004
P1. 73.93

-005
4.80

-009
20

-010
23.23

-011
3.18

-003
9.52

-008
798

-008
807689

-003
3.86

-006
6.73

-007
20.40

-008
1.00

-009
78

-010
3.42

-011
58

-012
34.47

-014
30.00

-015
10.00

-001
11.90

-002
3.00

-001
7.31

-003
1.60

-001
7.31

-001
7.31

-001
7.31