

**BUFFALO TOWNSHIP RESOLUTION
CITY OF BUFFALO RESOLUTION**

**JOINT RESOLUTION AND AGREEMENT FOR ORDERLY ANNEXATION
BETWEEN BUFFALO TOWNSHIP AND THE CITY OF BUFFALO,
MINNESOTA, OA 1002**

WHEREAS, the Buffalo Township Board passed a resolution on March 01, 2005, approving the annexation to the City of Buffalo of certain parcels of land owned by Jeffrey and Gail Mattila, legally described as follows:

See Attached Legal Description

WHEREAS, the City Council of the City of Buffalo agreed to the annexation of the above described parcel of land at its February 22, 2005 meeting; and

WHEREAS, the Buffalo Township board and the City Council for the City of Buffalo have both determined that the annexation of a portion of the Township with the City is of mutual benefit to both parties and the residents thereof.

NOW, THEREFORE, BE IT RESOLVED by the Buffalo Township Board and the City Council of the City of Buffalo as follows:

1. **Triggering of Annexation:** Buffalo Township ("Township") and the City of Buffalo ("City") desire to allow annexation per number two of OA 1002 that upon receipt of petition by property owner(s) that annexation will be allowed by the Minnesota Department of Administration.
2. **Population of Merger Area:**
 - a.) The Township and the City state that the population of the annexed area is approximately 0 persons.
 - b.) The 2003 State Demographer's estimate of the population of the City of Buffalo was 12,120 persons. Therefore, following the annexation, the estimated population of the City will increase by 0 persons.
3. **State Agency Jurisdiction:** That upon approval by the respective governing bodies of the Township and the City, this Joint Resolution and Agreement confers jurisdiction upon the Minnesota Municipal Board to accomplish the orderly annexation in accordance with the terms of this Joint Resolution and Agreement. The Board may review and comment but shall within 30 days order the annexation in accordance with the terms of the Agreement.
4. **No alterations of Boundaries:** City and Township mutually state that no alterations by the Municipal Board of the boundaries of the area designated herein for orderly annexation is appropriate.

5. **Authorization:** The appropriate officers of the City and the Township are hereby authorized to carry the terms of this Joint Resolution and Agreement into effect.
6. **Severability and Repealer:** Should any section of this Joint Resolution and Agreement be held by a court of competent jurisdiction to be unconstitutional or void, the remaining provisions will remain in full force and effect.
7. **Effective Date:** This Joint Resolution and Agreement is effective upon its adoption by the respective governing bodies of the Township and the City, as provided by law.

Adopted by the Buffalo Township Board the 1 day of March, 2005.

Gordon Jans
Town Clerk/Treasurer

Donald M. Schmidt
Town Board Supervisor

Colleen Ernest
Town Board Supervisor

Ralph V. Odeff
Town Board Supervisor

Adopted by the City Council for the City of Buffalo the 22nd day of February, 2005.

Paul Jack Gebauer
Mayor

Merton T. Auger
Merton T. Auger
City Administrator

3440 Pulaski Road
Buffalo MN 55313

REC'D BY
MMB

MAR 08 2005

EXHIBIT "A"

Legal Description

File No. 2-21146

All that part of Government Lot 3 lying East of the centerline of the road crossing Government Lot 3 in Section 16, Township 120, Range 25, Wright County, Minnesota. Excepting therefrom the following tracts of land:

- 1. Book 35 of Deeds, page 237 described as follows:
That part of Government Lot 3, of Section 16, Township 120, Range 25, Wright County, Minnesota described as follows: The North 180.0 feet of said Government Lot 3, lying East of County Road as now Travelled.**
- 2. Book 265 of Deeds, pages 270 and 272 described as follows:
Part of Government Lot 3, Section 16, Township 120, Range 25, Wright County, Minnesota described as follows: Beginning at the Southeast corner of said Lot 3 thence North, along the East line of said Lot 3, a distance of 866.7 feet; thence deflect 84° 33' left a distance of 600.7 feet; thence deflect 95° 27' left a distance of 100.6 feet; thence deflect 106° 40' right a distance of 212.8 feet; thence deflect 22° 40' right a distance of 191.2 feet more or less to the centerline of County Road No. 12; thence Southwesterly, along said centerline, to the South line of said Lot 3; thence East, along said South line, a distance of 1387.2 feet more or less to said point of beginning.**

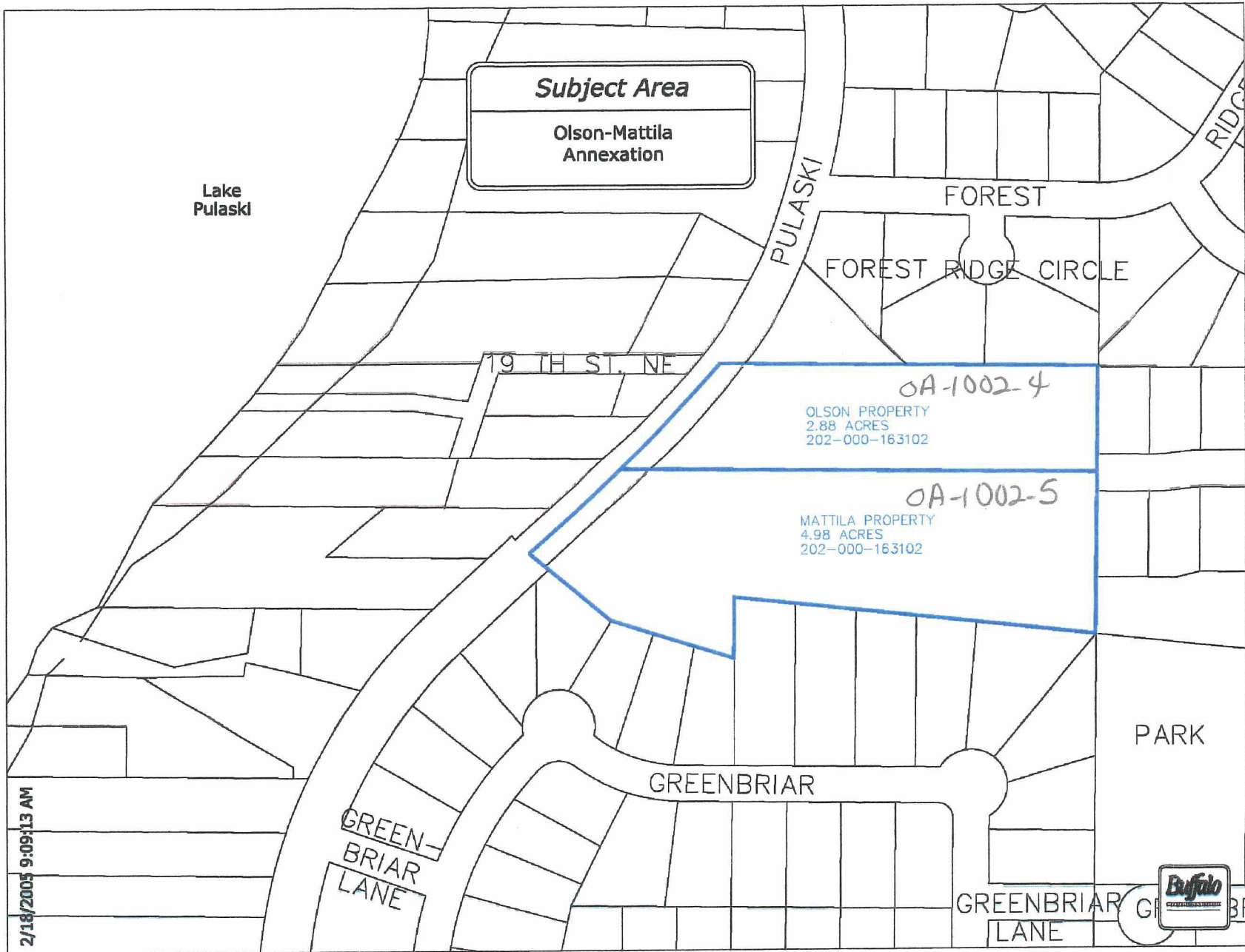

REC'D BY
M.M.B.
MAR 08 2005