

REC'D BY
MMB

DEC 24 2003

**TOWN OF JAMESTOWN,
BLUE EARTH COUNTY, MINNESOTA
CITY OF MADISON LAKE,
COUNTY OF BLUE EARTH, MINNESOTA**

RESOLUTION NO. 2003-216

**STATE OF MINNESOTA)
COUNTY OF BLUE EARTH) ss
TOWN OF JAMESTOWN)**

JOINT RESOLUTION FOR ORDERLY ANNEXATION

WHEREAS, all the owners have petitioned the City of Madison Lake for annexation of the following described real property legally described, to-wit:

That part of the northwest Quarter of section 35, Township 109 North Range 25 west, Blue Earth County, Minnesota, described as:
Commencing at an iron pipe monument designating the West Quarter corner of Section 35; thence North 00 degrees 10 minutes 00 seconds East, (assumed bearing), along the West line of the Northwest Quarter of Section 35 a distance of 423.92 feet; thence South 89 degrees 48 minutes 15 seconds East, 57.00 feet to the point of beginning; thence North 00 degrees 10 minutes 00 seconds East, along a line parallel with and distant 57.00 feet east of the West line of the Northwest Quarter of section 35 a distance of 834.62 feet to a point distant 58.75 feet southerly of the point of intersection of the north line of the Southwest Quarter of the Northwest Quarter of Section 35 with said parallel line; thence North 89 degrees 32 minutes 18 seconds East, 421.00 feet; thence North 00 degrees 10 minutes 00 seconds East, along a line parallel with the west line of Northwest Quarter of Section 35 a distance of 399.62 feet to a point on the southerly right of way line of the Sakatah Singing Hills Trail; thence North 70 degrees 20 minutes 30 seconds east, along said right of way line, 917.58 feet to the point of intersection with the east line of the Northwest Quarter of the Northwest Quarter of Section 35; thence South 00 degrees 01 minutes 14 seconds West, along said east line, 655.99 feet to the southeast corner of the Northwest Quarter of the Northwest Quarter of Section 35; thence South 89 degrees 54

minutes 03 seconds East, along the north line of the Southeast Quarter of the Northwest Quarter of Section 35 a distance of 1342.86 feet to the northeast corner of the Southeast Quarter of the Northwest Quarter of Section 35; thence South 00 degrees 07 minutes 29 seconds East, along the east line of the Southeast Quarter of the Northwest Quarter of Section 35 a distance of 578.46 feet to a point distant 742.50 feet northerly of the southeast corner of the Southeast Quarter of the Northwest Quarter of Section 35 as measured along the east line of said Southeast Quarter of the Northwest Quarter; thence South 19 degrees 29 minutes 03 seconds West, along a line towards a point 264.00 feet west of the southeast corner of the southeast Quarter of the Northwest Quarter of Section 35 as measured along the south line of said Southeast Quarter of the Northwest Quarter a distance of 745.72 feet to the point of intersection with the northerly 75.00 foot wide right of way line of Minnesota Trunk Highway No. 60; thence North 87 degrees 17 minutes 27 seconds West, along said right of way, 2015.96 feet to a point on the east line of the West 428.00 feet of the Southwest Quarter of the Northwest Quarter of Section 35; thence North 00 degrees 10 minutes 00 seconds East, along said east line, 296.89 feet to the point of intersection with a line which bears South 89 degrees 48 minutes 15 seconds East from the point of beginning; thence North 89 degrees 48 minutes 15 seconds West, 371.00 feet to the point of beginning.

This said property is unplatted and does not exceed 200 acres in area.

The acreage of such area is 79.40 acres, and subject to any and all easements of record.

WHEREAS, the owners wish to obtain sanitary sewer and water services; and,

WHEREAS, the City of Madison Lake has sanitary sewer and water facilities adjacent to said tract; and,

WHEREAS, the Town of Jamestown does not have the ability to provide sanitary sewer and water services to the above tract; and,

WHEREAS, the above tract is adjacent to the City's sanitary sewer and water lines; and,

WHEREAS, the owners intend to improve the premises with the construction of residential and commercial buildings; and

WHEREAS, the area is appropriate for such construction; and,

WHEREAS, the land abuts Minnesota State Highway 60 and Blue Earth County #26 and therefore provides adequate and appropriate transportation for the tract;

WHEREAS, the City is better able to provide government services to the property including sewer and water service, fire rating and protection, law enforcement, street improvements and maintenance, administrative services, and recreational facilities;

WHEREAS, annexation will allow the City to better control the environmental impact of

improvement of the properties;

WHEREAS, the Town of Jamestown is less able to provide the above government services to the property.

NOW THEREFORE, THE TOWN BOARD OF THE TOWN OF JAMESTOWN AND THE CITY COUNCIL OF THE CITY OF MADISON LAKE, BLUE EARTH COUNTY, MINNESOTA, DOES HEREBY RESOLVE AS FOLLOWS:

1. That the following described real estate legally described as follows, to-wit:

That part of the northwest Quarter of section 35, Township 109 North Range 25 west, Blue Earth County, Minnesota, described as:

Commencing at an iron pipe monument designating the West Quarter corner of Section 35; thence North 00 degrees 10 minutes 00 seconds East, (assumed bearing), along the West line of the Northwest Quarter of Section 35 a distance of 423.92 feet; thence South 89 degrees 48 minutes 15 seconds East, 57.00 feet to the point of beginning; thence North 00 degrees 10 minutes 00 seconds East, along a line parallel with and distant 57.00 feet east of the West line of the Northwest Quarter of section 35 a distance of 834.62 feet to a point distant 58.75 feet southerly of the point of intersection of the north line of the Southwest Quarter of the Northwest Quarter of Section 35 with said parallel line; thence North 89 degrees 32 minutes 18 seconds East, 421.00 feet; thence North 00 degrees 10 minutes 00 seconds East, along a line parallel with the west line of Northwest Quarter of Section 35 a distance of 399.62 feet to a point on the southerly right of way line of the Sakatah Singing Hills Trail; thence North 70 degrees 20 minutes 30 seconds east, along said right of way line, 917.58 feet to the point of intersection with the east line of the Northwest Quarter of the Northwest Quarter of Section 35; thence South 00 degrees 01 minutes 14 seconds West, along said east line, 655.99 feet to the southeast corner of the Northwest Quarter of the Northwest Quarter of Section 35; thence South 89 degrees 54 minutes 03 seconds East, along the north line of the Southeast Quarter of the Northwest Quarter of Section 35 a distance of 1342. 86 feet to the northeast corner of the Southeast Quarter of the Northwest Quarter of Section 35; thence South 00 degrees 07 minutes 29 seconds East, along the east line of the Southeast Quarter of the Northwest Quarter of Section 35 a distance of 578.46 feet to a point distant 742.50 feet northerly of the southeast corner of the Southeast Quarter of the Northwest Quarter of Section 35 as measured along the east line of said Southeast Quarter of the Northwest Quarter; thence South 19 degrees 29 minutes 03 seconds West, along a line towards a point 264.00 feet west of the southeast corner of the southeast Quarter of the Northwest Quarter of Section 35 as measured along the south line of said Southeast Quarter of the Northwest Quarter a distance of 745.72 feet to the point of intersection with the northerly 75.00 foot wide right of way line of Minnesota Trunk Highway No. 60; thence North 87 degrees 17 minutes 27 seconds West, along said right of way, 2015.96 feet to a point on the east line of the West 428.00 feet of the Southwest Quarter of the Northwest Quarter of Section 35; thence North 00 degrees 10 minutes 00 seconds East, along said east line, 296.89 feet to the point of intersection with a line which bears South 89 degrees 48 minutes 15 seconds East from the point of beginning; thence North 89 degrees 48 minutes 15 seconds West, 371.00 feet to the point of beginning.

2. State Agency Jurisdiction: That upon approval by the respective governing bodies of the Town and the City. This Joint Resolution and Agreement confers jurisdiction upon the Minnesota Municipal Board so as to accomplish the merger and orderly annexation in accordance with the terms of this Joint Resolution and Agreement.
3. No Alterations of Boundaries: The Town and the City mutually state that no alterations by the Municipal Board of the boundaries of the area designated herein for merger and orderly annexation is appropriate.
4. Review and Comment by State Board: The Town and the City mutually state that this Joint Resolution and Agreement sets forth all the conditions for the merger of the area designated herein for such merger and orderly annexation, and that no consideration by the Municipal Board is necessary. The Municipal Board may review and comment, but must, within thirty (30) days of receipt of this Joint Resolution and Agreement, order merger and orderly annexation in accordance with its terms and conditions.

Adopted by the City Council this 15th day Dec, 2003
Clell Hemphill
Clell Hemphill, Mayor

ATTEST:
Debra DeVlaeminck
Debra DeVlaeminck, City Clerk

Adopted by the Jamestown Board of Supervisors this 9 day of December 2003.

Edmund Fustik, Chair

ATTEST:
Michael P. Bisel, Clerk

I, Debra DeVlaeminck, Clerk of the City of Madison Lake, do hereby certify that I have compared the attached copy of with the original on file in the office of the City Clerk, and that it is a true and correct transcript therefrom and the whole of such original.

In Witness Whereof, I have set my hand and affixed the Seal of the City of Madison Lake this 15 day of Dec, 2003
Debra DeVlaeminck
City Clerk



REC'D BY
MMB

DEC 24 2003

City of Madison Lake

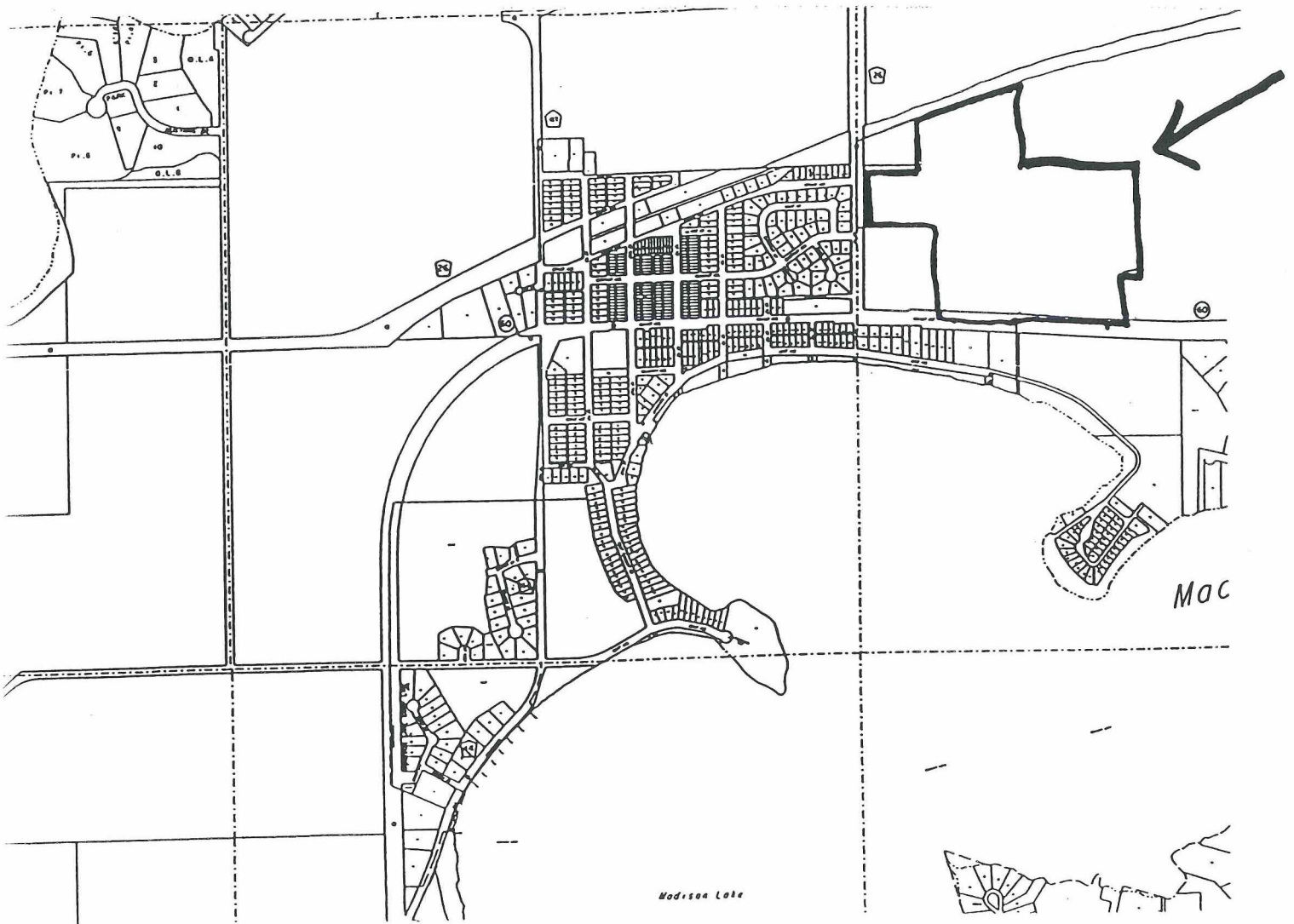

1/13/04 STAR-TAX # 1-651-284-3545

