

REC'D. BY JUN 06 1996
MMB

RESOLUTION NO. 96-5
TOWNSHIP OF GRANT
COUNTY OF WASHINGTON
STATE OF MINNESOTA

IN THE MATTER OF THE PETITION OF THE TOWNSHIP OF GRANT FOR
INCORPORATION PURSUANT TO MINNESOTA STATUTES, CHAPTER 414.

BE IT RESOLVED, by the Town Board of Supervisors of the Township of Grant (the
Township), Minnesota as follows:

WHEREAS, the Township is not included within the limits of any incorporated
municipality and includes land that has been platted into lots and blocks in the manner provided
by law; and

WHEREAS, Minnesota Statutes Section 414.02 provides the exclusive method of
incorporating a municipality in Minnesota; and

WHEREAS, the 1990 U.S. Census reported the Township population at 3778 residents.

WHEREAS, the Township, is now, or about to become, urban or suburban in character;
and

WHEREAS, the existing Township form of government is not adequate to protect the
public health, safety, and welfare; and

WHEREAS, incorporation would be in the best interest of the Township; and

WHEREAS, the Township has undertaken the process of updating its Comprehensive
Plan; and

WHEREAS, there has been a rapid increase in population within the Township in recent
years, and future increases are projected by both the Metropolitan Council and the Township;
and

WHEREAS, areas within the Township, are now, and will be in the future, the subject of
urban and suburban scale development; and

WHEREAS, the Township does not receive Municipal State Aid for roads and highways
to properly build, restore, and repair and maintain the road and highway infrastructure of the
Township; and

WHEREAS, incorporation as a city would allow the Township to be more effectively
served in the areas of fire protection, road maintenance, and administration, and;

(1)

WHEREAS, the Township has a certain assessed valuation, tax capacity, indebtedness, and other fiscal disclosures all of which are listed on the attached Exhibit A and herein incorporated by reference; and,

WHEREAS, Incorporation of the Township will have no adverse effect on communities adjacent to Grant, nor on school districts within and adjacent to the area; and,

THEREFORE, BE IT RESOLVED that the Town Board of Supervisors of the Township of Grant hereby declares that:

The Township of Grant, through this resolution, formally requests that the Minnesota Municipal Board institute a public hearing pursuant to Minn. Stat. Sec. 414.02, Subd. 2, and, subsequent to said hearing, enter an order incorporating the Township of Grant as the City of Grant pursuant to Minn. Stat. Sec. 414.02, Subd. 3.

Prior to the hearing on this matter, the Board notify all municipalities abutting the Township of Grant, Washington County, and each planning agency which has jurisdiction over the affected area, all of which are listed on the attached Exhibit B which is herein incorporated by reference.

That final order of the Board set the boundaries of the City at the present Township boundaries which are indicated on the attached Exhibit C, "Proposed Corporate Boundary Map, And Legal Description" which is herein incorporated by reference.

That final order provide for election of Municipal Officers in accordance with Minn. Stat. Sec. 414.09, Subd. 3 and for the ordering of an at-large election of council members, and to provide that the plan of Government shall be "Optional Plan A".

Passed and Adopted by the Town Board of Supervisors this 2nd day of April, 1996.

ATTEST:



Gary Erichson, Chairman



Deborah Graul, Town Clerk
0199560.01

EXHIBIT A
(Revised July 11, 1996)

The 1996 market value of the Township of Grant is \$251,867,200. The taxable net valuation (tax capacity) for 1996 is \$4,346,392.

There are 1256 homestead parcels and 634 non-homestead parcels within the Township of Grant.

The total bonded indebtedness of the Township of Grant as of March 31, 1996 is \$570,000.00.

Mill Rates: (Tax Capacity)

Washington County	29.760
Township of Grant	7.601
School District #832	73.333
School District #834	65.605

Payable 1996 figures - Source: Washington County Auditor

EXHIBIT A

The 1996 market value of the Township of Grant is \$231,478,200. The taxable net valuation (tax capacity) for 1996 is \$3,916,063.

There are 1256 homestead parcels and 634 non-homestead parcels within the Township of Grant.

The total bonded indebtedness of the Township of Grant as of March 31, 1996 is \$570,000.00.

Mill Rates: (Tax Capacity)

Washington County	11.175
Township of Grant	30.619
School District #832	73.661

Payable 1996 figures - Source: Washington County Auditor

EXHIBIT B

POLITICAL SUBDIVISIONS ADJACENT TO TOWNSHIP OF GRANT

Washington County:	Chairman Dave Engstrom Washington County Board of Commissioners Washington County Government Center 14900 - 61st Street North P.O. Box 6 Stillwater, MN 55082
City of Dellwood	Joanne Hensley, Clerk-Administrator P.O. Box 775 Willernie, MN 55090-0775
City of Hugo	Mary Ann Creager, Clerk-Treasurer 5524 Upper 146th Street North Hugo, MN 55038-9367
City of Lake Elmo	Sharon Lumby, Dep. Clerk 3800 Laverne Avenue North Lake Elmo, MN 55042
City of Mahtomedi	John Olinger, City Administrator 600 Stillwater Road Stillwater, MN 55115-2098
City of Pine Springs	Karen Pirozzoli, City Administrator 6145 Warner Avenue South St. Paul, MN 55115-5504
Baytown Township	Pat St. Claire, Clerk 14949 30th Street North Stillwater, MN 55082
May Township	Linda Klein, Clerk 13519 May Avenue North Stillwater, MN 55082
Stillwater Township	Pat Bantli, Clerk Box 117 Stillwater, MN 55082

White Bear Township

William Short, Clerk-Treasurer
1281 Hammond Road
White Bear Township, MN 55110

School Districts

Mahtomedi Public Schools District #832
District Education Center
1520 Mahtomedi Avenue
Mahtomedi, MN 55115

Stillwater Area Public Schools
District Office
1875 S. Greeley Street
Stillwater, MN 55082

Planning Agency

Metropolitan Council
Mears Park Center
230 East Fifth Street
St. Paul, Minnesota 55101



Orr
Schelen
Mayeron &
Associates, Inc.

300 Park Place East
5775 Wayzata Boulevard
Minneapolis, MN 55416-1228

612-595-5775
1-800-753-5775
FAX 595-5773

DESCRIPTION OF THE TOWNSHIP OF "GRANT"

All of Sections 1, 2, 3, 4, 9, 10, 11, 12, 13, 14, 15, 16, 21, 22, 23, 24, 25, 26, 27, 28, 33, 34, 35, and 36, all in Township 30 North, Range 21 West, Washington County, Minnesota.

And

The Northeast Quarter, the North Half of the Southeast Quarter, the East Half of the Northwest Quarter and the Northwest Quarter of the Northwest Quarter, all in Section 5, Township 30 North, Range 21 West, Washington County, Minnesota and that part of the South Half of the Southeast Quarter of said Section 5, which lies northerly and easterly of the property described in Book 217 of Deeds, Page 273, files of the County Recorder in and for said Washington County.

And

The Northeast Quarter, the Northwest Quarter, the Northeast Quarter of the Southwest Quarter and the North Half of the Southeast Quarter, all in Section 6, Township 30 North, Range 21 West, Washington County, Minnesota and that part of the South Half of the Southeast Quarter said Section 6, which lies northerly of the south line of NORTHRIDGE ACRES, according to the plat on file in the office of the County Recorder, said Washington County and that part of the west 433.00 feet of said South Half of the Southeast Quarter which lies northerly of the south line of the north 29 1/3 rods thereof.

And

That part of the West Half of the Northwest Quarter of Section 7, Township 30 North, Range 21 West, Washington County, Minnesota, which lies southerly of the north right of way line of the Soo Line Railroad, now known as CP Rail System.

And

Lots 1, 2, 3, 4, 5 and 6, Block 2, DELLWOOD, according to the plat on file in the office of the County Recorder, Washington County, Minnesota and the north half of that part of Stillwater Road adjoining said Block 2.

NOTE: No boundary survey work was performed as to the precise location of this tract.

I hereby certify that this survey, plan, or report was prepared by me or under my direct supervision and that I am a duly licensed land surveyor under the laws of the State of Minnesota.

h:\1751.00\survey\seam\ease.1

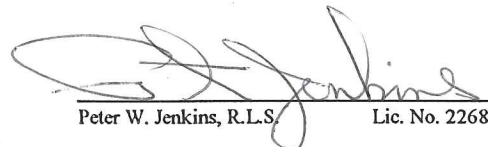
 19 Mar 96
Peter W. Jenkins, R.L.S. Lic. No. 22683 Date

EASEPJ3.XLS

And

The Southeast Quarter of Section 8, Township 30 North, Range 21 West, Washington County, Minnesota and that part of the Northeast Quarter of said Section 8, which lies southerly of the north right of way line of the Soo Line Railroad, now known as CP Rail System. Together with that part of the Southwest Quarter of said Section 8, which lies easterly of the following described line:

Beginning at the northwest corner of said Southwest Quarter, thence South, assumed bearing, along the west line thereof, to a point 1070.3 feet north of the southwest corner of said Southwest Quarter; thence North 50 degrees 50 minutes East 414.1 feet to an iron monument; thence South 55 degrees 40 minutes East 136.65 feet to an iron monument; thence South 31 degrees 53 minutes West 476.15 feet to an iron monument; thence South 30 degrees 45 minutes East 176.05 feet to an iron monument; thence South 20 degrees 46 minutes West 331.1 feet to an iron monument; thence South 16 degrees 59 minutes West 278.37 feet to an iron monument thence South 16 degrees 32 minutes West 129.35 feet to an iron monument on the south line of Section 8 and said line there terminating.

And

That part of the Northeast Quarter and that part of the East Half of the Northwest Quarter, both in Section 17, Township 30 North, Range 21 West, Washington County, Minnesota which lies northerly of the centerline of State Trunk Highway No. 96, according to the plats of GLASGOW PINE TREE ESTATES and PINE TREE HILLS, on file in the office of the County Recorder, said Washington County.

REC'D. BY JUN 28 1996
M.M.R

TOWN OF GRANT

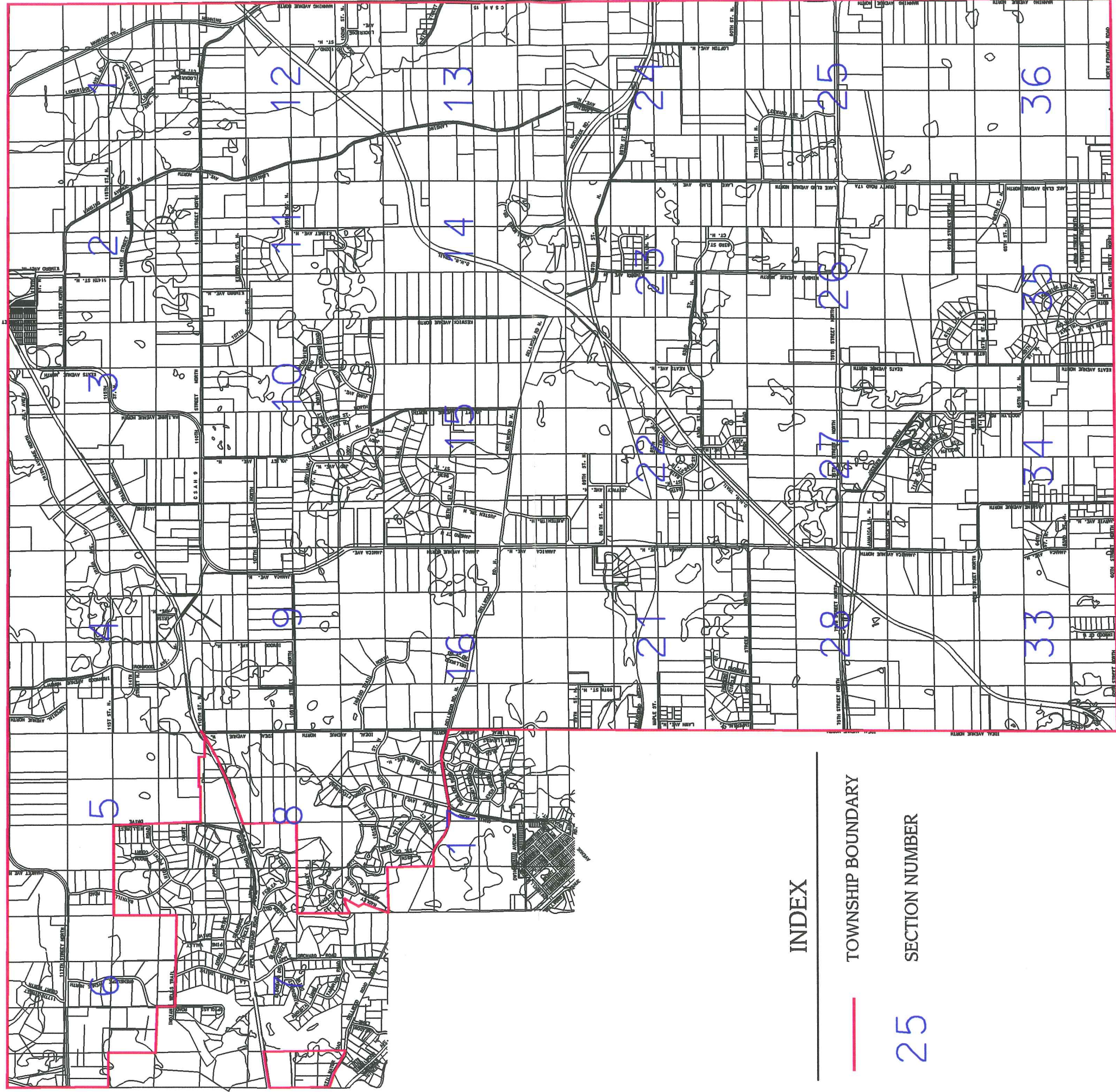

INDEX

— TOWNSHIP BOUNDARY

25 SECTION NUMBER