

original

**SAMPLE PROPERTY OWNER PETITION FOR DETACHMENT
OF PROPERTY FROM A CITY**

IN THE MATTER OF THE PETITION FOR DETACHMENT OF
CERTAIN LAND FROM THE CITY OF Alpha, MINNESOTA
PURSUANT TO MINNESOTA STATUTES § 414.06

TO: Office of Administrative Hearings
Municipal Boundary Adjustments
P. O. Box 64620
St. Paul, MN 55164-0620
651-361-7900

REC'D BY
MAMB APR 30 2009

PETITIONERS STATE: The number of petitioners required by Minnesota Statutes § 414.06, Subd. 1, to commence this proceeding is: all of the property owners if the area is less than 40 acres; or 75% or more of the property owners in number if the area is more than 40 acres.

It is hereby requested by:

all of the property owners, the area is less than 40 acres; or
 75% or more of the property owners, the area is more than 40 acres;

to detach certain properties described herein from the City of Alpha and make a part of the Township of Wisconsin.

- There are 2 property owners in the area proposed for detachment.
- 2 property owners have signed this petition. (If the land is owned by both the husband and wife, both must sign the petition to represent all owners.)
- The property is situated within the City of Alpha, abuts the municipal boundary and the boundary of the Township of Alpha, in the County of Jackson.
The petitioned area abuts on the city's N S E W (circle one) boundary(ies).
- The property proposed for detachment is rural in character and not developed for urban residential, commercial, or industrial purposes.
- The number of acres in the property proposed for detachment is 5.6 and is described as follows: see attached deed

**INSERT THE COMPLETE AND ACCURATE PROPERTY DESCRIPTION.
DO NOT USE DESCRIPTIONS FROM PROPERTY TAX STATEMENTS.**

- The reason detachment is requested is 1. Property has been farmland for 100 years and there is no intention for building. It will remain farmland.
2. There are no city maintained roads, used, no city electricity (or rural) no well or city water.

7. The number of residents in the area proposed for detachment is 0 (The number of residents is not necessarily the same as number of owners.)

8. The number and character of buildings on said property is: 1 pole barn for storage, gravel floor, no electricity

9. Public improvements on said property are: none

Date: 3-3-09

[Signature]
Property Owner
[Signature]
Property Owner

Rev. 10/2007

SAMPLE CITY RESOLUTION FOR DETACHMENT OF PROPERTY FROM A CITY

RESOLUTION OF THE CITY OF Alpha
FOR DETACHMENT OF CERTAIN LAND
PURSUANT TO MINNESOTA STATUTES § 414.06

The language in the following paragraph is used when the city requests or supports the detachment.

The City of Alpha hereby requests by resolution the Office of Administrative Hearings - Municipal Boundary Adjustments to detach certain properties described herein from the City of Alpha and make a part of the Township of Wisconsin

Insert statements 3 - 9, including the legal description, shown on sample petition.

Date: 3-3-09

[Signature]
Mayor
[Signature]
City Clerk

Rev. 10/2007
The Township of Wisconsin agrees to accept within its boundaries the aforementioned property 4-13-09 in their minutes
[Signature]

36 W

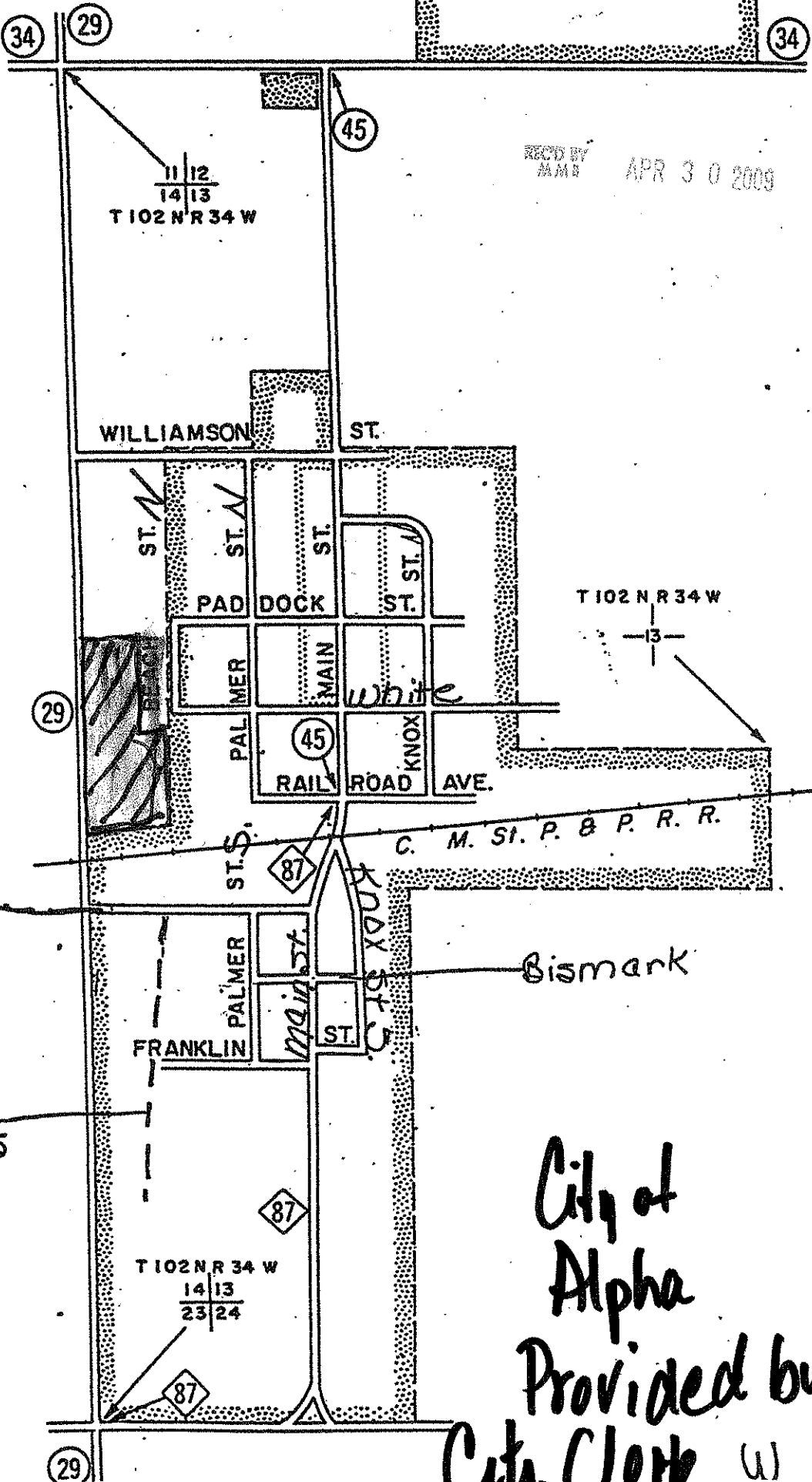

REC'D BY
MMB APR 30 2009

Keisel av.

Beach St. S

Bismark

City of Alpha
Provided by
City Clerk (u) 9

1400

247258

IMAGED

STATE OF MINNESOTA, ss
County of Jackson
I hereby certify that the within instrument was filed in County Recorder's office for record on July 11, 2006 at 12:20 o'clock PM and was duly recorded on Document No. 247258
Becky McElann
County Recorder
Dona Weets - Alpha

No delinquent taxes and transfer entered: Certificate of Real Estate Value () filed (X) not required.
Certificate of Real Estate Value No. 7-11-06
Date 7-11-06
B. J. Rulife
Jackson County Auditor
By Bette Williams
Deputy

RECORDED BY
MAMB
APR 30 2009

OFFICE OF COUNTY RECORDER
JACKSON COUNTY
 WELL CERTIFICATE RECEIVED

QUIT CLAIM DEED

DEED TAX DUE HEREON: \$ 1.65

Date: July 10 2006

FOR VALUABLE CONSIDERATION, Duane K. Crawley & Shirley Crawley, husband & wife Grantor(s), hereby convey(s) and quitclaim(s) to Dona Weets & Rick Weets, husband & wife as Joint Tenants not Tenants in common Grantee(s), real property in Jackson County, Minnesota, described as follows:

Beginning at the SW Corner of Block 9 in the Village of Alpha, MN, according to the Plat thereof or and of record in the office of the register of deeds of Jackson County, MN; Thence running N 911.6 along the W line of beach street; Thence running W to the section line between sections 13 & 14 in township 102 N, Range 34 W, in said county, approximately 273 ft.; Thence running S on said section to the railroad right-of-way of the C.M. St.P. & P. Railroad Company; Thence E on said N line of said Railroad right-of-way to the place of beginning 21.013.0300 6-32
1/4 pt SW 1/4 NW 1/4 & 1/4 pt NW 1/4 SW 1/4
13-102-34

together with all hereditaments and appurtenances.

County of Jackson
State of Minnesota
DEED STAMP TAX....\$ 1.65
Date 7-11-06 B
No 05864

Check box if applicable:

- The Seller certifies that the seller does not know of any wells on the described property.
- A well disclosure certificate accompanies this document.
- I am familiar with the property described in this instrument and I certify that the status and number of wells on the described real property have not changed since the last previously filed well disclosure certificate.

[Affix Deed Tax Stamp Here]