

IN THE MATTER OF THE PETITION FOR DETACHMENT OF  
CERTAIN LAND FROM THE CITY OF WOODBURY, MINNESOTA  
PURSUANT TO MINNESOTA STATUTES § 414.06

PETITIONERS STATE: The number of petitioners required by Minnesota Statutes § 414.06, Subd. 1, to commence this proceeding is: all of the property owners if the area is less than 40 acres; or 75% or more of the property owners in number if the area is more than 40 acres.

It is hereby requested by all of the property owners (the area is less than 40 acres) to detach certain properties described herein from the City of Woodbury and make a part of the Township of West Lakeland.

1. There is one property owner in the area proposed for detachment.
2. All property owners have signed this petition.
3. The property is situated within the City of Woodbury, abuts the municipal boundary and the boundary of the Township of West Lakeland, in the County of Washington. The petitioned area abuts on the city's north boundary.
4. The property proposed for detachment is rural in character and not developed for urban residential, commercial, or industrial purposes.
5. The number of acres in the property proposed for detachment is .06 acres and is described as follows:

The detachment area shall include that portion of the City of Woodbury lying north of the following described line: Beginning at the southeast corner of Section 36, Township 29 North, Range 21 West thence easterly along the south line of Section 31, Township 29 North, Range 20 West, on an azimuth of 89 degrees 56 minutes 13 seconds to the easterly right of way line of County Road 15, as it existed on March 7, 1967, said right of way line also being the easterly boundary line of the City of Woodbury and there terminating.

6. The reason detachment is requested is to redefine the City of Woodbury north corporate limits to reflect the construction of I-94 and to clarify public safety response responsibilities.
7. The number of residents in the area proposed for detachment is zero.
8. There are no buildings on said property to be detached from the City of Woodbury.

9. Public improvements on said property are Manning Avenue (TH95 and County State Aid Highway 15).

Date: March 13, 2008

  
Name: Lynn M. Anderson

Title: Assistant Secretary

Holiday Stationstores, Inc.  
4567 American Boulevard West  
Bloomington, MN 55437

**RESOLUTION NO. 07 – 255**

**RESOLUTION OF THE CITY OF WOODBURY,  
WASHINGTON COUNTY, MINNESOTA**

**APPROVING THE DETACHMENT OF CERTAIN LANDS AND REQUESTING  
REVIEW AND APPROVAL OF SAID DETACHMENT PURSUANT TO MINNESOTA  
STATUTE 414.06**

WHEREAS, when the City incorporated in 1967, the north boundary of the incorporated village (now City of Woodbury) was established as the north boundary of the north right-of-way line of Trunk Highway 12; and

WHEREAS, the construction of I-94 and the associated north frontage road (Hudson Boulevard) resulted in a change of the north right-of-way line; and

WHEREAS, West Lakeland Township and the City of Woodbury wish to redefine their mutual boundaries; and

WHEREAS, the City of Woodbury desires to detach and West Lakeland Township desires to annex those areas lying north of the I-94 main line and southerly of the original Trunk Highway 12 north right-of-way line; and

WHEREAS, Minnesota Statute Chapter 414.06 provides that property in one municipality which abuts another municipality may be concurrently detached and annexed pursuant to the procedure set forth in said statute; and

WHEREAS, a legal description of the land proposed to be detached and annexed is described in Exhibit B attached hereto and made a part hereof.

NOW, THEREFORE, BE IT RESOLVED by the City Council of the City of Woodbury, Washington County, Minnesota as follows:

1. The City of Woodbury requests the Minnesota Office of Administrative Hearings / Municipal Boundary Adjustments to approve the detachment of the property described on Exhibit B, attached hereto and made a part hereof, from the City of Woodbury and concurrently annexed to West Lakeland Township. ]
2. That said concurrent detachment and annexation would be in the best interest of the City of Woodbury and West Lakeland Township. ]?
3. That a copy of this resolution shall be forwarded to the Minnesota Office of Administrative Hearings / Municipal Boundary Adjustments for review and approval.

RECD BY  
M M B

JUL 22 2008

Resolution No. 07-255  
December 12, 2007  
Page 2

This Resolution was declared duly passed and adopted and was signed by the Mayor and attested to by the City Administrator this 12<sup>th</sup> day of December, 2007.

Attest:

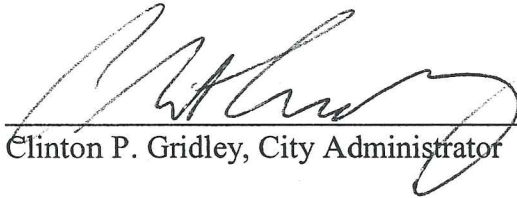

William Hargis, Mayor

  
Clinton P. Gridley, City Administrator

(SEAL)

EXHIBIT B  
City of Woodbury Detachment to West Lakeland Township

The detachment area shall include that portion of the City of Woodbury lying north of the following described line: Beginning at the southeast corner of Section 36, Township 29 North, Range 21 West thence easterly along the south line of Section 31, Township 29 North, Range 20 West, on an azimuth of 89 degrees 56 minutes 13 seconds to the easterly right of way line of County Road 15, as it existed on March 7, 1967, said right of way line also being the easterly boundary line of the City of Woodbury and there terminating.



**Limitation of Liability**

This document is not a legally recorded map or survey and is not intended to be used as one. This map is a compilation of records and information from various state, county, and township offices, and other sources.

REC'D BY  
MMB  
AUG 26 2008

City of Lake Elmo  
West Lakeland Township

**MANNING AVE  
(C.S.A.H. 15)**

City of Lake Elmo  
City of Woodbury

Existing Woodbury  
Corporate Boundary

**Proposed  
Detachment Area  
(0.06 Acres)**

**Proposed Woodbury  
Corporate Boundary**

West Lakeland Township  
City of Afton

**INTERSTATE 94**

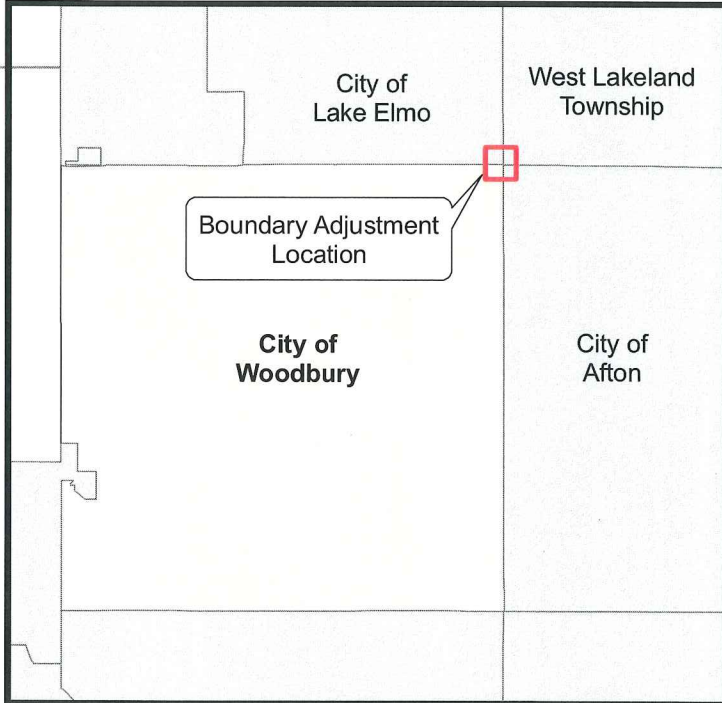

**INSET:  
LOCATION OF PROPOSED BOUNDARY  
ADJUSTMENT IN RELATION TO WOODBURY  
CORPORATE BOUNDARY**

City of Woodbury  
City of Afton

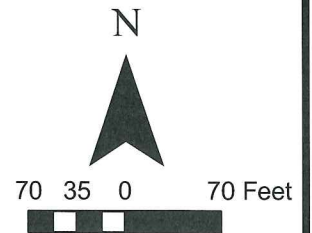

K:\projects\LAKEEL\MO\Projects\Hudson Blvd - Juris\WDB\WLI

Date: August 4, 2008  
Created By: CES  
**TKDA**  
ENGINEERS • ARCHITECTS • PLANNERS

PROJECT NO. 14064.000  
WEST LAKELAND TOWNSHIP  
MINNESOTA

**CITY OF WOODBURY DETACHMENT  
TO WEST LAKELAND TOWNSHIP**  
MN O.A.H./M.B.A. DOCKET NO. D-459

Figure No.  
**1**