

**IN THE MATTER OF THE CONCURRENT DETACHMENT
AND ANNEXATION OF INCORPORATED LAND BETWEEN
THE CITY OF ROCKFORD AND THE CITY OF GREENFIELD
PURSUANT TO MINNESOTA STATUTES §414.061**

TO: Christine Scotillo, Executive Director, Municipal Boundary Adjustments

WHEREAS, the following described parcels of real property are located within the City of Rockford, Hennepin County, Minnesota:

Parcel 1

The northwesterly 225 feet of that part of the Southeast Quarter of Section 29, Township 119, Range 24, described as follows: Commencing at a point in the southeasterly line of County Road 50 distant 250 feet northeasterly, measured along said line, from its intersection with the northeasterly line of Minneapolis, St. Paul and S. St. Marie R.R.; thence South 47 degrees 57 minutes East 535.26 feet to the point of beginning of the tract of land to be described; thence South 39 degrees 45 minutes West 248.14 feet to said railroad right-of-way line; thence Southeasterly along said railroad right-of-way to the east line of said Southeast Quarter; thence North along said east line to the southwesterly line of State Highway No. 55; thence Northwesterly along said southwesterly line to a point bearing North 39 degrees 45 minutes East from the point of beginning; thence to point of beginning.

Except that part of the above described property which lies northeasterly of a line 50 feet southwesterly of, measured at a right angle to and parallel with the southwesterly right-of-way line of State Highway No. 55.

PID # 29-119-24-41-0039 (approximately 1.35 acres)

Parcel 2

That part of the Southeast Quarter of Section 29, Township 119 North, Range 24 West of the 5th Principal Meridian, described as follows: Commencing at a point in the Southeasterly line of County Road No. 50 distant 250 feet Northeasterly, measured along said line, from its intersection with the Northeasterly line of Minneapolis, St. Paul and S. St. Marie R.R.; thence South 47 degrees 57 minutes East a distance of 535.26 feet to the point of beginning of the tract of land

to be described; thence South 39 degrees 45 minutes West a distance of 248.14 feet to said railroad right-of-way line; thence Southeasterly along said railroad right-of-way to the East line of said Southeast Quarter; thence North along said East line to the Southwesterly line of State Highway No. 55, created by Document Nos. 5383688 and 5524846; thence Northwesterly along said Southwesterly line to a point bearing North 39 degrees; 45 minutes East from the point of beginning; thence to point of beginning, except the Northwesterly 225 feet; and EXCEPT that part thereof described as follows: That part of the Southeast Quarter of Section 29 Township 119 North, Range 24 West of the 5th Principal Meridian lying Northeasterly of the Northeasterly right-of-way line of the Soo Line Railroad, Southwesterly of the Southwesterly right-of-way line of State Highway No. 55 as described in Document No. 2843993, and lying Southeasterly of the following described line: Commencing at the Southeast corner of said Section 29; thence West along the South line of said Southeast Quarter a distance of 393.32 feet to the point of beginning of the line to be described; thence Northeasterly deflecting right 114 degrees to the Southwesterly line of State Highway No. 55 and there ending.

PID # 29-119-24-41-0040 (approximately .18 acres); and

WHEREAS, the following two parcels of real estate are located within the City of Greenfield, Hennepin County, Minnesota:

Parcel 3

That part of the Southeast 1/4 of Section 29, Township 119 North, Range 24 West of the 5th Principal Meridian, more fully described as follows: Commencing at the Southeast corner of said Section 29; thence North along the East line of said Section 29 a distance of 16 feet to a point on the semi-tangent of the curve of the main track of the Minneapolis, St. Paul & Sault Ste. Marie Railroad; thence North 68 degrees 16 minutes West along said semi-tangent a distance of 1040.4 feet; thence North 47 degrees 16 minutes West along the semi-tangent of said curve a distance of 1061.9 feet to the point of tangency; thence North 42 degrees 44 minutes East a distance of 100 feet to the point of tangency of a curve along the Northeasterly right-of-way line of said railroad and the point of beginning of the tract herein described; thence North 47 degrees 16 minutes West along said right-of-way line a distance of 232.43 feet to the Southeasterly right-of-way line County Road No. 50; thence North 37 degrees 16 minutes East along last mentioned right-of-way line a distance of 250

feet; thence South 47 degrees 57 minutes East 535.26 feet; thence South 39 degrees 45 minutes West 248.14 feet to said railroad right-of-way line; thence Northwesterly along said railroad right-of-way line and on a curve to the right having a radius of 5629.65 feet a distance of 292.08 feet to the point of tangency of said curve and the point of beginning.

PID # 29-119-24-43-0001 (approximately 1.65 acres)

Parcel 4

All that part of the Southeast quarter (SE 1/4) of Section 29, Township 119, Range 24, described as follows:

Commencing at a point on the West line of Northeast quarter of Southeast quarter (NE 1/4 of SE 1/4) lying 894.11 feet South of the North line of Said Southeast quarter (SE 1/4); thence North along said line to the southerly line of the intersection of County Road 50 and State Highway 55; thence westerly along said line to the southeasterly line of County Road 50; thence southwesterly along said line to a point 250 feet northeasterly, measured along said line, from its intersection with the northeasterly line of Minneapolis, St. Paul and S. St. Marie R. R.; thence South 47° 57" East 535.26 feet; thence North 39° 45" East to the southwesterly line of State Highway No. 55; thence northwesterly along said line to a point bearing North 39° 49" East from the point of beginning; thence to point of beginning.

PID # 29-119-24-44-0003 (approximately .27 acres); and

WHEREAS, the City of Rockford and the City of Greenfield are in agreement as to the concurrent detachment and annexation of the incorporated land above-described; that both City Councils feel it will be to their benefit and to the benefit of their respective residents that the detachment and annexation occur; and

WHEREAS, Minnesota Statutes §414.061 provides a procedure whereby the City of Rockford and the City of Greenfield may agree upon the process of concurrent detachment and annexation of incorporated lands within their respective Cities; and

WHEREAS, the City of Rockford and the City of Greenfield have agreed upon the conditions for the detachment and annexation of the above-described lands, and that no consideration by Minnesota Planning, Municipal Boundary Adjustments is necessary prior to the concurrent detachment and annexation of lands.

NOW, THEREFORE, BE IT RESOLVED, jointly by the City Council of the City of Rockford and the City Council of the City of Greenfield as follows:

1. That the following described lands in the City of Rockford are subject to detachment and annexation to the City of Greenfield pursuant to Minnesota Statutes §414.061, and the parties hereto designate said parcels of property for concurrent detachment and annexation, to-wit:

Parcel 1

The northwesterly 225 feet of that part of the Southeast Quarter of Section 29, Township 119, Range 24, described as follows: Commencing at a point in the southeasterly line of County Road 50 distant 250 feet northeasterly, measured along said line, from its intersection with the northeasterly line of Minneapolis, St. Paul and S. St. Marie R.R.; thence South 47 degrees 57 minutes East 535.26 feet to the point of beginning of the tract of land to be described; thence South 39 degrees 45 minutes West 248.14 feet to said railroad right-of-way line; thence Southeasterly along said railroad right-of-way to the east line of said Southeast Quarter; thence North along said east line to the southwesterly line of State Highway No. 55; thence Northwesterly along said southwesterly line to a point bearing North 39 degrees 45 minutes East from the point of beginning; thence to point of beginning.

Except that part of the above described property which lies northeasterly of a line 50 feet southwesterly of, measured at a right angle to and parallel with the southwesterly right-of-way line of State Highway No. 55.

PID # 29-119-24-41-0039 (approximately 1.35 acres)

Parcel 2

That part of the Southeast Quarter of Section 29, Township 119 North, Range 24 West of the 5th Principal Meridian, described as follows: Commencing at a point in the Southeasterly line of County road No. 50 distant 250 feet Northeasterly, measured along said line, from its intersection with the Northeasterly line of Minneapolis, St. Paul and S. St. Marie R.R.; thence South 47 degrees 57 minutes East a distance of 535.26 feet to the point of beginning of the tract of land to be described; thence South 39 degrees 45 minutes West a distance of 248.14 feet to said railroad right-of-way line; thence Southeasterly along said railroad right-of-way to the East line of said Southeast Quarter; thence North along said East line to the Southwesterly line of State Highway No. 55, created by Document Nos. 5383688 and

5524846; thence Northwesterly along said Southwesterly line to a point bearing North 39 degrees; 45 minutes East from the point of beginning; thence to point of beginning, except the Northwesterly 225 feet; and EXCEPT that part thereof described as follows: That part of the Southeast Quarter of Section 29 Township 119 North, Range 24 West of the 5th Principal Meridian lying Northeasterly of the Northeasterly right-of-way line of the Soo Line Railroad, Southwesterly of the Southwesterly right-of-way line of State Highway No. 55 as described in Document No. 2843993, and lying Southeasterly of the following described line: Commencing at the Southeast corner of said Section 29; thence West along the South line of said Southeast Quarter a distance of 393.32 feet to the point of beginning of the line to be described; thence Northeasterly deflecting right 114 degrees to the Southwesterly line of State Highway No. 55 and there ending.

PID # 29-119-24-41-0040 (approximately .18 acres)

2. That the following described lands in the City of Greenfield are subject to detachment and annexation to the City of Rockford pursuant to Minnesota Statutes §414.061, and the parties hereto designate said parcels of property for concurrent detachment and annexation, to-wit:

Parcel 3

That part of the Southeast 1/4 of Section 29, Township 119 North, Range 24 West of the 5th Principal Meridian, more fully described as follows: Commencing at the Southeast corner of said Section 29; thence North along the East line of said Section 29 a distance of 16 feet to a point on the semi-tangent of the curve of the main track of the Minneapolis, St. Paul & Sault Ste. Marie Railroad; thence North 68 degrees 16 minutes West along said semi-tangent a distance of 1040.4 feet; thence North 47 degrees 16 minutes West along the semi-tangent of said curve a distance of 1061.9 feet to the point of tangency; thence North 42 degrees 44 minutes East a distance of 100 feet to the point of tangency of a curve along the Northeasterly right-of-way line of said railroad and the point of beginning of the tract herein described; thence North 47 degrees 16 minutes West along said right-of-way line a distance of 232.43 feet to the Southeasterly right-of-way line County Road No. 50; thence North 37 degrees 16 minutes East along last mentioned right-of-way line a distance of 250 feet; thence South 47 degrees 57 minutes East 535.26 feet; thence South 39 degrees 45 minutes West 248.14 feet to said railroad right-of-way line; thence Northwesterly along said railroad right-of-way line and on a curve to the right having a radius of 5629.65 feet a

distance of 292.08 feet to the point of tangency of said curve and the point of beginning.

PID # 29-119-24-43-0001 (approximately 1.65 acres)

Parcel 4

All that part of the Southeast quarter (SE 1/4) of Section 29, Township 119, Range 24, described as follows:

Commencing at a point on the West line of Northeast quarter of Southeast quarter (NE 1/4 of SE 1/4) lying 894.11 feet South of the North line of Said Southeast quarter (SE 1/4); thence North along said line to the southerly line of the intersection of County Road 50 and State Highway 55; thence westerly along said line to the southeasterly line of County Road 50; thence southwesterly along said line to a point 250 feet northeasterly, measured along said line, from its intersection with the northeasterly line of Minneapolis, St. Paul and S. St. Marie R. R.; thence South 47° 57" East 535.26 feet; thence North 39° 45" East to the southwesterly line of State Highway No. 55; thence northwesterly along said line to a point bearing North 39° 49" East from the point of beginning; thence to point of beginning.

PID # 29-119-24-44-0003 (approximately .27 acres)

3. That the above-described properties are contiguous with and abut the respective City limits of Greenfield and Rockford, and the parties hereto agree that the concurrent detachment and annexation as outlined above will better serve both Cities and the property owners with the reconfigured boundaries as outlined above.

4. That both the City of Rockford and the City of Greenfield agree that no consideration by Minnesota Planning, Municipal Boundary Adjustments is necessary and that upon receipt of this joint resolution, passed and adopted by each party, Minnesota Planning, Municipal Boundary Adjustments, may review and comment, but shall, within thirty (30) days, order the detachment and annexation in accordance with the terms of this joint resolution.

5. That the City of Rockford and the City of Greenfield, upon passage of this joint resolution, and upon acceptance by Minnesota Planning, Municipal Boundary Adjustments, confer jurisdiction upon Minnesota Planning, Municipal Boundary Adjustments, so as to accomplish said concurrent detachment and annexation of the incorporated lands herein described.

6. That the properties in both Rockford and Greenfield are zoned similarly; that the property in Greenfield is zoned commercial/industrial and the property in Rockford is zoned industrial; that the detachment and annexation of these lands will not change or alter the permissible use of the subject properties.

Approved by the City of Greenfield this 6 day of February, 2001.

CITY OF GREENFIELD

By: Thomas Swanson
Mayor

Wesley Rasmussen
Administrator

Approved by the City of Rockford this 27th day of February, 2001.

CITY OF ROCKFORD

By: Michael Stayer
Mayor

Nancy Ellis
Administrator

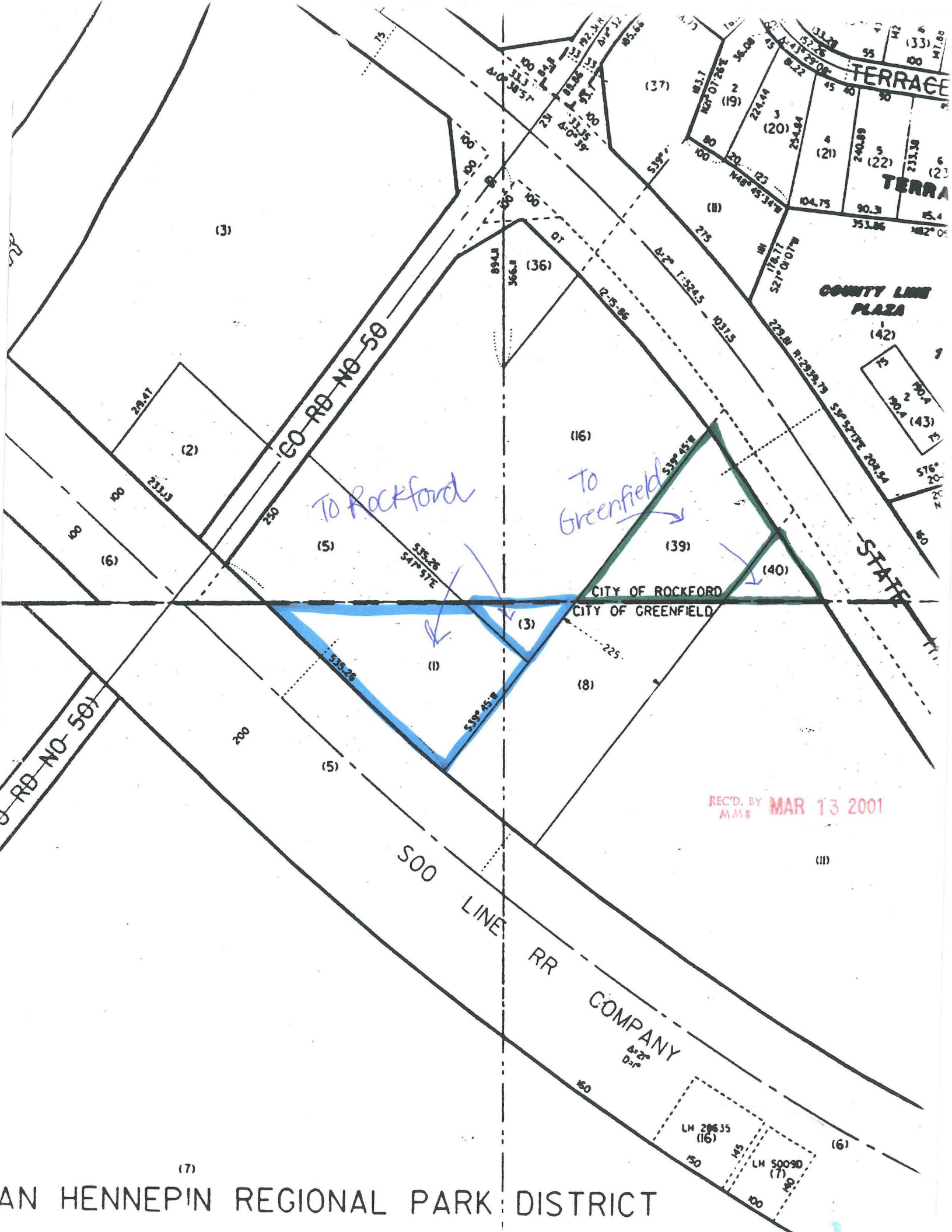

To Rockford

To Greenfield

REC'D. BY MAR 13 2001

AN HENNEPIN REGIONAL PARK DISTRICT