

SAMPLE PETITION FOR DETACHMENT OF PROPERTY FROM A CITY

IN THE MATTER OF THE PETITION FOR DETACHMENT OF
CERTAIN LAND FROM THE CITY OF SANDSTONE, MINNESOTA
PURSUANT TO MINNESOTA STATUTES 414.06

TO: Minnesota Municipal Board
225 Bandana Square
1021 Bandana Boulevard East
St. Paul, Minnesota 55108

PETITIONERS STATE: The number of petitioners required by M.S. 414.06, Subd. 1, to commence this proceeding is: all of the property owners if the area is less than 40 acres; or 75% or more of the property owners in number if the area is more than 40 acres.

It is hereby requested by:

X all of the property owners, the area is less than 40 acres; or
75% or more of the property owners, the area is more than 40
acres;

to detach certain properties described herein from the City of
SANDSTONE and make a part of the Township of SANDSTONE.

1. There are 1 property owners in the area proposed for detachment.
2. 1 property owners have signed this petition. (If the land is owned by both the husband and wife, both must sign the petition to represent all owners.)
3. The property is situated within the City of SANDSTONE, abuts the municipal boundary and the boundary of the Township of SANDSTONE, in the County of PINE.

The petitioned area abuts on the city's N S W (circle one) boundary(ies).

4. The property proposed for detachment is rural in character and not developed for urban residential, commercial, or industrial purposes.
5. The number of acres in the property proposed for detachment is 20 and is described as follows:

(INSERT COMPLETE AND ACCURATE LEGAL DESCRIPTION)
(Do Not Use Description From Property Tax Statements)

6. The reason detachment is requested is CITY REFUSES TO FIX ROAD, WE RECEIVE NO BENEFITS
7. The number of residents in the area proposed for detachment is 2. (The number of residents is not necessarily the same as number of owners.)

8. The number and character of buildings on said property is: SINGLE FAMILY DWELLING AND A STORAGE BUILDING

9. Public improvements on said property are: NONE

Date: 10/23/97

[Signature]
Property Owner

Property Owner

ADDITIONAL REQUIREMENTS:

- A. A filing fee of \$5 per acre with a minimum of \$100 and a maximum of \$600 must accompany the petition to the Minnesota Municipal Board.
- B. A map must also accompany the petition to the Municipal Board. This must be a map showing the property proposed for consideration and its relationship to any surrounding municipality.
- C. Property description: All distance references should be given in length. Beginning points should be land survey monuments and the description must close the boundaries. References to roads or railroads should be to survey lines such as centerline or known right-of-way line. The intent to include or exclude highway, railroad, and street right-of-ways surrounding platted blocks or lots should be clearly stated.

SAMPLE CITY RESOLUTION FOR DETACHMENT OF PROPERTY FROM A CITY

RESOLUTION OF THE CITY OF _____
FOR DETACHMENT OF CERTAIN LAND PURSUANT TO M.S. 414.06

(The language in the following paragraph is used when the city requests or supports the detachment:

The City of _____ hereby requests by resolution the Minnesota Municipal Board to detach certain properties described herein from the City of _____ and make a part of the Township of _____.

(Insert statements 3 through 9, including the legal description, shown on sample petition.)

Date: _____

Mayor

City Clerk

No.

Abstract of Title

TO

$\frac{1}{2}$ of NE $\frac{1}{4}$ of SE $\frac{1}{4}$, Sec. 10,

Twp. 42, Range 20.

Maude Newman

COMPLETE ABSTRACTS OF TITLE
TO ALL LANDS AND TOWN LOTS
IN THIS COUNTY

**PINE COUNTY
ABSTRACT COMPANY**

PINE CITY, MINNESOTA

RESOLUTION 97-16

**RESOLUTION OF THE CITY OF SANDSTONE
FOR DETACHMENT OF CERTAIN LAND
PURSUANT TO M.S. 414.06
(Mun. Board Docket # _____)**

The City of Sandstone hereby requests by resolution the Minnesota Municipal Board to detach certain properties described herein from the City of Sandstone and make a part of the Township of Sandstone.

WHEREAS, the property is situated within the City of Sandstone and abuts the municipal boundary and the boundary of the Township of Sandstone, in the County of Pine.

The petitioned area abuts on the city's east boundary

WHEREAS, the property proposed for detachment is rural in character and not developed for urban residential, commercial or industrial purposes and no municipal improvements have been extended to the area, and the city has no immediate plans to extend water and sewer or improved streets to this area;

WHEREAS, the number of acres in the property proposed for detachment is 20 and is described as follows:

The North 1/2 of the Northeast 1/4 of the Southeast 1/4 of Section 10, Township 42, Range 20.

WHEREAS, the land is not needed for reasonably anticipated future development;

WHEREAS, the population of the area is one (1).

NOW THEREFORE, be it resolved that the City of Sandstone, in agreement with the property owners of the above described land, requests that the Minnesota Municipal Board hereby grant the detachment of the above-described premises from the corporate limits of the City of Sandstone, Pine County, Minnesota.

Dated:

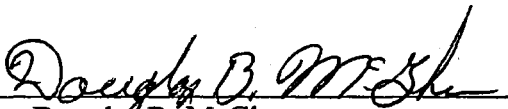

Douglas B. McGhee
Mayor

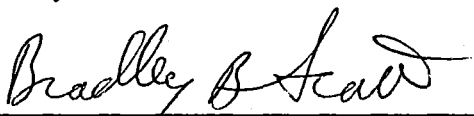

Bradley B. Scott
City Administrator

WEST PART SANDSTONE EAST PART DELL GROVE

T.42N.-R.20W.

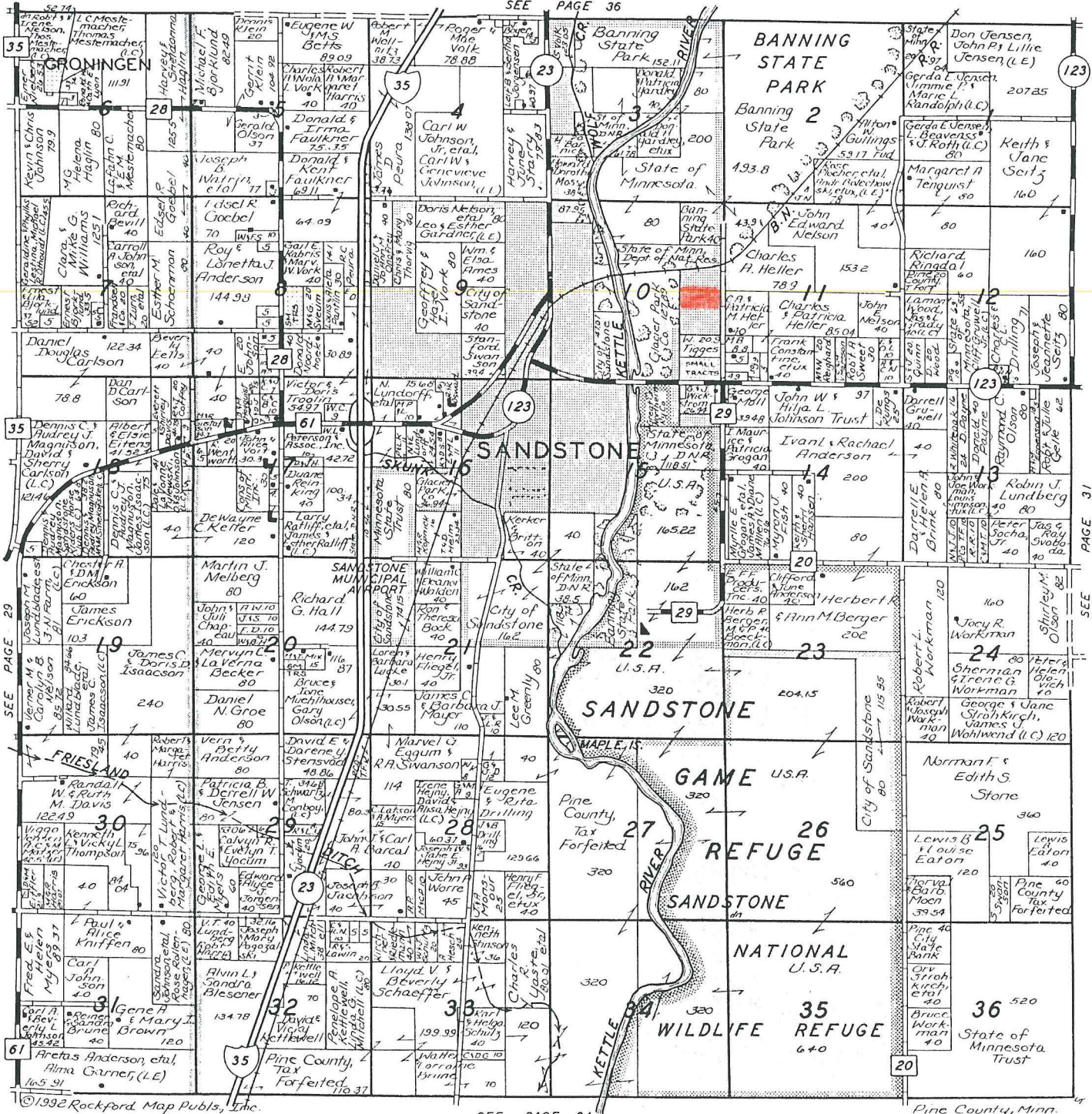

D-353
12-5-97

©1992 Rockford Map Pubs, Inc.

DELL GROVE TWP. ← SANDSTONE TWP.

SEE PAGE 24

PAGE 31



FIRST NATIONAL BANK
OF THE NORTH



Sandstone Office ... (612) 245-5261
 Askov Office (612) 838-3131
 Kerrick Office (218) 496-5515
 St. Paul Office (612) 772-2541

NORTH PINE
REAL ESTATE INC.

Sandstone Office:
 (612) 245-5263
 Askov Office:
 (612) 838-3133