

**CITY OF MAPLE GROVE
RESOLUTION NO. 97-074**

**A RESOLUTION AUTHORIZING THE DETACHMENT AND ANNEXATION OF
CERTAIN PROPERTY TO ADJUST THE BOUNDARY BETWEEN THE CITY OF
CORCORAN AND THE CITY OF MAPLE GROVE**

WHEREAS, the owners of certain property located in the City of Corcoran wish to attach to the Maple Grove water and sewer systems; and

WHEREAS, the area in question is accessible only by passing through Maple Grove; and

WHEREAS, the land is contiguous to the City of Maple Grove; and

WHEREAS, the needed services cannot be provided by the City of Corcoran; and

WHEREAS, the cities of Corcoran and Maple Grove are both in favor of the detachment of said property from Corcoran and its Annexation to Maple Grove; and

WHEREAS, Exhibit A to this resolution shows the existing municipal boundary between the Cities of Corcoran and Maple Grove in the Appaloosa Woods Subdivision; and

WHEREAS, Exhibit B to this resolution identifies the parcel to be detached and annexed; and

WHEREAS, Exhibit C depicts the new proposed municipal boundary between the Cities of Corcoran and Maple Grove after the boundary adjustment; and

WHEREAS, The City Council of the City of Maple Grove deems it desirable and in the best interest of the City to adjust the boundary between the City of Corcoran and the City of Maple Grove

NOW, THEREFORE BE IT RESOLVED by the City Council of the City of Maple Grove that it desires to annex the area described in Exhibit B; and

BE IT FURTHER RESOLVED that the City staff is authorized to request the State of Minnesota Municipal Board to issue an order implementing the annexation of the area described in Exhibit B and that the Mayor and City Clerk are hereby authorized to execute any documents necessary to accomplish the annexation proceedings.

Motion for the foregoing Resolution was made by Councilmember Sargent and seconded by Councilmember Koski and upon a vote being duly taken thereon, the following voted in favor thereof: Mayor Burlingame, Councilmembers Sargent, Koski, Burtness, Steffenson

REC'D. BY MAR 26 1997

and the following were against: None

and the following were absent: None

WHEREUPON, the Resolution was declared duly passed and adopted the **24th** day of **March**, 1997.

STATE OF MINNESOTA)
COUNTY OF HENNEPIN) SS.
CITY OF MAPLE GROVE)

I, the undersigned, being the duly qualified and acting Deputy City Clerk of the City of Maple Grove, Hennepin County, Minnesota, hereby certify that the above and foregoing Resolution No. **97-074** is a true and correct copy of the Resolution as adopted by the City Council of the City of Maple Grove on the **24th** day of **March**, 1997.

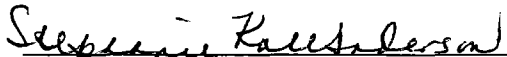
Stephanie Koll Anderson, Deputy City Clerk

REC'D MAY 26 1997

RESOLUTION NO. 1997 - 22

A RESOLUTION AUTHORIZING THE DETACHMENT AND ANNEXATION OF CERTAIN PROPERTY TO ADJUST THE BOUNDARY BETWEEN THE CITY OF CORCORAN AND THE CITY OF MAPLE GROVE

WHEREAS, the owners of certain property located in the City of Corcoran wish to attach to the Maple Grove water and sewer systems; and

WHEREAS, the area in question is accessible only by passing through Maple Grove; and

WHEREAS, the land is contiguous to the City of Maple Grove; and

WHEREAS, the needed services cannot be provided by the City of Corcoran; and

WHEREAS, the cities of Corcoran and Maple Grove are both in favor of the detachment of said property from Corcoran and annexation to Maple Grove; and

WHEREAS, Exhibit A to this resolution shows the existing municipal boundary between the cities of Corcoran and Maple Grove in the Appaloosa Woods Subdivision; and

WHEREAS, Exhibit B to this resolution identifies the parcel to be detached and annexed; and

WHEREAS, Exhibit C depicts the new proposed municipal boundary between the Cities of Corcoran and Maple Grove after the boundary adjustment; and

WHEREAS, the City Council of the City of Corcoran deems it desirable and in the best interest of the City to adjust the boundary between the City of Corcoran and the City of Maple Grove.

NOW, THEREFORE BE IT RESOLVED, by the City Council of the City of Corcoran that it desires to detach the area described in Exhibit B; and

BE IT FURTHER RESOLVED that the City staff is authorized to request the State of Minnesota Municipal Board to issue an order implementing the detachment of the area described in Exhibit B and that the Mayor and City Clerk are hereby authorized to execute any documents necessary to accomplish the detachment proceedings.

Moved by member Kluck, seconded by member Mayers.

The following voted in favor of said resolution: Mayor Larkin, Council members Kluck, Lindsley, Mayers.

The following voted against the same: None.

Whereupon said Resolution was declared carried.
Dated this 13th day of March, 1997.

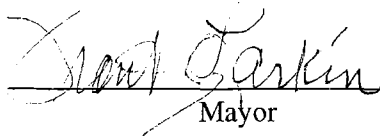

Mayor

ATTEST:

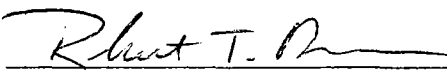

City Administrator

EXHIBIT "A"

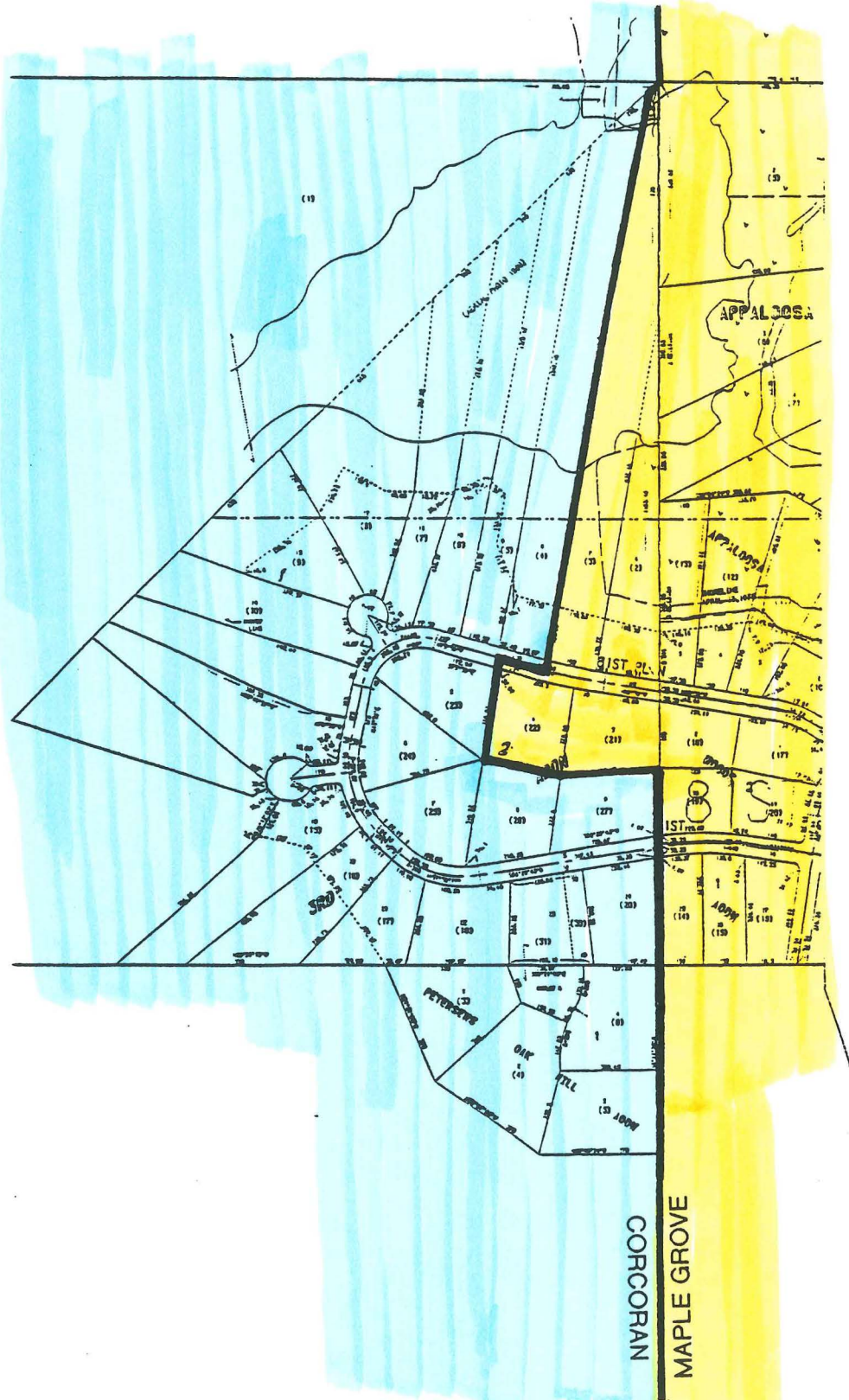

**EXISTING BOUNDARY BETWEEN
CORCORAN AND MAPLE GROVE**

EXHIBIT "B"**CORCORAN TO MAPLE GROVE ANNEXATION
PROPERTY DESCRIPTION**

Commencing at the northeast corner of Lot 9, Block 1, Appaloosa Woods 3rd Addition, Hennepin County, Minnesota and point of beginning; thence southwesterly along the east line of said Lot 9, Block 1 to the centerline of 81st Place North; thence southeasterly along said centerline to the point of intersection of the centerline of 81st Place North and the northeasterly extension of the east line of Lot 5, Block 2, Appaloosa Woods 3rd Addition; thence southwesterly along said extension and the easterly line of Lot 5, Block 2, to the southeast corner of Lot 5, Block 2; thence southwesterly along the south line of Lot 6, Block 2, Appaloosa Woods 3rd Addition to the centerline of 81st Place North; thence northerly along said centerline to the intersection of the centerline of 81st Place North and the southeasterly extension of the south line of Lot 15, Block 1, Appaloosa Woods 3rd Addition; thence northwesterly along said extension and the southerly line of Lot 15, Block 1 to the southwest corner of said Lot 15, Block 1; thence northeasterly along the west line of said Lot 15, Block 1 to the northwest corner of Lot 15, Block 1; thence southeasterly along the north line of said Lot 15, Block 1, to the centerline of 81st Place North; thence northeasterly along said centerline to the intersection of 81st Place North and the southeasterly extension of the centerline of a cul-de-sac to the northwest; thence northwest along said southwesterly extension and the cul-de-sac centerline to the center point of said cul-de-sac; thence northwesterly to the southwest corner of Lot 12, Block 1, Appaloosa Woods 3rd Addition; thence northwesterly along the southwest line of said Lot 12, Block 1, to the northwest corner of Lot 12, Block 1; thence northeasterly along said northwest line of Lot 12, Block 1 to the northeast corner of Lot 11, Block 1, Appaloosa Woods 3rd Addition; thence southwesterly along the east line of said Lot 11, Block 1 to the centerline of 81st Place North; thence easterly along said centerline to the intersection of the southwesterly extension of the west line of Lot 9, Block 1, Appaloosa Woods 3rd Addition; thence northeasterly along said extension and the west line of Lot 9, Block 1 to the northwest corner of Lot 9, Block 1; thence northeasterly along the northwest line of said Lot 9, Block 1 to the point of beginning.

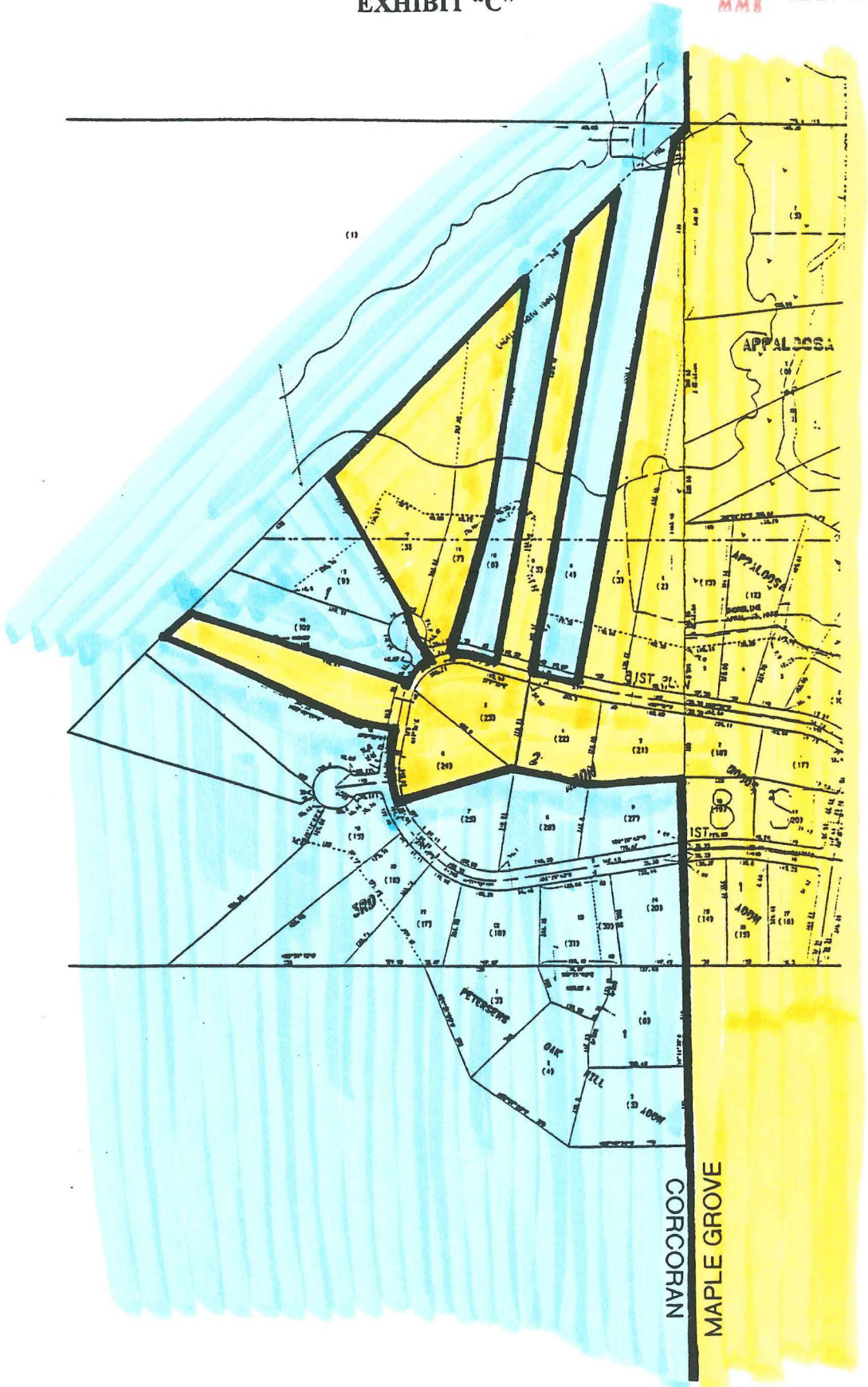

**PROPOSED BOUNDARY BETWEEN
CORCORAN AND MAPLE GROVE**