

IN THE MATTER OF THE PETITION BY ALL OF THE
PROPERTY OWNERS FOR THE CONCURRENT
DETACHMENT AND ANNEXATION OF CERTAIN LAND
PURSUANT OT MINNESOTA STATUTES §414.061, SUBD. 5

TO: Minnesota Municipal Board
475 McColl Building
366 Jackson Street
St. Paul, Minnesota 55101-1925

We, the undersigned, being all of the property owners of the following described land, hereby request the Minnesota Municipal Board to detach said property from the City of OTSEGO and annex it to the City of ALBERTVILLE, Pursuant to Minnesota Statutes §414.061, Subd. 5:

See Attached Exhibit A for property description.

In bringing forward this petition, the petitioners state that:

1. There is one property owner in the area proposed for detachment/annexation.
2. The property is presently within the City of Otsego and abuts the City of Albertville on its South and East Boundary, in the County of Wright.
3. The property proposed for detachment/annexation is 19.5 acres.
4. This boundary adjustment is being requested because:
 - A. Municipal sewer and water services are required to develop this area due to its close proximity to School Lake, Mud Lake and Otsego Creek. The City of Otsego does not have any municipal sewer or water systems available in this area. However, the City of Albertville can provide municipal services for this area.
 - B. Concurrent detachment/annexation of the property will provide a rational and natural border between Otsego and Albertville by utilizing the current road way of 70th Street N.E.

Date: 1-8-96

BALFANY DEVELOPMENT Inc.
Property Owner

By: M.C. Balfany Its: APES

REC'D. BY
M M R JAN 17 1996

EXHIBIT A

BELFANY DEVELOPMENT, INC.

PID#: 118-800-362100

All that part of Government Lot 3 except the north 32 rods thereof, situated in Section 36,
Township 121, Range 24, Wright County, Minnesota.

REC'D. BY JAN 17 1996
M M R

**CITY OF ALBERTVILLE
COUNTY OF WRIGHT
STATE OF MINNESOTA**

RESOLUTION NO. 1996-3

**SUPPORTING THE BALFANY DEVELOPMENT, INC.
CONCURRENT DETACHMENT/ANNEXATION REQUEST**

At a regular meeting of the City Council of the City of Albertville held on January 2, 1996, at the Albertville City Hall, 5975 Main Avenue NE, Albertville, Minnesota, with the following members present: Mayor Michael Potter, Councilmembers Sharon Anderson, Curt Muyres, Duane Berning and John Vetsch

WHEREAS, the owners of the properties described herein have expressed a desire to have their property detached from the City of Otsego and annexed to the City of Albertville; and

WHEREAS, Minnesota Statute 414.061, Subd. 5, requires that one of the affected cities must adopt and file a resolution supporting the request with the Minnesota Municipal Board; and

WHEREAS, the City of Albertville is ready and able to supply the property described herein with all the municipal services it presently supplies to all properties in the city.

NOW, THEREFORE, BE IT RESOLVED by the City Council of the City of Albertville, Wright County, Minnesota, that the City of Albertville hereby supports the detachment of the following described property from the City of Otsego for annexation to the City of Albertville:

BALFANY DEVELOPMENT, INC.

PID#: 118-800-362100

All that part of Government Lot 3 except the north 32 rods thereof, situated in Section 36, Township 121, Range 24, Wright County, Minnesota.

NOW, THEREFORE, BE IT FURTHER RESOLVED by the City Council of the City of Albertville, that:

1. The City of Albertville is ready and able to supply the property described herein with all the municipal services it presently supplies to all properties in the City.

REC'D BY JAN 17 1996
M.M.C.

2. The City of Albertville supports the concurrent detachment and annexation.
3. The City Clerk is directed to file a copy of this resolution with the Minnesota Municipal Board.

Voting in Favor: Potter, Anderson, Muyres, Berning and Vetsch

Voting Against: None

PASSED BY THE CITY COUNCIL THIS 2nd DAY OF JANUARY, 1996.

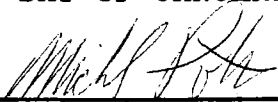

Michael Potter, Mayor

Attest:



Linda Houghton, City Clerk

RECEIVED BY JAN 17 1996
M M E



Subject Property



Other Current Petitioners



Current Border



Proposed New Border

N.1/2, SEC. 35, T. 121, R. 24

N.1/2, SEC. 36, T. 121, R. 24

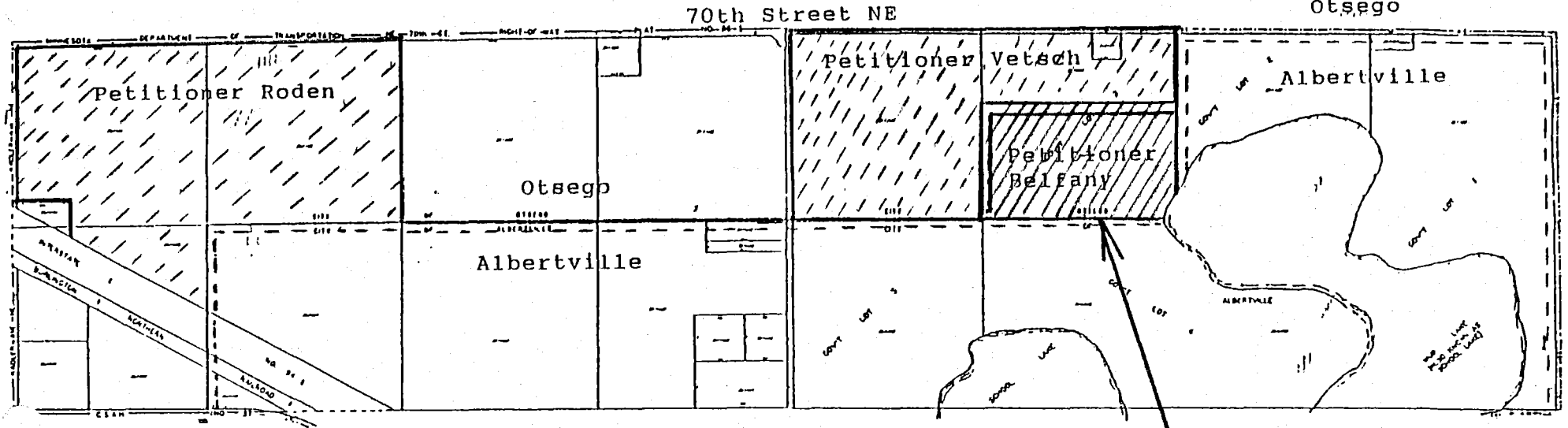

Subject Property 19.5 Acres