

REC'D. BY JAN 03 1995  
M M R

TO: Minnesota Municipal Board  
165 Metro Square Building  
St. Paul, Minnesota 55101

IN THE MATTER OF THE PETITION BY ALL OF THE PROPERTY OWNERS  
FOR THE CONCURRENT DETACHMENT AND ANNEXATION OF  
CERTAIN LAND PURSUANT TO MINNESOTA STATUTES  
SECTION 414.061, SUBDIVISION 5

Joint Petition

1. We, the undersigned, are all of the property owners of property legally described in Exhibits 1 and 2 attached hereto and incorporated herein (hereinafter referred to as the "Entire Property").
2. We, individually and jointly, request that the Minnesota Municipal Board detach the Entire Property from the City of Lake Elmo and annex the Entire Property to the City of Oakdale, pursuant to Minnesota Statutes Section 414.061, Subdivision 5.
3. We respectfully submit that the requested detachment and annexation of the Entire Property should be granted because of one or more of the following reasons:
  - a. The City of Oakdale is better qualified to provide municipal services to the Entire Property.
  - b. The City of Oakdale offers more extensive administrative services, full time police protection, and better fire protection.
  - c. The City of Oakdale has or is more likely soon to have available city water and sewer for the developable portions of the Entire Property.
  - d. The City of Oakdale is better prepared and qualified to provide planning, sewer and water for future development of the Entire Property.
  - e. The Entire Property is ready for immediate development and requires the services discussed above which only the City of Oakdale can provide now or in the near future.
  - f. The Entire Property is adjacent to other properties owned by the undersigned and the other properties which are located in the City of Oakdale cannot be logically developed, nor can the Entire Property be logically developed unless the Entire Property is annexed to the City of Oakdale.

- g. Other reasons as set forth in more detail in the applicable Minnesota Statutes and case law relating to concurrent detachment and annexation.
4. The Entire Property consists of Parcel 1 (as legally described in Exhibit 1) and Parcel 2 (as legally described in Exhibit 2). The Entire Parcel is 14.57 acres in total, more or less.
  5. The location of the Entire Property, consisting of Parcel 1 and Parcel 2, is shown generally on Exhibit 3 attached hereto.
  6. Parcel 1 is .3 acres presently within the City of Lake Elmo. The north, east and west sides abut the City of Oakdale in the County of Washington. Parcel 1 on the south abuts property which is presently within the City of Lake Elmo and which is owned by the State of Minnesota and is used by the public for 4th Street North.
  7. Parcel 2 is 14.27 acres presently within the City of Lake Elmo. The north, west and south sides abut the City of Oakdale in the County of Washington. Parcel 2 on the east side abuts property within the City of Lake Elmo which is owned by Washington County and is used by the public for County Road 13.

Parcel 1

Lake Elmo Properties, a Minnesota General  
Partnership

Date 12-22-94

By Bruce Haslend  
A General Partner

Triple E Limited Partnership, a Minnesota Limited  
Partnership

Date 12-22-94

By Bruce Haslend  
A General Partner

Parcel 2

Date Dec 22 1994

Richard A. Schiltgen  
Richard A. Schiltgen

Date 12/22/94

Marcelline A. Ingebrand  
Marcelline A. Ingebrand

Date 12-22-94

Marian Stevenson  
Marian Stevenson

Date 12-22-94

Donna Mae Hermann  
Donna Mae Hermann

The above are brothers and sisters.

Separate Petition as to Parcel 1

1. We, the undersigned, are all of the property owners of property legally described in Exhibit 1 attached hereto and incorporated herein (hereinafter referred to as "Parcel 1").
2. We, individually and jointly, request that the Minnesota Municipal Board detach Parcel 1 from the City of Lake Elmo and annex Parcel 1 to the City of Oakdale, pursuant to Minnesota Statutes Section 414.061, Subdivision 5.
3. We respectfully submit that the requested detachment and annexation of Parcel 1 should be granted because of one or more of the following reasons:
  - a. The City of Oakdale is better qualified to provide municipal services to Parcel 1.
  - b. The City of Oakdale offers more extensive administrative services, full time police protection, and better fire protection.
  - c. The City of Oakdale has or is more likely soon to have available city water and sewer for the developable portions of Parcel 1.
  - d. The City of Oakdale is better prepared and qualified to provide planning, sewer and water for future development of Parcel 1.
  - e. Parcel 1 is ready for immediate development and requires the services discussed above which only the City of Oakdale can provide now or in the near future.
  - f. Parcel 1 is adjacent to other properties owned by the undersigned and the other properties which are located in the City of Oakdale cannot be logically developed, nor can Parcel 1 be logically developed unless Parcel 1 is annexed to the City of Oakdale.
  - g. Other reasons as set forth in more detail in the applicable Minnesota Statutes and case law relating to concurrent detachment and annexation.
4. The location of Parcel 1 is shown generally on Exhibit 3 attached hereto.
5. Parcel 1 is .3 acres presently within the City of Lake Elmo. The north, east and west sides abut the City of Oakdale in the County of Washington. Parcel 1 on the south abuts property which is presently within the City of Lake Elmo and which is owned by the State of Minnesota and is used by the public for 4th Street North.

Parcel 1

Lake Elmo Properties, a Minnesota General Partnership

Date 12-22-94

By Bruce Hasleund  
A General Partner

Triple E Limited Partnership, a Minnesota Limited Partnership

Date 12-22-94

By Bruce Hasleund  
A General Partner

Separate Petition as to Parcel 2

1. We, the undersigned, are all of the property owners of property legally described in Exhibit 2 attached hereto and incorporated herein (hereinafter referred to as "Parcel 2").
2. We, individually and jointly, request that the Minnesota Municipal Board detach Parcel 2 from the City of Lake Elmo and annex Parcel 2 to the City of Oakdale, pursuant to Minnesota Statutes Section 414.061, Subdivision 5.
3. We respectfully submit that the requested detachment and annexation of Parcel 2 should be granted because of one or more of the following reasons:
  - a. The City of Oakdale is better qualified to provide municipal services to Parcel 2.
  - b. The City of Oakdale offers more extensive administrative services, full time police protection, and better fire protection.
  - c. The City of Oakdale has or is more likely soon to have available city water and sewer for the developable portions of Parcel 2.
  - d. The City of Oakdale is better prepared and qualified to provide planning, sewer and water for future development of Parcel 2.
  - e. Parcel 2 is ready for immediate development and requires the services discussed above which only the City of Oakdale can provide now or in the near future.
  - f. Parcel 2 is adjacent to other properties owned by the undersigned and the other properties which are located in the City of Oakdale cannot be logically developed, nor can Parcel 2 be logically developed unless Parcel 2 is annexed to the City of Oakdale.
  - g. Other reasons as set forth in more detail in the applicable Minnesota Statutes and case law relating to concurrent detachment and annexation.
4. Parcel 2 is 14.27 acres presently within the City of Lake Elmo. The north, west and south sides abut the City of Oakdale in the County of Washington. Parcel 2 on the east side abuts property within the City of Lake Elmo which is owned by Washington County and is used by the public for County Road 13.

Parcel 2

Date Dec 22, 1994

Richard A. Schiltgen  
Richard A. Schiltgen

Date 12/22/94

Marcelline A. Ingebrand  
Marcelline A. Ingebrand

Date 12/22/94

Marian Stevenson  
Marian Stevenson

Date 12-22-94

Donna Mae Hermann  
Donna Mae Hermann

The above are brothers and sisters.



REC'D. BY JAN 03 1995  
M M R

**EXHIBIT 1**

That part of Parcel 17, Minnesota Department of Transportation Right of Way Plat No. 82-17, as recorded in the Office of the Register of Deeds, Washington County, Minnesota as Document No. 312604 lying north of Parcel 7, Minnesota Department of Transportation Right of Way Plat No. 82-29, as recorded in the Office of the County Recorder, Washington County, Minnesota as Document No. 418783.

Containing 0.30 acres.

REC'D BY JAN 03 1995  
M M R

**EXHIBIT 2**

That part of the Northwest Quarter of the Southwest Quarter of Section 33, Township 29 North, Range 21 West lying east of the west 60.00 Rods thereof, platted as Parcel 16, State Highway Right of Way Plat No. 4 of 12 as recorded in the office of the Register of Deeds, Washington County, Minnesota as Document No. 296886.

together with,

That part of the Northeast Quarter of the Southwest Quarter of Section 33, Township 29 North, Range 21 West platted as Parcel 16, State Highway Right of Way Plat No. 4 of 12 as recorded in the office of the Register of Deeds, Washington County, Minnesota as Document No. 296886.

Containing 14.27 acres.

REC'D BY JAN 03 1995  
MMB



**EXHIBIT 3**

Area Map to be Provided by City.

REC'D BY JAN 03 1995  
M M R

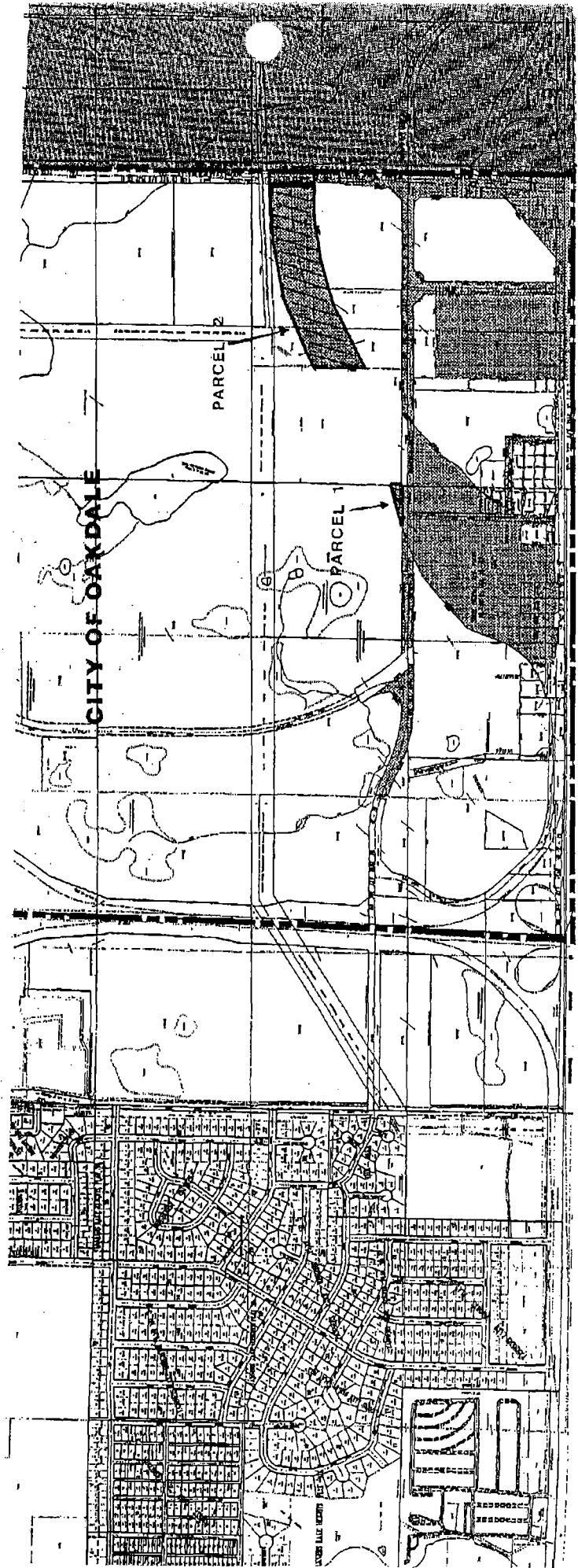
EXHIBIT 3



CITY OF OAKDALE   
PARCELS 1 & 2 

**City of Oakdale  
RESOLUTION NO. 94-228**

**SUPPORTING THE SCHILTGEN/ARCON ANNEXATION REQUEST.**

At a regular meeting of the City Council of the City of Oakdale held on Tuesday, December 27, 1994, at the Oakdale Municipal Building, 1584 Hadley Avenue North, Oakdale, Minnesota, with the following members present: Mayor Ted Bearth, Councilmembers Mari Moen, Pat O'Hara, Carmen Sarrack, and Sherry Timmermann, and the following absent: None, the Oakdale City Council resolved:

**WHEREAS**, the owners of the properties described herein have expressed a desire to have their property detached from the City of Lake Elmo and annexed to the City of Oakdale; and

**WHEREAS**, Minnesota Statute 414.061, Subd. 5, requires that one of the affected cities must adopt and file a resolution supporting the request with the Minnesota Municipal Board; and

**WHEREAS**, the City of Oakdale is ready and able to supply the property described herein with all the municipal services it presently supplies to all properties in the city.

**NOW, THEREFORE, BE IT RESOLVED** by the City Council of the City of Oakdale, Minnesota, that the City of Oakdale hereby supports the detachment of the following described property from the City of Lake Elmo for annexation to the City of Oakdale:

That part of Parcel 17, Minnesota Department of Transportation Right-of-way Plat No. 82-17, as recorded in the Office of the Register of Deeds, Washington County, Minnesota, as Document No. 312604, lying north of Parcel 7, Minnesota Department of Transportation Right-of-way Plat No. 82-29, as recorded in the Office of the County Recorder, Washington County, Minnesota, as Document No. 418783.

That part of the Northwest Quarter of the Southwest Quarter of Section 33, Township 29 North, Range 21 West, lying east of the west 60.00 rods thereof, platted as Parcel 16, State Highway Right-of-way Plat No. 4 of 12, as recorded in the Office of the Register of Deeds, Washington County, Minnesota, as Document No. 296886; together with, that part of the Northeast Quarter of the Southwest Quarter of Section 33, Township 29 North, Range 21 West, platted as Parcel 16, State Highway Right-of-way Plat No. 4 of 12, as recorded in the Office of the Register of Deeds, Washington County, Minnesota, as Document No. 296886.

**NOW, THEREFORE, BE IT FURTHER RESOLVED** by the City Council of the City of Oakdale, Minnesota, that:

1. The City of Oakdale is ready and able to supply the property described herein with all the municipal services it presently supplies to all properties in the City.

2. The City of Oakdale supports the concurrent detachment and annexation.
3. The City Clerk is directed to file a copy of this resolution with the Minnesota Municipal Board.

Voting in Favor: Mayor Bearth, Councilmembers: Moen, O'Hara, Sarrack, and Timmermann;

Voting Against: None.

Resolution duly seconded and passed this 27th day of December, 1994.

  
Ted Bearth, Mayor

Attest:

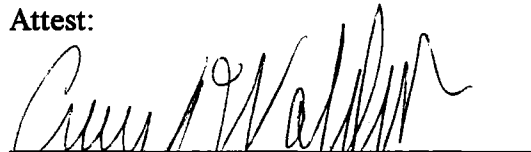
  
Craig A. Waldron, City Administrator

I, Susan Barry Deputy City Clerk  
for the City of Oakdale, do hereby  
certify that this is a true and  
correct copy of Resolution 94-228  
which is on file in the office of  
the City Clerk of the City of Oakdale  
1-3-95 Susan Barry