

CITY OF OAKDALE  
RESOLUTION NO. 90 - 213

A RESOLUTION REQUESTING THE MINNESOTA MUNICIPAL BOARD TO INITIATE ON ITS OWN MOTION, THE CONCURRENT DETACHMENT AND ANNEXATION TO OAKDALE, THE REMAINING PARCELS IN THE EAST 1/2 OF SECTION 32 AND WEST 1/2 OF SECTION 33, TOWNSHIP 29, RANGE 21, LOCATED WITHIN THE MUNICIPAL LIMITS OF THE CITY OF LAKE ELMO, WASHINGTON COUNTY, PURSUANT TO MINNESOTA STATUTES 414.061, SUBD. 4.

At a regular meeting of the City Council of the City of Oakdale held on Tuesday, November 27, 1990, at the Oakdale Municipal Building, 1584 Hadley Avenue North, Oakdale, Minnesota, with the following members present: Mayor Ted Bearth, Councilmembers Bill Lee, Pat Morris, Bev Peterson and Carmen Sarrack; and the following absent: None: The Oakdale City Council resolved:

WHEREAS, The Minnesota Municipal Board (MMB) approved the concurrent detachment and annexation of 523 acres from the City of Lake Elmo to the City of Oakdale, issued October 31, 1990, and effective November 7, 1990.

WHEREAS, isolated parcels remain in the east 1/2 of Section 32, and the west 1/2 of Section 33 that are now virtually surrounded by property in the City of Oakdale (see Exhibit "A").

WHEREAS, similar conditions exist between property already approved for detachment and annexation and that property remaining, including that concurrent detachment and annexation will provide for more effective and economical delivery of services of the affected municipalities.

WHEREAS, in keeping with the MMB ruling issued October 31, 1990, the remaining parcels should also become subject to concurrent detachment and annexation.

THEREFORE, BE IT RESOLVED, the City Council of the City of Oakdale that the Municipal Board is hereby requested to initiate by its own motion the concurrent detachment and annexation to Oakdale, the remaining parcels in the east 1/2 of Section 32 and the west 1/2 of Section 33, Township 29, Range 21, located within the municipal limits of the City of Lake Elmo, Washington County, pursuant to Minnesota Statutes 414.061, Subd. 4.

Voting in Favor: Mayor Bearth, Councilmembers Lee, Morris  
Peterson and Sarrack

Voting Against: None

RESOLUTION 90-213

Resolution duly seconded and passed this 27th day of November, 1990.

  
\_\_\_\_\_  
Ted Bearth, Mayor

ATTEST:  
  
\_\_\_\_\_  
Sharon G. Klumpp, City Administrator



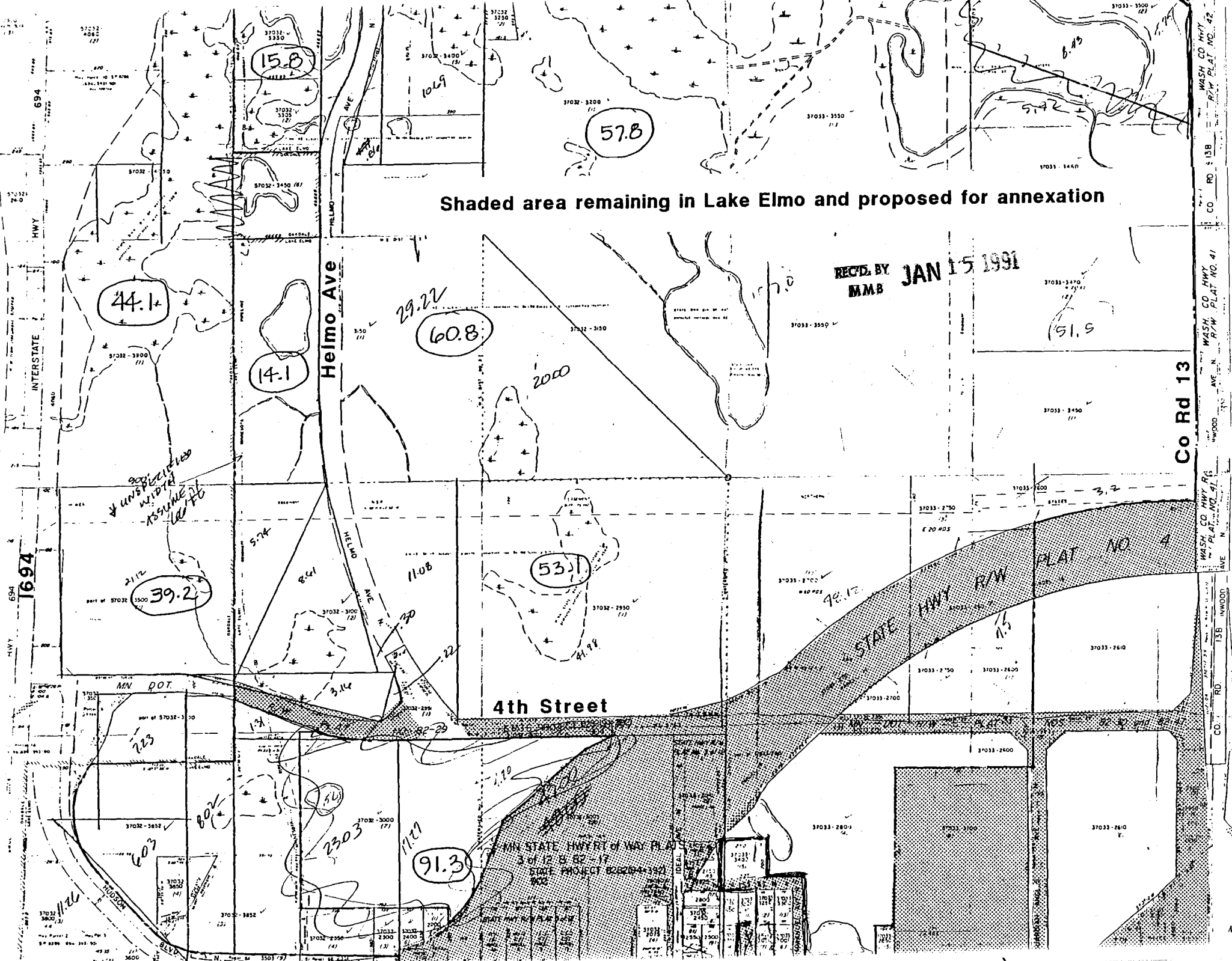

Shaded area remaining in Lake Elmo and proposed for annexation

REC'D. BY  
M.M.B. JAN 15 1991

Co Rd 13

4th Street

91.3

60.8

44.1

57.8

39.2

53.1

14.1

29.22

51.9

900' SPECIFIED  
WIDENING  
ASSUMED  
L&P

MINN STATE HWY R/W PLAT NO. 4  
3 of 12 B 82-17  
STATE PROJECT 822204-1921  
2002

WASH CO HWY R/W PLAT NO. 42  
WASH CO HWY R/W PLAT NO. 41  
WASH CO HWY R/W PLAT NO. 4  
WOOD AVE N  
INWOOD  
RD 13B  
RD 13A

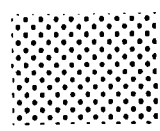
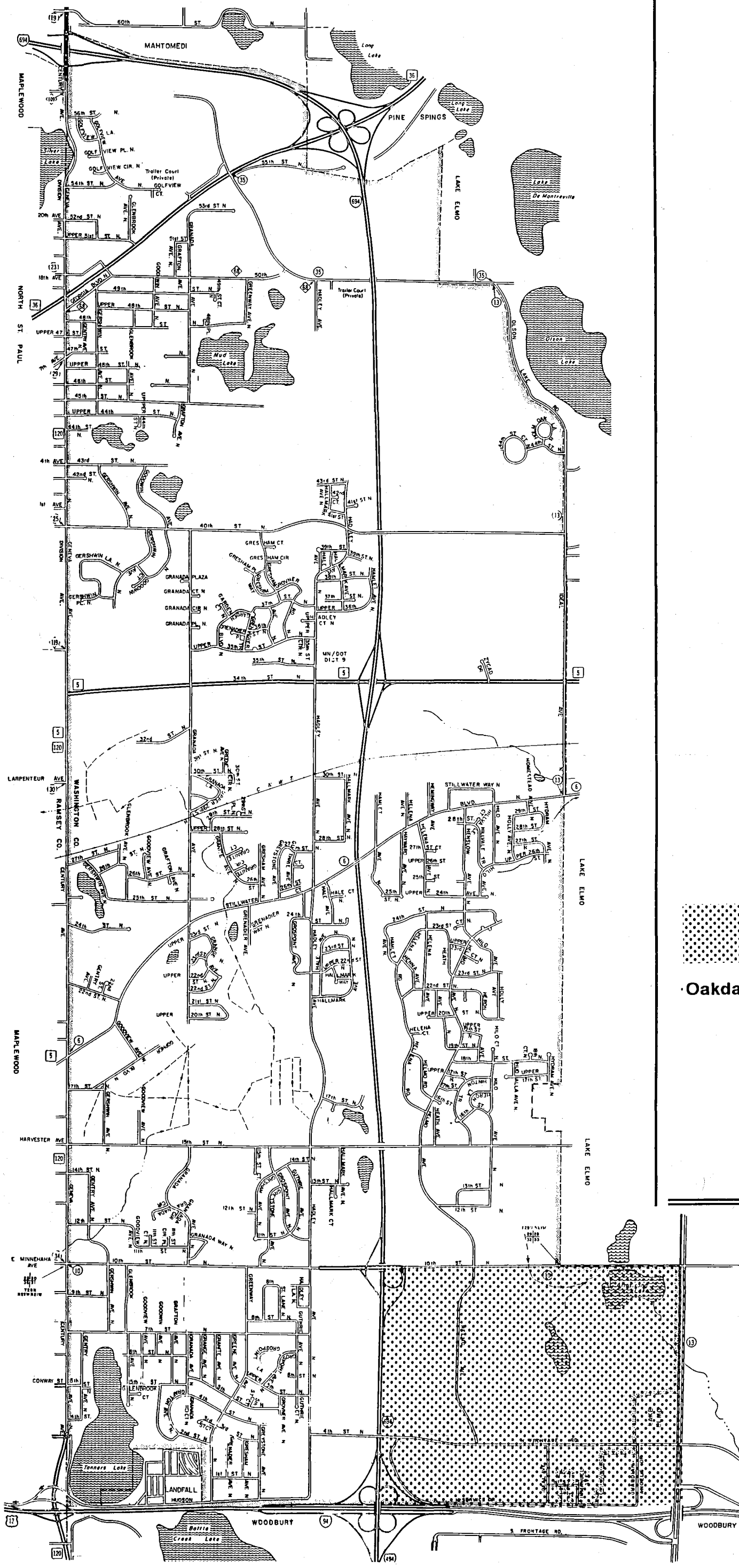

Annexation area -  
Oakdale/Lake Elmo boundary

REC'D BY  
MMB JAN 15 1991

# Oakdale Minnesota



SCALE IN FEET  
1000' 0' 1000' 2000'

Note: This map is for planning purposes only and should not be used when precise measurements are required.

Base map source: Minnesota Dept. of Transportation - 1989

Prepared By:  
**Northwest Associated Consultants, inc.**  
JUL 10-90