

**PROPERTY OWNER PETITION FOR ANNEXATION BY ORDINANCE
BY ORLAND J. ASPEN AND LINDA K. ASPEN, HUSBAND AND WIFE**

IN THE MATTER OF THE PETITION OF CERTAIN PERSONS FOR THE
ANNEXATION

OF CERTAIN LAND TO THE CITY OF FOSSTON, MINNESOTA
PURSUANT TO MINNESOTA STATUTES § 414.033, SUBD. 5

TO: Council of the City of Fosston, Minnesota

AND

Office of Administrative Hearings
Municipal Boundary Adjustment Unit
P. O. Box 64620
St. Paul, MN 55164-0620

PETITIONER(S) STATE: The property owner or a majority of the property owners in number are required to commence a proceeding under Minnesota Statutes § 414.033, Subd. 5.

It is hereby requested by:

- the sole property owner; or
 all of the property owners; or
 a majority of the property owners

of the area proposed for annexation to annex certain property described herein lying in the Town of Rosebud to the City of Fosston, County of Polk, Minnesota.

The area proposed for annexation is described as follows: **See attached Exhibit A.**

1. There are two property owners in the area proposed for annexation. (If a property owner owns more than one parcel in the area proposed for annexation, he/she is only counted once as an owner - the number of parcels owned by a petitioner is not counted.)
2. Two property owners have signed this petition. (If the land is owned by both husband and wife, both must sign the petition to represent all owners.)
3. Said property is: unincorporated, abuts on the city's N S E W boundaries, and is not included within any other municipality.
4. The area of land proposed for annexation is .07 of an acre and:
 Unplatted Platted
5. The reason for the requested annexation is because it is in the best interest of the City of Fosston.

6. The area proposed for annexation will be zoned residential.
7. All of the area proposed for annexation is or is about to become urban or suburban in character.
8. The area proposed for annexation is not included in any area that has already been designated for orderly annexation pursuant to Minnesota Statutes § 414.0325, nor in any other boundary adjustment proceeding pending before the Municipal Boundary Adjustment Unit of the Office of Administrative Hearings.

PETITIONERS' REQUEST: That pursuant to Minnesota Statutes § 414.033, the property described herein be annexed to and included within the City of Fosston, Minnesota.

Dated: 7/25/17

Signatures: Orland J. Aspen

Orland J. Aspen

Linda K. Aspen

Linda K. Aspen

NOTE: Pursuant to Minnesota Statutes § 414.033 and Minnesota Rules 6000.0800, the petition to the Office of Administrative Hearings must be accompanied by a certification showing that a copy of the petition was filed within 10 days after service on the annexing city to the affected township(s), county, and any other abutting municipality.

NOTE: Under Minnesota Statutes § 414.033, Subd. 5, if the petition is not signed by all of the property owners of the land proposed for annexation, the ordinance shall not be enacted until the municipal council has held a hearing on the proposed annexation after at least 30 days mailed notice to all property owners within the area to be annexed.

Municipal Boundary Adjustment Unit Contacts

Star Holman star.holman@state.mn.us 651-361-7909

Katie Lin katie.lin@state.mn.us 651-361-7911

(June 2011)

Petition for Annexation
Orland J. Aspen & Linda K. Aspen

EXHIBIT A

Commencing at the Northwest corner of Government Lot Four (4), Section Three (3), Township One Hundred Forty-seven (147) North, Range Forty (40) West, thence running South along the West line of Government Lot 4 a distance of 1,292.44 feet to a point, thence running East along a line having a bearing of S88°58'06"E a distance 412.71 feet to a point, thence running North along a line having a bearing of N01°00'28"W a distance of 220.14 feet to a point, thence running East along a line having a bearing of S88°57'53"E a distance of 145.09 feet to a point being the POINT OF BEGINNING, thence running South along a line having a bearing of S01°00'27"E a distance of 220.14 feet to a point, thence running East along a line having a bearing of S88°57'53"E a distance of 12 feet to a point, thence running North to a point being 17 feet Easterly of the point of beginning, thence Westerly to the point of beginning.

MUNICIPALITIES OF
POLK CO.

PREPARED BY THE
MINNESOTA DEPARTMENT OF TRANSPORTATION
OFFICE OF TRANSPORTATION DATA & ANALYSIS
IN COOPERATION WITH
U.S. DEPARTMENT OF TRANSPORTATION
FEDERAL HIGHWAY ADMINISTRATION

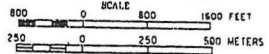

2010
BASIC DATA - 2009

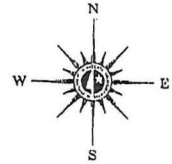

LEGEND

- INTERSTATE TRUNK HIGHWAY.....(I)
- U.S. TRUNK HIGHWAY.....(U)
- STATE TRUNK HIGHWAY.....(S)
- COUNTY STATE AID HIGHWAY.....(C)
- COUNTY ROAD.....(R)
- PUBLIC ROAD.....(P)
- PRIVATE ROAD.....(PR)
- CORPORATE LIMITS.....(CL)

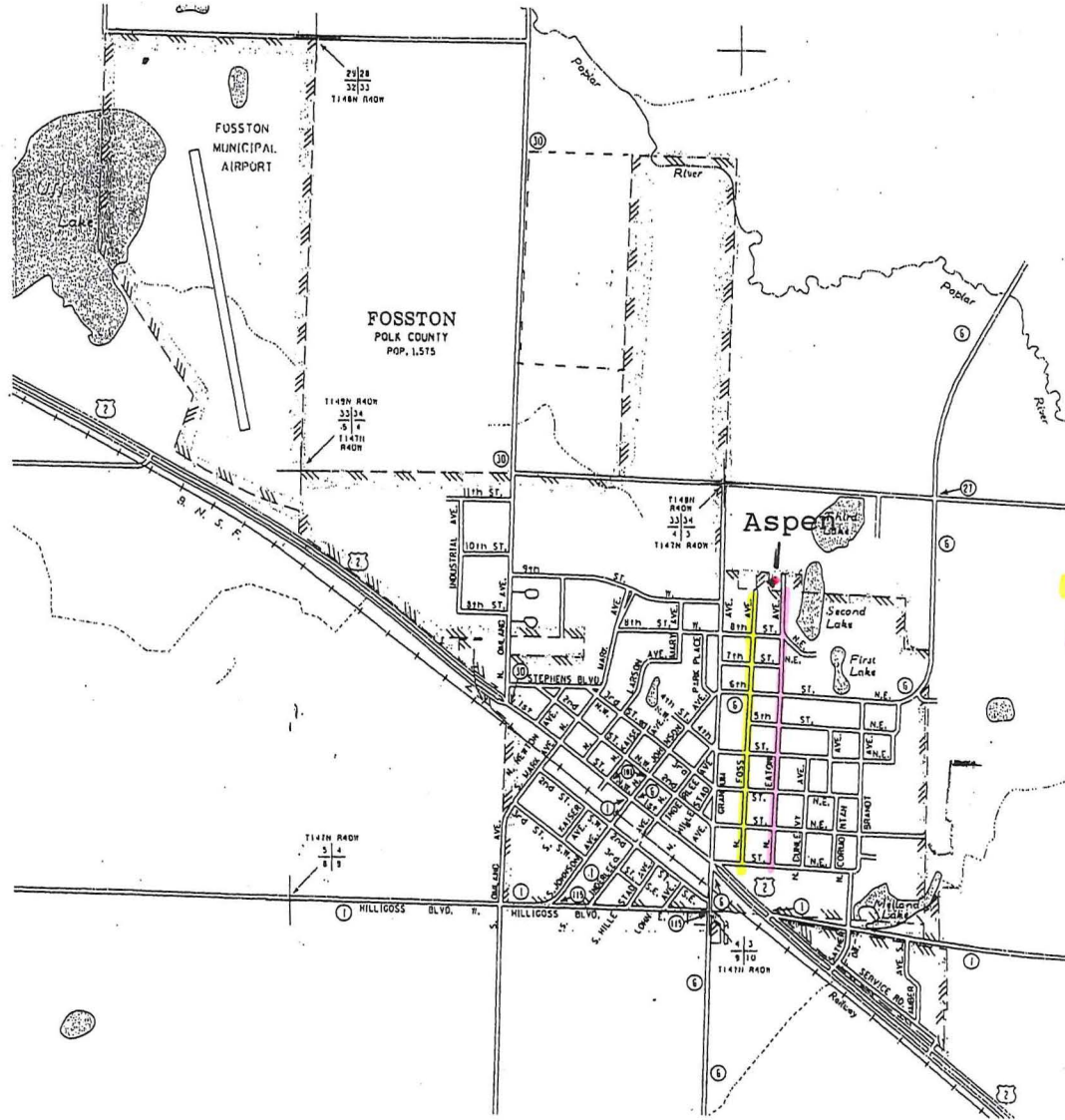

Foss
Eaton

MUNICIPALITIES SHOWN
ON THIS SHEET
BELTRAMI
FOSSTON

To request information from this document in an alternative format, call 800-551-7273 or 651-281-7273. If you are hearing impaired, call 1-800-551-7273 (TDD/Relay Minnesota). You may also visit an alternate format request at: www.dhs.gov. (Please request at least two weeks in advance.)

NOTE: 2000 U.S. CENSUS FIGURES SHOWN FOR ALL MUNICIPALITIES UNLESS OTHERWISE STATED.

Polk County

Zoom In Zoom Out Pan Zoom Prev Zoom Next Zoom Select Zoom Extent Clear Search Identify Street View Legend

Navigation Commands

1 Items

Parcel_ID	Document Type	Document Number	Document Type 2	Document Number 2	Document Type 3
X 61.00032.03	Quit Claim Deed				

*This ship is
Parcel # 61.00032.03
deeded from Melbo to Aspen
in 2015*

REC'D BY
MBA

AUG 04 2017

Scale 1: 1000 X: 653439.815 Y: 131611.6786

IN THE MATTER OF THE ANNEXATION
PETITION OF:

AFFIDAVIT OF SERVICE BY U.S.
MAIL

Orland J. Aspen and Linda K. Aspen

STATE OF MINNESOTA)
) §
COUNTY OF POLK)

The undersigned being first duly sworn, says that a copy of the following:

Petition for Annexation of Orland J. Aspen and Linda K. Aspen

was served upon:

Ms. Cheryl Winkelmann
Rosebud Town Clerk
33435 410th Street Southeast
Fosston, MN 56542

All in accordance with the Rules of Civil Procedure of the State of Minnesota by enclosing the same in an envelope addressed as indicated, with postage fully prepaid, and by depositing said envelope(s) in a United States Postal Service mailbox in Fosston, Minnesota on August 2, 2017.

Amber Hildebrandt

Subscribed and sworn to before me, a notary public in and for the County of Polk, State of Minnesota, on August 2, 2017.

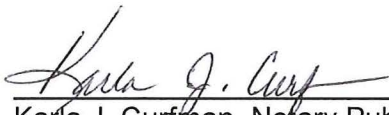

Karla J. Curfman, Notary Public