

RECEIVED

by OAH on 10/27/16

AMENDED ORDINANCE NO. 1086

**AN ORDINANCE OF THE CITY OF STILLWATER, MINNESOTA
ANNEXING LAND LOCATED IN STILLWATER TOWNSHIP,
WASHINGTON COUNTY, MINNESOTA PURSUANT TO
MINNESOTA STATUTES § 414.033 SUBDIVISION 2(2)
PERMITTING ANNEXATION BY ORDINANCE**

WHEREAS, the Stillwater Country Club is the fee owner of a parcel of real property and which is legally described in the Exhibit A attached hereto and incorporated herein, (the “Property”); and

WHEREAS, the Property is unincorporated and is completely surrounded by land within the municipal limits of the City of Stillwater; and

WHEREAS, said property is not located within a flood plain or shoreland area; and

WHEREAS, the City Council of the City of Stillwater held a public hearing on this matter on March 22, 2016 at 7:00 p.m. Written notice of the public hearing was given by certified mail to the Property owners, the Township of Stillwater, and all landowners contiguous to the Property; and

WHEREAS, provisions of Minnesota Statutes § 414.033 Subd. 13 are not applicable in that there will be no change in the electric utility service provider resulting from the annexation of the territory to the municipality.

**NOW, THEREFORE, THE CITY COUNCIL OF THE CITY OF STILLWATER
HEREBY ORDAINS AS FOLLOWS:**

1. The City Council hereby determines that the Property as hereinafter described is completely surrounded by land within the municipal limits of the City of Stillwater and is therefore urban or suburban in character or about to become so.

2. None of the Property is now included within the limits of any city, or in any area that has already been designated for orderly annexation pursuant to Minnesota Statutes § 414.0325.

3. The corporate limits of the City of Stillwater, Minnesota, are hereby extended to include the Property described in Exhibit A attached hereto and incorporated herein by reference.

The Property consists of a total of 0.541 of an acre, more or less. A copy of the corporate boundary map showing the Property to be annexed and its relationship to the corporate boundaries is attached hereto as Exhibits B and C.

4. That the population of the area legally described and hereby annexed is zero.

5. The 2016 property taxes for the Property were in the amount of \$206.00. The City of Stillwater, pursuant to Minnesota Statutes § 414.036, that with respect to the property taxes payable on the Property legally described herein, hereby annexed, shall make a cash payment to Stillwater Township in accordance with the following schedule: \$206.00 due and payable in two annual installments to the Stillwater Township on or before December 31 of each year.

6. That pursuant to Minnesota Statutes § 414.036 there are no special assessments or debt incurred by the Town on the subject are for which reimbursement is required.

7. That the City Administrator of the City of Stillwater is hereby authorized and directed to file a copy of this Ordinance with the Municipal Boundary Adjustment Unit of the Office of Administrative Hearings, the Minnesota Secretary of State, the Washington County Auditor, and the Stillwater Township Clerk.

8. That this Ordinance shall be in full force and effect and final upon the date this Ordinance is approved by the Office of Administrative Hearings.

PASSED AND ADOPTED by the City Council of the City of Stillwater this 18th day of
October, 2016.

CITY OF STILLWATER

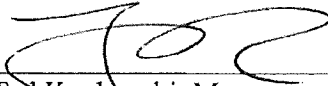

Ted Kozlowski, Mayor

ATTEST:

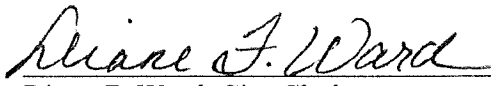

Diane F. Ward, City Clerk

EXHIBIT A

All that part of the West half of the NW $\frac{1}{4}$ of the SW $\frac{1}{4}$ Section 21 T 30 Range 20 lying East of the Northly extension of the East line of Owens Street extended to the North line of the NW $\frac{1}{4}$, except the South 550 feet thereof.

EXHIBIT B





EXHIBIT C

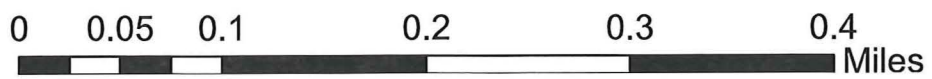

City of Stillwater

Engineering Department

CITY BASE MAP

Parcel being annotated.
OAH DOCKET 84-0831-3938
STILLWATER / TOWN / CITY

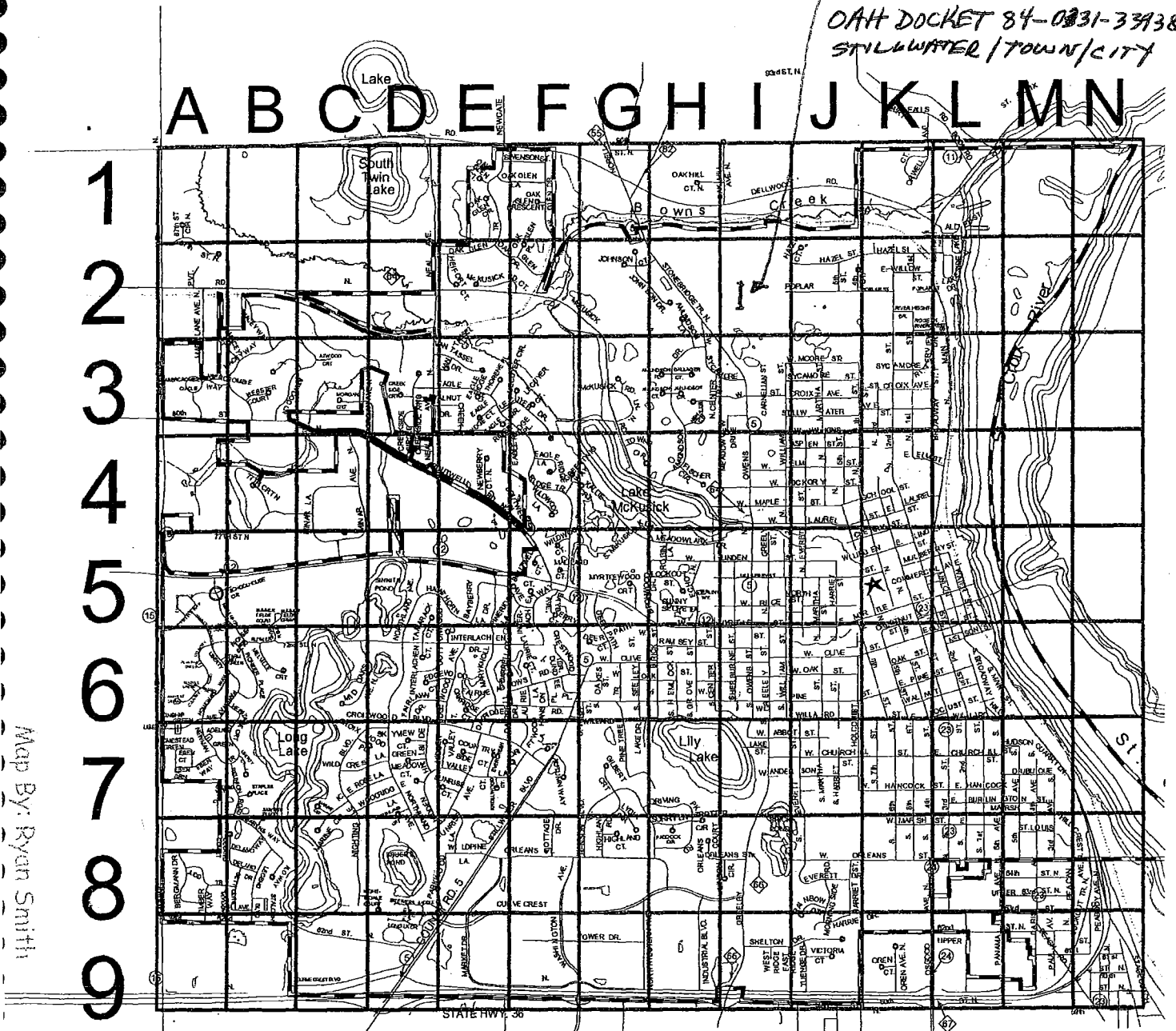

Map By: Ryan Smith

Base Map
Street list
City Detail

Ward Map
Zoning Map
Land Use

Parks Map
Plow Map 05-06
Trash Pickup

1" = 200'

SEE MAP PAGE 11



SEE MAP PAGE 2H

SEE MAP PAGE 2J

Map By: Ryan Smith

21 PAGE

SEE MAP PAGE 31

