

**CITY OF LITCHFIELD  
ORDINANCE NO. 771  
AN ORDINANCE OF THE CITY OF LITCHFIELD, MINNESOTA, ANNEXING  
LAND LOCATED IN LITCHFIELD TOWNSHIP, MEEKER COUNTY, MINNESOTA  
PURSUANT TO MINNESOTA STATUTES 414.033 SUBDIVISION 2(3),  
PERMITTING ANNEXATION ORDINANCE**

**WHEREAS**, a petition signed by all the property owners, requesting that property legally described herein be annexed to the City of Litchfield, Minnesota, was duly presented to the Council of the City of Litchfield on the 2nd day of September, 2014, and

**WHEREAS**, said property is unincorporated and abuts the City of Litchfield on its southern boundary; is less than 120 acres, is not presently served by public sewer facilities or public sewer facilities are not otherwise available, and

**WHEREAS**, said property is not located within a flood plain or shoreland area, and

**WHEREAS**, said land is currently unused and annexation is requested to facilitate the extension of city services for the industrial development of the property, and

**WHEREAS**, the City of Litchfield held a public hearing pursuant to Minnesota Statutes 414.033 Subd. 2b, on October 20, 2014, following thirty (30) days written notice by certified mail to the Township of Litchfield and to all landowners within and contiguous to the area legally described herein, to be annexed, and

**WHEREAS**, provisions of Minnesota Statutes 414.033, subd. 13 are not applicable in that there will be no change in the electric utility service provider resulting from the annexation of the territory to the municipality,

**NOW THEREFORE, THE CITY OF LITCHFIELD DOES HEREBY ORDAIN AS FOLLOWS:**

1. The City Council hereby determines that the property as hereinafter described abuts the City limits and is or is about to become urban or suburban in nature in that industrial use is being proposed for said property the construction of which requires or will need city services, including public sewer facilities.

2. None of the property is now included within limits of any city, or in any area that has already been designated for orderly annexation pursuant to Minnesota Statute 414.0325.

3. The corporate limits of the City of Litchfield, Minnesota, are hereby extended to include the following described property, said land abutting the City of Litchfield and being 120 acres or less in area, and is not presently served by public sewer facilities or public sewer facilities are not otherwise available, and the City having received a petition for annexation from all the property owners of land, to wit:

**NORTHERN TRACT:**

That part of the Northwest Quarter of the Northwest Quarter of Section 24, Township 119, Range 31, Meeker County, Minnesota bounded as follows:

Bounded on the south by a line 25 feet north of the following described line and its easterly extension: Said line commencing at the East Quarter Corner of said Section 23, thence on an assumed bearing of North, along the east line of said Section 23, a distance of 1397.35 feet to the point of beginning of said line; thence North 87 degrees 01 minutes 45 seconds West a distance of 314.48 feet; thence North 89 degrees 42 minutes 30 seconds West, a distance 300.41 feet and said line terminating thereat;

Bound on the west by the following described line: The west line of the Northwest Quarter of the Northwest Quarter of Said Section 24 Township 119, Range 31;

Bounded on the east by the following described line: Said line commencing at the southwest corner of the Northwest Quarter of said Section 24; thence easterly along the south line thereof, a distance of 1077.70 feet' thence northerly at a right angle, a distance of 487.00 feet; thence westerly at a right angle, a distance of 894.40 feet to the point of beginning of said line; thence northerly to a point on the north line of said Northwest Quarter which point is 99.00 feet east of the northwest corner thereof and said line terminating thereat;

Bounded on the north by the following described line and its extensions: Said line commencing at the northeast corner of said Government Lot 1; thence on an assumed bearing of South along the east line thereof, a distance of 823.23 feet to the point of beginning of said line; thence South 89 degrees 30 minutes 30 seconds West, a distance of 550.27 feet and said line terminating thereat;

**SOUTHERN TRACT:**

Part of the West Half of the Northwest Quarter of Section 24, Township North, Range 31, described as follows: Beginning at a point on the west side of Section 24, Township 119, Range 31, 370.1 feet North of the one-quarter corner on the west side of said section, thence North along the west side of said section, thence North along the west side of said section 1,017.5 feet, thence South 87 degrees 54 minutes East 146.8 feet, thence South 01 degrees 58 minutes 966.0 feet, thence South 75 degrees 00 minutes West 188.1 feet to point of beginning.

The above described property consists of a total of 4.9 acres, more or less. Copies of the corporate boundary map showing the property to be annexed and its relationship to the corporate boundaries and all appropriate plat maps are attached hereto.

4. That the population of the area legally described herein and hereby annexed is 0.

5. The City of Litchfield, pursuant to Minnesota Statutes 414.036, that with respect to the property taxes payable on the area legally described herein, hereby annexed, shall make a cash payment to the Township of Litchfield in accordance with the following schedule:

- a. 2015 - an amount equal to one hundred percent (100%) of the property taxes distributed to the township in regard to the annexed area in 2014;
- b. 2016 - an amount equal to ninety percent (90%) of the property taxes distributed to the township in regard to the annexed area in 2014;
- c. 2017 - an amount equal to seventy percent (70%) of the property taxes distributed to the township in regard to the annexed area in 2014;
- d. 2018 - an amount equal to fifty percent (50%) of the property taxes distributed to the township in regard to the annexed area in 2014;
- e. 2019 - an amount equal to thirty percent (30%) of the property taxes distributed to the township in regard to the annexed area in 2014;
- f. 2020 - an amount equal to ten percent (10%) of the property taxes distributed to the township in regard to the annexed area in 2014;

6. That pursuant to Minnesota Statutes 414.036 with respect to any special assessments assigned by the Township to the annexed property and any portion of debt incurred by the Township prior to the annexation and attributable to the property to be annexed, but for which no special assessments are outstanding, for the area legally described herein there are not special assessments or debt incurred by the Township on the subject are for which reimbursement is required.

7. That the Assistant City Administrator of the City of Litchfield is hereby authorized and directed to file a copy of this Ordinance with the Municipal Boundary Adjustment Unit of the Office of Administrative Hearings, the Minnesota Secretary of State, the Meeker County Auditor, and the Litchfield Township Clerk.

8. That this Ordinance shall be in full force and effect and final upon the date this Ordinance is approved by the Office of Administrative Hearings.

Adopted by the City Council this 3rd day of November, 2014.

Attest:

  
ASSISTANT CITY ADMINISTRATOR

Approved:

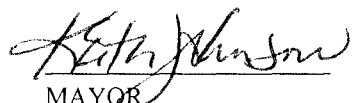
  
MAYOR

REC'D BY  
MBA

JAN 26 2015

First Reading: October 20, 2014

Second Reading: November 3, 2014

Publication:

Effective Date:

Approved as to Form and Legality

by, City Attorney:

Signature: \_\_\_\_\_

Date: \_\_\_\_\_





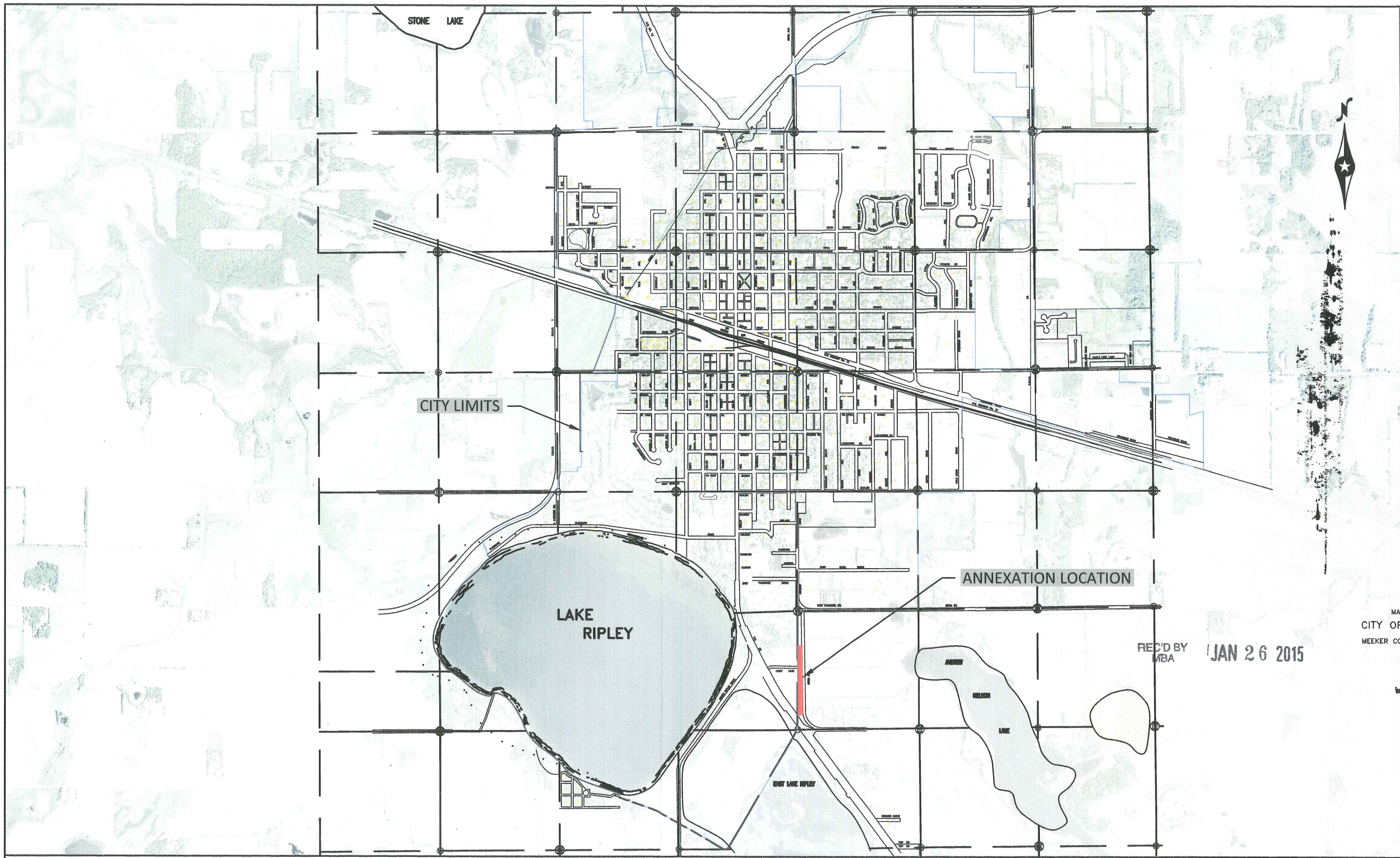

MA  
CITY OF  
MEEKER CO

REC'D BY  
MBA JAN 26 2015

© Bolton & Menk, Inc. 2014. All Rights Reserved  
H:\UTCW\14107741\CAD\Concepts-Display\Copy Lane Annexation Map.dwg 12/16/14 4:52 pm

0 1000 2000  
SCALE FEET

**BOLTON & MENK, INC.**  
Consulting Engineers & Surveyors  
MANKATO, MN FAIRMONT, MN SLEEPY EYE, MN BURNSVILLE, MN WILLMAR, MN  
CHASKA, MN RAMSEY, MN MAPLEWOOD, MN BAXTER, MN ROCHESTER, MN  
AMES, IA SPENCER, IA DES MOINES, IA FARGO, ND

CITY OF LITCHFIELD, MINNESOTA  
CUSTOM PRODUCTS  
ANNEXATION LOCATION

DECEMBER, 2014

FIGURE NO. 1