

NOTICE OF INTENT FOR ANNEXATION

IN THE MATTER OF THE NOTICE OF INTENT FOR THE ANNEXATION OF CERTAIN
LAND TO THE CITY OF DELANO, MINNESOTA PURSUANT TO MINNESOTA
STATUTES § 414.033, SUBD. 3

TO: Franklin Town Board
8735 County Road 16 SE
Delano, MN 55328

and

Office of Administrative Hearings
Municipal Boundary Adjustment Unit
P.O. Box 64620
St. Paul, MN 55164

WHEREAS, the territory described below is not presently within the corporate limits of any incorporated city; and

WHEREAS, the area proposed for annexation is 40 acres or less in size, is 60% or more bordered by land already within the corporate limits of the City of Delano, and is not appropriate for annexation by ordinance pursuant to Minnesota Statutes § 414.033, subd. 2(3); and

WHEREAS, the area proposed for annexation is described as follows:

See Attached Exhibit A

WHEREAS, the area proposed for annexation abuts upon the corporate limits of the City of Delano, Minnesota; and

WHEREAS, the area proposed for annexation is unincorporated, abuts on the City's north boundary, and is not included within any other municipality; and

WHEREAS, the area proposed for annexation is approximately 2.12 acres in size; and

WHEREAS, the reason for the proposed annexation is to provide municipal utilities, streets, and other development to the area proposed for annexation consistent with the City's plan for long-range growth;

WHEREAS, the nature of the area proposed for annexation is residential, commercial, and industrial; and

WHEREAS, the area proposed for annexation is not included in any area that has already been designated for orderly annexation pursuant to Minnesota Statutes § 414.0325, nor in any other proceeding currently pending before the Office of Administrative Hearings – Municipal Boundary Adjustment Unit.

NOW THEREFORE, BE IT RESOLVED BY THE CITY COUNCIL OF DELANO, MINNESOTA that we hereby serve a Notice of Intent to annex the above-described property into the corporate limits of the City of Delano, Minnesota on: Franklin Township; Wright County; and the Municipal Boundary Adjustment Unit of the Office of Administrative Hearings.

Adopted this 12th day of June, 2014.

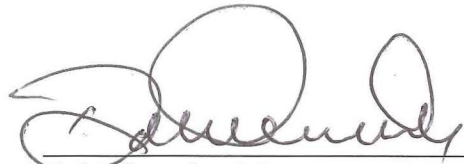

Dale Graunke, Mayor



Phil Kern, City Administrator

EXHIBIT "A"

Legal Description

That part of Lot 5 of Section 11, Township 118, Range 25, according to plat recorded in Book 1 of Section Plats, Page 11, bounded as follows:

Begin at the Northwest corner of the Louis and Augusta Bock tract, which point is 713 $\frac{1}{4}$ feet North of the Northwest Corner of Lot "L" of said Lot; thence East to the center of Waverly and Watertown Road; thence Northwesterly along center of said road to Southeast corner of Lot "B" of Lot 5; thence along the South line of said Lot "B" to the Southwest corner thereof; thence South to the point of beginning, excepting therefrom the West 1 rod thereof.

LESS AND EXCEPT that part of Lot 5 of the E $\frac{1}{2}$ of the NW $\frac{1}{4}$ of Section 11, Township 118, Range 25, Wright County, Minnesota, according to the recorded plat thereof of Book Number 1 of Section Plats, page 11, described as follows:

Commencing at the Northwest corner of Louis and Augusta Bock tract of land which is 713.25 feet North of the Northwest corner of Lot L of said Lot 5; thence East along the South line of a tract of land deeded to Arthur J. and Juanita VanLith as recorded in Book 171 of Deeds page 566, to a point distant 202.23 feet West of the centerline of the former Waverly and Watertown Road said point being point of beginning of the land to be described; thence East along said South line of VanLith tract of land, a distance of 202.23 feet to the centerline of said road; thence Northerly deflecting 116 degrees 55 minutes 35 seconds left along said centerline, a distance of 96.12 feet; thence Northerly deflecting 13 degrees 32 minutes right along said centerline, a distance of 314.98 feet to the Southeast corner of Lot B of said Lot 5; thence Westerly deflecting 101 degrees 53 minutes 35 seconds left along the Southerly line of said Lot B, a distance of 101.91 feet; thence South deflecting 65 degrees 46 minutes left, a distance of 348.64 feet to the point of beginning, Wright County, Minnesota.



Overview

Legend

Roads

- CSAHCL
- CTYCL
- MUNICL
- PRIVATECL
- TWPCCL

City/Township Limits

- c
- t

□ Parcels

Parcel ID	208200112405	Alternate ID	n/a	Owner Address	WEBER, MARTIN J & DIANE C
Sec/Twp/Rng	11-118-25	Class	206 - RES 1-3 UNITS		1960 95TH ST SE
Property Address		Acreage	n/a		DELANO, MN 55328
District	n/a				
Brief Tax Description	Sect-11 Twp-118 Range-025 UNPLATTED LAND FRANKLIN TWP3 REV DES9IN BK99OF DDS PG626 EX W1RD THOF EX TR DES IN BK81MIS-168				
	<i>(Note: Not to be used on legal documents)</i>				

Last Data Upload: 6/10/2014 9:28:33 AM



developed by
The Schneider Corporation
www.schneidercorp.com

City of Delano Location of Webber Property

REC'D BY
MBA JUL 16 2014

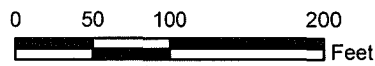
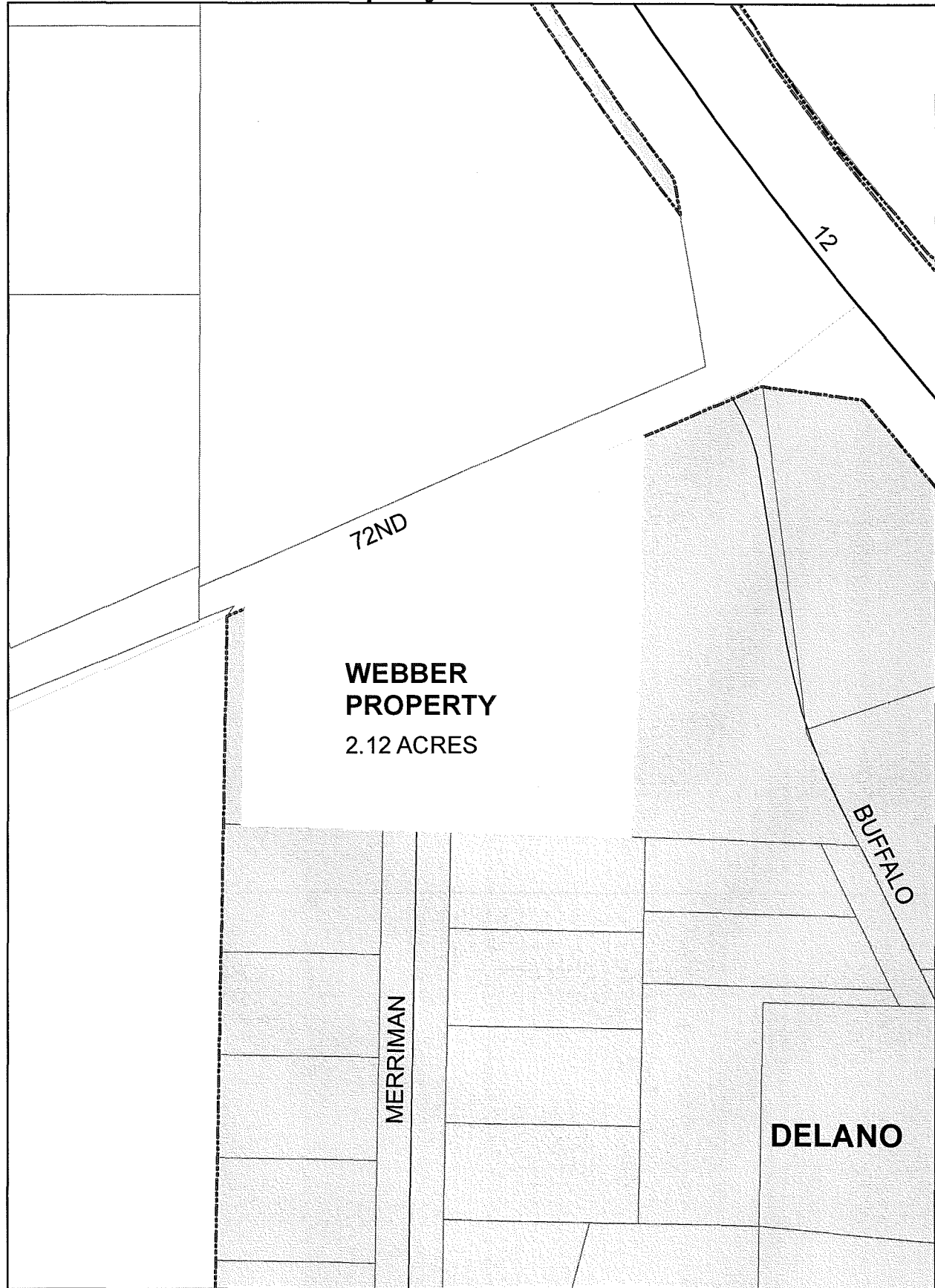

 Delano City Limits

Map Date: July 9, 2014
Data Source: Wright County GIS
Created By: NAC

City of Delano Location of Webber Property

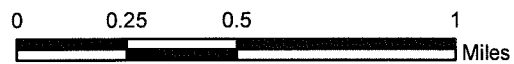
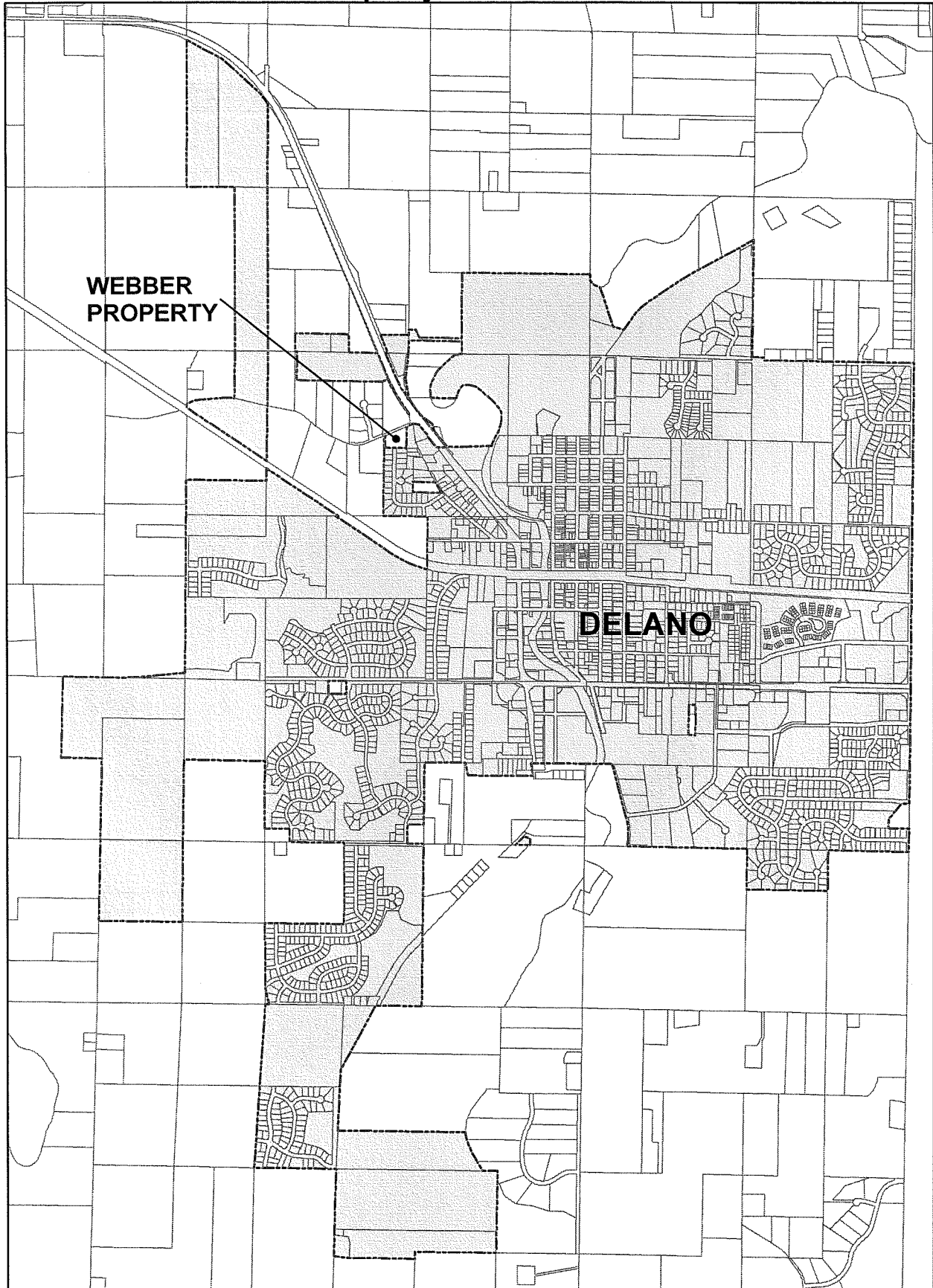

 Delano City Limits