

PETITION FOR ANNEXATION

IN THE MATTER OF THE PETITION FOR ANNEXATION OF
UNINCORPORATED ADJOINING PROPERTY LOCATED
ALONG WINTERGREEN LANE (Paulson),
ALEXANDRIA, MINNESOTA

TO THE CITY OF ALEXANDRIA AND THE STATE OF MINNESOTA

I, THE UNDERSIGNED, the owner of the property described below, hereby petition the Alexandria City Council to annex this territory to the City of Alexandria, Minnesota and for that purpose respectfully state:

1. The petitioner is the owner of the subject property.
2. Pursuant to Minn. Stat. Section 414.033, Subdivision 5, the petition is a majority (100%) of the property owners within the affected area. (One property owners and one petitioner.)
3. The property currently abuts upon the northwesterly boundaries of the Alexandria City Limits along the easterly boundary of the subject property and is not presently a part of any incorporated city.
4. The property consists of platted land in LaGrand Township, Douglas County, containing approximately 0.16 acres in one (1) parcel owned by one (1) property owner and described as:

**LOT 2 BLK 3 (EXCEPT PART IN ALEX CITY)
"RIDGEWOOD 3RD ADDITION" (ADJOINS 63-0691-196)
Section 12, Twp, 128, Range 38.**

5. The petitioner states that this land has or is about to become urban or suburban in character by usage.
6. The parties affected and which may be entitled to notice are the Township of LaGrand and Douglas County.
7. The reason for requesting annexation is for the affected property to be combined with the adjoining parcel, owned by the same property owner, which is already located within the City limits of the City of Alexandria.

Pursuant to Minnesota Statutes Section 414.033, subdivision 13, the City of Alexandria notifies the petitioner that the cost for electric utility service is currently and will continue to be served by Alexandria Light and Power even after the territory is annexed to the City of Alexandria.

(Paulson, con't.)

Dated this 22nd day of Oct, 2013.

REC'D BY
MBA

NOV 04 2013

PROPERTY OWNER

DESCRIPTION

SIGNATURE

Jay Paulson

27-0466-890

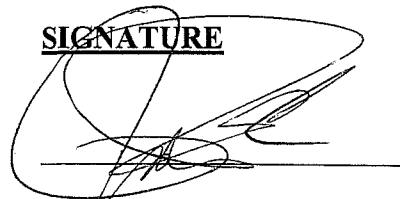

"I hereby represent and state under the penalties of perjury that the signatures of all parties appearing hereon are actual signatures of the person whose name appears as signing this petition."

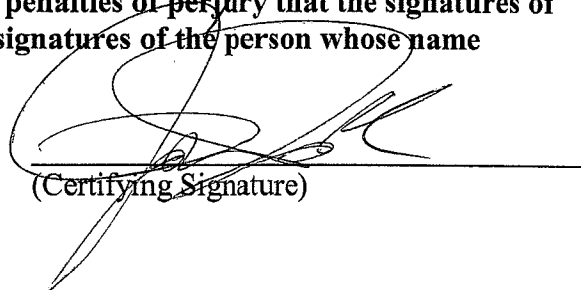

(Certifying Signature)

Subscribed and sworn to before me this 22nd day of Oct, 2013.

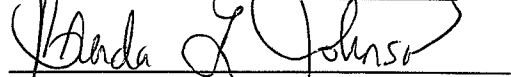

(Notary Public)

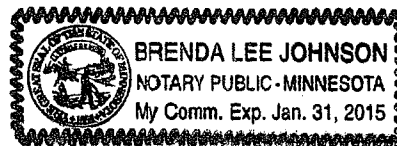



PIN: 27-0466-890

Taxpayer: PAULSON/JAY D/ETAL

GIS Acres: 0.18

Water Acres: 0.00

ROW Acres: 0.00

Section: 12

Township: 128

Range: 38

Tax Desc.: EX PT IN ALEX CITY AC .16
(ADJOINS 63-0691-196)

Plat Desc.: RIDGEWOOD 3RD ADDN

Other Interest:

Disclaimer: Douglas County does not warrant or guarantee the accuracy of the data.
The data is meant for reference purposes only and should not be used for official decisions.
If you have questions regarding the data presented in this map, please contact the Douglas County GIS Department.

Map created on Oct 22, 2013 1:08. This information is to be used for reference purposes only.
Copyright © 2006 Douglas County GIS, All Rights Reserved

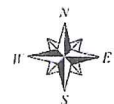

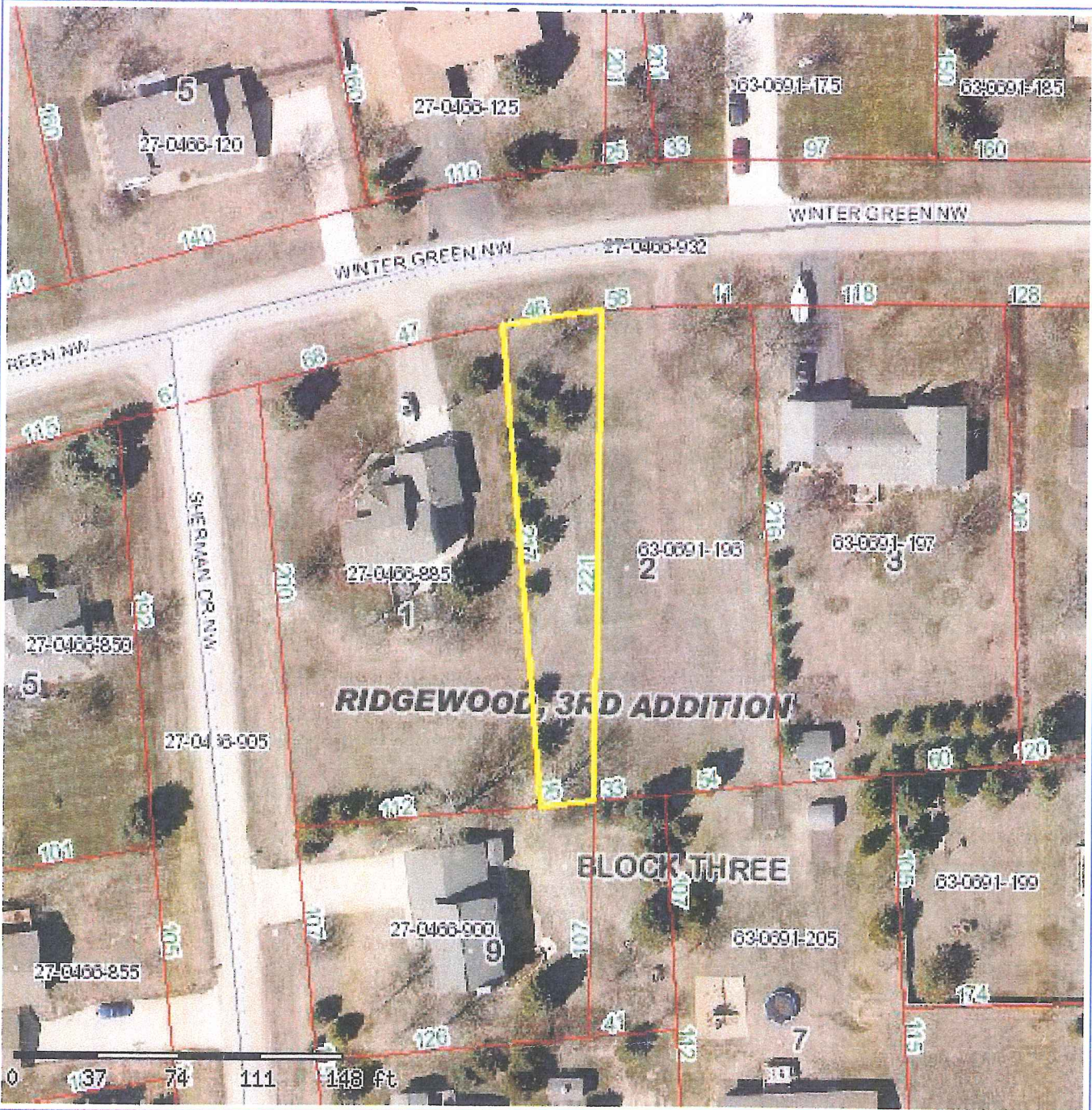

PIN: 27-0466-890

Taxpayer: PAULSON/JAY D/ETAL

Tax Desc.: EX PT IN ALEX CITY AC .16
(ADJOINS 63-0691-196)

GIS Acres: 0.18

Water Acres: 0.00

ROW Acres: 0.00

Section: 12

Township: 128

Range: 38

Plat Desc.: RIDGEWOOD 3RD ADDN



Other Interest:

Disclaimer: Douglas County does not warrant or guarantee the accuracy of the data.
The data is meant for reference purposes only and should not be used for official decisions.
If you have questions regarding the data presented in this map, please contact the Douglas County GIS Department.

Map created on Oct 22, 2013 1:06. This information is to be used for reference purposes only.
Copyright © 2006 Douglas County GIS, All Rights Reserved





City of Alexandria - 2007 Comprehensive Plan

 = Subject Site
 = City Limits

REC'D BY
MBA NOV 04 2013

ANNEXATION
AREA
←

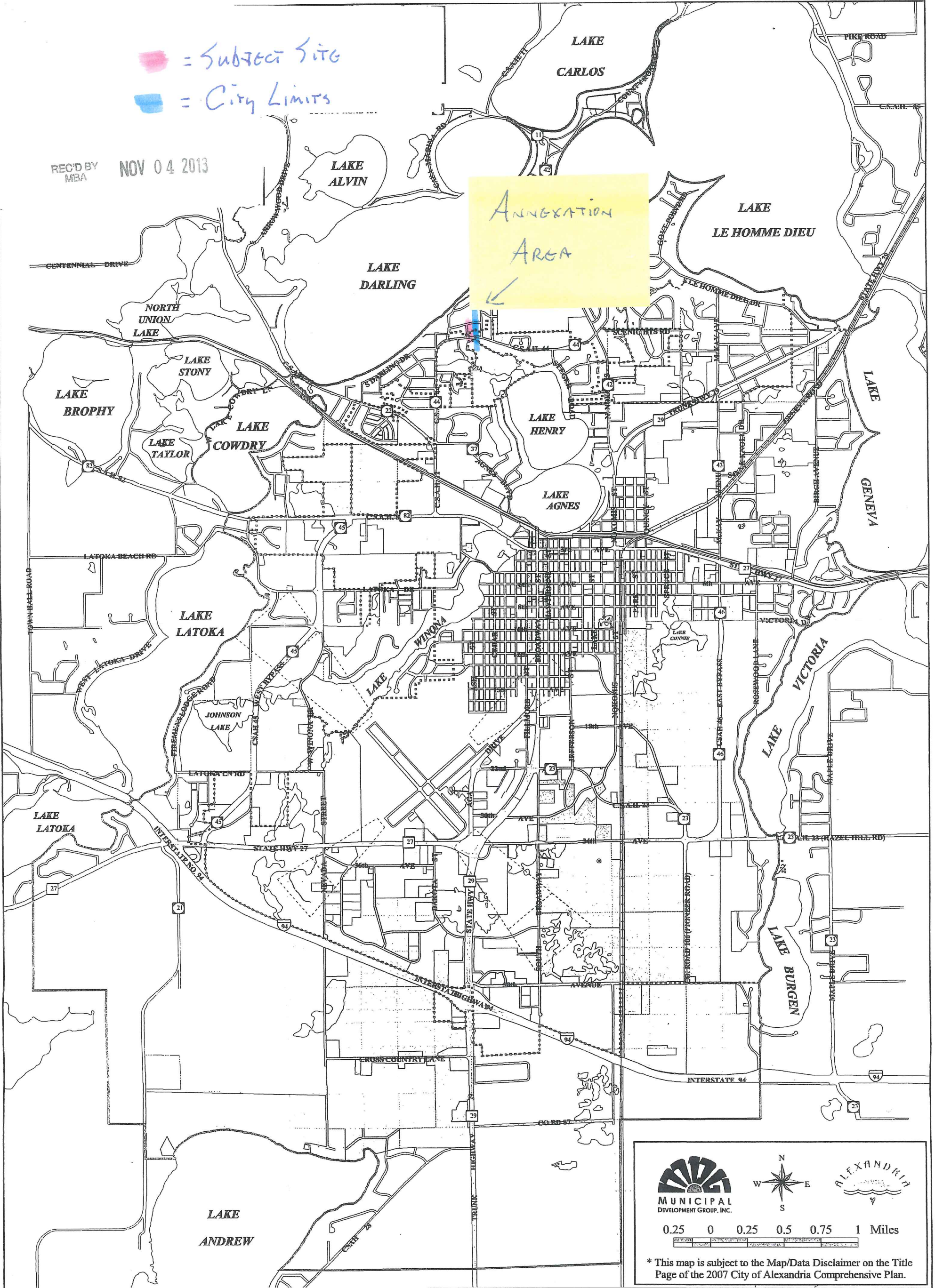

0.25 0 0.25 0.5 0.75 1 Miles

* This map is subject to the Map/Data Disclaimer on the Title Page of the 2007 City of Alexandria Comprehensive Plan.