

ORDINANCE NO. 4112

AN ORDINANCE ANNEXING TO THE CITY OF ROCHESTER APPROXIMATELY 14.43 ACRES OF LAND LOCATED IN A PART OF THE NORTHEAST QUARTER OF SECTION 36 AND A PART OF THE NORTHEAST QUARTER OF THE NORTHWEST QUARTER AND THE NORTHWEST QUARTER OF THE NORTHEAST QUARTER OF SECTION 36, TOWNSHIP 106 NORTH, RANGE 14 WEST, OLMTED COUNTY, MINNESOTA.

THE COMMON COUNCIL OF THE CITY OF ROCHESTER DO ORDAIN:

Section 1. A petition has been filed with the Common Council of the City of Rochester, signed by the City of Rochester requesting the Common Council to annex said land to the City of Rochester. The land described in the petition for annexation is described as follows:

PARCEL 1

That part of the Northeast Quarter of Section 36, Township 106 North, Range 14 West, Olmsted County, Minnesota described as follows:

Commencing at the northeast corner of said Northeast Quarter; thence on an assumed bearing of South 89 degrees 26 minutes 00 seconds West, along the north line of said Northeast Quarter, 200.00 feet to the point of beginning; thence continue South 89 degrees 26 minutes on seconds West, along said north line, 610.00 feet; thence South 01 degrees 49 minutes 09 seconds West, 480.42 feet; thence South 89 degrees 26 minutes 00 seconds West, 1090.00 feet; thence South 00 degrees 34 minutes 00 seconds East, 470.00 feet; thence South 89 degrees 26 minutes 00 seconds West, 500.00 feet; thence South 20 degrees 02 minutes 30 seconds West, 192.94 feet; thence North 89 degrees 26 minutes 00 seconds East, 637.91 feet; thence North 00 degrees 34 minutes 00 seconds West, 380.59 feet; thence North 89 degrees 26 minutes 00 seconds East, 900.00 feet; thence North 44 degrees 26 minutes 00 seconds East, 1060.66 feet to the north line of said Northeast Quarter and the point of

beginning. Consisting of 13.86 acres more or less.

PARCEL 2

That part of the Northeast Quarter of the Northwest Quarter and the Northwest Quarter of the Northeast Quarter of Section 36, Township 106 North, Range 14 West, Olmsted County, Minnesota described as:

Commencing at the northeast corner of the Northeast Quarter of said Section 36, thence on an assumed bearing of South 89 degrees 26 minutes 00 seconds West along the north line of said Northeast Quarter, 810.00 feet; thence South 01 degrees 49 minutes 09 seconds West, 480.42 feet; thence South 89 degrees 26 minutes 00 seconds West, 1090.00 feet; thence South 00 degrees 34 minutes 00 seconds East, 470.00 feet; thence South 89 degree 26 minutes 00 seconds West, 500.00 feet; thence South 20 degrees 02 minutes 30 seconds West, 113.62 feet to the point of the beginning; thence South 89 degrees 26 minutes 00 seconds West, 664.08 feet; thence South 83 degrees 54 minutes 38 seconds East, 640.48 feet; thence North 20 degrees 02 minutes 30 seconds East, 79.32 feet to the point of beginning.

Consisting of 0.57 acre more or less

The entire tract contains 14.43 acres more or less.

Section 2. The total quantity of land included in the petition is approximately 14.43 acres in size.

Section 3. On May 20, 2013, the Common Council held a public hearing to consider this annexation petition after providing written notice of the hearing, by certified mail, to the property owners, the Rochester Township officers, and the adjacent property owners.

Section 4. The City provided notification to the petitioners pursuant to Minn. Stat. §414.033, subd. 2b, 11, 12 and 13 if applicable to this petitioned annexation.

Section 5. Following the public hearing, the Common Council of the City of Rochester determined that the land abuts the municipality and the area to be annexed is 120 acres or less, and the area to be annexed is not presently served by public wastewater facilities or public wastewater facilities are not otherwise available, and the municipality has received a petition for annexation from all the property owners of the land and, as such, the land is or will soon become urban or suburban in character.

Section 6. As provided in Minn. Stat. §414.036, the City shall pay the Townships the equivalent of three years' taxes in two years. There are no township special assessments assigned to or portion of township debt attributable to the land described in Section 1.

Section 7. Therefore, pursuant to Minn. Stat. §414.033, subd. 2(3), the land described in Section 1 above is hereby annexed, added to and made a part of the City of Rochester, Minnesota, as if it had originally been a part thereof.

Section 8. Present and future owners of the lands annexed by this ordinance are hereby notified that in addition to the usual assessments, it is the intention of the Common Council to assess against benefited property all or a portion of the cost of any storm sewer, water tower, pumping station, and trunk line sanitary sewer construction, heretofore or hereafter undertaken to serve the area annexed.

Section 9. This ordinance shall take effect and be in force from and after its official publication and from and after the filing of a certified copy hereof with the Minnesota Department of Administration – Municipal Boundary Adjustments, the Rochester Town Clerk, the County Auditor and the Secretary of State.

PASSED AND ADOPTED BY THE COMMON COUNCIL OF THE CITY OF
ROCHESTER, MINNESOTA, THIS 20TH DAY OF MAY, 2013.

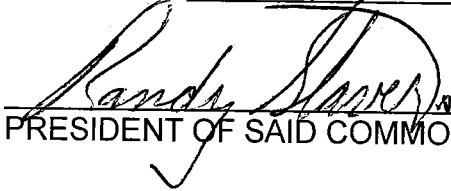
PRESIDENT OF SAID COMMON COUNCIL

ATTEST:

CITY CLERK

APPROVED THIS 21st DAY OF MAY, 2013.

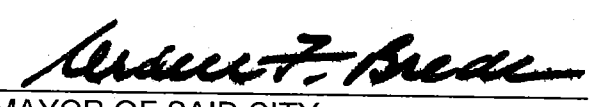
MAYOR OF SAID CITY

(Seal of the City of
Rochester, Minnesota)

192
Notification.. Area of proposed Annexation R2013-001ANX

by Olmsted County to annex approximately 14.43 acres of land in a part of the NE ¼ of Section 36 and a part of the NE ¼ of the NW ¼ & NW ¼ of the NE ¼ of Section 36 Rochester Township. The property is located south of the Olmsted County Maintenance Shop located at 1188 50th Street SE.

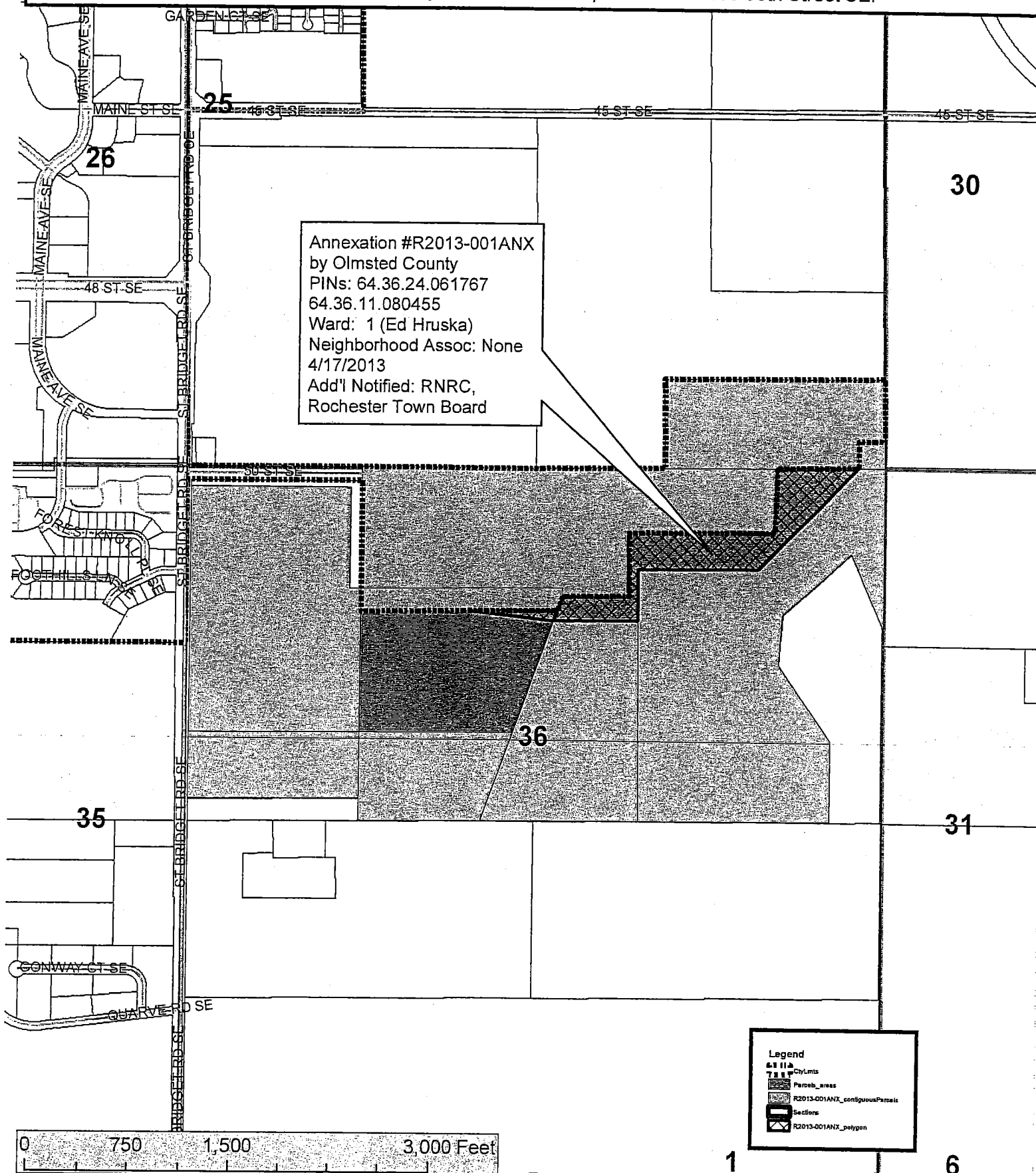

ORDINANCE NO. 4121

REC'D BY
MBA

AUG 13 2013

AN ORDINANCE AMENDING AND REENACTING SECTION 6 OF ORDINANCE NO. 4112 RELATING TO THE ANNEXATION OF 14.43 ACRES OF LAND LOCATED IN A PART OF THE NORTHEAST QUARTER OF SECTION 36 AND A PART OF THE NORTHEAST QUARTER OF THE NORTHWEST QUARTER AND THE NORTHWEST QUARTER OF THE NORTHEAST QUARTER OF SECTION 36, TOWNSHIP 106 NORTH, RANGE 14 WEST, OLMSTED COUNTY, MINNESOTA.

THE COMMON COUNCIL OF THE CITY OF ROCHESTER DO ORDAIN:

Section 1. Section 6 of Ordinance No. 4112 is amended and reenacted so as to read as follows:

Section 6. As provided in Minn. Stat. §414.036, the City shall pay the Townships the equivalent of three years' taxes in two years. In this case, however, the land is owned by Olmsted County. Therefore, the City will not pay any taxes to the Townships. There are no township special assessments assigned to or portion of township debt attributable to the land described in Section 1.

Section 2. The remainder of Ordinance No. 4112 remains in effect and is not affected by this Ordinance.

PASSED AND ADOPTED BY THE COMMON COUNCIL OF THE CITY OF ROCHESTER, MINNESOTA, THIS 5th DAY OF August, 2013.

Kandy Hoover
PRESIDENT OF SAID COMMON COUNCIL

ATTEST:

Valori Langseth
DEPUTY CITY CLERK

APPROVED THIS 6th DAY OF August, 2013.

Richard F. Blade
MAYOR OF SAID CITY

(Seal of the City of
Rochester, Minnesota)