

OA-1449-1 Ranier

STATE OF MINNESOTA  
OFFICE OF ADMINISTRATIVE HEARINGS

---

IN THE MATTER OF THE RANIER/RAINY  
LAKE UNORGANIZED TERRITORY  
(Joint Resolution Between City of Ranier and  
and Koochiching County; 1,142 acres)

---

PETITION FOR ANNEXATION  
PER MINN. STAT. §414.031

---

Pursuant to Minn. Stat. §414.031, Subd. 1(a)(1) the City of International Falls submits its petition/resolution as an annexing municipality to the chief administrative law judge and Koochiching County.

1. The City of International Falls is a Charter City providing municipal services for over 100 years including water, sewer, zoning, economic development, recreation, fire and ambulance services.

2. The Boundaries of the proposed unincorporated area which is or is about to become urban or suburban in character to be annexed are shown in the attached map and are:

(A) That part of the S $\frac{1}{2}$ , SE $\frac{1}{4}$ , SE $\frac{1}{4}$  of Section 35, Township 71, Range 24 which lies East of Trunk Highway 332;

(B) All that portion of the SW $\frac{1}{4}$  of Section 36, Township 71, Range 24 which is South of the existing platted areas;

(C) That part of the Plat of American Suburbs Company's Rose Park Addition to International Falls that lies East of the westerly right-of-way of Third Avenue and its extension to the northerly and southerly plat limits;

(D) That part of the Plat of American Suburbs Company's East Side Addition to International Falls that: (i) lies East of the westerly right-of-way of Third Avenue from its

southerly extension to the South plat limits to its northerly extension to the North right-of-way of Fifth Street, said point being the Southeast corner of Block 2; (ii) and lies South of the northerly right-of-way of Fifth Street from the Southeast corner of Block 2 to its easterly extension to the East plat limits;

(E) The SE $\frac{1}{4}$  and the S $\frac{1}{2}$  of the NE $\frac{1}{4}$  of Section 36, Township 71, Range 24:

(F) The westerly 33' of Section 31, Township 71, Range 23 which is located within:

(i) The Plat of Bedell's Addition to International Falls;

(ii) The Plat of Clarke's First Addition to International Falls; and

(iii) The W $\frac{1}{2}$  of the SW $\frac{1}{4}$ , Section 31, Township 71, Range 23.

(G) That part of the Plat of Alberta Park that: (i) lies East of the easterly right-of-way of Viola Avenue from its southerly extension to the South plat limits to the Northwest corner of Lot 23, Block 8; (ii) and lies South of the northerly line of Lot 23, Block 8 and its extension easterly across the alley to the Northwest corner of Lot 8, Block 8 and continuing easterly on the northerly line of said Lot 8 and its extension to the East plat limits;

(H) That part of the Plat of First Addition to Ranier that: (i) lies South of the southerly right-of-way of First Street from its westerly extension to the West plat limits to the Northeast corner of Block 7 same being on the westerly right-of-way of Aldrich Avenue; (ii) and lies East of the westerly right-of-way of Aldrich Avenue from its southerly extension to the South plat limits to its northerly extension to the North plat limits.

(I) That part of County Road right-of-way located in Auditor's Plat No. 29, Section 25, Township 71, Range 23 lying easterly of the East of Lot 19 and a 66' northerly extension of said line to the northerly right-of-way of County Road 113.

(J) All that part of the W $\frac{1}{2}$  of Section 30, Township 71, Range 23 South of T.H. 11 and South and East of the northerly and westerly right-of-way lines of County Road 113 which abut Lots 1 through 5, Block 3, Plat of Riverside Park;

(K) The N $\frac{1}{2}$ , NW $\frac{1}{4}$ , Section 31, Township 71, Range 23;  
with all land totaling approximately 590 acres or less.

3. The names of all parties entitled to Notice under Minn. Stat. §414.09 are:

Robert Peterson, County Auditor  
Koochiching County Courthouse  
715 Fourth Street  
International Falls, MN 56649

Dale Olson, Zoning Administrator  
Koochiching County Courthouse  
715 Fourth Street  
International Falls, MN 56649

Patricia Henderson, Executive Director  
Arrowhead Regional Development Commission  
221 W. First Street  
Duluth, MN 55802

Robert W. Anderson, Governmental Affairs Director  
Boise White Paper, LLC  
400 2<sup>nd</sup> St.  
International Falls, MN 56649

Daniel Ganter  
3127 County Road 112  
International Falls, MN 56649

4. The reasons for the annexation are:

(A) The City of International Falls is presently providing water production, library, recreation, fire and ambulance services. International Falls has the staff to additionally provide all other municipal services including police, sewer and water service, animal control.

(B) The City of International Falls is one half owner of the Foreign Trade Zone which is in part of the proposed area to be annexed and provide its fair share of the financial resources to develop the Foreign Trade Zone. Most importantly the City of International Falls has the financial resources to develop the Foreign Trade Zone, the second busiest rail port of entry.

(C) The remaining land is either a logical possible extension of the Foreign Trade Zone or land needed to extend the truck route of T.H. 332 to the Foreign Trade Zone and to Highway 11. The Foreign Trade Zone is the economic future of the area bringing warehousing and assembly jobs to a railroad line which is the 2<sup>nd</sup> busiest in North America. This road will serve four vital areas of International Falls and the whole community:

- (i) The Burner Road portion of T.H. 332 is vacated to benefit Boise and its employees;

- (ii) businesses, both downtown and on Highway 53, will not have a vehicular bypass created that was opposed by 900 petitioners, the Falls Chamber of Commerce, and a large majority of the public participating at all public meetings;
- (iii) the community's economic future due to having a first-class truck bypass continue from the existing north easterly turn of State Trunk Highway 332 to the Foreign Trade Zone;
- (iv) a quick "escape" and bypass route for the lake residents coming from the South.

Adopted by resolution by affirmative vote of the City Council of International Falls the 24<sup>th</sup> day of September, 2009

Ayes: Councilor Rognerud, Councilor Paul Eklund, Councilor Jaksa

Nays: None

Absent: Councilor McBride

Recused: Mayor Shawn Mason

CITY OF INTERNATIONAL FALLS

ATTEST:

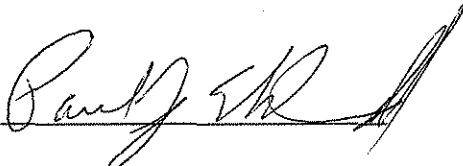
By:   
Acting Mayor

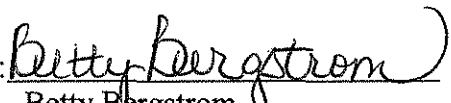
By:   
Betty Bergstrom  
Acting City Administrator

Approved the 24<sup>th</sup> day of September, 2009

OCT 30 2003

RECIDIVY AREA

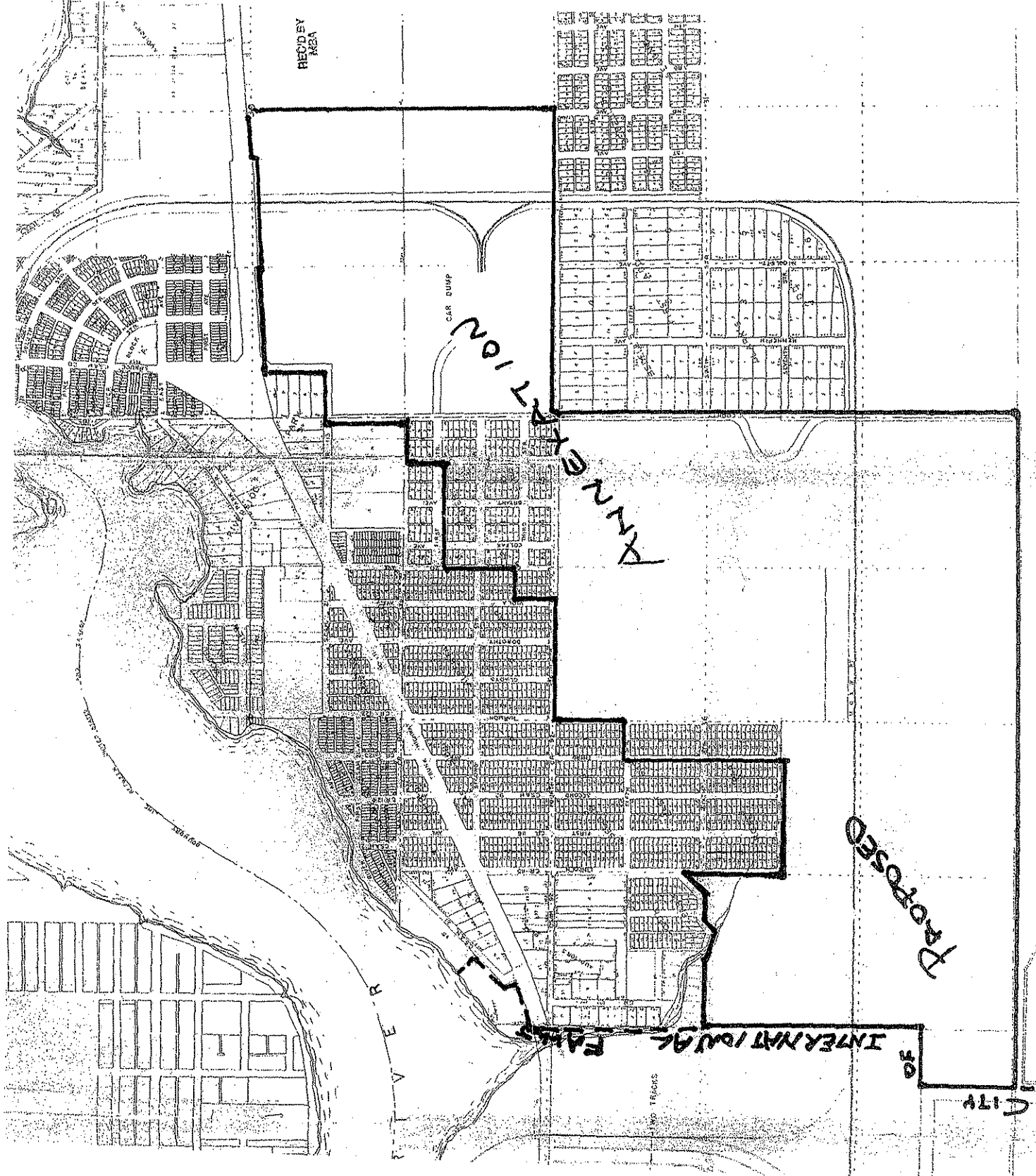

ANNEXATION

PROPOSED

INTERNATIONAL PARK

CITY OF

CAR DUMP

TRUCKS

