

ORDINANCE NUMBER 2007-5-14/2

**AN ORDINANCE ANNEXING PROPERTY TO THE CITY OF HARRIS, MINNESOTA
PURSUANT TO MINNESOTA STATUTES SECTION 414.033 SUBD. 2(3).**

The City Council of Harris, Minnesota Ordains that the following land is hereby annexed to the City of Harris, Chisago County, Minnesota pursuant to, and in accordance with, Minnesota Statutes Section 414.033 Subd. 2(3):

That part of Section 22, Township 36 North, Range 21 West, Chisago County, Minnesota, legally described as follows:

The Southwest Quarter of the Southwest Quarter;

The Southeast Quarter of the Southwest Quarter;

That part of the South 440 feet of Northwest Quarter of the Southeast Quarter, lying west of the East 200 feet thereof; and

That part of the Southwest Quarter of Southeast Quarter, described as follows:

Beginning at the southwest corner of said Southwest Quarter of Southeast Quarter; thence North 89 degrees 45 minutes 13 seconds East 221.10 feet along the south line of said Southwest Quarter of Southeast Quarter to the centerline of Sunrise Road; thence northeasterly 110.57 feet along said centerline on a non-tangential curve, concave to the northwest, radius 614.00 feet, central angle 10 degrees 19 minutes 04 seconds, and chord bearing of North 61 degrees 06 minutes 11 seconds; thence northeasterly 284.68 feet along said centerline on a compound curve, concave to the northwest, radius 3042.00 feet, central angle 5 degrees 21 minutes 43 seconds; thence North 50 degrees 34 minutes 57 seconds East 349.42 feet along said centerline; thence northeasterly 393.94 feet along said centerline on a tangential curve, concave to the northwest, radius 1041.74 feet, central angle 21 degrees 40 minutes 00 seconds; thence North 28 degrees 54 minutes 57 seconds East 168.28 feet along said centerline; thence northeasterly 142.77 feet on a tangential curve, concave to the southeast, radius 954.93 feet, central angle 8 degrees 33 minutes 59 seconds to a line herein after described as Line A; thence North 14 degrees 22 minutes 03 seconds West 321.52 feet along said line A to the north line of said Southwest Quarter of Southeast Quarter; thence South 89 degrees 44 minutes 31 seconds East 1140.92 feet along said north line to the east line of said Southwest Quarter of Southeast Quarter; thence South 00 degrees 12 minutes 53 seconds West 1320.53 feet along said east line to the point of beginning.

Description of Line A:

Beginning at a point on the north line of said Southwest Quarter of Southeast Quarter distant of 200 feet westerly of the northeast corner thereof; thence southeasterly to a point on the east line of said Southwest Quarter of Southeast Quarter distant 787 feet southerly of the northeast corner thereof and there terminating.

Subject to Sunrise road (C.S.A.H. No. 9).

That pursuant to Minn. Stat. § 414.036, the City shall reimburse Sunrise Township for the taxable property annexed as part of the Ordinance in the amount of \$2,692.60 payable in one installment in 2007, and calculated as follows:

Year	Township Share of 2007 Tax			Subtotal	Percentage paid to Township	Total
	PID 09.00564.00	PID 09.00564.00	PID 09.00564.00 Prorated amount based on 38.83 acres			
1	\$284.49	\$528.17	\$264.38	\$1,077.04	90%	\$969.34
2	\$284.49	\$528.17	\$264.38	\$1,077.04	70%	\$753.93
3	\$284.49	\$528.17	\$264.38	\$1,077.04	50%	\$538.52
4	\$284.49	\$528.17	\$264.38	\$1,077.04	30%	\$323.11
5	\$284.49	\$528.17	\$264.38	\$1,077.04	10%	\$107.70
Total Amount to be paid to Township						\$2692.60

This ordinance shall be effective upon publication in the official newspaper of the City and approval by the Minnesota Municipal Board.

Dated: May 14, 2007

City of Harris

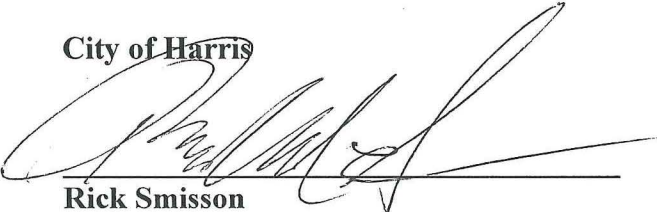
Rick Smisson
Its Mayor

ATTEST:



Jennifer Wothe
City Clerk

Published in the Cambridge Star on _____, 2007

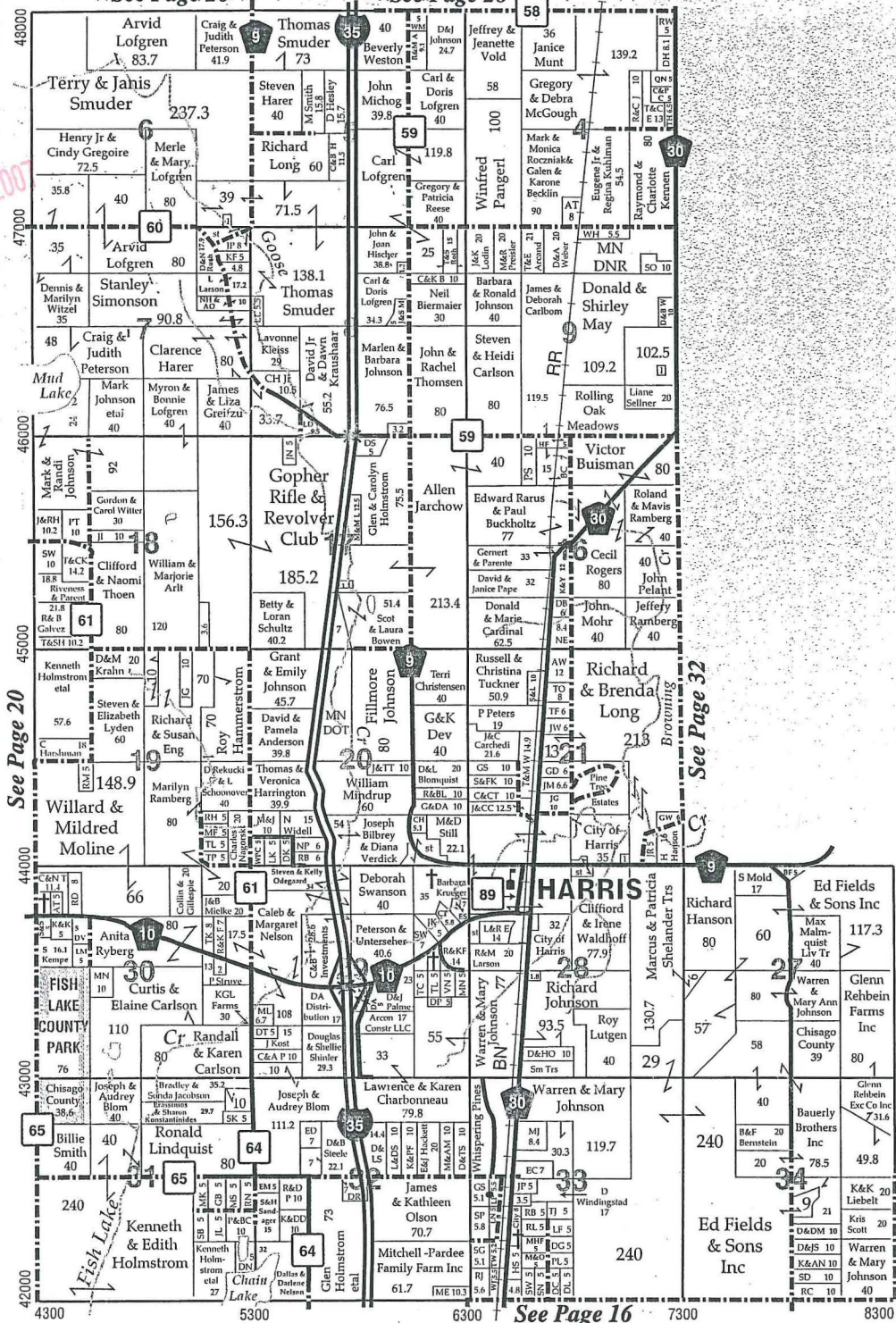

See Page 26

See Page 28



REC'D BY
MAB
MAY 18 2007

See Page 20

See Page 32

See Page 16