

ORDINANCE NO. 36-1
EXTENDING THE CORPORATE LIMITS
OF THE CITY OF MAZEPPA
TO INCLUDE CERTAIN UNINCORPORATED LAND
ABUTTING THE CITY OF MAZEPPA

WHEREAS, Minnesota Statute §414.033 allows a city to annex land into the city limits by ordinance when: a) the land abuts the municipality, b) the land area is less than 60 acres, c) the city receives a petition for annexation from all property owners of the land, and d) the area to be annexed is not presently served by public sewer facilities, and

WHEREAS, the City of Mazeppa has received a Petition dated February 15, 2005 from Phil A. Olson and Shari L. Olson, husband and wife, and MN & N Partnership, Inc., all of the owners of the property described on Exhibit A hereto, no part of which is now included in the city limits of the City of Mazeppa, and

WHEREAS, the petitioners' lands taken together abut the City, and

WHEREAS, the land is 59.7 acres in area, and

WHEREAS, the property to be annexed is not presently served by public sewer facilities, and

WHEREAS, the City believes the land is about to become urban or suburban in character because the area in which the property is located is a logical location for expansion of the City limits to accommodate single family housing and the property to be annexed will be used for construction of new single-family homes in a residential subdivision to be developed by petitioners, and

WHEREAS, a public hearing was held on March 24, 2005 pursuant to Minnesota Statutes Section 414.033, Subd.2(b), and 30 days' written notice was given by certified mail to Mazeppa Township and to all landowners within and contiguous to the area to be annexed, and

WHEREAS, the City feels that annexation of the property by ordinance is in the best interests of the citizens of the City of Mazeppa;

NOW THEREFORE, IT IS ORDAINED BY THE CITY OF MAZEPPA, MINNESOTA AS FOLLOWS:

1. The land described on Exhibit A hereto is declared annexed to the City of Mazeppa, and the corporate limits of the City of Mazeppa are hereby extended to include said land.
2. A certified copy of this ordinance shall be immediately forwarded by the City Attorney to the Wabasha County Auditor and to the Office of Strategic and Long-Range Planning, together with appropriate filing fees. A certified copy shall also be forwarded to the Mazeppa Township Clerk, Secretary of State, and the petitioners.
3. This ordinance shall take effect upon the latest of date of passage, approval by the State Office of Strategic and Long-Range Planning, and publication according to law.

Dated: 3/24/05

Deborah E. Frank
Deborah Frank, Mayor

Linda Friedrich
Linda Friedrich, City Clerk

EXHIBIT A

PROPOSED PROPERTY DESCRIPTION FOR ANNEXATION PROCEEDINGS

That part of the Southwest Quarter of Section 5, Township 109 North, Range 14 West, Wabasha County, Minnesota, described as follows:

Beginning at the southwest corner of said Section 5; thence on an assumed bearing of North 01 degree 22 minutes 45 seconds West, along the west line of the Southwest Quarter of said Section 5, a distance of 2068.52 feet; thence South 66 degrees 12 minutes 37 seconds East, a distance of 125.64 feet; thence South 01 degrees 22 minutes 45 seconds East, a distance of 50.77 feet; thence South 57 degrees 27 minutes 53 seconds East, a distance of 238.19 feet; thence North 36 degrees 08 minutes 38 seconds East, a distance of 306.08 feet; thence South 53 degrees 52 minutes 39 seconds East, a distance of 130.00 feet; thence South 88 degrees 53 minutes 11 seconds East, a distance of 80.65 feet; thence South 52 degrees 06 minutes 47 seconds East, a distance of 349.29 feet; thence South 01 degree 49 minutes 59 seconds West, a distance of 302.44 feet; thence South 24 degrees 45 minutes 59 seconds West, a distance of 126.99 feet; thence South 51 degrees 28 minutes 37 seconds East, a distance of 219.24 feet; thence South 59 degrees 24 minutes 39 seconds East, a distance of 134.73 feet; thence South 30 degrees 38 minutes 17 seconds West, a distance of 130.00 feet; thence South 59 degrees 24 minutes 39 seconds East, a distance of 499.98 feet; thence South 53 degrees 51 minutes 00 seconds East, a distance of 75.98 feet; thence South 37 degrees 49 minutes 25 seconds East, a distance of 146.84 feet; thence South 21 degrees 10 minutes 26 seconds East, a distance of 84.63 feet; thence South 08 degrees 19 minutes 56 seconds East, a distance of 144.89 feet; thence South 19 degrees 48 minutes 41 seconds East, a distance of 125.48 feet; thence South 06 degrees 45 minutes 44 seconds West, a distance of 268.28 feet to the south line of the Southwest Quarter of said Section 5; thence North 89 degrees 35 minutes 53 seconds West, along said south line, a distance of 1709.56 feet to the point of beginning. Containing 59.70 acres, more or less.

REC'D BY
MAB

MAR 28 2005



MAP OF

MAZEPPA & W. ZUMBRO



TOWNSHIP: 109 N.

RANGE: 14 W.

CODE: MA

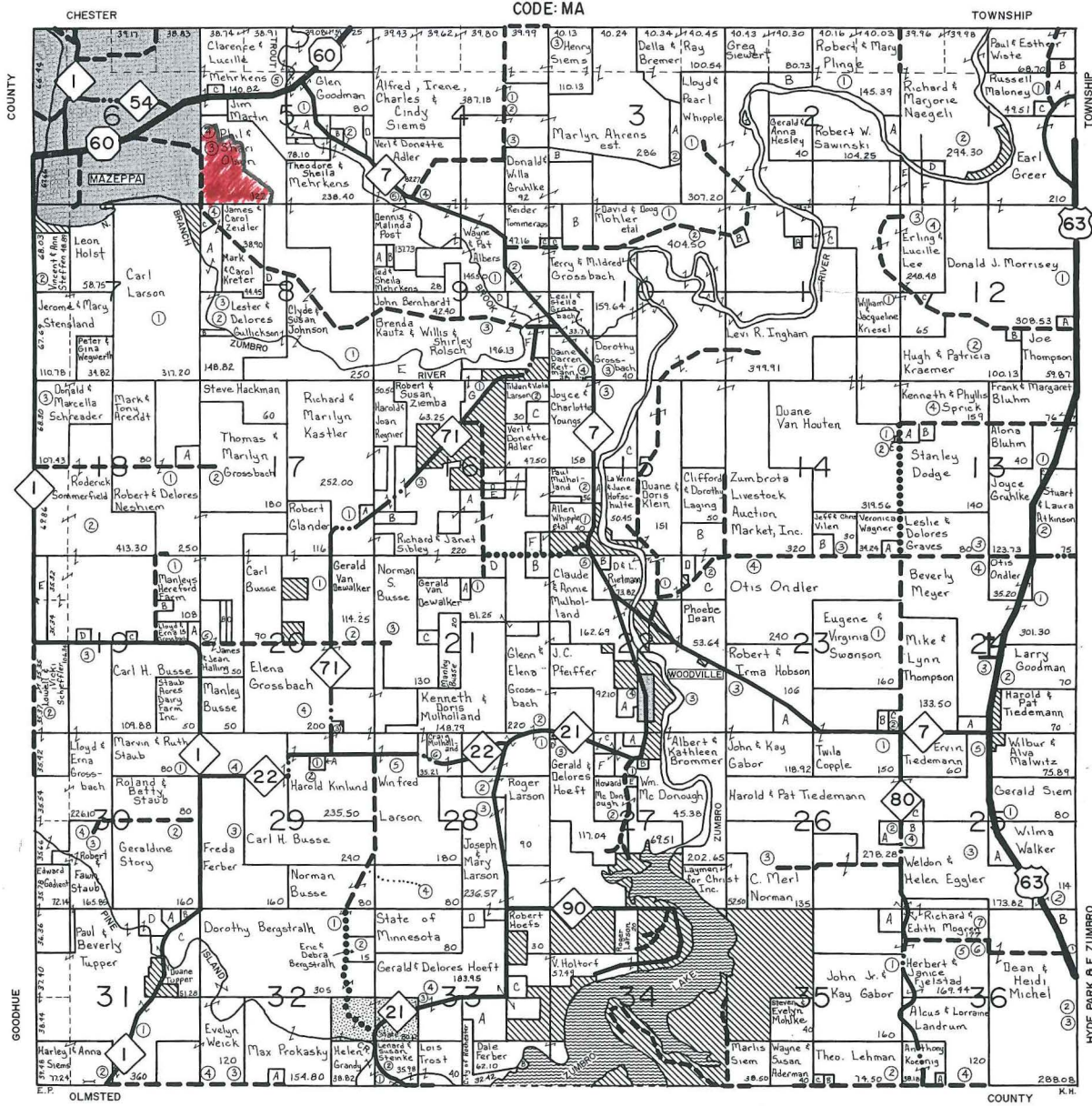

Property
Annexed

SEE SMALL TRACT OWNERS FOLLOWING TOWNSHIP MAPS

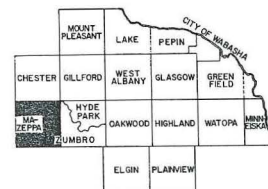

REC'D BY
MAAB

2005

85-109-14

SCALE FOR SECTION, { Each side large blue squares = 20 chains, 80 rods, 1320 feet; area of square 40 acres.
660 Ft. = 1 inch { Each side small red squares = 5 chains, 20 rods, 330 feet: area of square 2½ acres.

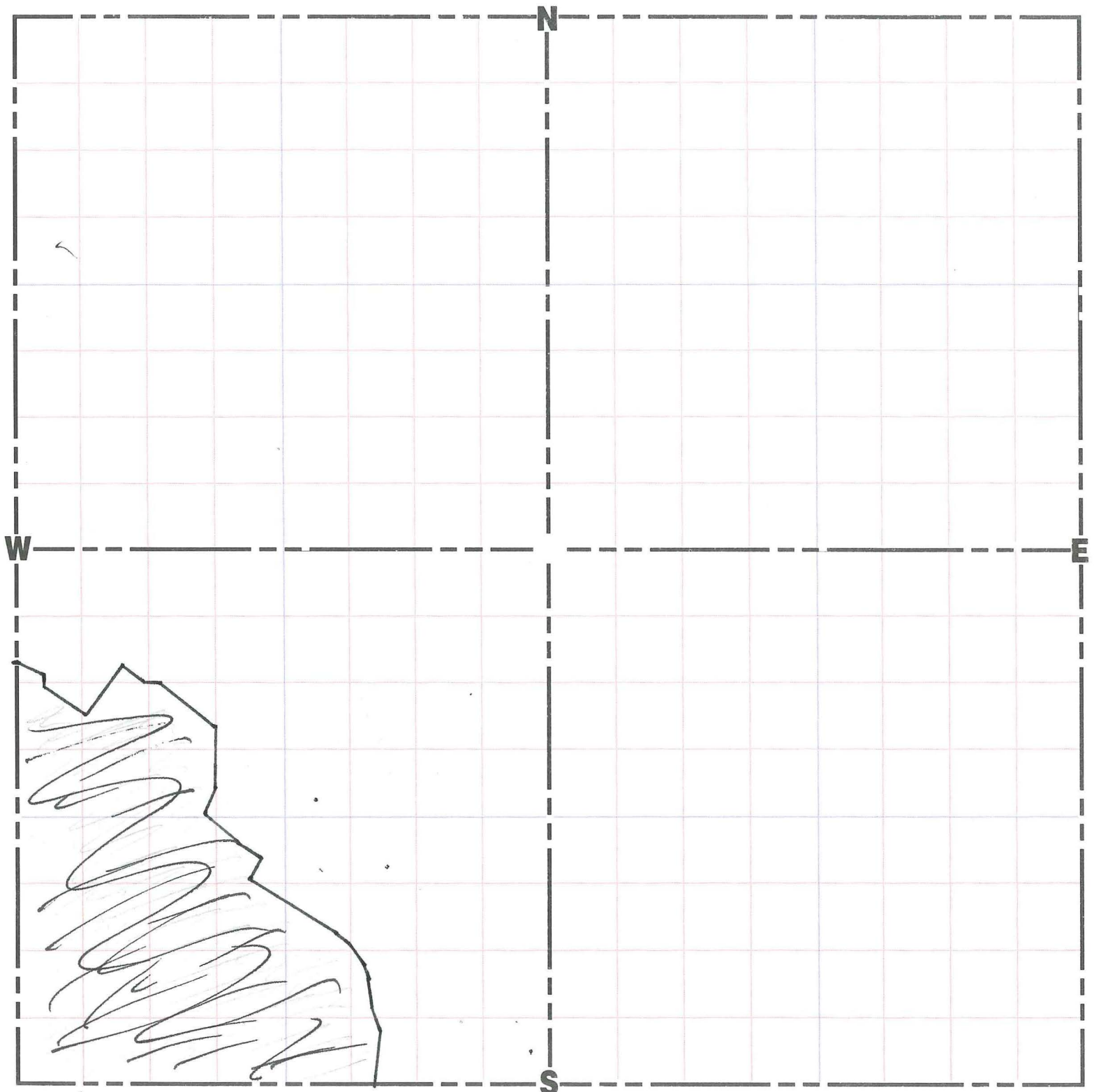

SCALE FOR QUARTER SECTION. { Each side large blue squares = 10 chains, 40 rods, 660 feet: area of square 10 acres.
330 Ft. = 1 inch { Each side small red squares = 2.5 chains, 10 rods, 165 feet: area of square .625 of 1 acre.

PRONTO LAND MEASURE 660-330 MAP SHEET

PRONTO LAND MEASURE
P.O. Box 279, Northville, MI 48167
Phone (248) 347-3145
Fax (248) 347-4560

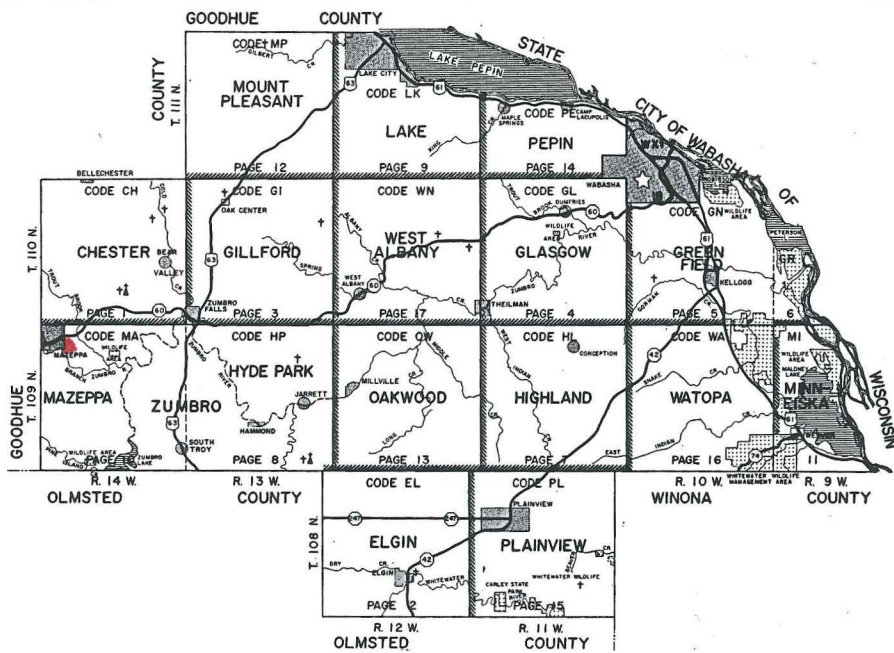

■ Annexed
Property

REC'D BY
M.M.B.
MAR 28 2005

MAR 28 2005

Annexed Property