

ORDINANCE NO. 3695

AN ORDINANCE ANNEXING TO THE CITY OF ROCHESTER APPROXIMATELY 15 ACRES OF LAND LOCATED IN A PART OF THE SOUTHEAST QUARTER OF THE SOUTHEAST QUARTER OF SECTION 30, AND A PART OF THE NORTHEAST QUARTER OF THE NORTHEAST QUARTER OF SECTION 31, TOWNSHIP 107 NORTH, RANGE 14 WEST, OLMSTED COUNTY, MINNESOTA.

THE COMMON COUNCIL OF THE CITY OF ROCHESTER DO ORDAIN:

Section 1. A petition has been filed with the Common Council of the City of Rochester, signed by the owner of land described herein, requesting the Common Council to annex said land to the City of Rochester. The land described in the petition for annexation is described as follows:

North Section

That part of the Southeast Quarter of the Southeast Quarter of Section 30, Township 107 North, Range 14 West, Olmsted County, Minnesota, described as follows:

Beginning at the southeast corner of said Southeast Quarter; thence Westerly on a Minnesota State Plane Grid Azimuth from north of 270 degrees 06 minutes 21 seconds along the south line of said Southeast Quarter 544.50 feet; thence northerly 00 degrees 10 minutes 05 seconds azimuth 526.74 feet; thence easterly 90 degrees 10 minutes 05 seconds azimuth 544.50 feet to the east line of said Southeast Quarter; thence southerly 180 degrees 10 minutes 05 seconds azimuth along said east line 526.15 feet to the point of beginning.

South Section

That of the Northeast Quarter of the Northeast Quarter of Section 31, Township 107 North, Range 14 West, Olmsted County, Minnesota, described as follows:

Beginning at the northeast corner of said Northeast Quarter; thence westerly on a Minnesota State Plane Grid Azimuth from north of 270 degrees 06 minutes 21 seconds along the north line of said Northeast Quarter 544.50 feet; thence southerly 180 degrees 10 minutes 05 seconds azimuth 614.94 feet to the center line of a Township Road; thence easterly 99 degrees 15 minutes 25 seconds azimuth along said center line 574.59 feet to the east line of said Northeast Quarter; thence northerly 358 degrees 18 minutes 47 seconds azimuth along said east line 706.67 feet to the point of beginning.

Said tract contains 15 acres more or less.

Section 2. The total quantity of land included in the petition is approximately 15 acres in size.

Section 3. On February 7, 2005, the Common Council held a public hearing to consider this annexation petition after providing written notice of the hearing, by certified mail, to the property owners, the Cascade Township officers, and the adjacent property owners.

Section 4. The City provided notification to the petitioners pursuant to Minn. Stat. §414.033, subd. 2b, 11, 12 and 13 if applicable to this petitioned annexation.

Section 5. Following the public hearing, the Common Council of the City of Rochester determined that the land abuts the municipal limits, is less than 60 acres in area, the annexation petition is signed by all property owners of the land described in Section 1, and the land is or will soon become urban or suburban in character.

Section 6. Therefore, pursuant to Minn. Stat. §414.033, subd. 2(3), the land described in Section 1 above is hereby annexed, added to and made a part of the City of Rochester, Minnesota, as if it had originally been a part thereof.

Section 7. Present and future owners of the lands annexed by this ordinance are hereby notified that in addition to the usual assessments, it is the intention of the Common Council to assess against benefited property all or a portion of the cost of any storm sewer, water tower, pumping station, and trunk line sanitary sewer construction, heretofore or hereafter undertaken to serve the area annexed.

RECEIVED
MAR 17 2005

Section 8. This ordinance shall take effect and be in force from and after its official publication and from and after the filing of a certified copy hereof with the Minnesota State Planning Commission, the Cascade Town Clerk, the County Auditor and the Secretary of State.

PASSED AND ADOPTED BY THE COMMON COUNCIL OF THE CITY OF
ROCHESTER, MINNESOTA, THIS 7th DAY OF MARCH, 2005.

PRESIDENT OF SAID COMMON COUNCIL

ATTEST: 
CITY CLERK

APPROVED THIS 8th DAY OF MARCH, 2005.

MAYOR OF SAID CITY

(Seal of the City of
Rochester, Minnesota)

Ord05\Annex.0421

ANNEXATION EXHIBIT

RECEIVED
MAY 17 2005

A 3

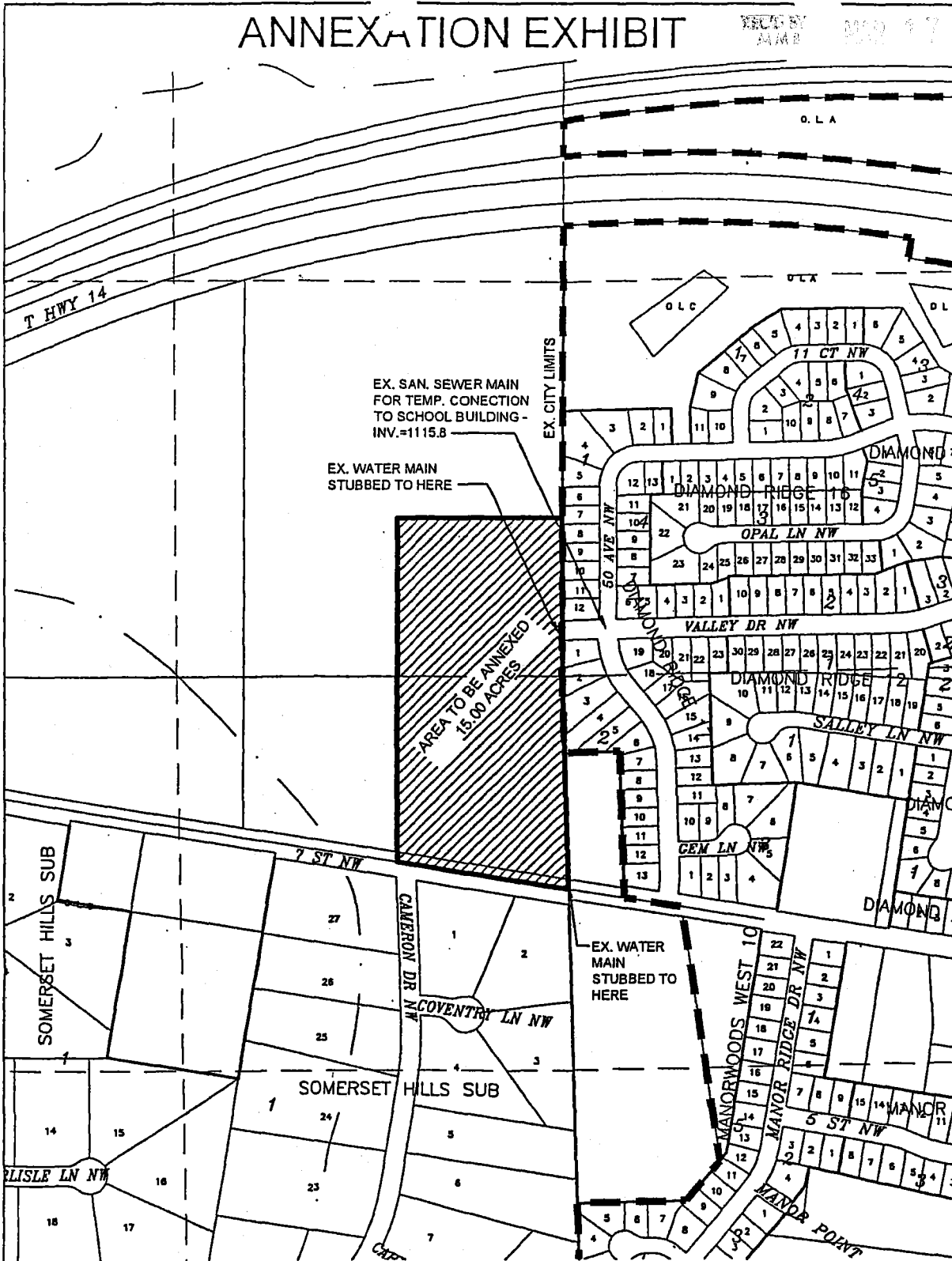

RECEIVED

DEC 21 2004

ROCHESTER - CLMSTED
PLANNING DEPARTMENT

DATE
12/14/04

Pape Engineering &
Land Surveying, Inc.

RR 2 Box 1655, Stewartville, MN 55976 (507) 378-4355

PROJECT NO: 1153

SHEET 1 OF 1

PETITIONER
ROCHESTER MONTESSORI SCHOOL, INC.