

ORDINANCE NO. 234

**ANNEXATION OF PRAIRIE'S EDGE
CITY OF PERHAM, COUNTY OF OTTER TAIL
STATE OF MINNESOTA
AN ORDINANCE EXTENDING THE CORPORATE LIMITS OF
THE CITY OF PERHAM
TO INCLUDE CERTAIN UNINCORPORATED PROPERTY
ABUTTING UPON THE LIMITS OF THE CITY**

WHEREAS, the territory described below is not presently within the corporate limits of any incorporated City, Village or Borough; and

WHEREAS, the territory to be annexed is 29.74 acres; and

WHEREAS, this territory abuts upon the boundary of the City of Perham; and

WHEREAS, this territory is urban or about to become urban in character.

THE CITY COUNCIL OF PERHAM, MINNESOTA DOES HEREBY ORDAIN:

Section 1. Territory Annexed.

The corporate limits of the City of Perham, Minnesota are hereby extended to include the unplatted property described as follows:

The SW $\frac{1}{4}$ of SE $\frac{1}{4}$, EXCEPT the following described tracts:

The westerly 487.00 feet of the southerly 245.00 feet of the Southwest Quarter of the Southeast Quarter in Section 11, Township 136 North, Range 39 West of the Fifth Principal Meridian in Otter Tail County, Minnesota, said westerly 487 feet is measured at a right angle to and is parallel with the west line of said Southwest Quarter of the Southeast Quarter and said southerly 245.00 feet is measured at a right angle to and is parallel with the south line of said Southwest Quarter of the Southeast Quarter. The above described tract contains 2.74 acres.

SUBJECT TO an easement for public road purposes over, under, and across the westerly 33.00 feet of the above described tract and over, under and across the southerly 33.00 feet of the above described tract.

AND EXCEPT

That part of the Southwest Quarter of the Southeast Quarter in Section 11, Township 136 North, Range 39 West of the Fifth Principal Meridian in Otter Tail County, Minnesota, described as follows:

Commencing at a found iron monument which designates the south quarter corner of said Section 11; thence North 01 degree 06 minutes 16 seconds East 245.01 feet on an assumed bearing along the west line of said Southwest quarter of the Southeast Quarter to the intersection with a line which is 245.00 feet northerly of, as measured at a right angle to and is parallel with the south line of said Section 11, said point is the point of beginning; thence continuing North 01 degree 06 minutes 16 seconds East 756.02 feet along the west line of said Southwest Quarter of the Southeast Quarter; thence South 89 degrees 19 minutes 34 seconds East 43.65 feet to an iron monument; thence continuing South 89 degrees 19 minutes 34 seconds East 389.36 feet to an iron monument; thence South 01 degree 06 minutes 16 seconds West 756.02 feet to an iron monument on said parallel line; thence North 89 degrees 19 minutes 34 seconds West 400.01 feet along said parallel line to an iron monument; thence continuing North 89 degrees 19 minutes 34 seconds West 33.00 feet along said parallel line to the point of beginning. The above described tract contains 7.52 acres.

SUBJECT TO an easement for County State Aid Highway No. 8 right of way purposes and for 2nd Avenue Northeast right of way purposes over, under, and across that part of the above tract described as follows:

Beginning at the aforementioned point of beginning; thence south 89 degrees 19 minutes 34 seconds East 33.00 feet along said parallel line to an iron monument; thence North 01 degree 06 minutes 16 seconds East 163.16 feet; thence northerly on a curve concave to the west, having a central angle of 36 degrees 06 minutes 16 seconds and a radius of 122.25 feet, for a distance of 77.03 feet (chord bearing North 16 degrees 56 minutes 52 seconds West) to the easterly right of way line of said County State Aid Highway No. 8; thence northerly along the easterly right of way line of said County State Aid Highway No. 8 on a curve concave to the west, having a central angle of 16 degrees 04 minutes 05 seconds and a radius of 1507.39 feet, for a distance of 422.73 feet (chord bearing North 09 degrees 16 minutes 10 seconds East); thence North 01 degree 14 minutes 07 seconds East 104.01 feet continuing along the easterly right of way line of said County State Aid Highway No. 8; thence North 89 degrees 19 minutes 34 seconds West 25.95 feet to an iron monument; thence continuing North 89 degrees 19 minutes 34 seconds West 43.65 to the west line of said Southwest Quarter of the Southeast Quarter; thence south 01 degree 06 minutes 16 seconds West 756.02 feet along the west line of said Southwest Quarter of the Southeast Quarter to the point of beginning of said public road easements.

(Owners, Joseph and Rebecca Esser)

REC'D BY
MMB

MAR 7 4 2005

Section 2. Filing.

The City Manager is directed to file certified copies of this Ordinance with the Board of the Township in which the property is located, the Secretary of State, The County Auditor of the County in which the property is located, the Municipal Boundary Adjustment and any other parties as may be required pursuant to Minnesota Statutes 414.033, Subdivision 3.

Section 3. Effective Date of Annexation.

This Ordinance is effective and final on the date of publication and filing pursuant to Minnesota Statutes 414.033, Subdivision 3.

Adopted this 7th day of March 2005 by the City Council of Perham, Minnesota.

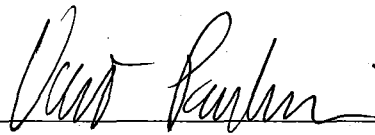

Mayor

ATTEST:

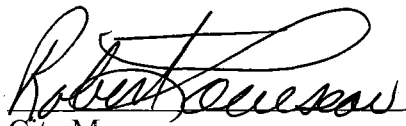

City Manager

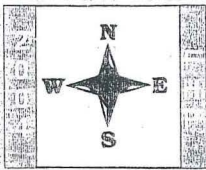

PERHAM ROAD MAP

© Farm & Home Publishers, Ltd.

REC'D BY
MMP

MAR 14 2005

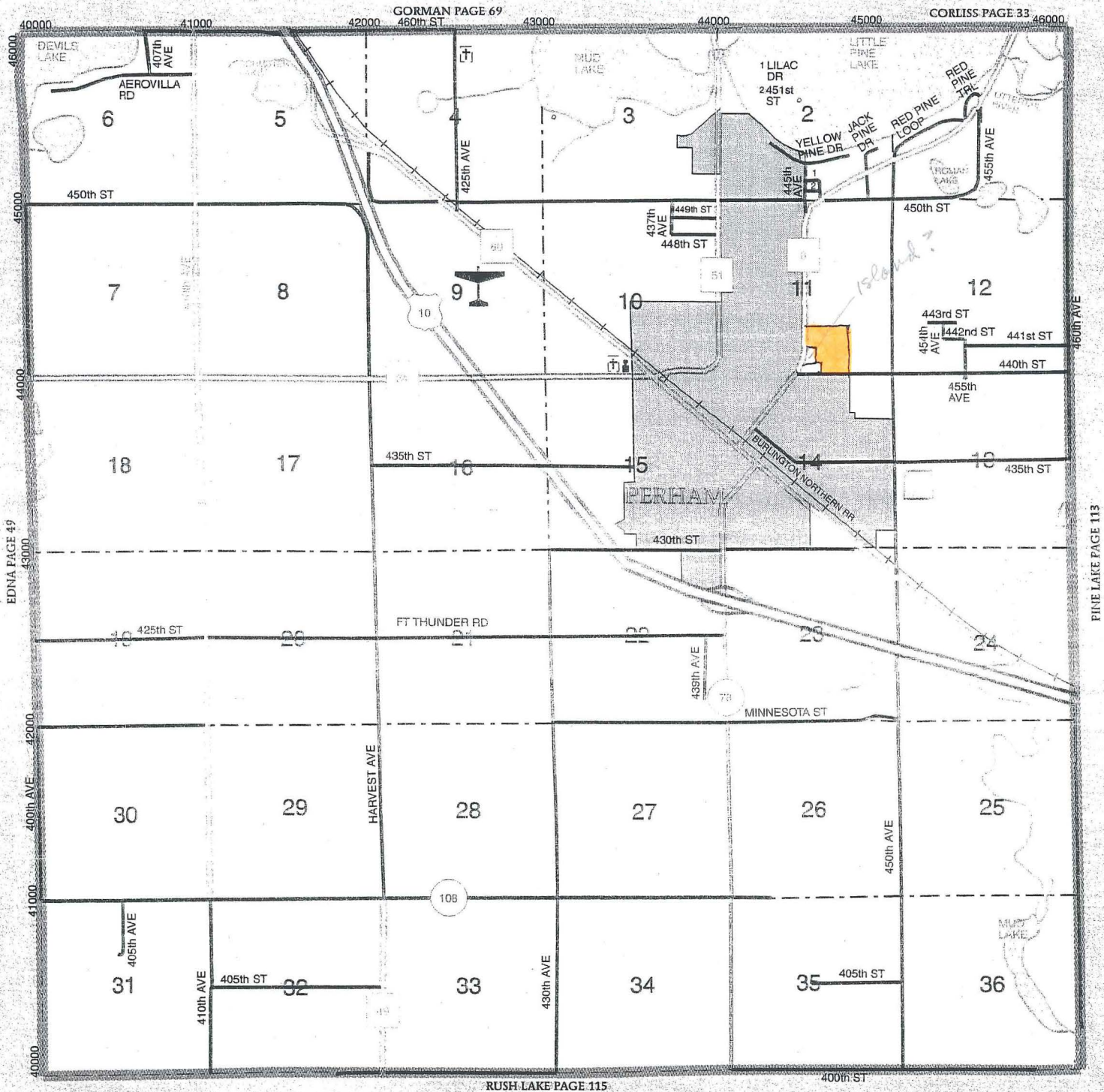
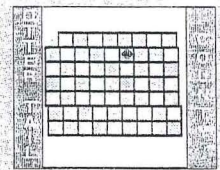

Century 21
Vista, Inc.

Cell: 218-770-0340
Mobile (500) 435-0340

Website www.kroshusauctioneers.com

Each Office is Independently Owned And Operated

Larry Kroshus
REALTOR®/Auctioneer



**EAST OTTER TAIL
CREDIT UNION**

NEW YORK MILLS & PERHAM, MN

24 Hr. "Otto" Teller 385-2620

ATM At NYMS Cenex C-Store

www.eastottertailcu.org

CHECKING ACCTS. SAVINGS • LOANS
ALL SAVINGS FEDERALLY INSURED TO 100,000

M-Th 8-5, Fri 8-6, Sat 9-12

385-2070
New York Mills

346-4450
Perham, MN

