

ORDINANCE NUMBER 62

**AN ORDINANCE PROVIDING FOR THE ANNEXATION OF CERTAIN PROPERTIES
LOCATED IN SIBLEY TOWNSHIP, CROW WING COUNTY, TO THE CITY OF
JENKINS, CROW WING COUNTY MINNESOTA, PURSUANT TO MINNESOTA
STATUTE 414.033**

THE CITY COUNCIL OF THE CITY OF JENKINS DOES ORDAIN:

SECTION ONE: That Wayne and Bonnie Witkop, the fee owners of certain property in the county of Crow Wing, State of Minnesota, legally described as follows:

Part of Government lot 2 described as beginning 33 feet south of the NW corner of said lot 2, the South road line of County Road 16, and then East 320 feet on said South line, then turn right 90 degrees and run 320 feet, on South Road line, then turn right 95 degrees and run 320 feet, then right 90 degrees and run West 320 feet parallel to road line, then Right 90 degrees and run 320 feet to the point of Beginning. Subject to mineral reservations of records. Containing approximately 2.35 acres. → 5/6
90

filed a petition with the City Council of the City of Jenkins pursuant to Minnesota Statutes Section 414.033, subdivision 2 (3). This property is located within Sibley Township of Crow Wing County. This area contains approximately 2.35 acres of land.

SECTION TWO: That Said realty abuts the City of Jenkins and is less than 60 acres in size.

SECTION THREE: That pursuant to Minnesota Statutes Section 414.033, Subdivision 13, the petitioners will see no change in their electric utility service at this time.

SECTION FOUR: That pursuant to Minnesota Statutes Section 414.033, Subdivision 2b, the City of Jenkins has held the required public hearing and notified the town along with all landowners within and contiguous to the area being annexed.

SECTION FIVE: That the City Council of the City of Jenkins deems the annexation of said realty to the City of Jenkins to be in the best interest of the City of Jenkins and the territory affected and accordingly, said realty is hereby annexed to the City of Jenkins as Residential (R) District so as to become and be part of the City of Jenkins and included within its cooperate limits and boundaries thereof.

SECTION SIX: That the population would increase by 2 adults.

SECTION SEVEN: The property taxes payable on the annexed land shall continue to be paid to the affected town for the year in which the annexation becomes effective. If the annexation becomes effective on or before August 1 of a levy year, the City may levy on the annexed area beginning with that same levy year. If the annexation becomes effective after

August 1, of a levy year, the town may continue to levy on the annexed area for that levy year, and the City may not levy on the annexed area until the following year. The first year following the year when the City could first levy on the annexed area property taxes on the annexed land shall be paid to the City. However, the city shall make a cash payment to the town for the period and in accordance with the following schedule:

- i. In the first year following the year the City could first levy on the annexed area, and amount equal to 90% of the property taxes distributed to the town in regard to the annexed area in the last year the property taxes from the annexed area were payable to the town;
- ii. In the second year, an amount equal to 70%;
- iii. In the third year, an amount equal to 50%;
- iv. In the fourth year and amount equal to 30%;
- v. In the fifth year, an amount equal to 10%.

SECTION EIGHT: This Ordinance shall take effect and be in force one week from and after its publication and is further subject to final approval of Minnesota Planning Municipal Boundary Adjustments.

Adopted this 13th day of May, 2002

CITY OF JENKINS



Dwight Heim
Mayor
City of Jenkins



Julie Ohr
City Clerk
City of Jenkins

Faxed
from Julie
5-24-02

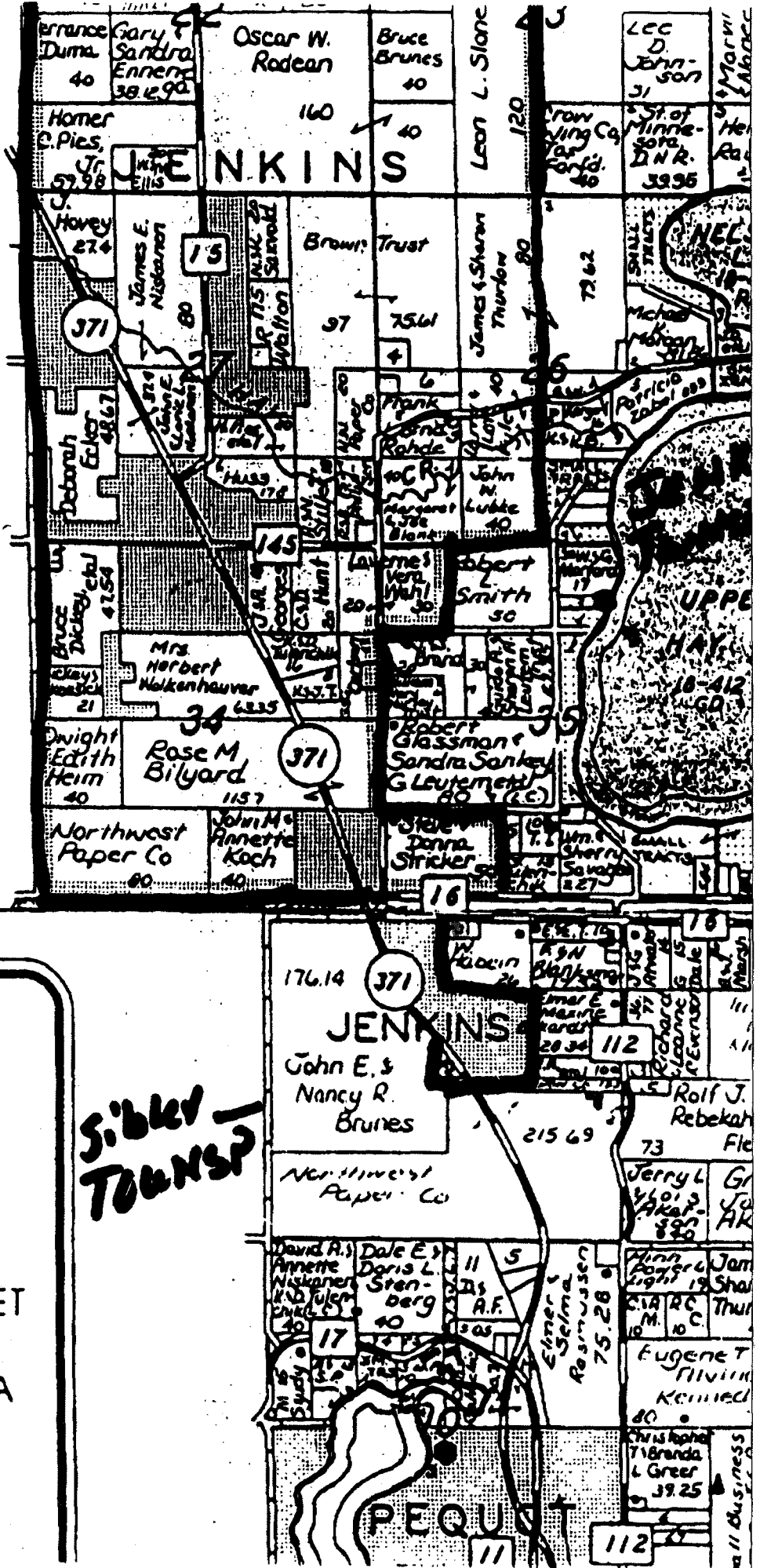

AN FAMILY
RANCE
BUSINESS HEALTH LIFE®

NSURANCE AGENCY

1/EST WOODMAN STREET

P.O. BOX 364

JOT LAKES, MINNESOTA

ONE: (218) 568-4620

AX: (218) 568-4344

MAY 24 2002

MAY 24 2002

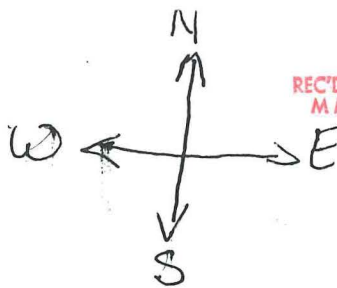

A-1687

Wayne & Bonnie
Withop
Annexation
#1

Theodore And Kimberly Elnet
Annexation #2.1

et
A-6688

p. 14

371

JENKINS

John E. &
Janey R.
Brunes

Northwest
Paper Co.

id A. §	Dale E. §
nto	Basia /

Dale E. 3

1

5

2

Minn.
Power