

ORDINANCE NO. 31
AN ORDINANCE EXTENDING THE CORPORATE LIMITS OF THE CITY OF PEMBERTON,
TO INCLUDE CERTAIN UNINCORPORATED PROPERTY IN MEDO TOWNSHIP,
BLUE EARTH COUNTY, OWNED BY THE CITY OF PEMBERTON
AND ABUTTING UPON THE CITY LIMITS

WHEREAS, the real estate described below is not presently within the corporate limits of any incorporated city; and

WHEREAS, the real estate abuts upon the corporate limits of the City of Pemberton, and is presently a city owned building presently used for storage and commercial rentals, and consists of approximately 4 acres; and

WHEREAS, this real estate is owned by the City of Pemberton and is about to be urban or suburban in character and the annexation is required to protect the public health, safety, and welfare and is in the best interests of the property proposed for annexation;

THE CITY COUNCIL OF THE CITY OF PEMBERTON, MINNESOTA ORDAINS:

SECTION 1. Real Estate Annexed. The corporate limits of the City of Pemberton are hereby extended to include the unplatted property described below, now owned by the City:

Commencing at the Northwest corner of the Northeast Quarter (NE $\frac{1}{4}$) of the Northwest Quarter (NW $\frac{1}{4}$) of Section Twelve (12), Township One Hundred Six (106), Range Twenty-five (25), and thence running east Twenty (20) rods on the north line of said Northwest Quarter (NW $\frac{1}{4}$) thence South thirty-two (32) rods parallel with the west line of said Northwest Quarter (NW $\frac{1}{4}$), thence west twenty (20) rods parallel with the north line of said Northwest Quarter (NW $\frac{1}{4}$) and thence north thirty-two (32) rods, parallel with said west line of said Northwest Quarter (NW $\frac{1}{4}$) to the point of beginning.

SECTION 2. Filing Copies. The City Clerk is directed to file copies of this ordinance with the County Auditor of Blue Earth County, the Town Clerk of Medo Township, and Minnesota Planning-Minnesota Boundary Adjustment.

SECTION 3. Effective Date of Annexation. This ordinance takes effect upon its passage and publication and the filing of copies as directed in Section 2.

Adopted this 11th day of February, 2002.

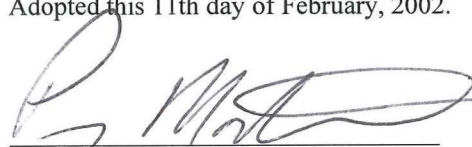

City of Pemberton
Mayor - Perry Mortensen

ATTEST:



Linda Groskreutz, City Clerk/Treasurer

N

REC'D BY
MMB MAR 05 2002

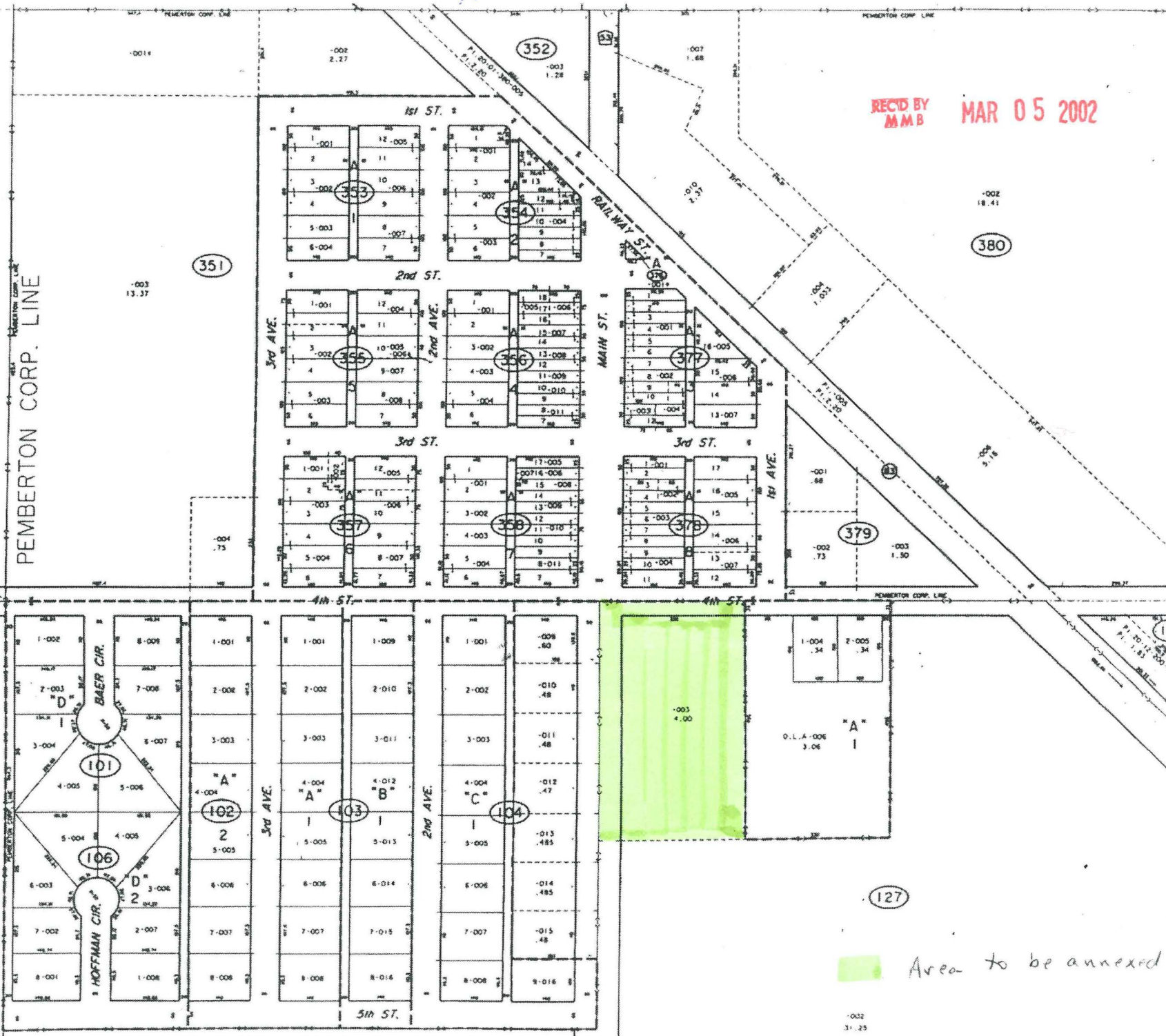

PEMBERTON CORP. LINE

Area to be annexed

S

002
31.25