

ORDINANCE NO. 211, THIRD SERIES
AN ORDINANCE OF ANNEXATION BY THE CITY OF NORTH MANKATO, MINNESOTA,
OF CERTAIN LAND TO-WIT:
PART OF THE NORTHEAST QUARTER OF THE NORTHEAST QUARTER
OF SECTION 3, TOWNSHIP 108 NORTH RANGE 27 WEST

THE CITY COUNCIL OF THE CITY OF NORTH MANKATO, MINNESOTA ORDAINS:

Section 1. The described tract of unincorporated property abuts the municipal limits of the City of North Mankato, Minnesota.

Section 2. The legal description of said land is as follows:

That part of the Northeast Quarter of the Northeast Quarter of Section 3 in Township 108 North Range 27 West, Nicollet County, Minnesota, which lies westerly of the westerly line of Northport No. 6, according to the plat thereof on file and of record with the Nicollet County Recorder.

Said annexation parcel contains 38.38 acres.

Section 3. Such land is now or is about to become urban or suburban in character.

Section 4. The land proposed for annexation is unplatted and contains 38.38 acres.

Section 5. The North Mankato City Council received petition dated February 2, 2002, bearing signatures of one hundred percent (100%) of the ownership interest in such land petitioned for annexation of the land to the City.

Section 6. Such land is hereby annexed to the City of North Mankato, Minnesota, and is declared to be included within its municipal limits.

Section 7. This ordinance shall be published once in the official newspaper of the City after adoption, signing and attestation and following this ordinance is approved by the Municipal Board of the State of Minnesota. The ordinance shall be in effect on and after the day following such publication.

Adopted by the Council this 4th day of March, 2002.

Mayor

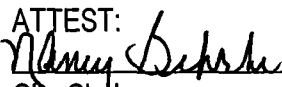
ATTEST:

City Clerk

REC'D BY
MMB

MAR 11 2002

RE: IN THE MATTER OF THE ANNEXATION OF CERTAIN LAND BY THE CITY OF
NORTH MANKATO, MINNESOTA, TO-WIT: PART OF THE NE 1/4 OF THE NE 1/4
OF SECTION 3, TOWNSHIP 108 NORTH RANGE 27 WEST

RE: CONSENT TO ANNEXATION PROCEDURE

TO: MINNESOTA MUNICIPAL BOARD

1. The Belgrade Township Board acknowledges receipt of a Notice of Intention to Annex Certain Land by the City of North Mankato concerning land which is described upon Exhibit A attached to this Consent.
2. It is understood that the Township Board has the right to submit written objections to such annexation to the Municipal Board and the City of North Mankato within ninety (90) days from the date of service of the Notice of Intention to Annex Certain Land.
3. The Belgrade Township Board waives its right to file such objections and consents to allowing the annexation procedure to proceed without further delay.

Signed this 5th day of March, 2002

BELGRADE TOWNSHIP BOARD

By: Steven M. Michels
President

By: Boris J. Hansen
Clerk

ISAIAH ESTATES

AREA OF ANNEXATION

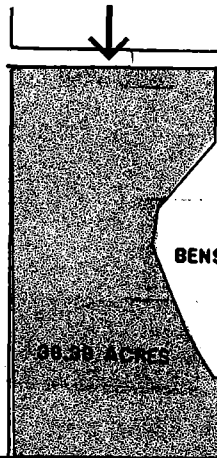

TIMM ROAD

BENSON PARK

66.38 ACRES

PRESIDENTIAL ESTATES

CARLSON DRIVE

ROUND TABLE LANE

ROUND TABLE COURT

CLAY LANE

EXCAVATOR ROAD

CLAY COURT

LANCLOT LANE

LANCLOT LANE

MORGAN WAY

WINCHESTER WAY

LANCLOT LANE

EXCAVATOR LANE

CLAY COURT

CLAY COURT

CLAY COURT

CLAY COURT

CLAY COURT

CLAY COURT

CLAY COURT

CLAY COURT

CLAY COURT

CLAY COURT

CLAY COURT

CLAY COURT

CLAY COURT

CLAY COURT

CLAY COURT

CLAY COURT

CLAY COURT

CLAY COURT

CLAY COURT

CLAY COURT

CLAY COURT

CLAY COURT

CLAY COURT

CLAY COURT

CLAY COURT

CLAY COURT

CLAY COURT

CLAY COURT

CLAY COURT

CLAY COURT

CLAY COURT

CLAY COURT

CLAY COURT

CLAY COURT

CLAY COURT

CLAY COURT

CLAY COURT

CLAY COURT

CLAY COURT

CLAY COURT

CLAY COURT

CLAY COURT

KINGHOFER DRIVE

LOOKOUT

HOWARD DRIVE

KINGSWAY DRIVE

WAY

CROWN DR.

SHEFFIELD

DRIVE

DRIVE

DRIVE

DRIVE

DRIVE

DRIVE

DRIVE

DRIVE

DRIVE

DRIVE

DRIVE

DRIVE

DRIVE

DRIVE

DRIVE

DRIVE

DRIVE

DRIVE

COMMERCE DRIVE

JAMES

COUNTRYSIDE

DRIVE

DRIVE

DRIVE

DRIVE

DRIVE

DRIVE

DRIVE

DRIVE

DRIVE

DRIVE

DRIVE

DRIVE

DRIVE

DRIVE

DRIVE

DRIVE

DRIVE

DRIVE

DRIVE

DRIVE

DRIVE

DRIVE

DRIVE

DRIVE

DRIVE

DRIVE

DRIVE

DRIVE

DRIVE

DRIVE

DRIVE

DRIVE

DRIVE

DRIVE

DRIVE

DRIVE

DRIVE

DRIVE

DRIVE

DRIVE

DRIVE

DRIVE

DRIVE

DRIVE

DRIVE

DRIVE

DRIVE

DRIVE