

REC'D BY  
MMB JAN 14 2002

**CITY OF BEMIDJI**  
**ORDINANCE NO. 306, 2<sup>ND</sup> SERIES**

**AN ORDINANCE ANNEXING PROPERTY  
ALONG DIVISION STREET NW  
TO THE CORPORATE LIMITS OF THE CITY OF BEMIDJI  
(Doug/Gloria Smart Property – 1819 Division Street NW)**

**WHEREAS**, certain properties, described below, are not presently included in the corporate limits of any incorporated city, village, or borough; and

**WHEREAS**, pursuant to M.S. 414.033, Subd. 2(3) the owner of said described properties has petitioned for annexation of such properties; and

**WHEREAS**, the properties are located adjacent to existing City boundaries and can receive city services; and

**WHEREAS**, the total area is 1.67 acres and is urban or suburban in character or about to become so; and

**WHEREAS**, there are 0 persons residing on the property; and

**WHEREAS**, the legal description of the property is as follows:

*Legal Description: Parcel #03-00067.03 (1819 Division Street NW)  
Section 7, Township 146, Range 033. The West 180 feet of the East 438 feet of the South 403 feet of the SE quarter of the SE quarter.*

**NOW, THEREFORE**, the Council of the City of Bemidji hereby ordains that the corporate limits of the City of Bemidji are hereby extended to include land as described, and the same is hereby annexed and included within the City of Bemidji as effectively as if it had originally been a part thereof.

This Ordinance shall become effective thirty (30) days after its passage, due publication thereof, and approval by the Minnesota Planning Agency.

Ayes:	South, Moen, Lehmann, Johnson, Downs, Erickson, Zachman
Nays:	None
Absent:	None
First Reading:	September 4, 2001
Second Reading:	September 17, 2001
Third Reading and passed:	November 5, 2001

Attest:

*Shirley J. Sherman*  
Shirley J. Sherman City Clerk

Approved:

*Richard Lehmann*  
Richard Lehmann, Mayor

REC'D BY  
MMB

JAN 11 2002

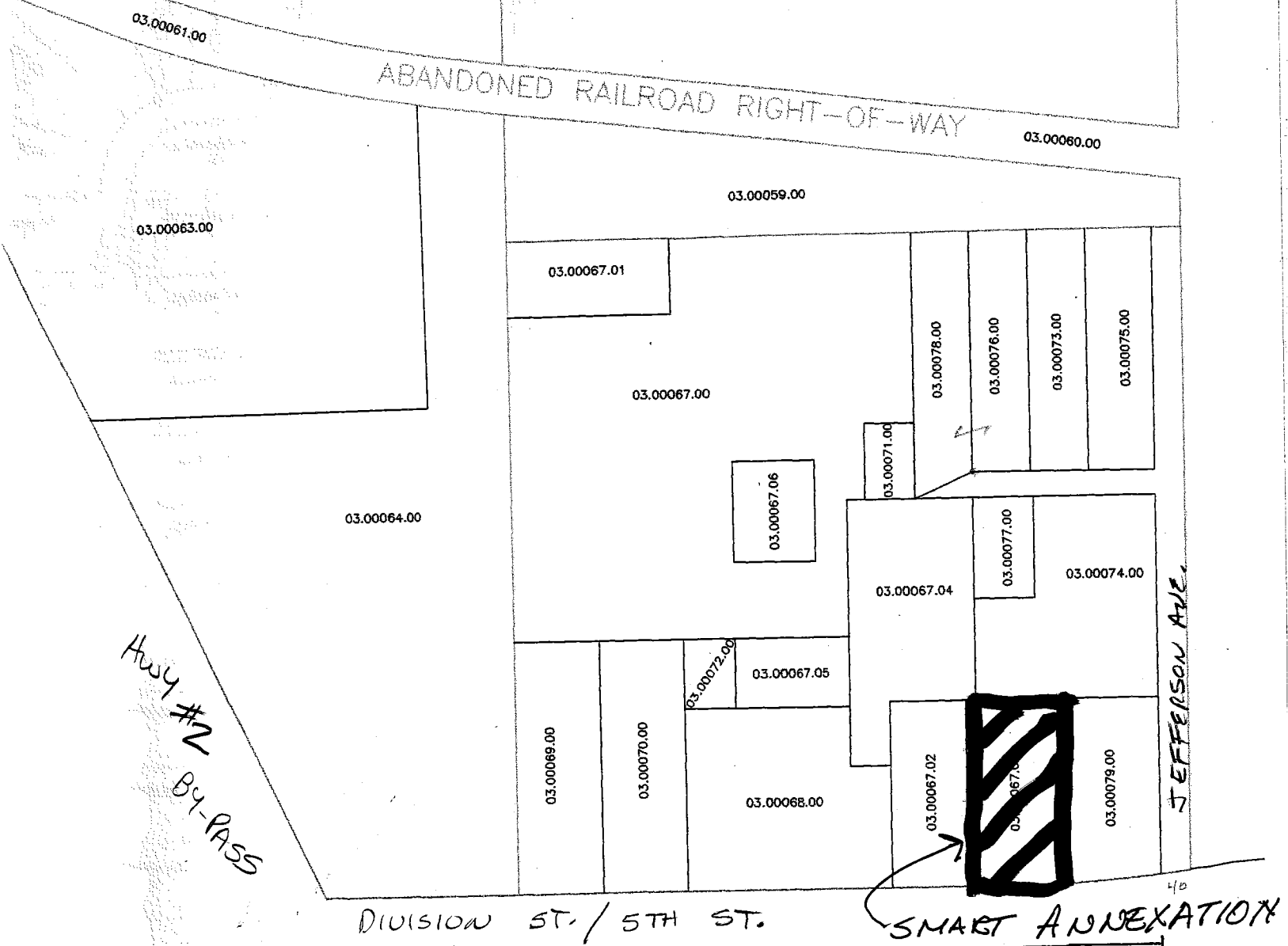

R IN THE BELTRAMI COUNTY OFFICES AFFECTING  
PURPOSES. THIS DRAWING SHOULD NOT BE  
INFORMATION ON THE ROAD RIGHT-OF-WAYS  
POSSIBLE FOR ANY INACCURACIES HEREIN CONTAINED.

# CITY OF BEMIDJI

BEMIDJI - BELTRAMI  
AIRPORT

POND

REC'D BY  
M.M.B. JAN 11 2002

PROPERTY TO  
BE ANNEXED

LAKE

BEMIDJI

LAKE

IRVING

MISSISSIPPI  
RIVER

CARR