

REC'D BY
MMB

DEC 17 2001

ORDINANCE NO. 3429

AN ORDINANCE ANNEXING TO THE CITY OF ROCHESTER APPROXIMATELY 198.21 ACRES OF LAND LEGALLY DESCRIBED AS A PART OF THE SOUTH HALF OF SECTION 4 AND A PART OF THE SOUTHWEST QUARTER OF SECTION 4, TOWNSHIP 107 NORTH, RANGE 14 WEST, OLMSTED COUNTY, MINNESOTA.

THE COMMON COUNCIL OF THE CITY OF ROCHESTER DO ORDAIN:

Section 1. A petition has been filed with the Common Council of the City of Rochester, signed by the owner of land described herein, requesting the Common Council to annex said land to the City of Rochester. The land described in said petition for annexation is described as follows:

That part of the South Half of Section 4, Township 107 North, Range 14 West, Olmsted County, Minnesota, described as follows:

Beginning at the southeast corner of the West Half of the Southeast Quarter of said Section 4; thence South 89 degrees 26 minutes 48 seconds West, assumed bearing, along the south line of said West Half, 1309.97 feet to the southeast corner of the Southwest Quarter of said Section 4; thence South 89 degrees 04 minutes 16 seconds West, along the south line of said Southwest Quarter, 225.00 feet; thence North 00 degrees 55 minutes 44 seconds West, 150.00 feet; thence North 23 degrees 51 minutes 33 seconds West, 1245.13 feet; thence North 11 degrees 29 minutes 58 seconds West, 1350.00 feet to the north line of said Southwest Quarter; thence North 89 degrees 11 minutes 09 seconds East, along said north line, 1000.00 feet to the northeast corner of said Southwest Quarter; thence North 89 degrees 11 minutes 08 seconds East, along the north line of the West Half of the Southeast Quarter of said Section 4, a distance of 1305.60 feet to the northeast corner of said West Half; thence South 00 degrees 06 minutes 11 seconds East, along the east line of said West Half, 2628.07 feet to the point of beginning.

Containing 118.55 acres, more or less.

Also:

That part of the Southwest Quarter of Section 4, Township 107 North, Range 14 West, described as follows:

Beginning at the southwest corner of the Southwest Quarter of said Section 4; thence North 00 degrees 09 minutes 28 seconds West, assumed bearing, along the west line of said Southwest Quarter, 2627.33 feet to the northwest corner of said Southwest Quarter; thence North 89 degrees 11 minutes 09 seconds East, along the north line of said Southwest Quarter, 1071.06 feet; thence South 13 degrees 45 minutes 16 seconds East, 625.18 feet; thence North 76 degrees 14 minutes 44 seconds East, 201.00 feet; thence South 01 degree 44 minutes 58 seconds East, 195.67 feet; thence South 10 degrees 19 minutes 31 seconds East, 143.93 feet; thence South 05 degrees 09 minutes 21 seconds West, 1698.91 feet; thence South 00 degrees 55 minutes 44 seconds East, 33.00 feet to the south line of said Southwest Quarter; thence South 89 degrees 04 minutes 16 seconds West, 1287.41 feet to the point of beginning.

Containing 79.66 acres, more or less.

Section 2. The total quantity of land included in said petition is approximately 198.21 acres in size.

Section 3. On October 15, 2001, the Common Council held a public hearing to consider this annexation petition after providing written notice of the hearing, by registered mail, to the property owner, the Cascade Township officers, and the adjacent property owners.

Section 4. The City provided notification to the petitioners pursuant to Minn. Stat. §414.033, subd. 2b, 11, 12 and 13 if applicable to this petitioned annexation.

Section 5. Following the public hearing, the Common Council of the City of Rochester determined that the land abuts the municipal limits, is less than 200 acres in area, the annexation petition is signed by all property owners of the land described in Section 1, there have been no written objections filed by the Cascade Township within 90 days of the date of service of the petition for annexation, and the land is or will soon become urban or suburban in character.

Section 6. Therefore, pursuant to Minn. Stat. §414.033, subd. 5, the land described in Section 1 above is hereby annexed, added to and made a part of the City of Rochester, Minnesota, as if it had originally been a part thereof.

Section 7. Present and future owners of the lands annexed by this ordinance are hereby notified that in addition to the usual assessments, it is the intention of the Common Council to assess against benefited property all or a portion of the cost of any storm sewer, water tower, pumping station, and trunk line sanitary sewer construction, heretofore or hereafter undertaken to serve the area annexed.

Section 8. This ordinance shall take effect and be in force from and after its official publication and from and after the filing of a certified copy hereof with the Minnesota Municipal Board, the Cascade Town Clerk, the County Auditor, and the Secretary of State.

PASSED AND ADOPTED BY THE COMMON COUNCIL OF THE CITY OF
ROCHESTER, MINNESOTA, THIS 19TH DAY OF November, 2001.

John Hanzel
PRESIDENT OF SAID COMMON COUNCIL

ATTEST: Judy Kay Shred
CITY CLERK

APPROVED THIS 20TH DAY OF November, 2001.

Charles Bonfield
MAYOR OF SAID CITY

(Seal of the City of
Rochester, Minnesota)

ANNEXATION EXHIBIT

75TH STREET NW

DESCRIPTION:
SEE ATTACHED:



NW CORNER SW1/4
SEC4-107-14

UNPLATTED

UNPLATTED

ANNEXATION AREA=
79.66 ACRES

ANNEXATION AREA=
118.55 ACRES

88 ST NW

MIDDEN LAKE VALLEY

BANDEL'S VICTOR

65TH STREET NW

EXISTING CITY LIMITS

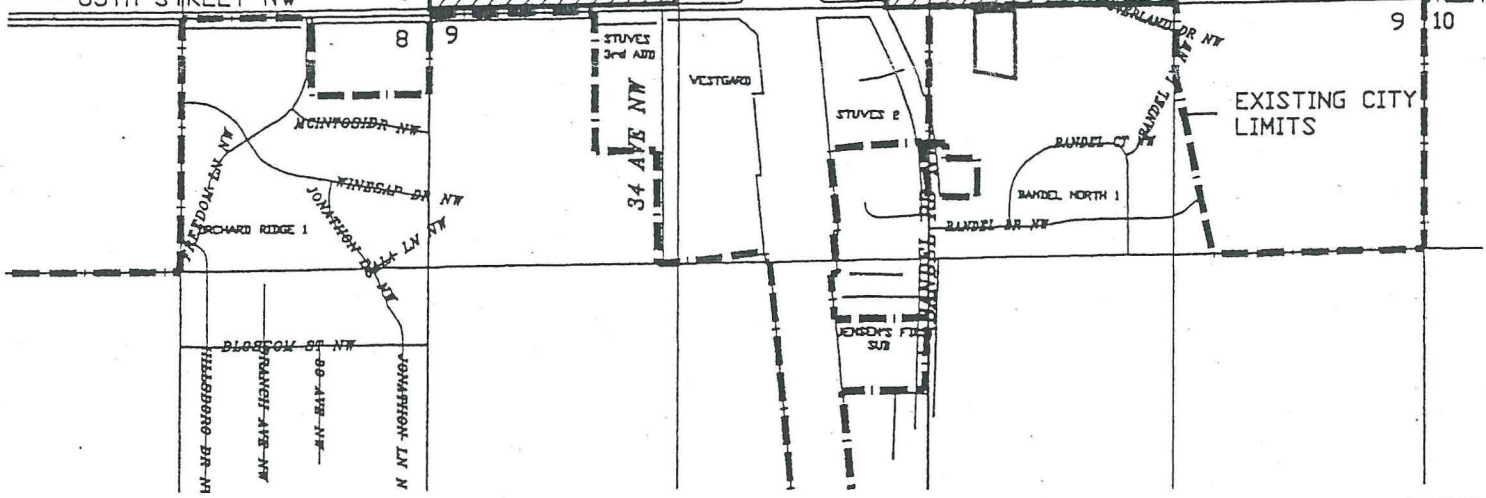

FOR NELSON COMPANY
1201 MEADOWLAKE COURT SW
ROCHESTER, MINNESOTA
55902
JOB NO. 1112B/0501

McGhie
Consulting Engineers

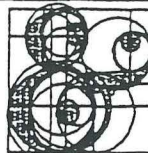

Betts, Inc.
Land Surveyors

1648 3rd AVE. SE. Rochester, MN 55904

507-289-3919

SCALE: 1" = 1000'

DRAWN BY: JLF

DATE: 09-07-01

ACCT. NO.: 1112B/0501

CADD NO.: ANNEX-EXHIBIT