

ORDINANCE NO. 121

ANNEXATION ORDINANCE ANNEXING 8.93 ACRES OF LAND INCLUDING
HIGHWAY RIGHT-OF-WAY TO THE CITY OF SPRING GROVE,
MINNESOTA.

THE CITY COUNCIL FOR THE CITY OF SPRING GROVE,
MINNESOTA, HEREBY ORDAINS THAT THE REAL ESTATE CONSISTING
OF 8.93 ACRES HEREINAFTER DESCRIBED IS HEREBY ANNEXED TO THE
CITY OF SPRING GROVE, MINNESOTA.

The Legal Description is as follows:

Commencing at the Southwest corner of Section 12, Township 101 North,
Range 7 West of the Fifth Principal Meridian; thence East along said section line a
distance of 534.03 feet to the point of beginning; thence North along the east line of
Tweeten Memorial Hospital First Addition to the City of Spring Grove a distance of
312.4 feet; thence East 1245 feet; thence South 312.4 feet to the South line of said
Section 12, thence West 1245 feet to the point of beginning containing 8.93 acres
more or less inclusive of Highway Right of Way.
Subject to Highway Right of Way and existing easements.

THE CITY COUNCIL FOR THE CITY OF SPRING GROVE APPROVES
THIS ANNEXATION BASED ON THE FOLLOWING FINDINGS:

1. The land adjoins the City of Spring Grove, Minnesota.
2. The land is located adjacent to 5th Avenue and Houston County Hwy. No. 27
and the topography is such that the lands are a natural extension of the City
boundaries of the City of Spring Grove, Minnesota.
3. City Services such as water, sewer and electric service are near the area and
can be extended by the city for its orderly development.

THE EFFECTIVE DATE OF THIS ORDINANCE SHALL BE FROM AND
AFTER ITS PASSAGE AND PUBLICATION ACCORDING TO LAW.

PASSED AND ENACTED BY THE CITY COUNCIL ON THE 18th DAY
OF September, 2001.

APPROVED:



Donald Sherburne, Mayor

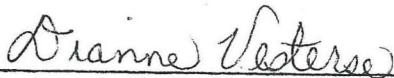

Dianne Vesterse, City Clerk

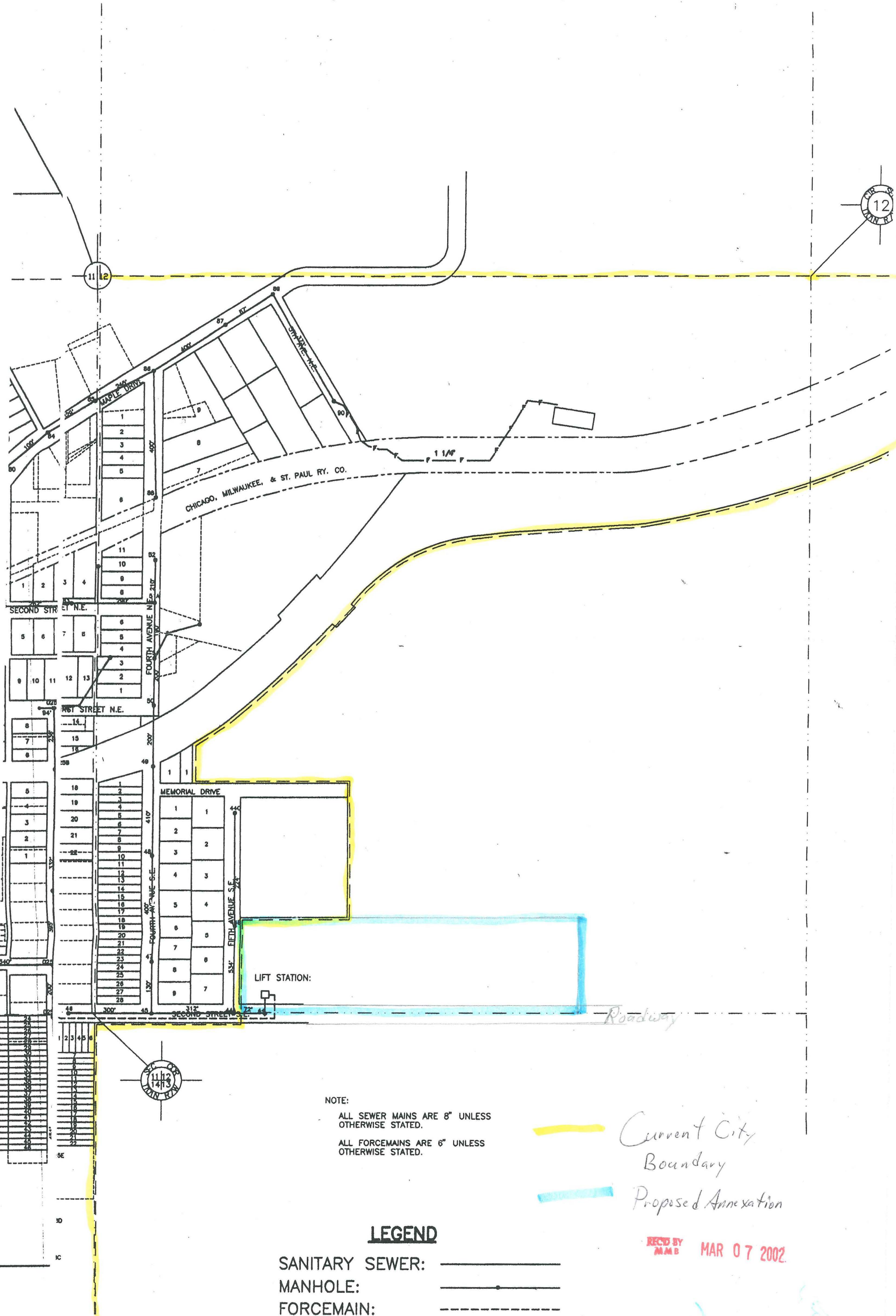

NOTE:
 ALL SEWER MAINS ARE 8" UNLESS OTHERWISE STATED.
 ALL FORCEMAINS ARE 6" UNLESS OTHERWISE STATED.

Current City Boundary
Proposed Annexation

LEGEND

SANITARY SEWER: _____
 MANHOLE: _____
 FORCEMAIN: _____

REC'D BY MAB MAR 07 2002