

PETITION TO ANNEX LAND TO THE CITY OF SPRING GROVE
MINNESOTA

DR. JAMES BEAMAN GRAY AND KAREN GRAY OF SPRING GROVE MINNESOTA AND THE CITY OF SPRING GROVE MINNESOTA, OWN LAND LEGALLY DESCRIBED ON THE ATTACHED EXHIBIT A. AS OWNERS OF THE ABOVE-DESCRIBED PARCEL, WE HEREBY PETITION THE CITY OF SPRING GROVE TO ANNEX THE LAND TO THE CITY OF SPRING GROVE, MINNESOTA.

WE BELIEVE THAT THIS LAND SHOULD BE ANNEXED TO THE CITY OF SPRING GROVE MINNESOTA FOR THE FOLLOWING REASONS:

1. THE LAND ADJOINS THE CITY OF SPRING GROVE.
2. THE LAND IS LOCATED ADJACENT TO 5TH AVENUE IN THE CITY OF SPRING GROVE AND HOUSTON COUNTY HWY. NO. 27 AND THE TOPOGRAPHY IS SUCH THAT THE LANDS ARE A NATURAL EXTENSION TO THE CITY BOUNDARIES OF THE CITY OF SPRING GROVE MINNESOTA.
3. CITY SERVICES, SUCH WAS WATER AND SEWER ARE LOCATED NEAR THE AREA AND CAN SERVICE THE LANDS IN QUESTION IN AN ORDERLY FASHION.
4. THE ANNEXATION OF THESE PROPERTIES WILL NOT AFFECT THE TOWNSHIP OF SPRING GROVE, MINNESOTA.

RESPECTFULLY SUBMITTED,

9/4/01

James B. Gray DVM
Dr. James Beaman Gray

9/4/01

Karen B. Gray
Karen Gray

THE CITY OF SPRING GROVE:

9/4/01

By: Donald Sherburne
Donald Sherburne, Mayor

ATTEST:

Dianne Vesterse
Dianne Vesterse, City Clerk

**Commencing at the Southwest corner of Section 12, Township 101 North, Range 7 West of the Fifth Principal Meridian; thence East along said section line a distance of 534.03 feet to the point of beginning; thence North along the east line of Tweeten Memorial Hospital First Addition to the City of Spring Grove a distance of 312.4 feet; thence East 1245 feet; thence South 312.4 feet to the South line of said Section 12, thence West 1245 feet to the point of beginning containing 8.93 acres more or less inclusive of Highway Right of Way.
Subject to Highway Right of Way and existing easements.**

EXHIBIT A.

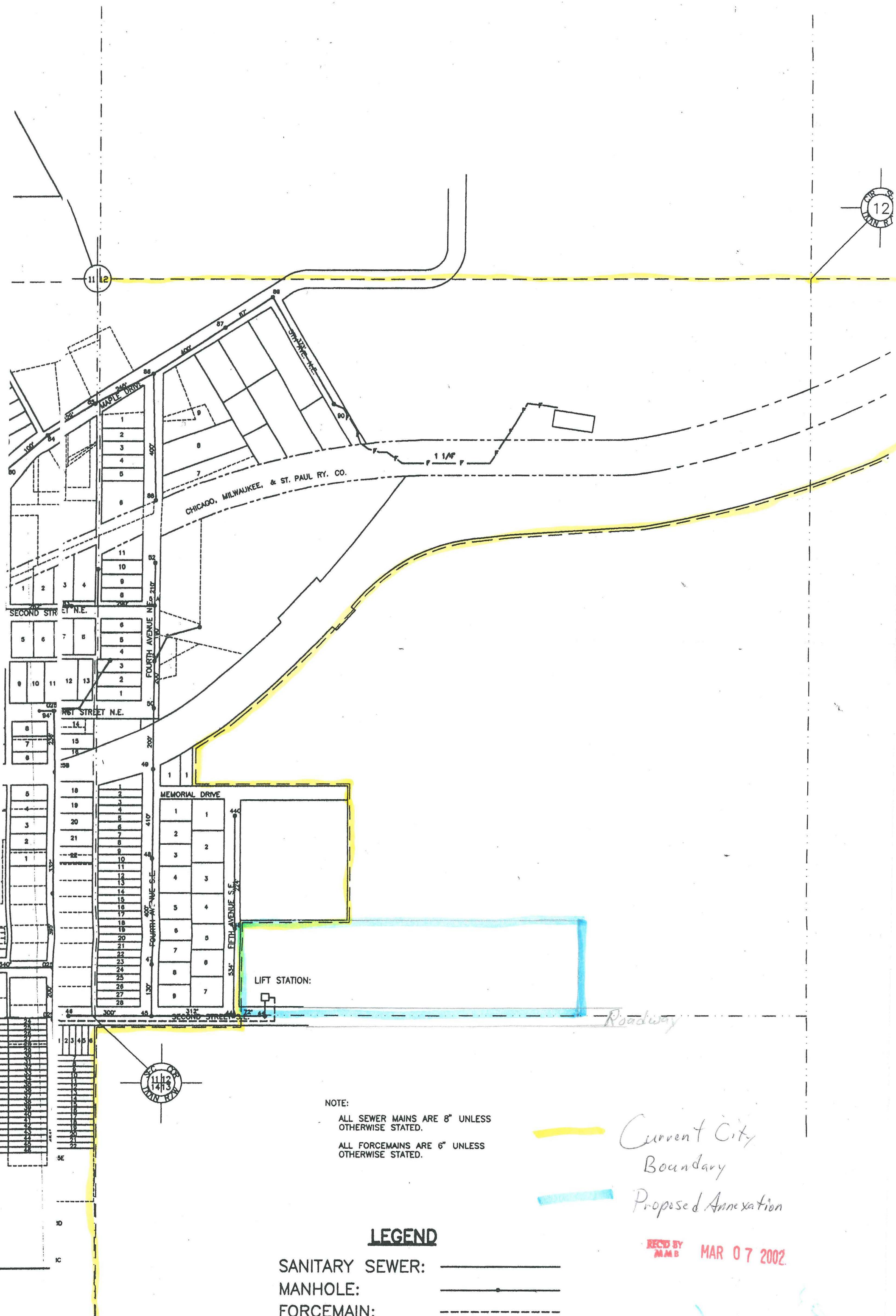

NOTE:
 ALL SEWER MAINS ARE 8" UNLESS OTHERWISE STATED.
 ALL FORCEMAINS ARE 6" UNLESS OTHERWISE STATED.

Current City Boundary
Proposed Annexation

LEGEND

SANITARY SEWER: _____
 MANHOLE: _____
 FORCEMAIN: _____

REC'D BY MAB MAR 07 2002