

CITY OF MONTICELLO
ORDINANCE NO. 366

AN ORDINANCE IN THE CITY OF MONTICELLO
ANNEXING LAND LOCATED IN THE TOWN OF MONTICELLO
WRIGHT COUNTY, MINNESOTA TO THE CITY OF MONTICELLO
WRIGHT COUNTY, MINNESOTA PURSUANT TO
MINNESOTA STATUTES 414.033 SUBDIVISION 2
ADMITTING ANNEXATION BY ORDINANCE

WHEREAS, Ocello, Inc., the owners of the property described in Exhibit attached hereto as Petition for Annexation; and

WHEREAS, the land described in Exhibit A attached hereto is unincorporated and abuts the corporate limits of the City of Monticello; and

WHEREAS, the property to be annexed, and as described in Exhibit A, is urban or suburban in character or is about to become urban or suburban in character by reason of the fact that the owner of the property proposes to subdivide and build residential properties ranging from 12,000 square foot lots to 20,000 square foot lots; and

WHEREAS, the population of the area to be annexed, as set forth in Exhibit A, is zero; and

WHEREAS, the City held a public hearing on the matter on the 10th day of September, 2001 and provided 30 days written notice by certified mail to the Township of Monticello and to all landowners within and contiguous to the area described in Exhibit A; and

WHEREAS, the property described in Exhibit A does not lie in a flood plain or shoreland;

NOW, THEREFORE, it is hereby ordained:

1. The property described in Exhibit A attached hereto is hereby annexed to the City of Monticello.

2. Annexation shall be final on the date this ordinance is approved by Minnesota Planning.

3. If the annexation becomes effective on or before August 1 of a levy year, the City of Monticello may levy on the annexed area beginning with that levy year. If the annexation becomes effective after August 1 of a levy year, the City of Monticello may continue to levy on the annexed area for that levy year. In the first year following the year when the Town of Monticello can levy on the annexed area as described on Exhibit A and thereafter property

taxes on the property described in Exhibit A shall be paid to the City of Monticello, but the City shall make a cash payment to the Township of Monticello in accordance with the following schedule:

(a) In the first year following the year the municipality could first levy on the annexed area an amount equal to 90% of the property taxes distributed to the township in regard to the annexed area and the last year the property taxes from the next area were payable to the town;

(b) in the second year an amount equal to 70%;

(c) in the third year an amount equal to 50%;

(d) in the fourth year an amount equal to 30%;

(e) in the fifth year an amount equal to 10%.

Dated this 10th day of September, 2001.



Roger Belsaas
Its: Mayor

Attest:



Rick Wolfstetter,
Its: City Administrator

EXHIBIT A

That part of the Northeast Quarter of Section 15, Township 121 North, Range 25 West, Wright County, Minnesota described as follows:

Commencing at the northwest corner of said Northeast Quarter of Section 15; thence on an assumed bearing of South 0 degrees 05 minutes 54 seconds West a distance of 30.01 feet along the west line of said Northeast Quarter to the point of beginning of the property to be described; thence South 88 degrees 26 minutes 47 seconds East a distance of 360.14 feet, parallel with the north line of said Northeast Quarter; thence South 00 degrees 05 minutes 54 seconds West a distance of 137.24 feet; thence South 49 degrees 35 minutes 12 seconds East a distance of 326.40 feet; thence South 02 degrees 16 minutes 26 seconds West a distance of 294.19 feet; thence South 16 degrees 24 minutes 19 seconds East a distance of 165.15 feet; thence South 36 degrees 57 minutes 06 seconds East a distance of 61.86 feet; thence South 22 degrees 52 minutes 08 seconds East a distance of 150.00 feet; thence North 67 degrees 07 minutes 52 seconds East a distance of 212.20 feet; thence North 75 degrees 50 minutes 26 seconds East a distance of 226.64 feet; thence North 00 degrees 34 minutes 06 seconds East a distance of 159.81 feet; thence easterly a distance of 127.64 feet along a nontangential curve concave to the south, having a central angle of 12 degrees 49 minutes 50 seconds, a radius of 570.00 feet, a chord bearing of North 84 degrees 29 minutes 57 seconds East and a chord of 127.38 feet; thence South 89 degrees 05 minutes 08 seconds East a distance of 244.12 feet; thence South 00 degrees 54 minutes 52 seconds West a distance of 193.98 feet; thence South 44 degrees 14 minutes 32 seconds East a distance of 166.93 feet; thence South 06 degrees 15 minutes 58 seconds East a distance of 172.75 feet; thence South 42 degrees 37 minutes 35 seconds West a distance of 172.75 feet; thence North 88 degrees 28 minutes 52 seconds West a distance of 172.75 feet; thence North 41 degrees 32 minutes 43 seconds West a distance of 132.88 feet; thence South 69 degrees 19 minutes 42 seconds West a distance of 1209.47 feet; thence North 49 degrees 31 minutes 00 seconds West a distance of 199.69 feet to said west line of the Northeast Quarter; thence North 00 degrees 05 minutes 54 seconds East, along said west line, a distance of 1498.25 feet to the point of beginning.

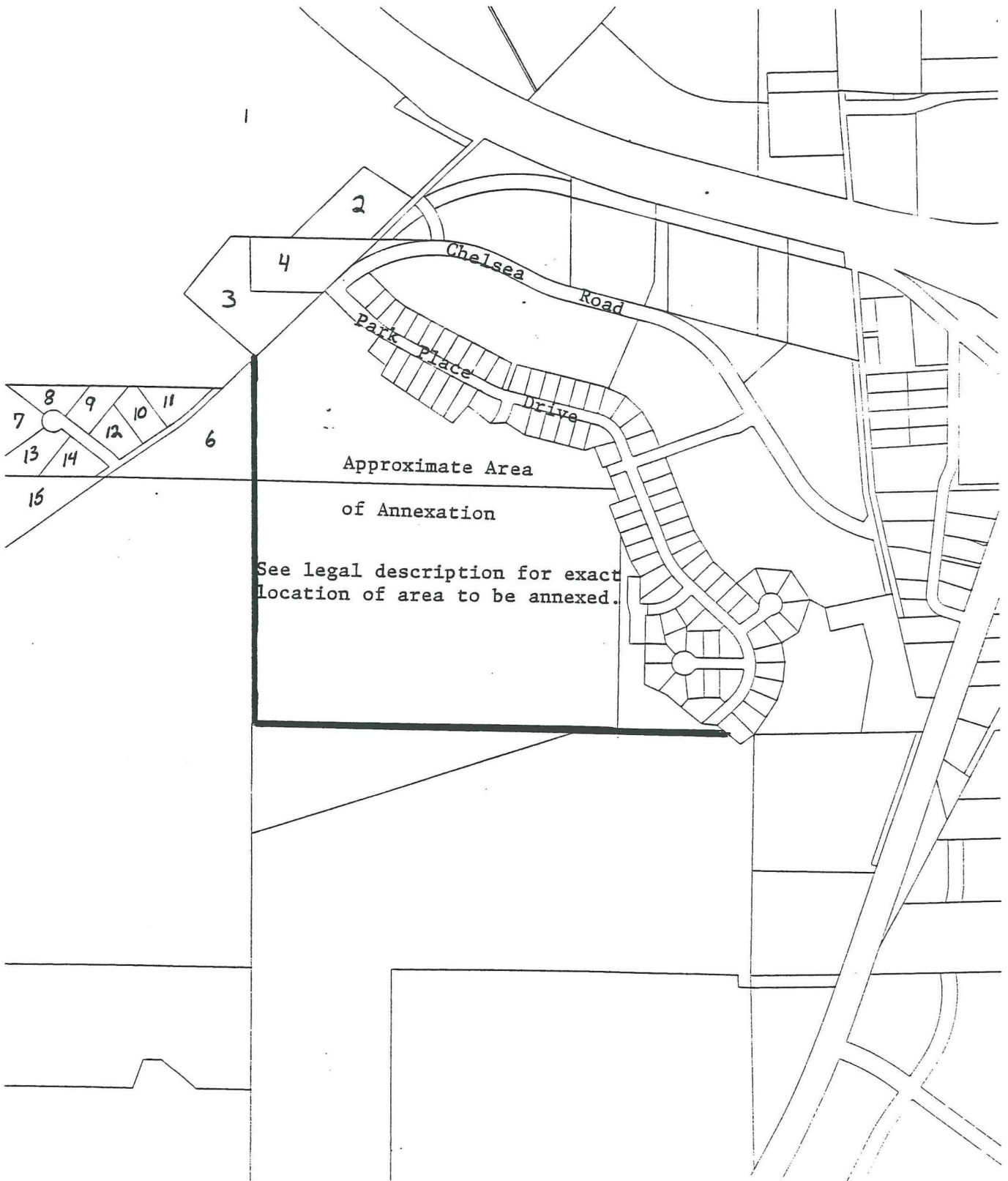

REC'D BY
M.M.B. OCT 02 2001

ANNEXATION
#5

ANNEXATION
#4

