

REC'D. BY
MMB MAR 08 2001

ORDINANCE NO. 289

AN ORDINANCE EXTENDING THE CORPORATE LIMITS OF THE CITY OF SLAYTON, MURRAY COUNTY, MINNESOTA, TO INCLUDE CERTAIN UNINCORPORATED UNPLATTED LAND NOT EXCEEDING 200 ACRES IN AREA ABUTTING UPON THE CITY LIMITS

WHEREAS, a certain Petition for Annexation requesting that certain territory described therein be annexed to the City of Slayton, Minnesota, has been duly presented to this City Council; and

WHEREAS, the quantity of land embraced within the area described in the petition and bounded as described consists of unplatted land not exceeding 2000 acres in area, no part of which is included within the limits of an incorporated city, or borough, and all provisions of M.S. 414.033, Subd. 13, were complied with; and

WHEREAS, the petition was signed by all owners; and

WHEREAS, no objections have been received from the Slayton Township Board or the county board and the boundaries of the land to be annexed do not abut upon the boundaries of any municipality except the City of Slayton; and

WHEREAS, the Slayton Township Board has passed a RESOLUTION OF WAIVER OF OBJECTION TO ANNEXATION stating it had no objections to the annexation and waiving the ninety (90) day period allowed it pursuant to M.S. 414.033, Subd. 5, to submit written objections to the annexation to the Minnesota Municipal Board and the City of Slayton; and

WHEREAS, the land described in the petition abuts upon the City limits at the south boundary thereof.

The Council of the City of Slayton, Minnesota, ordains:

Section 1. The City Council hereby determines (1) that the annexation will be in the best interests of the City and of the territory affected; (2) that the territory described herein abuts upon the City limits and is urban or suburban in character; and (3) that none of said territory is now included within the limits of any city, or borough.

Section 2. Territory Annexed. The corporate limits of the City are hereby extended to include the unplatted land described as follows and the same is hereby annexed to and included within the City as effectually as if it had originally been a part thereof:

A tract of land in the Northeast Quarter (NE $\frac{1}{4}$) of Section Twenty-two (22), Township One Hundred Six North (106N), Range Forty-one (41), West of the 5th P.M., Murray County, Minnesota, described as follows: Beginning at the northwest corner of said Northeast Quarter (NE $\frac{1}{4}$) of Section 22, Township 106N, Range 41W, which is the point of beginning; thence east along and upon the north boundary line of said Northeast Quarter (NE $\frac{1}{4}$) of Section 22, Township 106N, Range 41W, a distance of 300 feet; thence south and parallel with the west boundary line of said Northeast Quarter (NE $\frac{1}{4}$) of Section 22, Township 106N, Range 41W, a distance of 500 feet; thence west and parallel to the north boundary line of said Northeast Quarter (NE $\frac{1}{4}$) of Section 22, Township 106N, Range 41W, a distance of 300 feet to the west boundary line of said Northeast Quarter (NE $\frac{1}{4}$) of Section 22, Township 106N, Range 41W; thence north along and upon the west boundary line of said Northeast Quarter (NE $\frac{1}{4}$) of Section 22, Township 106N, Range 41W, a distance of 500 feet to the point of beginning. Said tract contains 3.44 acres, more or less.

REC'D. BY
MMB MAR 08 2001

Section 3. Filing. The City Clerk-Administrator is hereby directed to file copies of this ordinance with the Minnesota Municipal Board, the Minnesota Secretary of State, the Town Clerk of Slayton Township, and the Murray County Auditor/Treasurer.

Section 4. Effective Date. This ordinance takes effect upon its passage and publication and the filing of the certified copies as directed in Section 3, and the approval of the ordinance by the Minnesota Municipal Board.

Adopted by the City Council this 5th day of March, 2001.



MAYOR

ATTEST:



CLERK-ADMINISTRATOR

REC'D. BY
MMB FEB 09 2001

RESOLUTION OF WAIVER OF OBJECTION TO ANNEXATION

WHEREAS, the Township Board of Slayton Township, Murray County, Minnesota, has received a copy of a Petition for Annexation filed with the City Council of the City of Slayton, Murray County, Minnesota, which was signed by all of the owners of the land proposed to be annexed; and

WHEREAS, said land proposed to be annexed abuts the City of Slayton on the City's south boundary; and

WHEREAS, said land is urban or suburban in character;

NOW, THEREFORE, the Township Board of Slayton Township hereby waives the ninety (90) day period granted in M.S. 414.033, Subd. 5, to submit written objections to the annexation board and the City of Slayton so that the City of Slayton may, pursuant to M.S. 414.033, Subd. 5, annex the following described land:

A tract of land in the Northeast Quarter (NE $\frac{1}{4}$) of Section Twenty-two (22), Township One Hundred Six North (106N), Range Forty-one (41), West of the 5th P.M., in Slayton Township, Murray County, Minnesota, described as follows: Beginning at the northwest corner of said Northeast Quarter (NE $\frac{1}{4}$) of Section 22, Township 106N, Range 41W, which is the point of beginning; thence east along and upon the north boundary line of said Northeast Quarter (NE $\frac{1}{4}$) of Section 22, Township 106N, Range 41W, a distance of 300 feet; thence south and parallel with the west boundary line of said Northeast Quarter (NE $\frac{1}{4}$) of Section 22, Township 106N, Range 41W, a distance of 500 feet; thence west and parallel to the north boundary line of said Northeast Quarter (NE $\frac{1}{4}$) of Section 22, Township 106N, Range 41W, a distance of 300 feet to the west boundary line of said Northeast Quarter (NE $\frac{1}{4}$) of Section 22, Township 106N, Range 41W, a distance of 500 feet to the point of beginning. Said tract contains 3.44 acres, more or less.

Adopted by the township board of Slayton Township, Murray County, Minnesota this 6th day of February, 2001.

TOWNSHIP BOARD CHAIRMAN

ATTEST:

TOWNSHIP CLERK

CITY OF SLAYTON



CORPORATE LIMITS

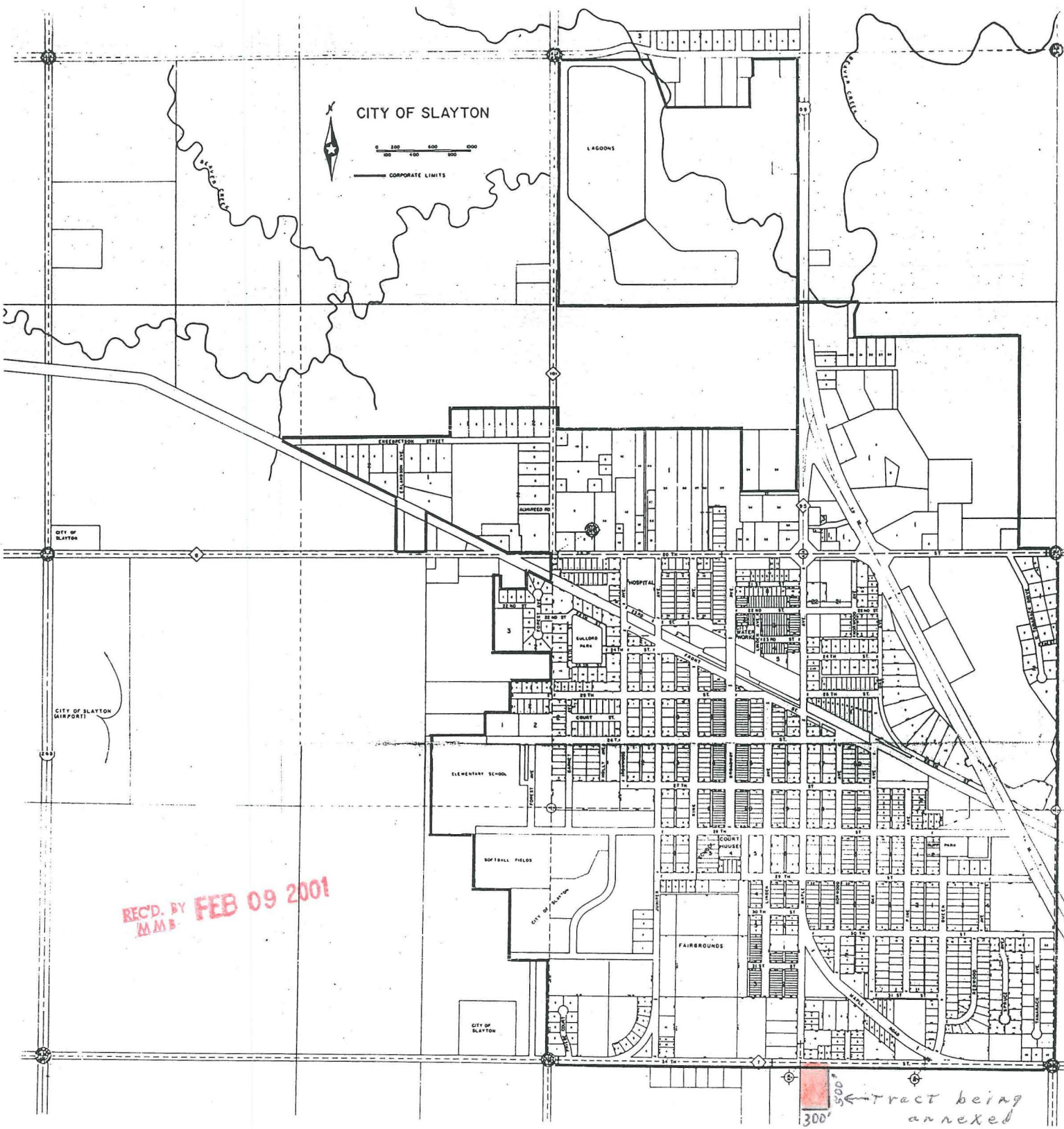

REC'D. BY
MMB FEB 09 2001

300' ← Tract being annexed