

REC'D. BY DEC 07 2000  
MMS

**CITY OF FARIBAULT**

**ORDINANCE 2000-18**

**AN ORDINANCE EXTENDING THE CORPORATE LIMITS  
OF THE CITY OF FARIBAULT  
TO INCLUDE CERTAIN UNPLATTED LAND  
NOT EXCEEDING 60 ACRES IN AREA  
ABUTTING THE CORPORATE LIMITS  
(MARK DUBE' PROPERTY)**

WHEREAS, a certain petition dated the 25<sup>th</sup> day of August, 2000, requesting annexation of the territory hereinafter described was duly presented to the City Council on the 5<sup>th</sup> day of September, 2000; and

WHEREAS, the petition was signed by the owner of said property; and

WHEREAS, a resolution of waiver of objection to annexation of property to the City of Faribault, dated the 10<sup>th</sup> day of October, 2000, has been received from the Walcott Township Board; and

WHEREAS, the land described in the petition abuts the corporate limits of the City of Faribault.

**THE CITY OF FARIBAULT ORDAINS:**

**Section 1:** The City Council hereby determines: 1) the territory described herein abuts upon the city limits and is urban or suburban in character; and 2) none of the territory is now included within the limits of any city.

**Section 2:** The population of the territory is 4.

**Section 3:** The property being annexed will be zoned R-1, Single Family Residential District. The intent of this district is to provide for an environment of predominantly low density, single family dwellings, and directly related, complementary uses.

**Section 4: Territory Annexed.** The corporate limits of the city are hereby extended to include the unplatted land described as follows and the same is hereby annexed to and included within the city as effectually as if it had originally been a part thereof:

Part of the North one-half of the Northwest Quarter, Section 8, T109N-R20W, Rice County, Minnesota, and more specifically described in attached Exhibit A;

**Section 5: Filing.** The City Administrator is hereby directed to file certified copies of this ordinance with the Minnesota Municipal Board, the Walcott Town Clerk, the Rice County Auditor, and the Rice County Recorder.

**Section 6: Effective Date.** This ordinance takes effect upon its passage and publication and the filing of the certified copies as directed in Section 5, and approval of the ordinance by the Minnesota Municipal Board.

First Reading: November 14, 2000

Second Reading: November 28, 2000

  
\_\_\_\_\_  
Mayor

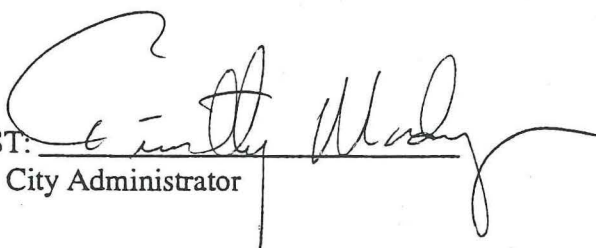
ATTEST:   
\_\_\_\_\_  
City Administrator

REC'D. BY  
ALB DEC 07 2000

## Exhibit A

### Legal Description Mark Dube' property

Part of the North one-half of the Northwest Quarter of Section 8, T109N-R20W, Fifth Principal Meridian, Rice County, Minnesota, described as follows:  
Beginning at the Northwest corner of said Northwest Quarter; thence Southerly, along the West line of said North one-half of Northwest Quarter (for purposes of this description bearing of said West line is assumed South 0°03'22" West), a distance of 1150.17 feet to a point in the center line of a township road and the true point of beginning of the parcel to be herein described; thence continue along said West line South 0°03'22" West, 173.38 feet to the Southwest corner of said North one-half of Northwest Quarter; thence South 89°43'18" East, along the South line of said North one-half of Northwest Quarter, 1086.94 feet; thence North 12°41'45" East, 300.00 feet to a point in the center line of County State Aid Highway 19; thence North 48°46'47" West, along said highway center line, 615.08 feet; thence South 51°49'22" West, 213.25 feet; thence South 89°59'29" West, 202.05 feet; thence South 7°37'08" West, 204.69 feet; thence South 57°48'24" West, 346.49 feet to said true point of beginning; subject to said township road over the Westerly side and said Highway 19 over the Northeasterly side of the herein described parcel; containing 12.146 acres, more or less, including said road and highway rights of way, and containing 11.280 acres, more or less, excluding said road and highway rights of way.



REC'D. BY  
MMB DEC 07 2000

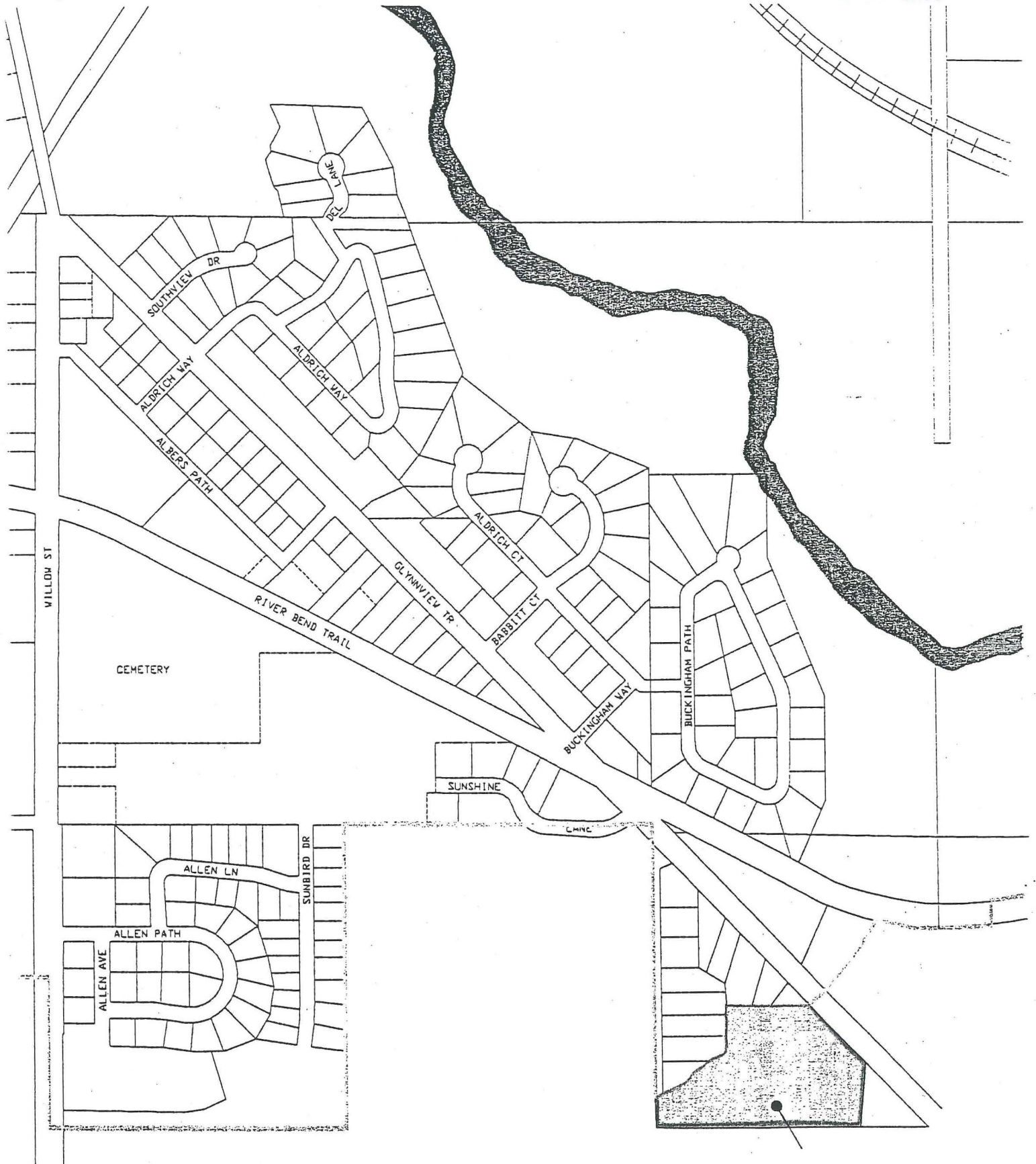

PETITION AREA