

285966

Document No.  
285966



REC'D. BY MAR 08 2001  
MAB  
OFFICE OF COUNTY RECORDER  
County of Le Sueur, MN

No. of Pages: ☒ Well Certificate NOT REQ'D  
2 ☐ Well Certificate Rec'd

I hereby certify that the within instrument was filed in this office  
for record on 02-21-2001 at 01:00 ☐ AM ☒ PM



02212001  
*Denise M. Wolf, Deputy*  
DAVID A. SEKE,  
COUNTY RECORDER

**ORDINANCE NO. LC 02132001**

AN ORDINANCE EXTENDING THE CORPORATE LIMITS OF THE CITY OF LE CENTER TO INCLUDE CERTAIN UNINCORPORATED PROPERTY ABUTTING UPON THE LIMITS OF THE CITY.

WHEREAS, The territory described below is not presently within the corporate limits of any incorporated city; and

WHEREAS, this territory abuts upon the corporate limits of the City of Le Center on the Easterly boundary thereof and is deemed to be urban or suburban in character; and

WHEREAS, the perimeter of the area to be annexed is 60% or more bordered by Le Center; and

WHEREAS, the territory to be annexed consists of 37.7 acres.

**THE CITY OF LE CENTER HEREBY ORDAINS:**

Section 1. Territory Annexed. The corporate limits of the City of Le Center are hereby extended to include the property described as follows:

Beginning at a point on the South line of the Southwest Quarter of Section 28-111-24, Le Sueur County, Minnesota, 933 feet East of the Southwest corner of said Section 28; thence East along the South line of said Section 28, 300 feet; thence North on a line parallel to the West line of said Section 28, 3960 feet more or less to the South line of the North Half of the Northwest Quarter of said Section 28, said South line of North Half of Northwest Quarter also being the South line of Outlot B of Sunrise Addition in the City of Le Center; thence West along the said South line of Outlot B to the Southwest corner of said Outlot B, thence North 165 feet; thence North 89 degrees 53 minutes 00 seconds West 280 feet to the East line of State Avenue in the City of Le Center, thence South along said East line of State Avenue 472.7 feet to the Southwest corner of Lot 2, Block 1

285966

of G.W. Dickinson's Second Addition, City of Le Center; thence East along the South line of said Lot 2 to the Southeast corner of said Lot 2, which corner is also the Northeast corner of Lot 3, Block 1, G.W. Dickinson's Second Addition, City of Le Center; thence South along the East line of said Lot 3 and along its Southerly extension to the center of Woodlawn Street in the City of Le Center; thence East along the centerline of said Woodlawn Street 186 feet; thence South 33 feet to the Northeast corner of Lot 1, Block 2, G.W. Dickinson's Second Addition, City of Le Center; thence South along the East line of Lot 1, Block 2, G.W. Dickinson's Second Addition, City of Le Center 443.27 feet; thence East 127.5 feet; thence South 165 feet to the North line of Washington Street in the City of Le Center; thence East along the North line of said Washington Street to the East line of Sunrise Avenue in the City of Le Center; thence South along the East line of Sunrise Avenue to a point 66 feet East of the Northeast corner of Lot 9, Block 1, Emery's Addition in the City of Le Center; thence West 66 feet to the Northeast corner of said Lot 9, Block 1, Emery's Addition; thence South along the East line of Block 1 of Emery's Addition of the City of Le Center and its Southerly extension to the point of beginning. Consisting of 37.7 acres more or less.

Section 2. Filing. The City Clerk is directed to file certified copies of this ordinance with the Secretary of State, the County Auditor of the County in which the property is located, and the Town Clerk of the affected Township.

Section 3. Electric Utility Service Notice. Notice of change in the electric utility service has been given pursuant to M.S. 414.033, Subd. 13.

Section 4. Effective Date of Annexation. This ordinance takes effect upon its passage by the City of Center, the filing of copies as directed in Section 2, and approval by the Minnesota Planning Commission.

Adopted by the City of Le Center, Minnesota, this 13th day of February, 2001.

ATTEST:

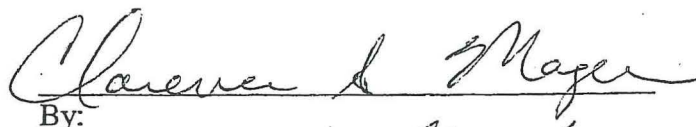

By:

Its: Mayor



By: Myles McGrath

Its: City Clerk

EXHIBIT B

REC'D. BY NOV 28 2000  
MAM B

3960 +

#2  
37.7  
AC

300'

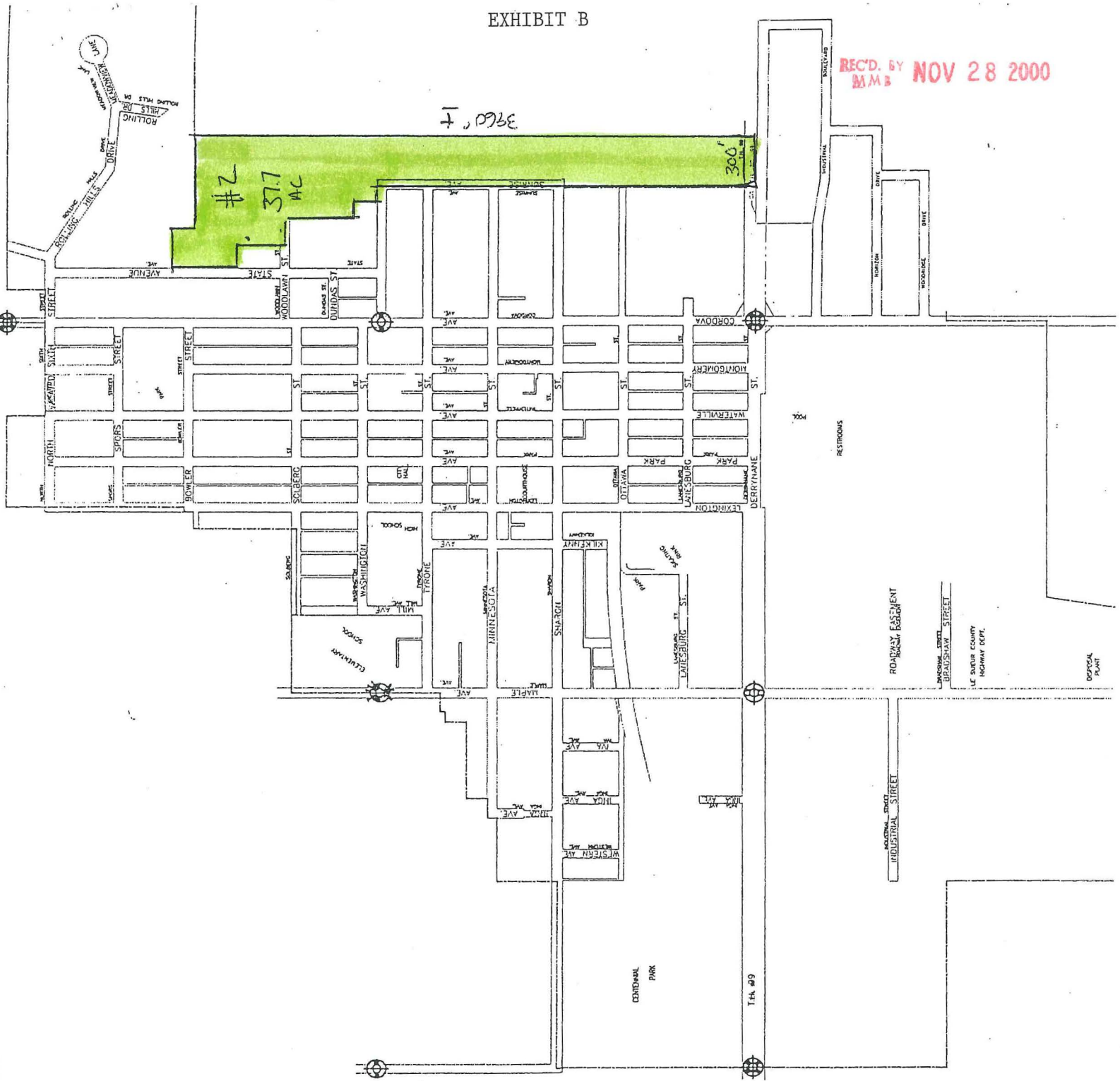



REC'D. BY  
MAY 15 2000

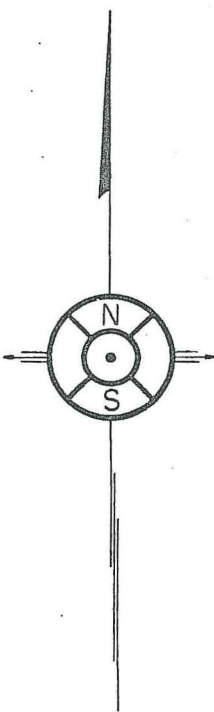

CITY OF LE CENTER,  
MINNESOTA

DRAWN: MAY, 1958

BRADSHAW  
ENGINEERING