

## NOTICE OF INTENT TO ANNEX PROPERTY

TO: The Lexington Township Board of Supervisors  
c/o Wilmar Tiede  
Route 2, Box 229  
Le Center, MN 56057

REC'D. BY  
MMA NOV 28 2000

Minnesota Planning Municipal Boundary Adjustments  
658 Cedar Street, Room 300  
St. Paul, MN 55155

You are hereby notified that the City of Le Center intends to annex the property described on attached Exhibit A and further delineated on the map attached as Exhibit B. Said property consists of 37.7 acres and the perimeter of the 37.7 acres is 60% or more bordered by the City of Le Center. This Notice of Intent to Annex is being served upon you pursuant to Minnesota Statute 414.033, Subd. 3.

Dated: November 22, 2000.

By:

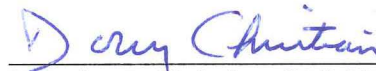

Douglas J. Christian, ID# 187203  
Attorney for the City of Le Center  
Christian, Spartz, Keogh & Christian  
65 South Park Avenue  
P.O. Box 156  
Le Center, MN 56057  
507-357-2278

**EXHIBIT A**

Beginning at a point on the South line of the Southwest Quarter of Section 28-111-24, Le Sueur County, Minnesota, 933 feet East of the Southwest corner of said Section 28; thence East along the South line of said Section 28, 300 feet; thence North on a line parallel to the West line of said Section 28, 3960 feet more or less to the South line of the North Half of the Northwest Quarter of said Section 28, said South line of North Half of Northwest Quarter also being the South line of Outlot B of Sunrise Addition in the City of Le Center; thence West along the said South line of Outlot B to the Southwest corner of said Outlot B, thence North 165 feet; thence North 89 degrees 53 minutes 00 seconds West 280 feet to the East line of State Avenue in the City of Le Center, thence South along said East line of State Avenue 472.7 feet to the Southwest corner of Lot 2, Block 1 of **G.W. Dickinson's Second Addition**, City of Le Center; thence East along the South line of said Lot 2 to the Southeast corner of said Lot 2, which corner is also the Northeast corner of Lot 3, Block 1, G.W. Dickinson's Second Addition, City of Le Center; thence South along the East line of said Lot 3 and along its Southerly extension to the center of Woodlawn Street in the City of Le Center; thence East along the centerline of said Woodlawn Street 186 feet; thence South 33 feet to the Northeast corner of Lot 1, Block 2, G.W. Dickinson's Second Addition, City of Le Center; thence South along the East line of Block 2, G.W. Dickinson's Second Addition, City of Le Center 443.27 feet; thence East 127.5 feet; thence South 165 feet to the North line of Washington Street in the City of Le Center; thence East along the North line of said Washington Street to the East line of Sunrise Avenue in the City of Le Center; thence South along the East line of Sunrise Avenue to a point 66 feet East of the Northeast corner of Lot 9, Block 1, Emery's Addition in the City of Le Center; thence West 66 feet to the Northeast corner of said Lot 9, Block 1, Emery's Addition; thence South along the East line of Block 2 of Emery's Addition of the City of Le Center and its Southerly extension to the point of beginning. Consisting of 37.7 acres more or less.

EXHIBIT B

REC'D. BY NOV 28 2000  
MAM

3960 +

#2  
37.7  
AC

300'

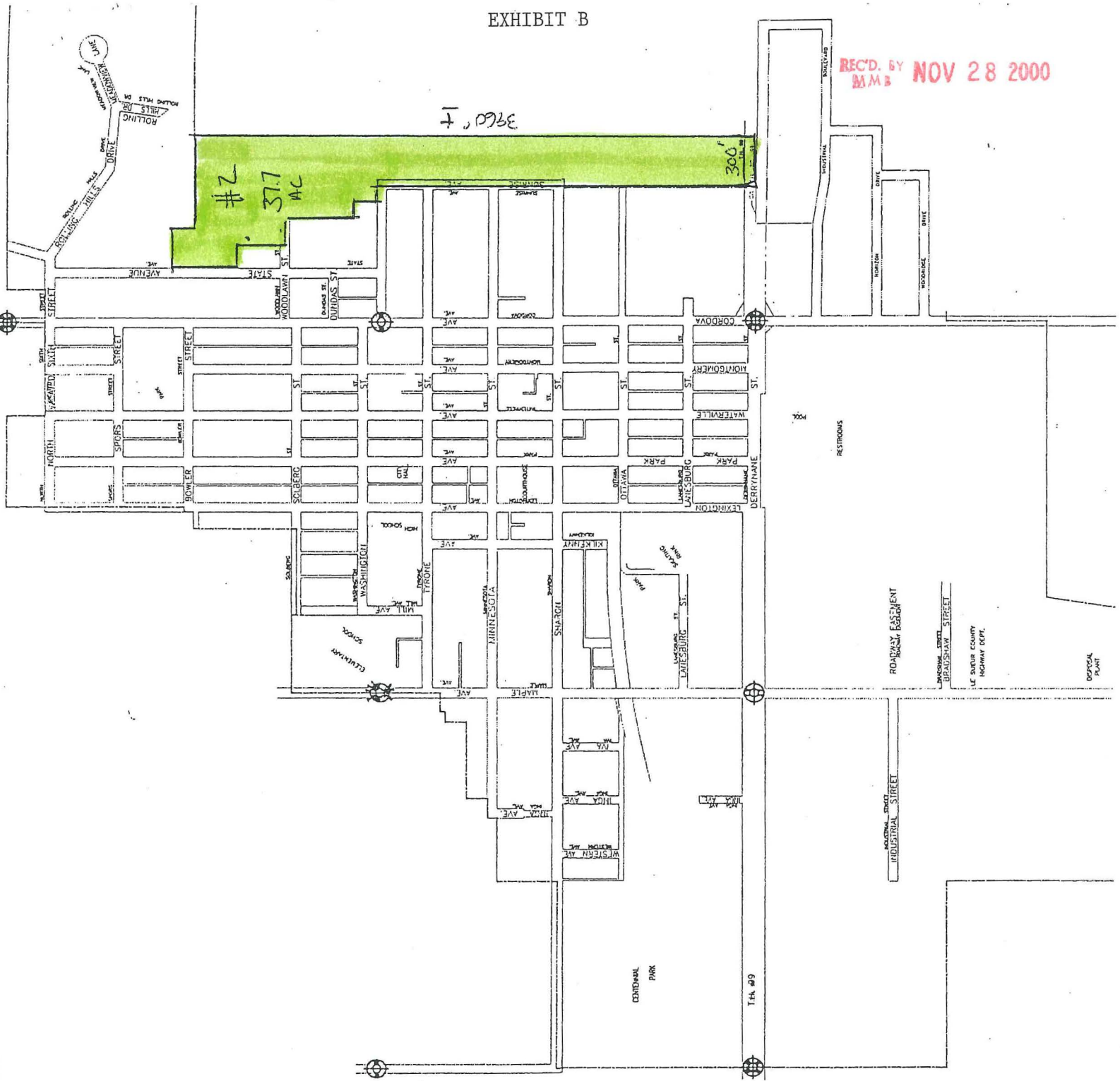



A hand-drawn compass rose is centered on a vertical line. The rose has a circular face with a smaller circle inside, creating a ring. The letters 'N' and 'S' are written at the top and bottom of the ring, respectively. Four lines radiate from the center to the outer edge, dividing the circle into four quadrants. The vertical line passes through the center of the rose, and a horizontal line crosses it at the level of the rose. The vertical line continues above and below the rose, with a small arrowhead pointing upwards at the top. The horizontal line has small arrowheads at both ends.

