

REC'D. BY  
M M B APR 03 2000

ORDINANCE NO. 3318

AN ORDINANCE ANNEXING TO THE CITY OF ROCHESTER APPROXIMATELY 10.93 ACRES OF LAND LOCATED IN A PART OF THE SOUTHWEST QUARTER OF SECTION 29, THE SOUTHEAST QUARTER OF THE NORTHEAST QUARTER OF SECTION 30, AND THE NORTHEAST QUARTER OF THE SOUTHEAST QUARTER OF SECTION 30, TOWNSHIP 107 NORTH, RANGE 13 WEST, OLMSTED COUNTY, MINNESOTA.

THE COMMON COUNCIL OF THE CITY OF ROCHESTER DO ORDAIN:

Section 1. A petition has been filed with the Common Council of the City of Rochester, signed by the owner of land described herein, requesting the Common Council to annex said land to the City of Rochester. The land described in the petition for annexation is described as follows:

That part of the Southwest Quarter of the Northwest Quarter and the Northwest Quarter of the Southwest Quarter of Section 29, and the Southeast Quarter of the Northeast Quarter and the Northeast Quarter of the Southeast Quarter of Section 30, all in Township 107 North, Range 13 West, Olmsted County, Minnesota, described as follows:

Commencing at the southeast corner of the Southeast Quarter of the Northeast Quarter of said Section 30; thence westerly on a Minnesota State Plane Grid Azimuth from north of 269 degrees 29 minutes 20 seconds along the south line of said Southeast Quarter of the Northeast Quarter 270.01 feet to the east line of Century Hills Second

Subdivision, according to the plat thereof on file at the County Recorder's Office, Olmsted County, Minnesota, and the point of beginning; thence southerly 178 degrees 58 minutes 31 seconds azimuth along said west line 32.42 feet; thence westerly 268 degrees 58 minutes 31 seconds azimuth along said west line 46.50 feet; thence southerly 178 degrees 58 minutes 31 seconds azimuth along said west line 140.00 feet; thence easterly 88 degrees 58 minutes 31 seconds azimuth along said west line 46.50 feet; thence southerly 178 degrees 58 minutes 31 seconds azimuth along said west line and along the west line of Century Hills Third Subdivision, according to the plat thereof on file at the County Recorder's office, Olmsted County, Minnesota 374.97 feet; thence southwesterly 223 degrees 58 minutes 31 seconds a azimuth along said west line 353.24 feet; thence southerly 182 degrees 30 minutes 47 seconds azimuth along said west line 61.54 feet; thence southerly 200 degrees 27 minutes 45 seconds azimuth along said west line 160.99 feet; thence easterly 89 degrees 50 minutes 27 seconds azimuth along said west line 642.62 feet; thence northerly 358 degrees 58 minutes 31 seconds azimuth along said west line 1145.66 feet; thence westerly 268 degrees 58 minutes 31 seconds azimuth 330.00 feet to the east line of said Century Hills Second Subdivision; thence southerly 178 degrees 58 minutes 31 seconds azimuth along said east line 127.58 feet to the point of beginning.

Said tract contains 10.87 acres more or less.

ALSO:

That part of the Northeast Quarter of the Southeast Quarter of Section 30, Township 107 North, Range 13 West, Olmsted County, Minnesota, described as follows:

Commencing at the most easterly corner of Lot 4, Block 2 of Century Hills Third Subdivision, according to the plat thereof on file at the County Recorder's office, Olmsted County, Minnesota; thence southwesterly on a Minnesota State Plane Grid Azimuth from north of 223 degrees 58 minutes 31 seconds along the southeasterly line of said Lot 4, a distance of 140.00 feet to the most southerly corner of said Lot 4; thence southeasterly 133 degrees 58 minutes 31 seconds azimuth 20.00 feet; thence northeasterly 43 degrees 58 minutes 31 seconds azimuth 140.00 feet; thence northwesterly 313 degrees 58 minutes 31 seconds azimuth 20.00 feet to the point of beginning.

Said tract contains 0.06 acres more or less.

Section 2. The total quantity of land included in the petition is approximately 10.93 acres in size.

Section 3. On February 7, 2000, the Common Council held a public hearing to consider this annexation petition after providing written notice of the hearing, by certified mail, to the property owners, the Haverhill Township officers, and the adjacent property owners.



Section 4. The City provided notification to the petitioners pursuant to Minn. Stat. §414.033, subd. 2b, 11, 12 and 13 if applicable to this petitioned annexation.

Section 5. Following the public hearing, the Common Council of the City of Rochester determined that the land abuts the municipal limits, is less than 60 acres in area, the annexation petition is signed by all property owners of the land described in Section 1, and the land is or will soon become urban or suburban in character.

Section 6. Therefore, pursuant to Minn. Stat. §414.033, subd. 2(3), the land described in Section 1 above is hereby annexed, added to and made a part of the City of Rochester, Minnesota, as if it had originally been a part thereof.

Section 7. Present and future owners of the lands annexed by this ordinance are hereby notified that in addition to the usual assessments, it is the intention of the Common Council to assess against benefited property all or a portion of the cost of any storm sewer, water tower, pumping station, and trunk line sanitary sewer construction, heretofore or hereafter undertaken to serve the area annexed.

Section 8. This ordinance shall take effect and be in force from and after its official publication and from and after the filing of a certified copy hereof with the Minnesota State Planning Commission, the Haverhill Town Clerk, the County Auditor, and the Secretary of State.

PASSED AND ADOPTED BY THE COMMON COUNCIL OF THE CITY OF  
ROCHESTER, MINNESOTA, THIS 6TH DAY OF MARCH, 2000.

  
\_\_\_\_\_  
PRESIDENT OF SAID COMMON COUNCIL

ATTEST:   
\_\_\_\_\_  
CITY CLERK

APPROVED THIS 7th DAY OF MARCH, 2000.

  
\_\_\_\_\_  
MAYOR OF SAID CITY







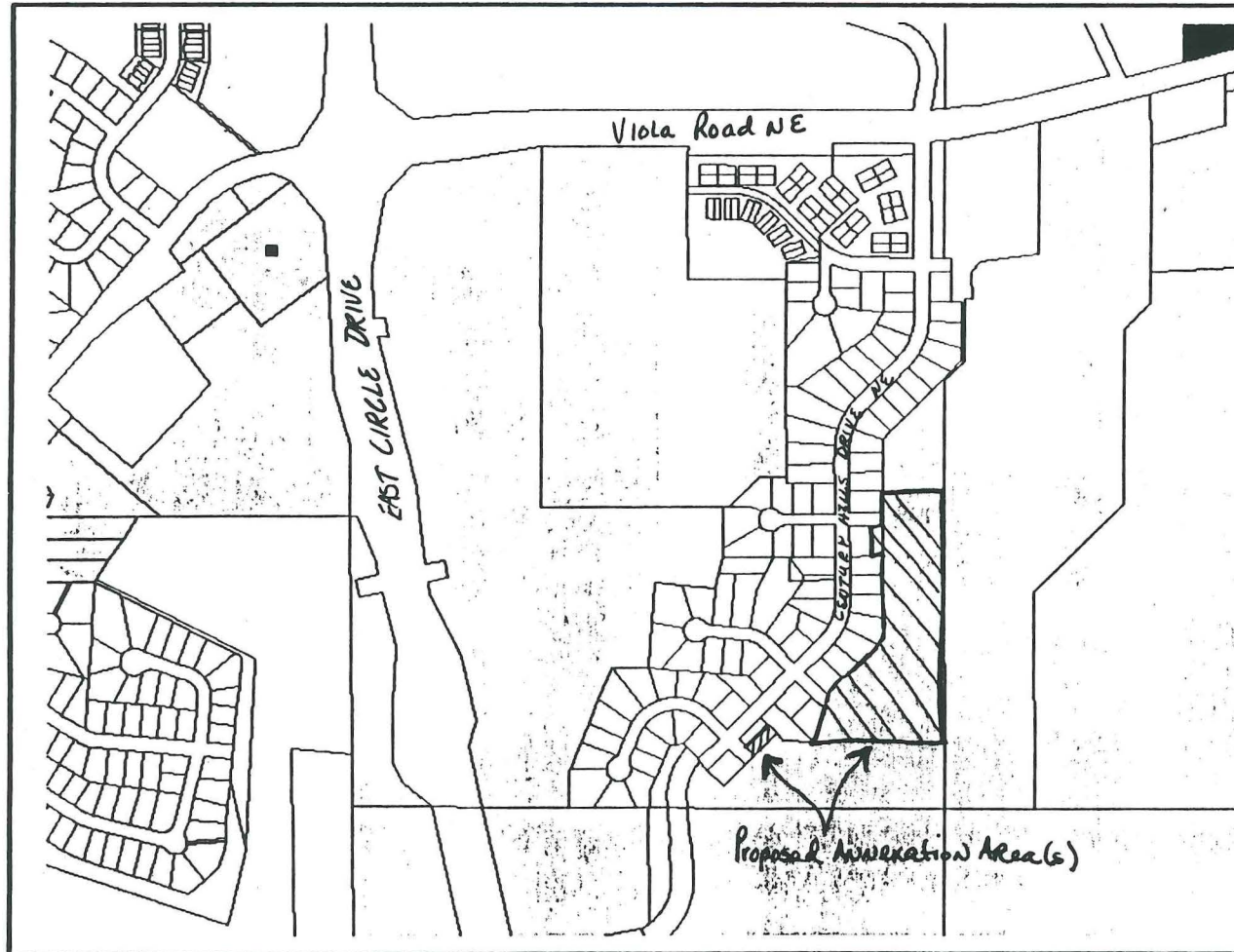







(Seal of the City of  
Rochester, Minnesota)



# Map Title



 olmstedapps83  
 Labels  
 Olmstedzone (ZONING\_DIS)

	A1
	A2
	A3
	A4
	ARC
	CS
	HC
	I
	MI
	R1
	R2
	RA
	RC
	RSD
	SD





CENTURY HILLS FOURTH SUBDIVISION  
ANNEXATION MAP

REC'D. BY APR 03 2000  
MAB



0 30 60 120  
SCALE IN FEET

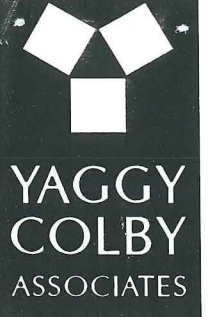
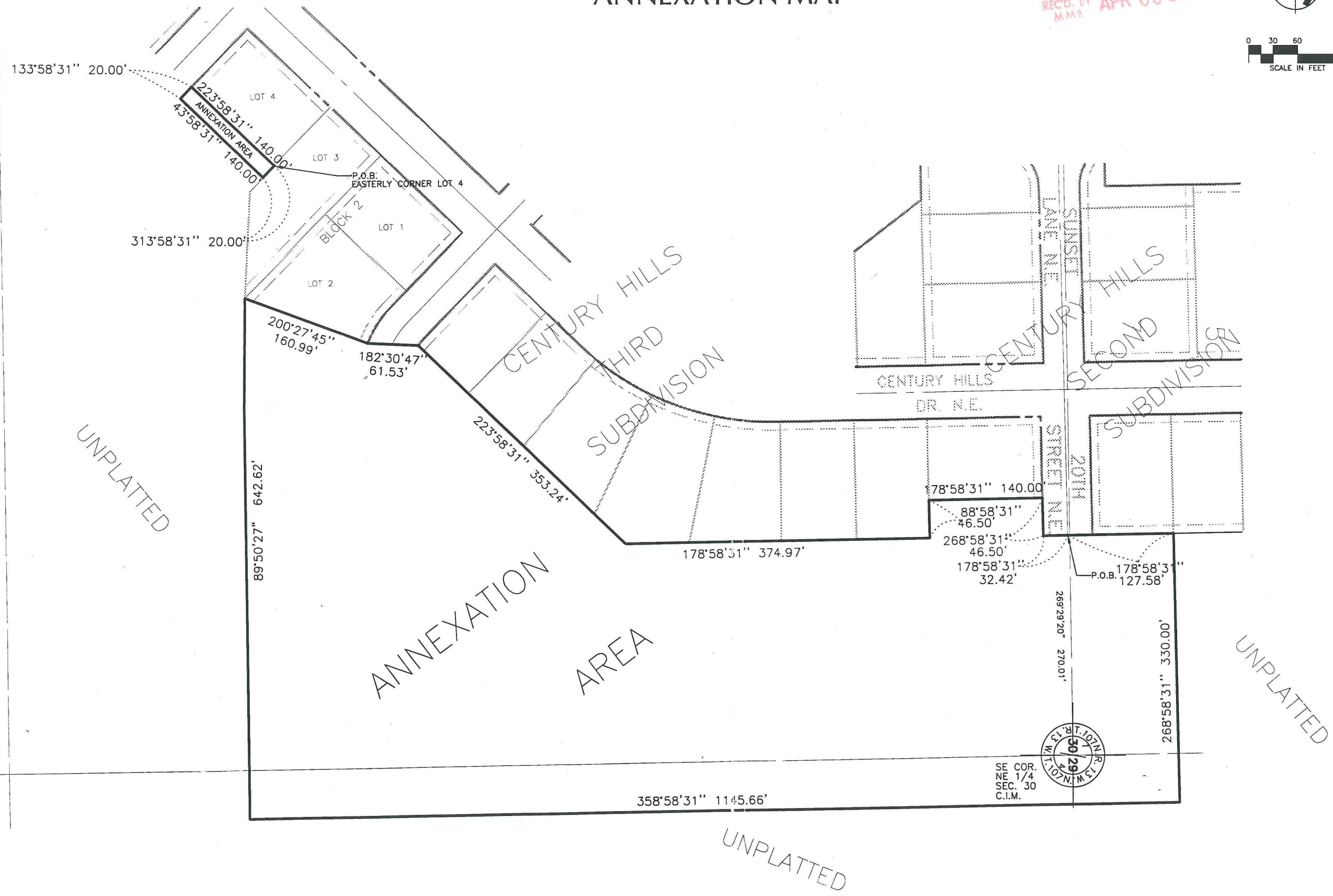

ENGINEERS • ARCHITECTS  
SURVEYORS • PLANNERS  
LANDSCAPE ARCHITECTS  
717 THIRD AVENUE SOUTHEAST  
ROCHESTER, MINNESOTA 55904  
507-288-6464  
FAX 507-288-5058  
EMAIL INFO@YAGGY.COM

CENTURY HILLS FOURTH SUBDIVISION  
ROCHESTER, MINNESOTA  
ANNEXATION MAP

PROJECT NUMBER	6821
COMPUTER FILE	6821ANNX.DWG
DATE	12-29-99
DRAWN BY	J.F.
CHECKED BY	W.D.
REVISIONS	

SHEET NUMBER  
1  
OF ONE SHEETS