

ORDINANCE NO. 135, 3rd Series

AN ORDINANCE EXTENDING THE CORPORATE LIMITS OF THE CITY OF WADENA TO INCLUDE CERTAIN UNINCORPORATED PROPERTY OWNED BY AND ABUTTING UPON THE LIMITS OF THE CITY.

WHEREAS, the territory described below is not presently within the corporate limits of any incorporated city; and

WHEREAS, this territory abuts upon the corporate limits of the city and more particularly upon the westerly boundary thereof and is deemed to be urban or suburban in character; and

WHEREAS, this territory is owned in fee by the City of Wadena,

The City of Wadena herewith ordains as follows:

SECTION 1. TERRITORY ANNEXED.

The corporate limits of the City of Wadena are hereby extended to include the unplatted property described as follows and now owned by the City, to-wit:

The North 40 feet of the West 1,280 feet of the East 2,000.00 feet of the S $\frac{1}{2}$ of the SE $\frac{1}{4}$, Section 12, T134N, R36W, of the 5th P.M.

AND

That part of the SW $\frac{1}{4}$ of the SE $\frac{1}{4}$ of Section 12, T134N, R36W of the 5th P.M. in Otter Tail County, Minnesota, described as follows:

Commencing at the Southwest Corner of **EVERGREEN ESTATES FIRST ADDITION**, plat of which is on file and of record in the office of the Otter Tail County Recorder; thence North 89 degrees 44 minutes 20 seconds West 877.00 feet on an assumed bearing along the south line of said Section 12 to the point of beginning; thence North 1160.08 feet parallel with the westerly line of said EVERGREEN ESTATES FIRST ADDITION plat; thence East 244.00 feet; thence North 173 feet, more or less, to a point on the north line of said SW $\frac{1}{4}$ of the SE $\frac{1}{4}$; thence westerly along the north line of said SW $\frac{1}{4}$ of the SE $\frac{1}{4}$ to the northwest corner of said SW $\frac{1}{4}$ of the SE $\frac{1}{4}$; thence southerly along the west line of said SW $\frac{1}{4}$ of the SE $\frac{1}{4}$ to the southwest corner of said SW $\frac{1}{4}$ of the SE $\frac{1}{4}$; thence South 89 degrees 44 minutes 20 second East 830.47 feet along the south line of said SW $\frac{1}{4}$ of the SE $\frac{1}{4}$ to the point of beginning, EXCEPT that part of the SW $\frac{1}{4}$ of the SE $\frac{1}{4}$, Section 12, T134N, R36W, of the 5th P.M. in Otter Tail County, Minnesota described as follows: Commencing at the Southwest corner of EVERGREEN ESTATES FIRST ADDITION plat of which is on file and of record in the office of the Otter Tail County Recorder; thence North 89 degrees 44 minutes, 20 seconds West 877.00 feet along the South line of said Section 12, thence North 1, 160.8 feet and parallel with the westerly line of said EVERGREEN ESTATES FIRST ADDITION plat to the point

of beginning; thence East 244.00 feet; thence North 134.42 feet; thence South 81 degrees, 30 minutes, 47 seconds West 247.00 feet, more or less, to a point 94.0 feet North of the point of beginning; thence South 94.0 feet to the point of beginning, containing .65 acres, more or less.

SECTION 2. FILING

The City Administrator is directed to file certifies copies of this Ordinance with the Secretary of State, the County Auditor of Wadena County, the Town Clerk of Compton Township, Otter Tail County, and the Minnesota State Planning Agency.

SECTION 3. EFFECTIVE DATE.

This Ordinance takes effect upon its passage and publication and filing of certified copies as directed in Section 2.

Adopted by the City of Wadena, Minnesota, this 11 day of January, 2000.

ATTEST:

Bradley A Swanson
City Administrator

[Signature]
Mayor

Published in January 20, 2000.

REC'D. BY MMB JAN 21 2000

50

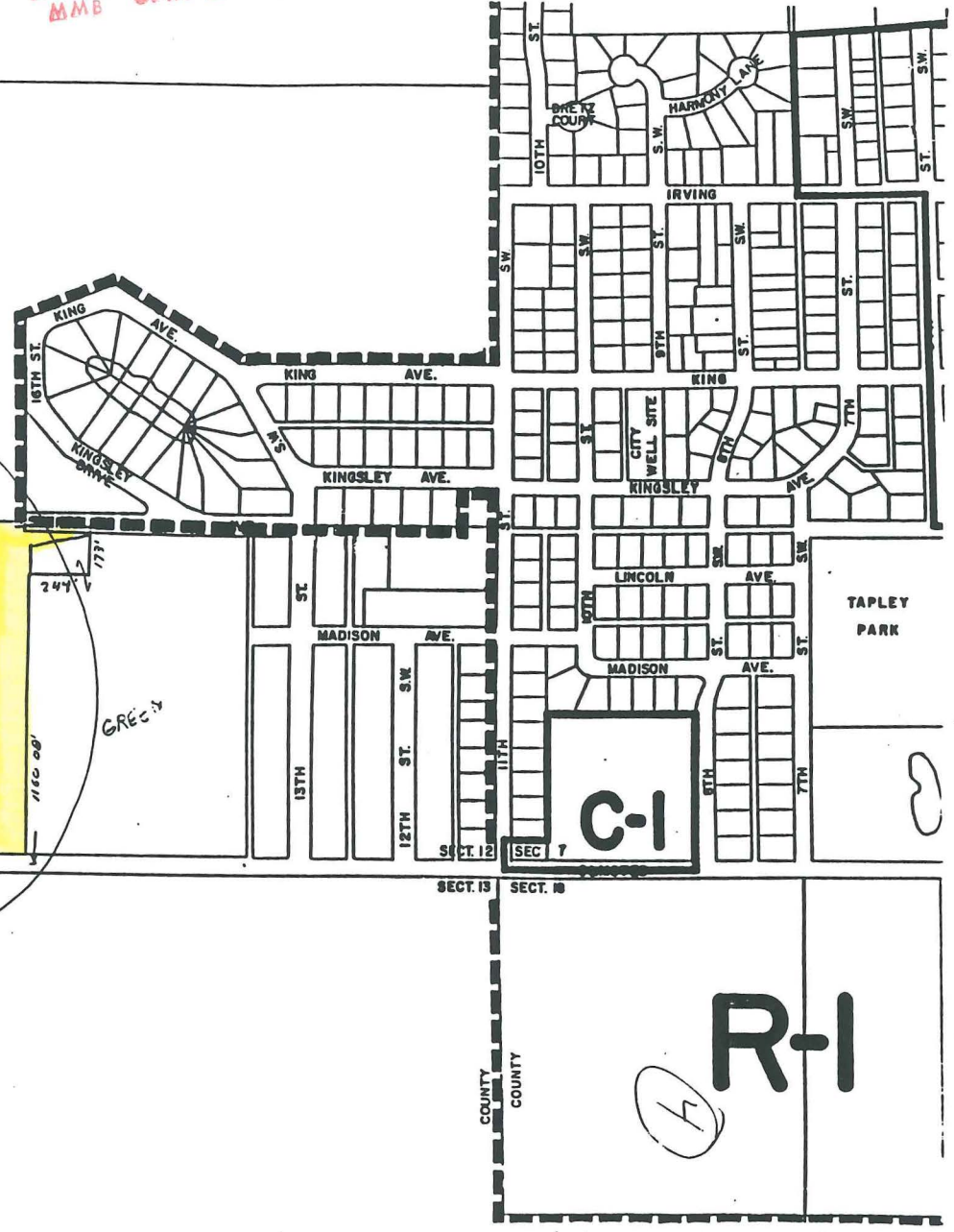
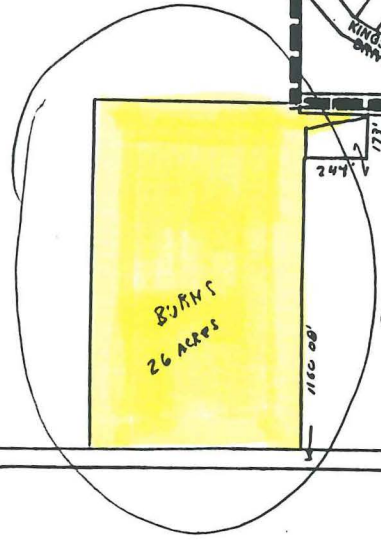

(7)

R-1

3