

**ORDINANCE NO. 1125**

**AN ORDINANCE EXTENDING THE CORPORATE LIMITS  
OF THE CITY OF WILLMAR**

**WHEREAS, Ernest Hazel III and Irv Moen (petitioners) have filed a petition dated September 8, 1999, requesting that certain land, as legally described below:**

**The South 153 feet of the North 20 rods of the East 375 feet of the NE 1/4 NE 1/4 Section 27, T119, R35 be annexed to the City of Willmar; and**

**WHEREAS, Petitioners represent that they are all of the owners of the property, that the property is unincorporated, abuts the limits of the City of Willmar, is not included within any other municipality, is less than sixty (60) acres, is not included in any area that has already been designated for orderly annexation pursuant to Minnesota Statutes 414.0325, is not presently served by public sewer facilities, and is approximately 1.32 acres in size.**

**NOW, THEREFORE, the City Council of Willmar, Minnesota, hereby determines, ordains, and declares as follows:**

**Section 1. STATUTORY COMPLIANCE. The City Council hereby determines and finds that the property abuts the municipality, that the area to be annexed is sixty (60) acres or less, that the property is not included in any area that has already been designated for orderly annexation pursuant to Minnesota Statutes 414.0325, that the property is not presently served by public sewer facilities, that the municipality has received a properly prepared Petition for Annexation from all of the owners of the property, and that the Petition complies with all of the provisions of Minnesota Statute 414.033. The property owners waived notice pursuant to Minnesota Statute 414.033 subd.13 as the utilities serving the site will not change.**

**Section 2. BEST INTEREST OF THE CITY OF WILLMAR AND AREA TO BE ANNEXED. The property is urban in nature or about to become so. The annexation will be in the best interest of the City of Willmar, Minnesota, and of the area affected.**

**Section 3. ANNEXATION. The corporate limits of the City of Willmar are hereby extended to include the property, and the same is hereby annexed to and included within the City of Willmar as if the property had originally been part thereof.**

**Section 4. ZONING. The above-described real estate shall be zoned GB - General Business.**

**Section 5. ACREAGE. The property conditioned for annexation has an area of 1.32 acres.**

REC'D. BY NOV 12 1999  
M 113

Section 6. EFFECTIVE DATE. This Ordinance shall be filed and shall take effect and be in full force and effect from and after filing a certificate thereof with Minnesota Planning, the County of Kandiyohi, Minnesota, and the Secretary of State of the State of Minnesota, and from and after its adoption and publication.

This Ordinance introduced by Councilman: Kelly

This Ordinance introduced on: October 20, 1999

This Ordinance published on: October 26, 1999

This Ordinance given a hearing on: November 3, 1999

This Ordinance adopted on: November 3, 1999

This Ordinance published on: November 9, 1999

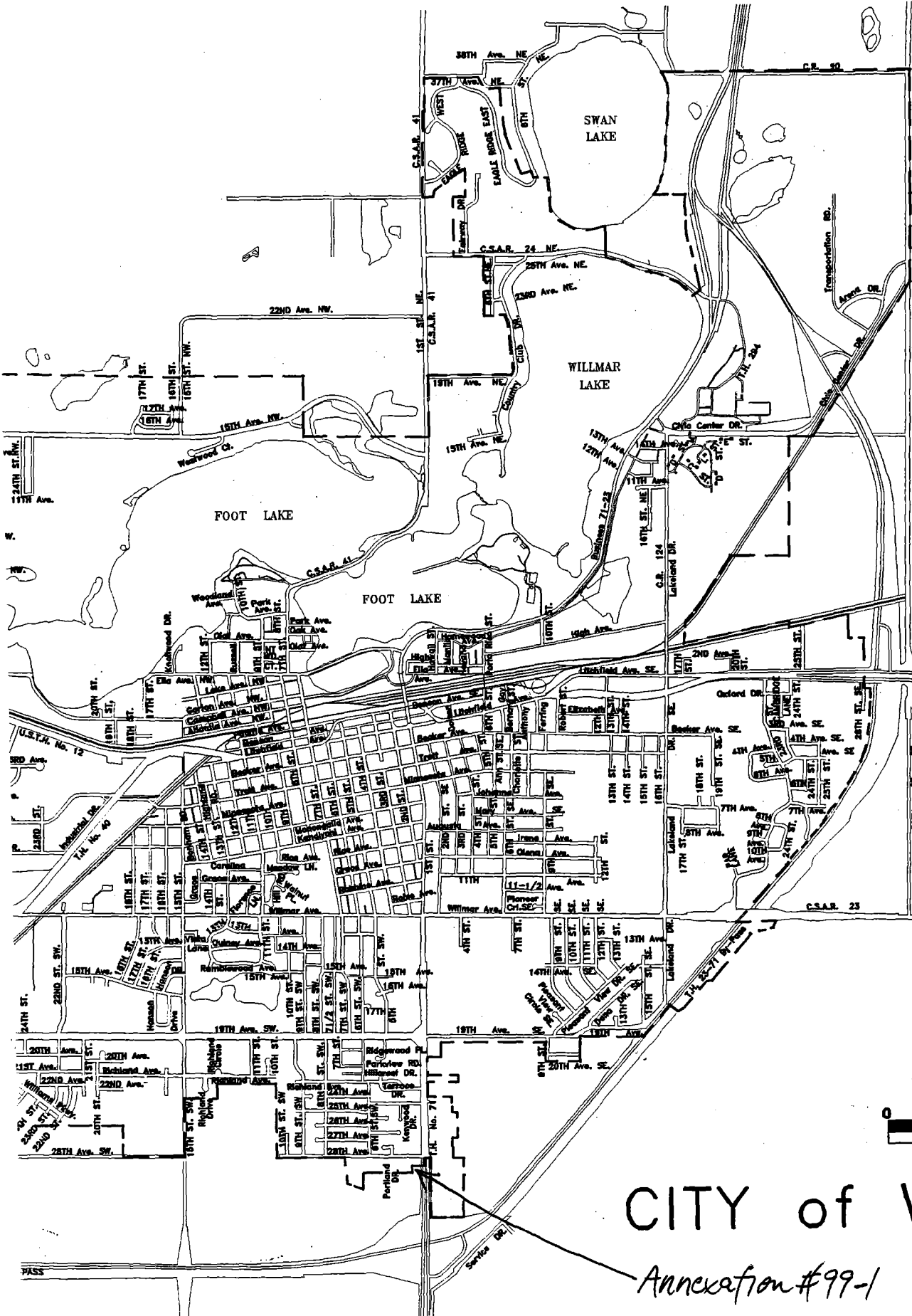

# CITY of WILLMAR

Annexation #99-1

City of  
Willmar  
Annexation  
#99-1  
Ord. #1125

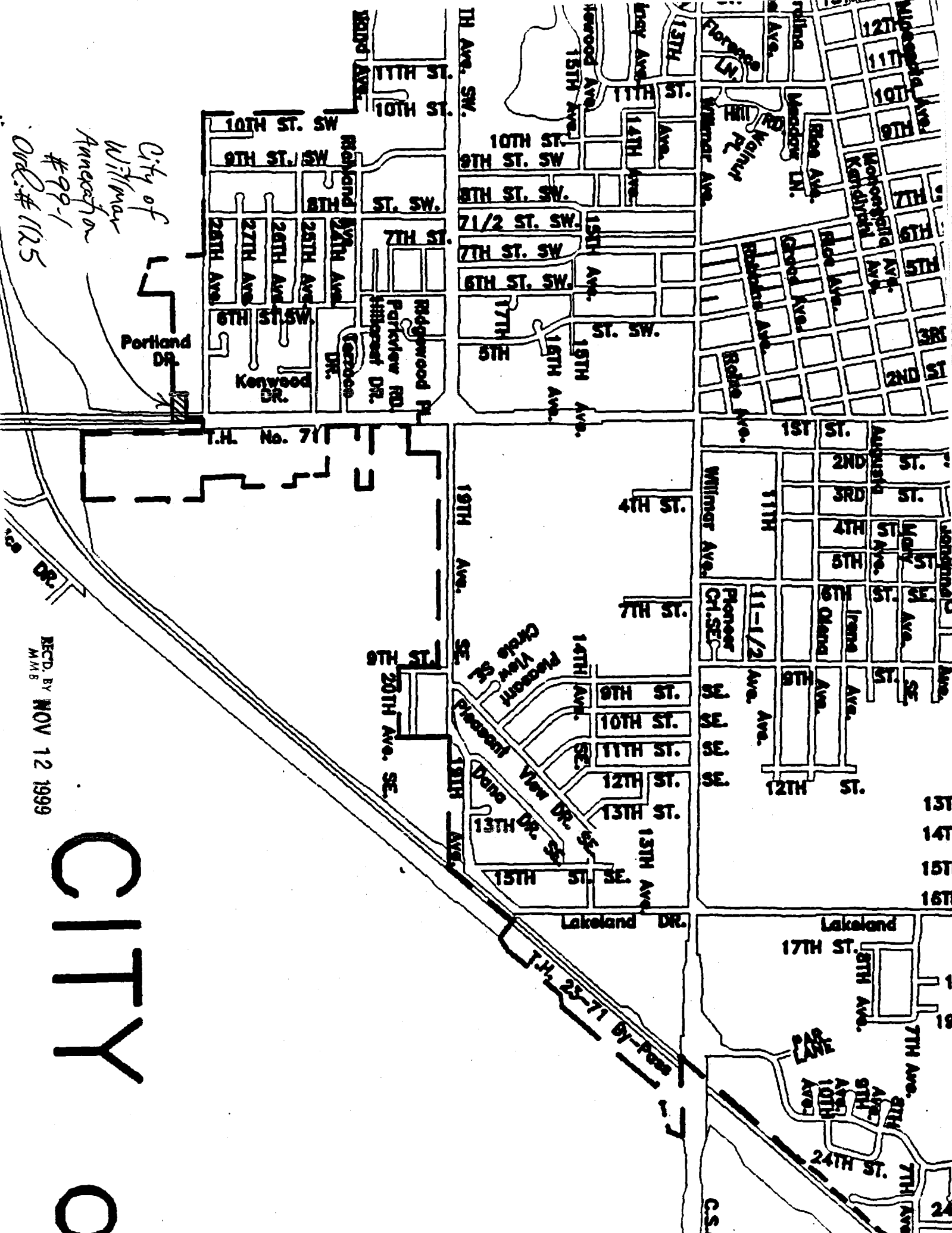

REC'D. BY  
MMB  
NOV 12 1999

CITY