

ORDINANCE NO. 442
2ND SERIES

AN ORDINANCE ANNEXING PROPERTY LOCATED ALONG CSAH 42 AND GEORGE STREET TO THE CORPORATE LIMITS OF THE CITY OF ALEXANDRIA

WHEREAS, a majority of the property owners of the lands described below have petitioned the Alexandria City Council to annex this territory to the City of Alexandria, pursuant to Minnesota Statutes Section 414.033, Subdivision 5, and

WHEREAS, the property abuts upon the northerly boundary of the Alexandria City Limits along the southerly boundary of the subject property, and

WHEREAS, the property is not presently part of any incorporated city, and

WHEREAS, the property consists of platted land in Alexandria Township, Douglas County, containing approximately 0.22 acres in one (1) parcels owned by one (1) property owner, and

WHEREAS, the Alexandria City Council finds that the property is suburban in character by surrounding development and usage and is not currently served by municipal water services, and

WHEREAS, the City of Alexandria has received a Waiver of Objection to Annexation Petition from Alexandria Township,

NOW, THEREFORE THE CITY COUNCIL OF THE CITY OF ALEXANDRIA HEREBY ORDAINS:

SECTION I: That the Corporate Limits of the City of Alexandria are hereby extended to include land as described and the same is hereby annexed and included within the City.

SECTION II: That the territory to be annexed is described as:

Lot 1 "Caldwell's Sub of S 10 AC of Gov't Lot 8"

SECTION III: That the territory to be annexed is hereby designated as B-1, General Business on the City's official Zoning Map.

SECTION IV: That the City Clerk is directed to file copies of this ordinance with State of Minnesota, the Douglas County Auditor and the Alexandria Township Board of Supervisors.

SECTION V: This Ordinance shall be in full force and effect from and after its passage, publication and approval by the State of Minnesota.

ADOPTED by the City Council of the City of Alexandria, Minnesota, this 27th day of December, 1999, by the following vote:

YES: KALPIN, RADIL, WEISEL, BENSON, FRANK

NO: NONE

ABSENT: NONE

John O. Perino, Mayor

ATTEST:

Jim Taddei, City Administrator

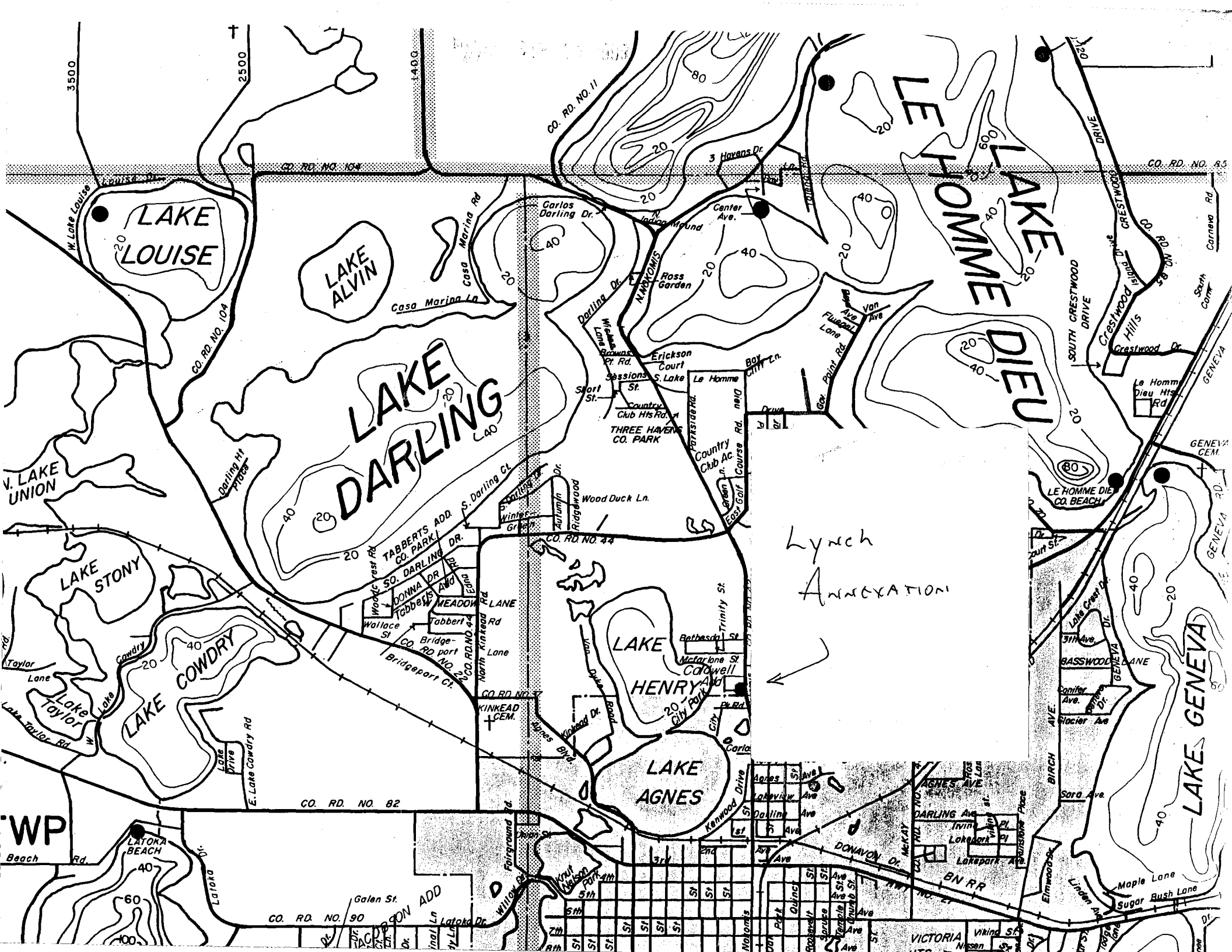

LAKE LOUISE

LAKE ALVIN

LAKE DARLING

LAKE STONY

LAKE COWDRY

LAKE HENRY

LAKE AGNES

LE HOMME DIEU

LAKE GENEVA

Lynch Annexation

WP

CO. RD. NO. 90

5th

DONOVAN DR.

VICTORIA

162.0	800	120	160.0	"	"	300.0	"	800
39	38	37	36	35	34	33	32	108.2
123.7	800	"	"	"	"	"	800	

DALE STREET

80	60	"	"	"	60	80
CALDWELLS						
27	26	25	24	23	22	21
SUB.						
16	15	14	13	12	11	10
80	60	"	"	"	60	80

NELSON ST.

NORTH NOKOMIS

GEORGE STREET

204.8	60'	"	"	"	"	"	60'	70'
9	8	7	6	5	4	3	2	1
12'40'	75.8	60'	"	"	"	"	60'	792

Lynch PROPERTY

07'	1276	1263	1264	1266	1268	1269	1270	1271	1272
SUB.									
1279	1280	1281	1282	1283	1284	1285	1286	1287	1288

EXISTING CITY LIMITS

32'	89.5	36	1273	1272	1271	1270
ADD						
32'	95	42	75	75	75	75

PARK ROAD

489	60	"	"	"	"	"	"	1257	1256	1255
LARSONS										
8	7	6	5	4	3	2	1	1254	1253	1252
ADD										
754	60	"	"	"	"	"	"	"	"	437

See Section 17-128-37

REVISED SEP 19 1944