

July
Dunk
Vol
PW

SD / Sect 4
B-17

REC'D. BY JUN 22 1998
MJB

ORDINANCE NO. 3177

AN ORDINANCE ANNEXING TO THE CITY OF ROCHESTER APPROXIMATELY 46.25 ACRES OF LAND LOCATED IN A PART OF THE NORTHWEST QUARTER OF SECTION 9 AND THE SOUTHWEST QUARTER OF SECTION 4, TOWNSHIP 106 NORTH, RANGE 14 WEST, OLMSTED COUNTY, MINNESOTA.

THE COMMON COUNCIL OF THE CITY OF ROCHESTER DO ORDAIN:

Section 1. A petition has been filed with the Common Council of the City of Rochester, signed by the owner of land described herein, requesting the Common Council to annex said land to the City of Rochester. The land described in said petition for annexation is located in Rochester Township, Olmsted County, Minnesota, and is described as follows:

A tract of land in the Southeast Quarter of the Southwest Quarter of Section 4, Township 106 North, Range 14 West, Olmsted County, Minnesota, more particularly described as follows:

Commencing at the southeast corner of said Southwest Quarter for a place of beginning; thence west along the south line of said Southwest Quarter, 629.82 feet; thence on an assumed bearing of North 06 degrees 19 minutes East a distance of 538.26 feet; thence South 56 degrees 44 minutes East, 120.75 feet; thence North 09 degrees 36 minutes 30 seconds East, 119.10 feet; thence South 77 degrees 26 minutes 30 seconds East, 434.40 feet to a point on a curve which has a delta angle of 08 degrees 29 minutes 20 seconds and a radius of 1909.86 feet and a chord which bears South 04 degrees 48 minutes 40 seconds East; thence 283.00 feet along said curve to its point of tangency; thence South 00 degrees 34 minutes East tangent to said curve a distance of 210.00 feet to the place of beginning. The east 75.0 feet thereof being subject to an easement for road right-of-way, containing 7.2 acres.

and also:

All that part of the East eighty-nine and one quarter (89.25) acres of the Northwest Quarter of Section 9, Township 106 North, Range 14 West, except the East 20 feet thereof, all lying north of the centerline of State Aid Road No. 25.

Section 2. The total quantity of land included in said petition is approximately 46.25 acres in size.

Section 3. On May 4, 1998, the Common Council held a public hearing to consider this annexation petition after providing written notice of the hearing, by registered mail, to the property owner, the Rochester Township officers, and the adjacent property owners.

Section 4. Pursuant to Minn. Stat. §414.033, subd. 13, the City notified the petitioners that the cost of electric service may change if the land is annexed to the City of Rochester.

Section 5. Following the public hearing, the Common Council of the City of Rochester determined that the land abuts the municipal limits, is less than 60 acres in area, the annexation petition is signed by all property owners of the land described in Section 1, and the land is or will soon become urban or suburban in character.

Section 6. Therefore, pursuant to Minn. Stat. §414.033, subd. 2(3), the land described in Section 1 above is hereby annexed, added to and made a part of the City of Rochester, Minnesota, as effectually as if it had originally been a part thereof.

Section 7. Present and future owners of the lands annexed by this ordinance are hereby notified that in addition to the usual assessments, it is the intention of the Common Council to assess against benefitted property all or a portion of the cost of any storm sewer, water tower, pumping station, and trunk line sanitary sewer construction, heretofore or hereafter undertaken to serve the area annexed.

Section 8. This ordinance shall take effect and be in force from and after its official publication and from and after the filing of a certified copy hereof with the Minnesota Municipal Board, the Rochester Town Clerk, the County Auditor, and the Secretary of State.

PASSED AND ADOPTED BY THE COMMON COUNCIL OF THE CITY OF ROCHESTER, MINNESOTA, THIS 1ST DAY OF JUNE, 1998.

John Hunsaker
PRESIDENT OF SAID COMMON COUNCIL

ATTEST: Judy Kay Soren
CITY CLERK

APPROVED THIS 2nd DAY OF JUNE, 1998.

Ed Bonfeld
MAYOR OF SAID CITY

(Seal of the City of Rochester, Minnesota)

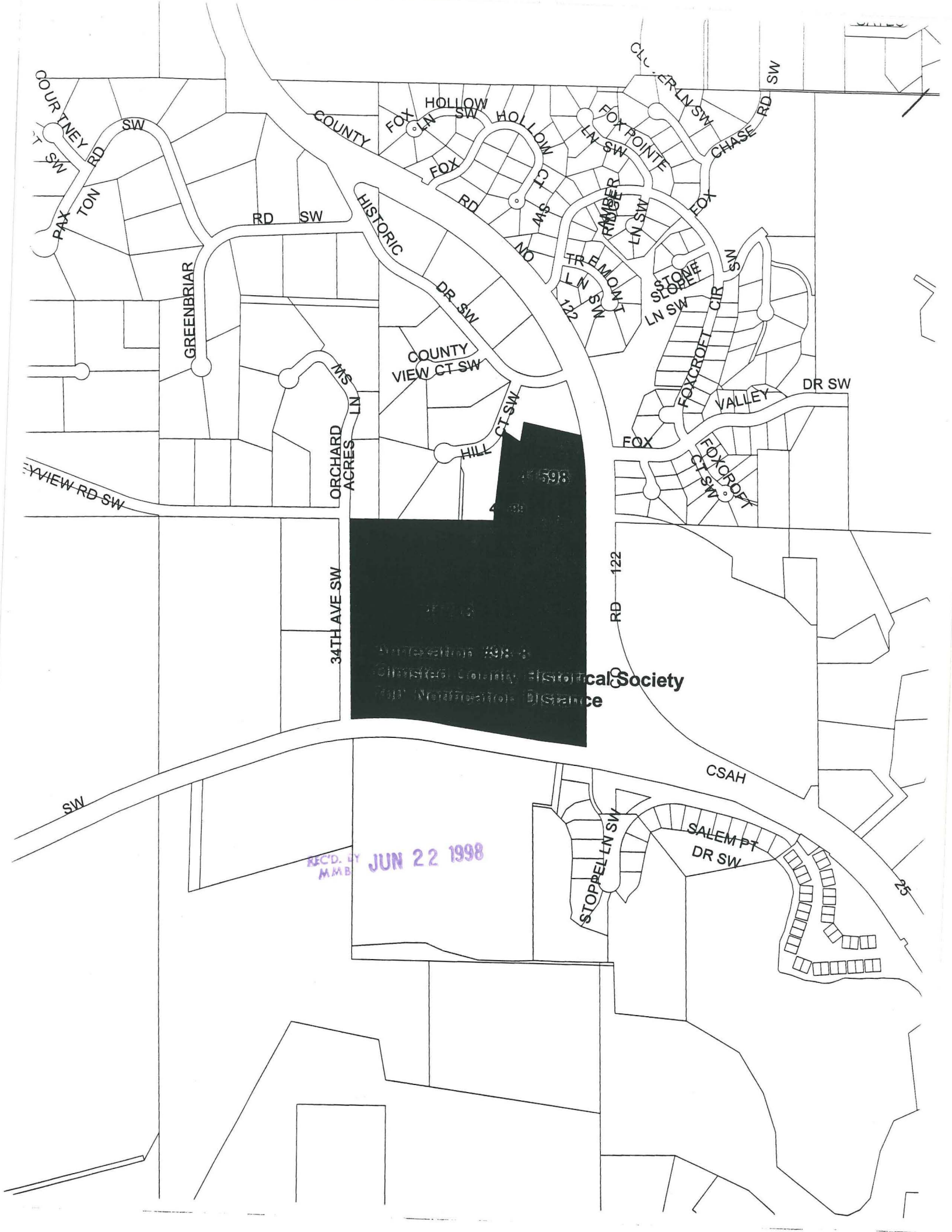

COURTNEY RD SW
PAX TON RD SW

GREENBRIAR

COUNTY RD SW

HISTORIC DR SW

COUNTY VIEW CT SW

ORCHARD ACRES LN SW

34TH AVE SW

HILL CT SW

FOX HOLLOW LN SW
FOX HOLLOW LN SW
FOX HOLLOW LN SW

TREMONT LN SW

STONE SLOPE LN SW

FOX CROFT CIR SW

VALLEY DR SW

FOX CROFT CT SW

RD 122

4598
4598
Historical Society
Historical Society

Historical Society

CSAH

STOPPELL LN SW

SALEM PT DR SW

REC'D. BY MMB JUN 22 1998

RD 25