

ORDINANCE NUMBER 293, 2ND SERIES

AN ORDINANCE ANNEXING TO THE CITY OF SAINT PETER, TWO TRACTS OF LAND CONTAINING 1.40 ACRES AND 65.75 ACRES, MORE OR LESS, LOCATED IN OSHAWA TOWNSHIP, NICOLLET COUNTY, MINNESOTA.

*City owned
for Barbara*

WHEREAS, the territory described below is not presently within the corporate limits of any incorporated city and is unplatted; and

WHEREAS, this territory is subject to orderly annexation pursuant to Minnesota Statutes 414.0325 and the parties hereto designate these areas for orderly annexation; and

WHEREAS, certain of these properties abut upon the corporate limits of the City and is deemed to be urban or suburban in character and the City of Saint Peter is capable of providing services to these areas within a reasonable time and the annexation is in the best interest of the area proposed for annexation; and

WHEREAS, Oshawa Township has waived objection and the waiting period otherwise required; and

NOW, THEREFORE, THE CITY COUNCIL OF SAINT PETER ORDAINS:

Section 1. Territory annexed. The corporate limits of the City of Saint Peter are hereby extended to include the properties described as follows:

PARCEL #1 (Jefferson Avenue right-of-way): All that part of the northwest quarter of Section 20, Township 110 North, Range 26 West, Nicollet County, Minnesota described as follows: The south 33.00 feet of the 1852.13 feet of the northwest quarter. (Approximately 1.40 acres more or less)

East

PARCEL #2 (Broadway Avenue Extension and Grace Street right-of-way): All that part of east half of the northwest quarter of Section 20 and south half of Section 17, all in Township 110 North, Range 26 West, Nicollet County, Minnesota described as follows: Beginning at the north quarter corner of said Section 20; thence south 00 degrees 12 minutes 27 seconds west (assumed bearing) on east line of the northwest quarter of said Section 20 a distance of 41.25 feet to the south right of way line of Old Fort Road; thence north 89 degrees 56 minutes 24 seconds west on said south right of way line for a distance of 1315.56 feet to the west line of the east half of the northwest quarter of said Section 20; thence north 00 degrees 22 minutes 58 seconds east on said west line for a distance of 41.25 feet to the northwest corner of the east half of the northwest quarter of said Section 20; thence north 00 degrees 05 minutes 05 seconds east on the west line of the southeast quarter of the southwest quarter of said Section 17, for a distance of 162.46 feet to a point 50 feet northerly of north right of way line of County State Aid Highway 5 as recorded in Nicollet County Right of Way Plat No. 1 being 110.00 feet northerly of the centerline of said County State Aid Highway 5; thence northeasterly on a said line being 110.00 feet northerly of County State Aid Highway 5 centerline to the east line of said Section 17; thence south 00 degrees 13 minutes 13 seconds west on said east line for a distance of 124.11 feet to the northeast corner of Parcel 7 as recorded in Nicollet County Right of Way Plat No. 1; thence north 89 degrees 55 minutes 08 seconds west, 866.88 feet to the west line of the east 208.25 feet of the southwest quarter of the northeast quarter of the southeast quarter; thence south 00 degrees 11 minutes 51 seconds west on said west line a distance of 698.36 feet to the south line of the northeast quarter of the southeast quarter; thence north 89 degrees 55 minutes 28 seconds west on said south line for a distance of 450.10 feet to the southwest corner of the northeast quarter of the southeast quarter of said Section 17; thence south 00 degrees 10 minutes 28 seconds west on the east line of the southwest quarter of the southeast quarter of said Section 17, for a distance of 1316.70 feet to the southeast corner of the southwest quarter of the southwest quarter of the southeast quarter of said Section 17; thence north 89 degrees 55 minutes 50 seconds west on the south line of the southwest quarter of the southeast quarter of said Section 17, for a distance of 1315.65 feet to the point of beginning; excepting therefrom that part of the southeast quarter of the southwest quarter of Section 17, Township 110 North, Range 26 West, Nicollet County, Minnesota, described as follows: Commencing at the south quarter corner of said Section 17; thence north 00 degrees 07 minutes 44 seconds east on the east line of the southeast quarter of the southwest quarter of said Section 17, for a distance of 41.25 feet to the north right of way line of Old Ford Road also being the point of beginning, thence north 89 degrees 56 minutes 24 seconds west on said north right of way line for a distance of 1157.21 feet to the south right of way line of County State Aid Highway 5 as recorded in Nicollet County Right of Way Plat No. 1 being a line 60.00 feet southerly of the centerline of said County State Aid Highway 5; thence northeasterly on a said line 60.00 feet southerly of said County State Aid Highway 5 centerline to a point on the east line of the southeast quarter of the southwest quarter of Section 17; thence south 00 degrees 07 minutes 44 seconds west on said east line for a distance of 905.29 feet to the point of beginning. (Approximately 65.75 acres more or less)

Section 2. Applicability. All provisions of Chapter 1 and other pertinent parts of the Saint Peter

City Code are made a part hereof and applicable to this Ordinance.

Section 3. Filing. The City Administrator is directed to file certified copies of this Ordinance with the Secretary of State, the County Auditor of the County in which the property is located, the Town Clerk of the affected township and the Minnesota Municipal Board.

Section 4. Effective date of annexation. This ordinance takes effect upon approval by the Municipal Board.

Adopted by the City Council of the City of Saint Peter, Nicollet County, Minnesota, this 23rd day of March, 1998.

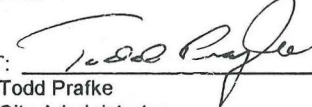
A'TTEST: 
Todd Prafke
City Administrator

Jerry K. Hawbaker
Mayor

The foregoing Ordinance was adopted by the following votes:

- Ayes: Councilmembers Pfeifer, Wright Kvamme, Gover, Douglas, Brinker, and Mayor Hawbaker
- Nayes: None
- Absent: None

Published in the *Saint Peter Herald* on April 2, 1998.

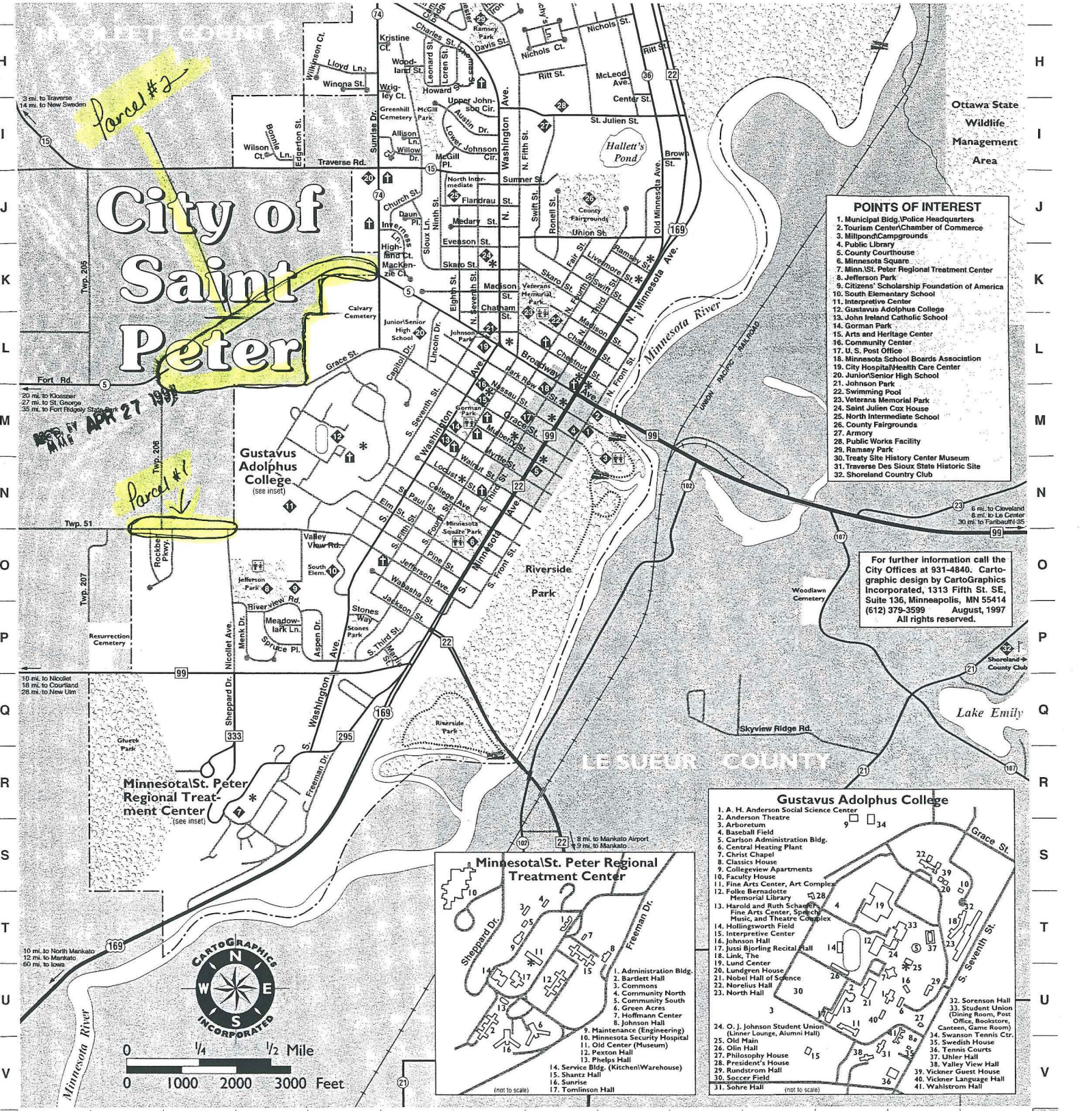

City of Saint Peter

- POINTS OF INTEREST**
1. Municipal Bldg./Police Headquarters
 2. Tourism Center/Chamber of Commerce
 3. Millpond/Campground
 4. Public Library
 5. County Courthouse
 6. Minnesota Square
 7. Minn. St. Peter Regional Treatment Center
 8. Jefferson Park
 9. Citizens' Scholarship Foundation of America
 10. South Elementary School
 11. Interpretive Center
 12. Gustavus Adolphus College
 13. John Ireland Catholic School
 14. Gorman Park
 15. Arts and Heritage Center
 16. Community Center
 17. U. S. Post Office
 18. Minnesota School Boards Association
 19. City Hospital/Health Care Center
 20. Junior/Senior High School
 21. Johnson Park
 22. Swimming Pool
 23. Veterans Memorial Park
 24. Saint Julien Cox House
 25. North Intermediate School
 26. County Fairgrounds
 27. Armory
 28. Public Works Facility
 29. Ramsey Park
 30. Treaty Site History Center Historic Site
 31. Traverse Des Sioux State Historic Site
 32. Shoreland Country Club

For further information call the City Offices at 931-4840. Cartographic design by CartoGraphics Incorporated, 1313 Fifth St. SE, Suite 136, Minneapolis, MN 55414 (612) 379-3599 August, 1997 All rights reserved.

Minnesota St. Peter Regional Treatment Center

1. Administration Bldg.
2. Bardett Hall
3. Commons
4. Community North
5. Community South
6. Green Acres
7. Hoffmann Center
8. Johnson Hall
9. Maintenance (Engineering)
10. Minnesota Security Hospital
11. Old Center (Museum)
12. Pexton Hall
13. Phelps Hall
14. Service Bldg. (Kitchen/Warehouse)
15. Shantz Hall
16. Sunrise
17. Tomlinson Hall

(not to scale)

Gustavus Adolphus College

1. A. H. Anderson Social Science Center
2. Anderson Theatre
3. Arboretum
4. Baseball Field
5. Carlson Administration Bldg.
6. Central Heating Plant
7. Christ Chapel
8. Classics House
9. Collegestview Apartments
10. Faculty House
11. Fine Arts Center, Art Complex
12. Folke Bernadotte Memorial Library
13. Harold and Ruth Schaefer Fine Arts Center, Studio, Music, and Theatre Complex
14. Hollingsworth Field
15. Interpretive Center
16. Johnson Hall
17. Jussi Bjorling Recital Hall
18. Link, The
19. Lund Center
20. Lundgren House
21. Nobel Hall of Science
22. Norelius Hall
23. North Hall
24. O. J. Johnson Student Union (Lobby Lounge, Alumni Hall)
25. Old Main
26. Olin Hall
27. Philosophy House
28. President's House
29. Rundstrom Hall
30. Soccer Field
31. Sohre Hall
32. Sorenson Hall
33. Student Union (Dining Room, Post Office, Bookstore, Canteen, Game Room)
34. Swanson Tennis Ctr.
35. Swedish House
36. Tennis Courts
37. Uhler Hall
38. Valley View Hall
39. Vickner Guest House
40. Vickner Language Hall
41. Wahlstrom Hall

(not to scale)