

REC'D. BY APR 13 1998  
MMB

## ORDINANCE NUMBER 179

### AN ORDINANCE EXTENDING THE CORPORATE LIMITS OF THE CITY OF PEQUOT LAKES TO INCLUDE CERTAIN UNINCORPORATED PROPERTY OWNED BY AND ABUTTING UPON THE LIMITS OF THE CITY

WHEREAS, the property described below is not presently within the corporate limits of any incorporated city: and

WHEREAS, this property abuts upon the corporate limits of the City of Pequot Lakes boundary thereof and is deemed to be urban or suburban in character: and

WHEREAS, this property is owned in fee by the city:

**The City Council of Pequot Lakes does hereby ordain:**

**Section 1. Territory annexed.** The corporate limits of the City of Pequot Lakes are hereby extended to include the unplatted properties described as follows now owned by the City:

Beginning 48 rods North of the Southwest corner of the W 1/2 SW 1/4 of Section 11, Township 136, Range 29, thence East 80 rods, thence North 20 rods, thence West 80 rods, thence South 20 rods to the place of beginning, excepting therefrom the North 100 feet.

EXCEPT:

that part of the SW 1/4 SW 1/4, Section 11, Township 136, Range 29, described as follows: Commencing at a point on the West line of said Section 11 (said west line is assumed to bear north-south) 48 rods north of the southwest corner thereof; thence east along the south line of Mezzenga tract 241.11 feet to the actual point of beginning of tract to be herein described; thence north 100.00 feet, thence east 100.00 feet; thence south 100.00 feet to its intersection with the south line of Mezzenga tract; thence west along said south line 100.00 feet, more or less, to the point of beginning, Crow Wing County, Minnesota.

**Section 2. Filing.** The City Clerk is directed to file certified copies of this ordinance with the Secretary of State, the County Auditor of the county in which the property is located, the Town Clerk of the affected township and the Minnesota Municipal Board.

**Section 3. Effective date of annexation.** This ordinance takes effect upon its passage and publication and the filing of certified copies as directed in Section 2.

Adopted by the City of Pequot Lakes, Minnesota, this 7 day of April, 1998.

  
\_\_\_\_\_  
Jack Schmidt, Mayor

ATTEST:

  
\_\_\_\_\_  
Marty Peisch, City Clerk

Published in the Country Echo the \_\_\_\_\_ of \_\_\_\_\_, 1998.

REC'D. BY APR 17 1998  
MMB



# MAP OF PEQUOT LAKES CROW WING COUNTY 886

POP. 843

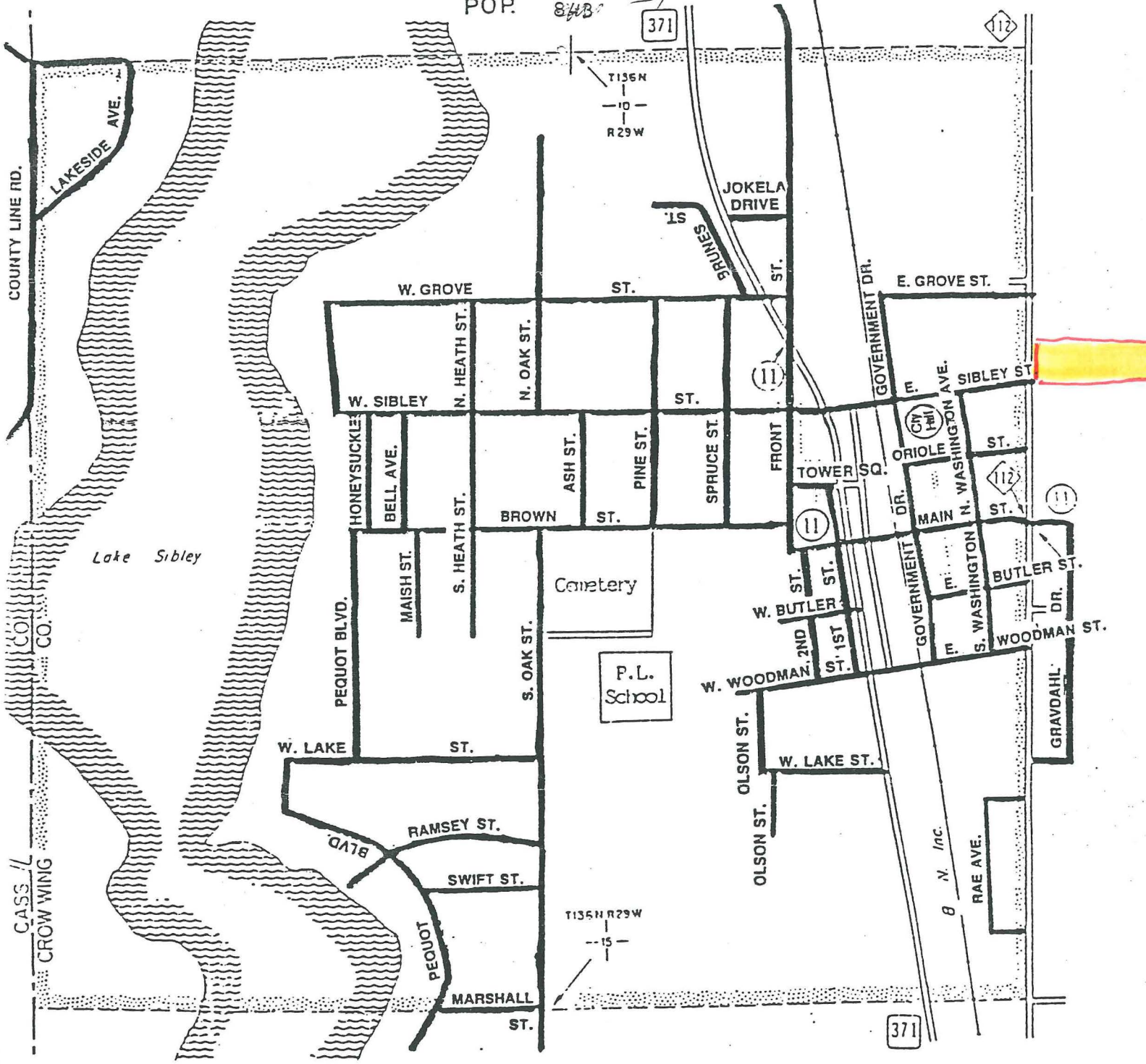

COUNTY LINE RD.

LAKESIDE AVE.

Lake Sibley

CASS /  
CROW WING

371

T136N  
R29W

JOKELA DRIVE

BRUNES ST.

W. GROVE ST.

E. GROVE ST.

W. SIBLEY

N. HEATH ST.

N. OAK ST.

ST.

GOVERNMENT DR.

HONEYSUCKLE

BELL AVE.

S. HEATH ST.

BROWN ST.

ASH ST.

PINE ST.

SPRUCE ST.

FRONT ST.

TOWER SQ.

E. SIBLEY ST.

ORIOLE ST.

MAIN ST.

N. WASHINGTON ST.

S. WASHINGTON ST.

Cemetery

P.L. School

W. BUTLER ST.

W. WOODMAN ST.

GOVERNMENT DR.

GOVERNMENT DR.

S. WASHINGTON ST.

BUTLER ST.

WOODMAN ST.

W. LAKE ST.

OLSON ST.

W. LAKE ST.

GRAVDAHL DR.

RAMSEY ST.

SWIFT ST.

B N. Inc.

RAE AVE.

MARSHALL ST.

T136N R29W

371



REC'D. BY APR 17 1998  
M.A.M.E

N  
↑

LAWRENCE DAYTON  
UNITED BUILDING CENTER

VERN & LINDA 254.2  
11  
COLE'S PLAT  
OUTLOTS  
STEPHEN KOLLM  
P.S. ARDEN JAHNKE 16  
JOHNSON 15  
B. PREMO  
CINDY RIECK  
10  
CLAYTON HARRINGTON  
J.D. CHASTAIN  
ANDOR BURAS  
LYNN HEADLEE  
ROBERT J. PETERSON  
ELLA M. ROBIDEAUX  
GEORGE BROADY

LYNN HEADLEE  
AUGUST MEZZENGA  
SIBLEY TOWNSHIP  
CORPORATE LIMITS OF PEQUOT LAKES

FAST SIBLEY STREET  
GOVERNMENT DRIVE  
PEQUOT LAKES  
RUTH W. MILLER  
DAVID BLAESER  
JOHN BARTHEL  
VACATED  
142' 3' GEORGE A. KNUTSON  
142' 3' AUDREY TERNUS  
142' 3' ERNEST L. MUSOLF  
142' 3' VERN DOWTY  
142' 3' IRENE BRUNES  
142' 3' ALVIN MALECHA  
142' 3' DONALD ENGER  
142' 3' R.H. WINKELMAN  
142' 3' ALICE  
142' 3' F.B. SPIELER  
142' 3' P. CRIMMONS  
142' 3' WAYNE RIVET  
142' 3' G. DASHORST  
142' 3' JOHN BUECKERS  
142' 3' NELLIE JOSEPH  
142' 3' RUBY GROVE  
142' 3' AM. LEG.  
142' 3' LANDOCHERS & ASSOC.  
142' 3' DONALD ENGER  
142' 3' R.H. WINKELMAN  
142' 3' ALICE

CORLISS J. HOLLEY  
PATSY HALVORSON  
JOHN E. BRUNES  
TAREN GARDNER  
HAROLD BUSCHMANN  
IRENE BRUNES  
P.J.E.K. ENT.  
ALVIN MALECHA  
STATE OF MINNESOTA  
EVERETT L. CLOW

ORIOLE STREET  
WASHINGTON AV  
BUTLER STREET  
EAST BUTLER STREET  
ALBIN ANDOLSKER  
BRAIN & GARY  
WATER TOWER  
PEQUOT LAKES  
NATIONAL BANK  
MAIN

COUNTY ROAD II  
SCANDIA NORTH  
# 101 WILLIAM JOHNSON  
# 102 BARBARA DAY  
# 103 KATHRYN JOHNSON  
# 104 LLOYD JOHNSON  
# 105 HERBERT HEIDECKER  
# 106 PATRICIA TUMBULL  
# 201 DORIS TAYOR  
# 202 DELIA BOMARDIER  
# 203 ERNST JARMEN  
# 204 MARY HOMAN  
# 205 MARK MEIXNER  
# 206 DONALD PHILLIPS  
# 207 WILLIAM CALDWELL  
# 208 HAROLD WERTS  
# 209 JOHN HOFSTETTER  
# 301 E. KNAUER  
# 302 TIM LEAGJELD  
OSCAR GRAVDAHL  
IVA PETERSEN  
KENNETH ERICKSON  
LOY T. PFEIFFER

↓  
S