

REC'D. BY
MAYOR DEC 29 1997

**ORDINANCE NO. 51.040
EXTENDING THE CORPORATE LIMITS
OF THE CITY OF ELGIN
TO INCLUDE CERTAIN UNINCORPORATED LAND
ABUTTING THE CITY OF ELGIN**

WHEREAS, Minnesota Statute §414.033 allows a city to annex land into the city limits by ordinance when: a) the land abuts the municipality, b) the land area is less than 60 acres, c) the city receives a petition for annexation from all property owners of the land, and d) the area to be annexed is not presently served by public sewer facilities, and

WHEREAS, the City of Elgin has received a Petition dated October 14, 1997 from Fred Ohm, Jr. and Irene Ohm, all of the owners of the property described on Exhibit A hereto, no part of which is now included in the city limits of the City of Elgin, and

WHEREAS, the petitioners' lands taken together abut the City, and

WHEREAS, the land is 29.5 acres in area, and

WHEREAS, the property to be annexed is not presently served by public sewer facilities, and

WHEREAS, the City believes the land is about to become urban or suburban in character because the area in which the property is located is between the City of Elgin on the north, which includes single-family housing, and Woodland Estates Subdivision, a residential single-family housing addition on the south, and the property to be annexed will be used for construction of new single-family homes in a residential subdivision to be developed by petitioners, and

WHEREAS, a public hearing was held on December 10, 1997 pursuant to Minnesota Statutes Section 414.033, Subd.2(b), and 30 days' written notice was given by certified mail to Elgin Township and to all landowners within and contiguous to the area to be annexed, and

WHEREAS, the City feels that annexation of the property by ordinance is in the best interests of the citizens of the City of Elgin;

NOW THEREFORE, IT IS ORDAINED BY THE CITY OF ELGIN, MINNESOTA AS FOLLOWS:

1. The land described on Exhibit A hereto is declared annexed to the City of Elgin, and the corporate limits of the City of Elgin are hereby extended to include said land.
2. A certified copy of this ordinance shall be immediately forwarded by the City Attorney to the Wabasha County Auditor and to the State Municipal Board, together with appropriate filing fees. A certified copy shall also be forwarded to the Elgin Township Clerk, Secretary of State, and the petitioners.
3. This ordinance shall take effect upon the latest of date of passage, approval by the State Municipal Board, and publication according to law.

Dated: 12-15-97

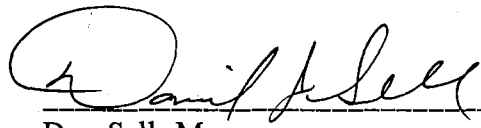

Dan Sell, Mayor

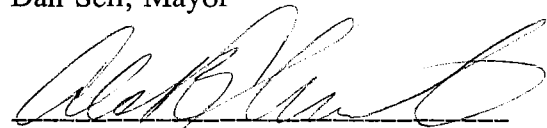

Alan Christensen, City Clerk

REC'D BY
DEC 20 2007

EXHIBIT A

Legal Description of Property to be annexed:

State of Minnesota, County of Wabasha: The North 57½ acres of the West Half of the Northeast Quarter (W½NE¼) of Section 34-108-12, excepting therefrom the North 28 acres of the West Half of the Northeast Quarter (W½NE¼) of Section 34-108-12. Containing 29½ acres, more or less.

MAP OF

ELGIN





TOWNSHIP: 108 N.

RANGE: 12 W.

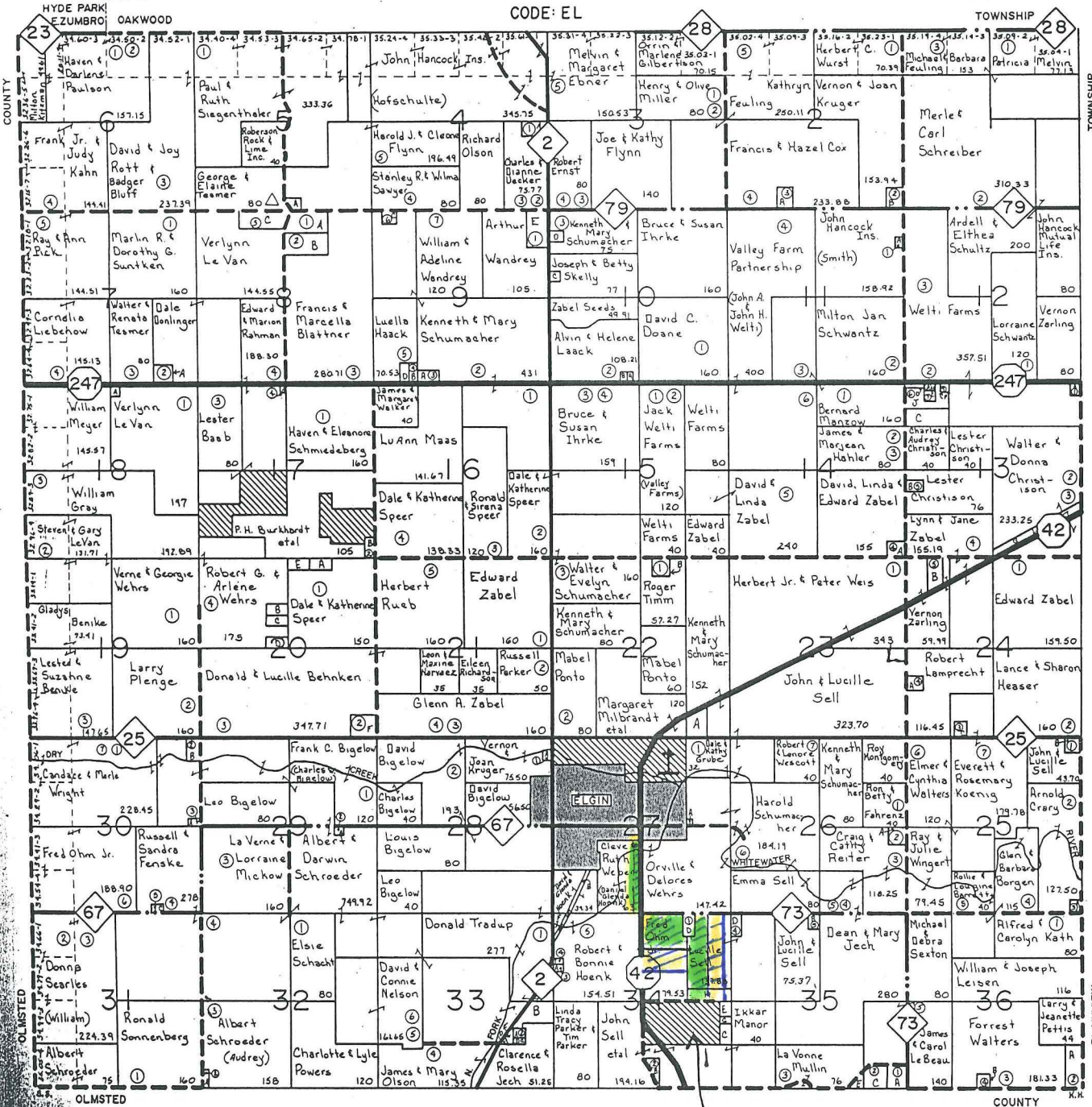
CODE: EL



SEE SMALL TRACT OWNERS FOLLOWING TOWNSHIP MAPS

-  Property to be Annexed
-  Already Annexed

Woodland Estates Residential Subdivision

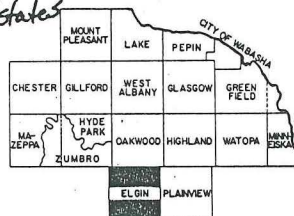

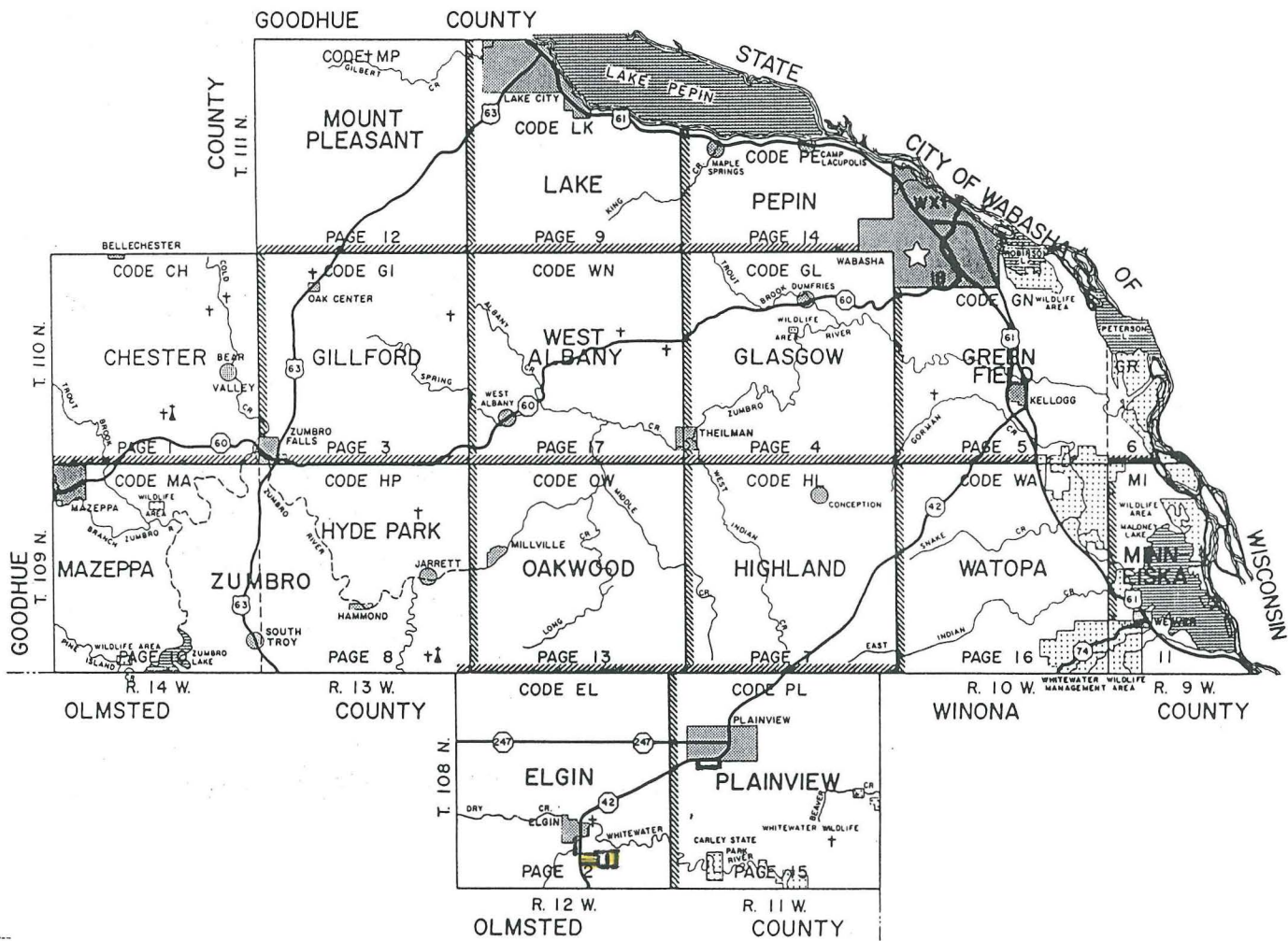

■ Land to be annexed