

ORDINANCE NO.

3129

AN ORDINANCE ANNEXING TO THE CITY OF ROCHESTER APPROXIMATELY 22.26 ACRES OF LAND LOCATED IN THE NORTHEAST QUARTER OF SECTION 29, TOWNSHIP 107 NORTH, RANGE 14 WEST, OLMSTED COUNTY, MINNESOTA.

THE COMMON COUNCIL OF THE CITY OF ROCHESTER DO ORDAIN:

Section 1. A petition has been filed with the Common Council of the City of Rochester, signed by the owners of land described herein, requesting the Common Council to annex said land to the City of Rochester. The land described in said petition for annexation is located in the Cascade Township, Olmsted County, Minnesota, and is described as follows:

That part of the Northeast Quarter of Section 29, Township 107 North, Range 14 West, Olmsted County, Minnesota, described as follows:

Beginning at the northeast corner of the Northwest Quarter of the Northeast Quarter thence westerly on a Minnesota State Plane Grid Azimuth from north of 267 degrees 09 minutes 39 seconds 579.33 feet, thence southerly 177 degrees 09 minutes 39 seconds azimuth 507.21 feet; thence southeasterly 144 degrees 36 minutes 28 seconds azimuth 939.84 feet to the south line of said Northwest Quarter of the Northeast Quarter, thence easterly along said south line to the southeast corner of said Northwest Quarter of the Northeast Quarter thence northerly along the east line of said Northwest Quarter of the Northeast Quarter 1300.41 feet to the point of beginning.

Said tract contains 13 acres more or less

Together with that part of the Southwest Quarter of the Northeast Quarter of Section 29, Township 107 North, Range 14 West, Olmsted County, Minnesota, described as follows:

Beginning at the northeast corner of said Southwest Quarter of the Northeast Quarter; thence westerly on a Minnesota State Plane Grid Azimuth from north of 267 degrees 09 minutes 13 seconds along the north line of said Southwest Quarter of the Northeast Quarter 350.00 feet, thence southerly 177 degrees 08 minutes 48 seconds azimuth 1251.60 feet to the northerly right-of-way of 19th Street Northwest according to the County State Aid Highway Number 22 plat on file in the County Recorder's office, Olmsted County, Minnesota, thence easterly 87 degrees 32 minutes 21 seconds azimuth along said northerly right of way 294.62 feet to the east line of said Southwest Quarter of the Northeast Quarter, thence northerly 359 degrees 40 minutes 36 seconds azimuth along said east line 800.36 feet, thence northerly 357 degrees 08 minutes 22 seconds azimuth 129.40 feet, thence easterly 87 degrees 08 minutes 48 seconds azimuth 5.73 feet to said east line, thence northerly 359 degrees 40 minutes 36 seconds azimuth along said east line 324.91 feet to the point of beginning

Said tract contains 9.26 acres more or less.

Section 2. The total quantity of land included in said petition is approximately 22.26 acres in size.

Section 3. On September 15, 1997, the Common Council held a public hearing to consider this annexation petition after providing written notice of the hearing, by registered mail, to the property owner, the Cascade Township officers, and the adjacent property owners.

Section 4. Pursuant to Minn. Stat. §414.033, subd. 13, the City notified the petitioners that the cost of electric service may change if the land is annexed to the City of Rochester.

Section 5. Following the public hearing, the Common Council of the City of Rochester determined that the land abuts the municipal limits, is less than 60 acres in area, the annexation petition is signed by all property owners of the land described in Section 1, and the land is or will soon become urban or suburban in character.

Section 6. Therefore, pursuant to Minn. Stat. §414.033, subd. 2(3), the land described in Section 1 above is hereby annexed, added to and made a part of the City of Rochester, Minnesota, as effectually as if it had originally been a part thereof.

Section 7. Present and future owners of the lands annexed by this ordinance are hereby notified that in addition to the usual assessments, it is the intention of the Common Council to assess against benefitted property all or a portion of the cost of any storm sewer, water tower, pumping station, and trunk line sanitary sewer construction, heretofore or hereafter undertaken to serve the area annexed.

REC'D. BY
MAILED OCT 29 1997

Section 8. This ordinance shall take effect and be in force from and after its official publication and from and after the filing of a certified copy hereof with the Minnesota Municipal Board, the Cascade Town Clerk, the County Auditor, and the Secretary of State.

PASSED AND ADOPTED BY THE COMMON COUNCIL OF THE CITY OF ROCHESTER, MINNESOTA, THIS 20TH DAY OF OCTOBER, 1997.



PRESIDENT OF SAID COMMON COUNCIL

ATTEST:



CITY CLERK

APPROVED THIS 21ST DAY OF OCTOBER, 1997.

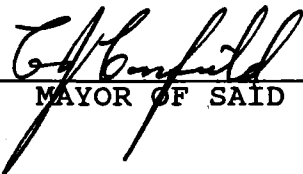

MAYOR OF SAID CITY

(Seal of the City of
Rochester, Minnesota)

ord\annex97.15

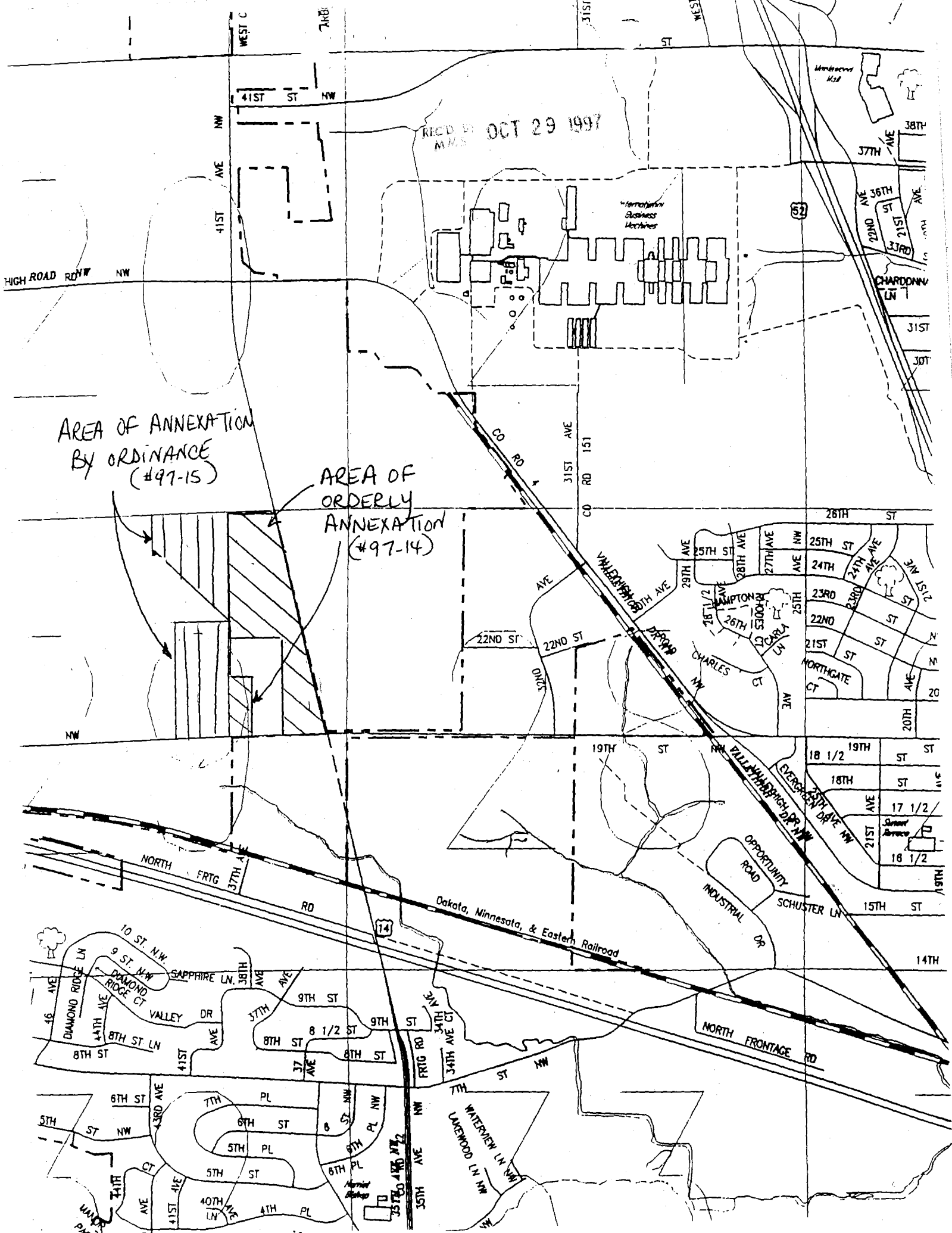

OCT 29 1997

AREA OF ANNEXATION
BY ORDINANCE
(#97-15)

AREA OF
ORDERLY
ANNEXATION
(#97-14)

REC'D BY
M.M.S.

HARRINGTON
BUSINESS
MACHINES

UNDERWOOD
HILL

CHARDON
LN

Oakota, Minnesota, & Eastern Railroad

NORTH FRONTAGE RD

WATERVIEW
LN NW

LAKEMOOD LN NW

DIAMOND RIDGE LN
SAPPHIRE LN
VALLEY DR
FRIG RD
NORTH 1ST ST
NORTH 2ND ST
NORTH 3RD ST
NORTH 4TH ST
NORTH 5TH ST
NORTH 6TH ST
NORTH 7TH ST
NORTH 8TH ST
NORTH 9TH ST
NORTH 10TH ST
NORTH 11TH ST
NORTH 12TH ST
NORTH 13TH ST
NORTH 14TH ST
NORTH 15TH ST
NORTH 16TH ST
NORTH 17TH ST
NORTH 18TH ST
NORTH 19TH ST
NORTH 20TH ST
NORTH 21ST ST
NORTH 22ND ST
NORTH 23RD ST
NORTH 24TH ST
NORTH 25TH ST
NORTH 26TH ST
NORTH 27TH ST
NORTH 28TH ST
NORTH 29TH ST
NORTH 30TH ST
NORTH 31ST ST
NORTH 32ND ST
NORTH 33RD ST
NORTH 34TH ST
NORTH 35TH ST
NORTH 36TH ST
NORTH 37TH ST
NORTH 38TH ST
NORTH 39TH ST
NORTH 40TH ST
NORTH 41ST ST
NORTH 42ND ST
NORTH 43RD ST
NORTH 44TH ST
NORTH 45TH ST
NORTH 46TH ST
NORTH 47TH ST
NORTH 48TH ST
NORTH 49TH ST
NORTH 50TH ST
NORTH 51ST ST
NORTH 52ND ST
NORTH 53RD ST
NORTH 54TH ST
NORTH 55TH ST
NORTH 56TH ST
NORTH 57TH ST
NORTH 58TH ST
NORTH 59TH ST
NORTH 60TH ST
NORTH 61ST ST
NORTH 62ND ST
NORTH 63RD ST
NORTH 64TH ST
NORTH 65TH ST
NORTH 66TH ST
NORTH 67TH ST
NORTH 68TH ST
NORTH 69TH ST
NORTH 70TH ST
NORTH 71ST ST
NORTH 72ND ST
NORTH 73RD ST
NORTH 74TH ST
NORTH 75TH ST
NORTH 76TH ST
NORTH 77TH ST
NORTH 78TH ST
NORTH 79TH ST
NORTH 80TH ST
NORTH 81ST ST
NORTH 82ND ST
NORTH 83RD ST
NORTH 84TH ST
NORTH 85TH ST
NORTH 86TH ST
NORTH 87TH ST
NORTH 88TH ST
NORTH 89TH ST
NORTH 90TH ST
NORTH 91ST ST
NORTH 92ND ST
NORTH 93RD ST
NORTH 94TH ST
NORTH 95TH ST
NORTH 96TH ST
NORTH 97TH ST
NORTH 98TH ST
NORTH 99TH ST
NORTH 100TH ST