

RECORDED BY NOV 19 1997

ORDINANCE NO. 270

AN ORDINANCE EXTENDING THE CORPORATE LIMITS OF THE CITY OF SLAYTON, MURRAY COUNTY, MINNESOTA, TO INCLUDE CERTAIN UNINCORPORATED UNPLATTED LAND NOT EXCEEDING 200 ACRES IN AREA ABUTTING UPON THE CITY LIMITS

WHEREAS, a certain Petition for Annexation requesting that certain territory described therein be annexed to the City of Slayton, Minnesota, has been duly presented to this City Council; and

WHEREAS, the quantity of land embraced within the area described in the petition and bounded as described consists of unplatted land not exceeding 200 acres in area, no part of which is included within the limits of an incorporated city, or borough, and all provisions of M.S. 414, Subd. 13, were complied with; and

WHEREAS, the petition was signed by all owners; and

WHEREAS, no objections have been received from the Slayton Township Board or the county board and the boundaries of the land to be annexed do not abut upon the boundaries of any municipality except the City of Slayton; and

WHEREAS, the Slayton Township Board has passed a RESOLUTION OF WAIVER OF OBJECTION TO ANNEXATION stating it had no objections to the annexation and waiving the ninety (90) day period allowed it pursuant to M.S. 414.033, Subd. 5, to submit written objections to the annexation to the Minnesota Municipal Board and the City of Slayton; and

WHEREAS, the land described in the petition abuts upon the City limits at the south boundary thereof.

The Council of the City of Slayton, Minnesota, ordains:

Section 1. The City Council hereby determines (1) that the annexation will be to the best interests of the City and of the territory affected; (2) that the territory described herein abuts upon the City limits and is urban or suburban in character; and (3) that none of said territory is now included within the limits of any city, or borough.

Section 2. Territory Annexed. The corporate limits of the City are hereby extended to include the unplatted land described as follows and the same is hereby annexed to and included within the City as effectually as if it had originally been a part thereof:

ALL THAT PART OF LOT 2 OF SUBDIVISION OF THE WEST ONE-HALF OF THE NORTHEAST QUARTER OF THE NORTHWEST QUARTER AND PART OF THE NORTHWEST QUARTER OF THE NORTHWEST QUARTER, ALL IN SECTION 22, TOWNSHIP 106 NORTH, RANGE 41 WEST, IN MURRAY COUNTY, MINNESOTA, DESCRIBED AS FOLLOWS:

COMMENCING AT THE NORTH QUARTER CORNER OF SECTION 22; THENCE NORTH 90 DEGREES 00 MINUTES WEST, ASSUMED BEARING, ALONG THE NORTH LINE OF THE NORTHWEST QUARTER OF SAID SECTION 22, A DISTANCE OF 798.50 FEET, TO THE POINT OF BEGINNING; THENCE SOUTH 00 DEGREES 00 MINUTES EAST, AT RIGHT ANGLES TO LAST DESCRIBED LINE A DISTANCE OF 248.00 FEET; THENCE NORTH 90 DEGREES 00 MINUTES WEST, AT RIGHT ANGLES TO LAST DESCRIBED LINE AND PARALLEL WITH THE NORTH LINE OF SAID NORTHWEST QUARTER, A DISTANCE OF 292.00 FEET; THENCE SOUTH 00 DEGREES 00 MINUTES EAST, AT RIGHT ANGLES TO LAST DESCRIBED LINE, A DISTANCE OF 150.00 FEET; THENCE NORTH 90 DEGREES 00 MINUTES WEST, AT RIGHT ANGLES TO LAST DESCRIBED LINE AND PARALLEL WITH THE NORTH LINE OF SAID NORTHWEST QUARTER, A DISTANCE OF 365.00 FEET; THENCE NORTH 00 DEGREES 00 MINUTES WEST, AT RIGHT ANGLES TO LAST DESCRIBED LINE, A DISTANCE OF 398.00 FEET, TO A POINT ON THE NORTH LINE OF SAID NORTHWEST QUARTER; THENCE SOUTH 90 DEGREES 00 MINUTES EAST, AT RIGHT ANGLES TO LAST DESCRIBED LINE AND ALONG THE NORTH LINE OF SAID NORTHWEST QUARTER, A DISTANCE OF 657.00 FEET, TO THE POINT OF BEGINNING.

THE TRACT CONTAINS 4.997 ACRES AND IS SUBJECT TO EXISTING ROADWAY EASEMENT AND OTHER EASEMENTS OF RECORD, IF ANY.

NOV 19 1997

Section 3. Filing. The City Clerk-Administrator is hereby directed to file copies of this ordinance with the Minnesota Municipal Board, the Minnesota Secretary of State, the Town Clerk of Slayton Township, and the Murray County Auditor/Treasurer.

Section 4. Effective Date. This ordinance takes effect upon its passage and publication and the filing of the certified copies as directed in Section 3, and the approval of the ordinance by the Minnesota Municipal Board.

Adopted by the City Council this 3rd day of November, 1997.



MAYOR

ATTEST:

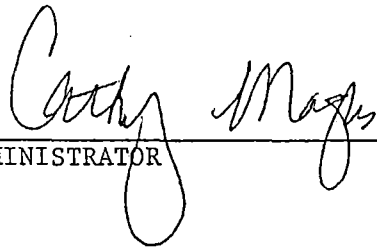

CLERK-ADMINISTRATOR

CITY OF SLAYTON

CITY OF SLAYTON (AIRPORT)

265

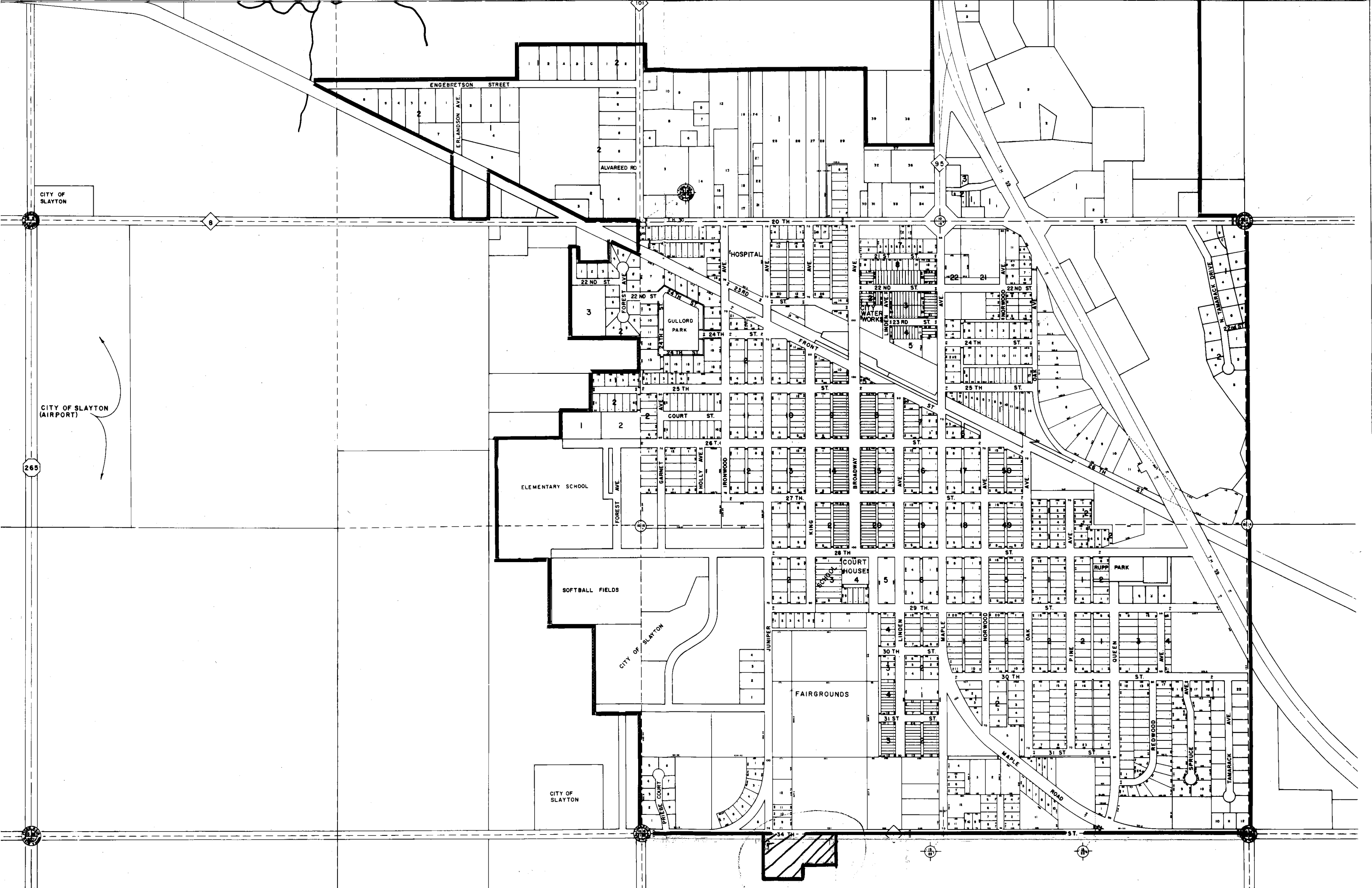

ENGBRETSON STREET

ERLANDSON AVE

ALVARED RD

HOSPITAL AVE

22 ND ST

GULLORD PARK

COURT ST

ELEMENTARY SCHOOL

SOFTBALL FIELDS

CITY OF SLAYTON

FAIRGROUNDS

CITY OF SLAYTON

FAIRGROUNDS

RUPP PARK

MAPLE ROAD

TAMARACK AVE