

PETITION FOR ANNEXATION

REC'D. BY
MME OCT 24 1997

TO THE CITY COUNCIL OF SLAYTON, MINNESOTA

We the undersigned, owners of the property located south of City of Slayton 34th Street hereby petition to be annexed into the City of Slayton City limits.

SIGNATURE

DESCRIPTION OF PROPERTY
(see attached description)

- | | |
|-------------------------------|--|
| 1. <i>Morris & Mueger</i> | |
| 2. <i>Burns & Johnson</i> | |
| 3. <i>Karen Dease</i> | |
| 4. <i>Marie Dault</i> | |
| 5. _____ | |

Examined, checked and found to be in proper form and to be signed by the required number of owners of property affected.

Cathy Mason

City Clerk/Administrator

REC'D BY OCT 24 1997
M/AB

PETITION FOR ANNEXATION

TO THE CITY COUNCIL OF SLAYTON, MINNESOTA:

We the undersigned, owners of the property located south of City of Slayton 34th street hereby petition to be annexed into City of Slayton City limits.

SIGNATURE	DESCRIPTION OF PROPERTY (see attached description)
1. <i>Steven S. Hays</i>	
2. <i>Wendy S. Lill</i>	
3. <i>William J. Fredman</i>	
4. <i>Danny Haase</i>	
5. <i>Virginia Kaska</i>	
6. _____	
7. _____	
8. _____	
9. _____	
10. _____	

Examined, checked and found to be in proper form and to be signed by the owners of property affected.

Cathy Magre
Clerk/Administrator

PETITION FOR ANNEXATION

REC'D. BY OCT 24 1997
MMP

TO THE CITY COUNCIL OF SLAYTON, MINNESOTA

We the undersigned, owners of the property located south of City of Slayton 34th Street hereby petition to be annexed into the City of Slayton City limits.

SIGNATURE	DESCRIPTION OF PROPERTY (see attached description)
1. <u><i>Lisa Christensen Burch</i></u> Lisa Christensen Burch	
2. _____	
3. _____	
4. _____	
5. _____	

Examined, checked and found to be in proper form and to be signed by the required number of owners of property affected.

Cathy Magne
City Clerk/Administrator

PETITION FOR ANNEXATION

REC'D. BY
MHP OCT 24 1997

TO THE CITY COUNCIL OF SLAYTON, MINNESOTA

We the undersigned, owners of the property located south of City of Slayton 34th Street hereby petition to be annexed into the City of Slayton City limits.

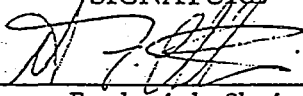
SIGNATURE	DESCRIPTION OF PROPERTY (see attached description)
1.  Thomas Frederick Christensen	
2. _____	
3. _____	
4. _____	
5. _____	

Examined, checked and found to be in proper form and to be signed by the required number of owners of property affected.

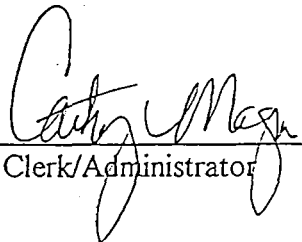

City Clerk/Administrator

REC'D. BY
MMB OCT 24 1997

ANNEXATION DESCRIPTION

ALL THAT PART OF LOT 2 OF SUBDIVISION OF THE WEST ONE-HALF OF THE NORTHEAST QUARTER OF THE NORTHWEST QUARTER AND PART OF THE NORTHWEST QUARTER OF THE NORTHWEST QUARTER, ALL IN SECTION 22, TOWNSHIP 106 NORTH, RANGE 41 WEST IN MURRAY COUNTY, MINNESOTA, DESCRIBED AS FOLLOWS:

COMMENCING AT THE NORTH QUARTER CORNER OF SECTION 22; THENCE NORTH 90 DEGREES 00 MINUTES WEST, ASSUMED BEARING, ALONG THE NORTH LINE OF THE NORTHWEST QUARTER OF SAID SECTION 22, A DISTANCE OF 798.50 FEET, TO THE POINT OF BEGINNING; THENCE SOUTH 00 DEGREES 00 MINUTES EAST, AT RIGHT ANGLES TO LAST DESCRIBED LINE A DISTANCE OF 248.00 FEET; THENCE NORTH 90 DEGREES 00 MINUTES WEST, AT RIGHT ANGLES TO LAST DESCRIBED LINE AND PARALLEL WITH THE NORTH LINE OF SAID NORTHWEST QUARTER, A DISTANCE OF 292.00 FEET; THENCE SOUTH 00 DEGREES 00 MINUTES EAST, AT RIGHT ANGLES TO LAST DESCRIBED LINE, A DISTANCE OF 150.00 FEET; THENCE NORTH 90 DEGREES 00 MINUTES WEST, AT RIGHT ANGLES TO LAST DESCRIBED LINE AND PARALLEL WITH THE NORTH LINE OF SAID NORTHWEST QUARTER, A DISTANCE OF 365.00 FEET; THENCE NORTH 00 DEGREES 00 MINUTES WEST, AT RIGHT ANGLES TO LAST DESCRIBED LINE, A DISTANCE OF 398.00 FEET, TO A POINT ON THE NORTH LINE OF SAID NORTHWEST QUARTER; THENCE SOUTH 90 DEGREES 00 MINUTES EAST, AT RIGHT ANGLES TO LAST DESCRIBED LINE AND ALONG THE NORTH LINE OF SAID NORTHWEST QUARTER, A DISTANCE OF 657.00 FEET, TO THE POINT OF BEGINNING.

THE TRACT CONTAINS 4.997 ACRES AND IS SUBJECT TO EXISTING ROADWAY EASEMENT AND OTHER EASEMENTS OF RECORD, IF ANY.

CITY OF SLAYTON

CITY OF SLAYTON (AIRPORT)

265

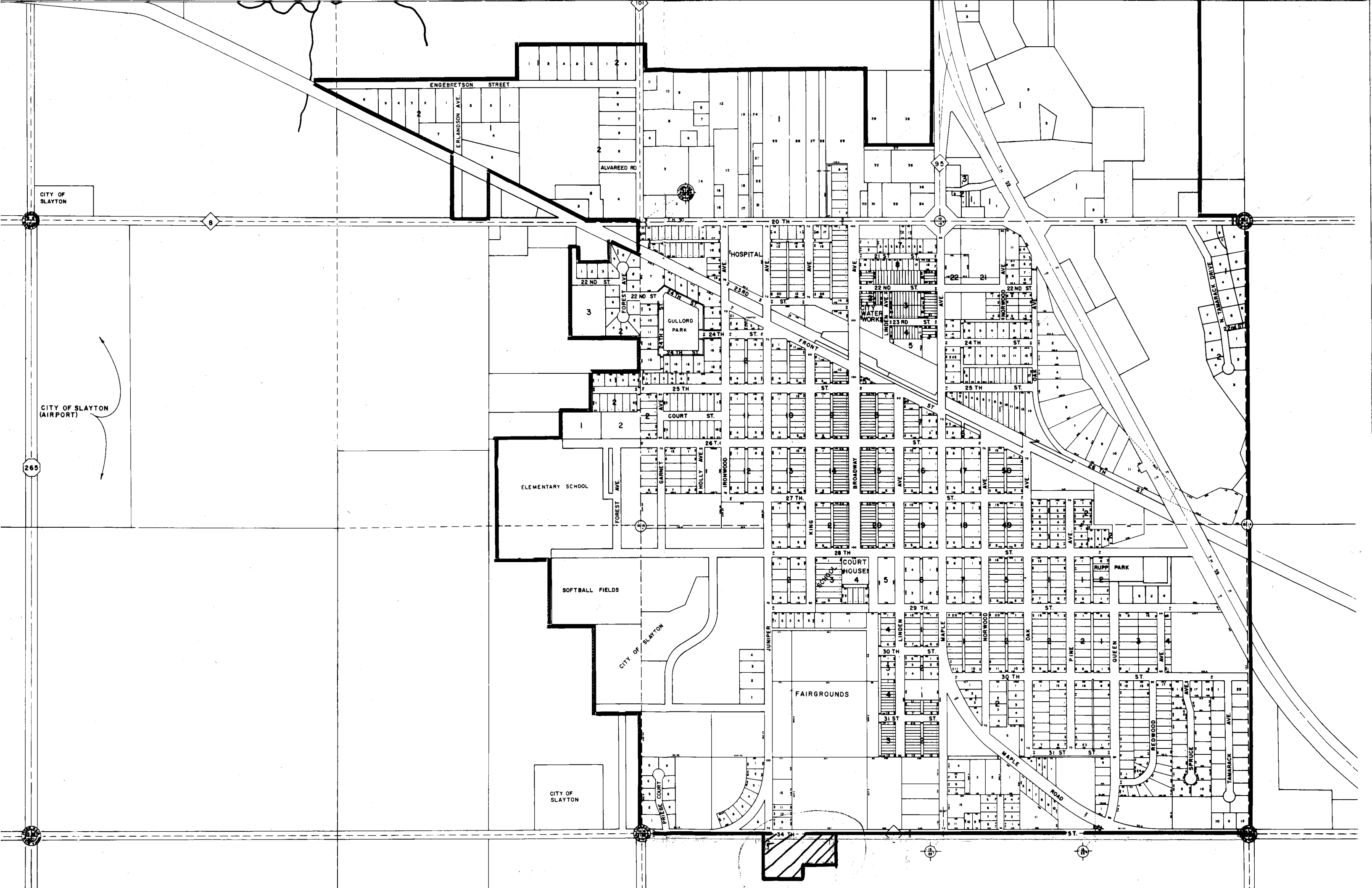

ENGBRETSON STREET

ERLANDSON AVE

ALVARED RD

HOSPITAL AVE

22 ND ST

GULLORD PARK

COURT ST

ELEMENTARY SCHOOL

SOFTBALL FIELDS

CITY OF SLAYTON

FAIRGROUNDS

CITY OF SLAYTON

FAIRGROUNDS

RUPP PARK

MAPLE ROAD

TAMARACK AVE