

ORDINANCE NO. 234

AN ORDINANCE EXTENDING THE CORPORATE LIMITS OF THE CITY OF STEWARTVILLE TO INCLUDE CERTAIN UNINCORPORATED, UNPLATTED LAND NOT EXCEEDING SIXTY (60) ACRES IN AREA ABUTTING UPON THE CITY LIMITS.

WHEREAS, a Petition requesting annexation of the territory hereinafter described was duly presented to the Council and

WHEREAS, a quantity of land embraced within the area described in the Petition and bounded as described is 23 acres more or less of unplatted land, no part of which is included within the limits of an incorporated city; and

WHEREAS, the petition was signed by the owner of the property and

WHEREAS, the land described in the Petition abuts the City limits on the east side of parcel; and

WHEREAS, the Municipality has conducted a public hearing and has given 30 days written notice by certified mail to the town or towns affected by the ordinance and to all landowners within and contiguous to the area to be annexed as required by MN Statute 414.033 Sub. 2b.

NOW THEREFORE BE IT RESOLVED THAT:

Section 1:

The Council of the City of Stewartville hereby determines:

1. That the annexation will be to the best interest of the City and of territory affected;
2. That the territory described herein abuts upon the City limits and is about to become urban or suburban in character;
3. That none of said territory is now included within the limits of any City or Borough.

Section 2:

Territory Annexed:

The corporate limits of the City are hereby extended to include the unplatted land described as follows and the same is hereby annexed to and included within the City as effectually as if it had originally been a part thereof:

That part of the northwest quarter, Section 2, Township 104, Range 14, lying westerly of the Chicago Great Western Railroad right of way and easterly of the right of way of trunk Hwy 63 described as follows:

Commencing at the southeast corner of the northwest quarter, Section 2, Township 104, Range 14, thence westerly on an assumed bearing of north 89 degrees 52 minutes west along the south line of said northwest quarter, a distance of 1166.1 feet to the point of beginning, thence on said line continued, a distance of 1458.57 feet to the easterly right of way line of trunk Hwy 63, thence northerly along said right of way line on a curve having a radius of 2814.93 feet, a distance of 380.37 feet, thence north 11 degrees 30 minutes east along said right of way, a distance of 834.50 feet, thence deflect to the left on a curve having a radius of 3324.17 feet, along said right of way, a distance of 589.52 feet, thence south 87 degrees 26 minutes west along said right of way, a distance of 9.70 feet, thence northerly along said right of way, a distance of 117.23 feet, thence north 89 degrees 34 minutes east a distance of 398.55 feet to the westerly right of way of the Chicago Great Western Railroad; thence south 06 degrees 52 minutes west along said railroad right of way a distance of 92.53 feet, thence deflect to the left on a curve having a radius of 1690.24 feet along said railroad right of way, a distance of 1442.56 feet, thence south 42 degrees 02 minutes east along said railroad right of way, a distance of 94.97 feet thence deflect to the right on a curve having a radius of 3069.33 feet along said railroad right of way a distance of 514.26 feet to the point of beginning, all in Olmsted County, Minnesota, excepting therefrom the following Parcels A, B, C & D.

PARCEL A

Commencing at the southeast corner of Lot 10, Block 2, Brin's plat, Village of Stewartville, Olmsted County, Minnesota, thence westerly along the south line of Lots 9 and 10 of Block 2 of said plat for a distance of 371.88 feet to the easterly right of way line of trunk Hwy 63, thence southerly along said right of way for a distance 105.13 feet, thence easterly and parallel with the south line of said lots 9 & 10 for a distance of 367.47 feet to the westerly right of way of the Chicago Great Western Railroad, thence northerly along said right of way for a distance of 105.44 feet to the point of beginning, Section 2, Township 104, Range 14.

PARCEL B

That part of the northwest quarter of the northwest quarter of Section 2, Township 104, Range 14, Olmsted County, Minnesota, described as follows: Commencing at the northwest corner of said northwest quarter, thence southerly on an assumed azimuth from north 177 degrees 58 minutes 51 seconds along the west line of said northwest quarter 1170.46 feet; thence easterly 89 degrees 50 minutes 28 seconds azimuth 375.26 feet to the easterly right of way line of trunk Hwy 63 and the point of beginning; thence continuing easterly 89 degrees 50 minutes 28 seconds azimuth 373.32 feet to the westerly right of way line of the former Chicago and Great Western Railroad; thence northerly along said westerly right of way line 300.98 feet on a nontangential curve concave to the east having a radius of 1482.40 feet, a central angle of 11 degrees 37 minutes 59 seconds and a chord azimuth of 359 degrees 56 minutes 04 seconds to the intersection with a line 204.67 feet south of and parallel with the south line of Brin's Plat; thence westerly 270 degrees 00 minutes 00 seconds azimuth along said line 339.71 feet to the easterly right of way line of trunk Hwy 63; thence southerly along said easterly right of way line 303.43 feet on a nontangential curve concave to the west, having a radius of 3346.12 feet, a central angle of 05 degrees 11 minutes 44 seconds and a chord azimuth of 186 degrees 17 minutes 44 seconds to the point of beginning. Said tract contains 2.41 acres more or less.

PARCEL C

That part of the northwest quarter of Section 2, Township 104, Range 14, Olmsted County, Minnesota described as follows: Commencing at the southwest corner of said northwest quarter of Section 2;; thence north 90 degrees 00 minutes 00 seconds east (for the purposes of this description bearings are assumed), along the south line of said northwest quarter, 66.62 feet to the easterly right of way line of trunk Hwy 63 for a point of beginning of the tract to be described; thence continuing along said south line of northwest quarter, north 90 degrees 00 minutes 00 seconds east 386.50 feet; thence north 0 degrees 00 minutes 00 seconds a distance of 490.35 feet; thence south 90 degrees 00 minutes 00 seconds west, 311.55 feet to a point on the easterly right of way of trunk Hwy 63; thence south 11 degrees 35 minutes 16 seconds west along said right of way line, 122.20 feet; thence southwesterly along a tangential curve concave easterly (curve data: radius = 2790.03 feet, delta angle = 7 degrees 41 minutes 14 seconds, a chord bearing and distance of south 7 degrees 44 minutes 38 seconds west, 374.05 feet), and arc distance of 374.34 feet to the point of beginning; said tract containing 4.00 acres more or less; subject to easements of record.

PARCEL D

That part of the northwest quarter of Section 2, Township 104, Range 14, Olmsted County, Minnesota, described as follows: Commencing at the southwest corner of said northwest quarter of section 2; thence north 90 degrees 00 minutes 00 seconds east (for the purposes of this description bearings are assumed), along the south line of said northwest quarter, 66.62 feet to the easterly right of way line of trunk Hwy 63, thence continuing along said south line of northwest quarter, north 90 degrees 00 minutes 00 seconds east 386.50 feet to the point of beginning of the tract to be described; thence north 00 degrees 00 minutes 00 seconds a distance of 490.35 feet, thence east 350 feet on a line parallel to the south line of the northwest quarter of the northwest quarter of Section 2, thence south 00 degrees 00 minutes 00 seconds to the

REC'D. BY SEP 16 1997
MMB

south line of the northwest quarter of the northwest quarter of Section 2, thence on the south line of the northwest quarter of the northwest quarter to the point of beginning.

AND

In Township One Hundred Four (104) North, Range Fourteen (14) West of the Fifth Principal Meridian, Olmsted County.

A strip of land 100 feet in width extending over and across part of the northwest quarter (NW 1/4) of Section Two (2), said strip of land being 50 feet in width on each side of the center line of the main tract (now removed) of the Winona and Southwestern Railway Company (later the Wisconsin Minnesota and Pacific Railway Company, the Chicago Great Western Railway Company, now the Chicago and North Western Transportation Company), as said main tract center line was originally located and established over and across said section and lying southerly of a line described as commencing at the northwest corner of the Northwest Quarter of the Northwest Quarter (NW 1/4 NW 1/4) of Section 2; thence southerly on an assumed azimuth from north of 177 degrees 58 minutes 41 seconds along the west line of said northwest quarter 1170.46 feet; thence easterly 89 degrees 50 minutes 28 seconds azimuth 375.26 feet to the easterly right of way line of trunk Hwy 63 and the point of beginning of the line described: thence continuing easterly 89 degrees 50 minutes 28 seconds azimuth 473 feet, more or less, to the easterly right of way line of said former Chicago and Northwestern Railroad and there terminating.



CITY OF STEWARTVILLE, MINNESOTA

REC'D. BY
MAB

SEP 16 1997

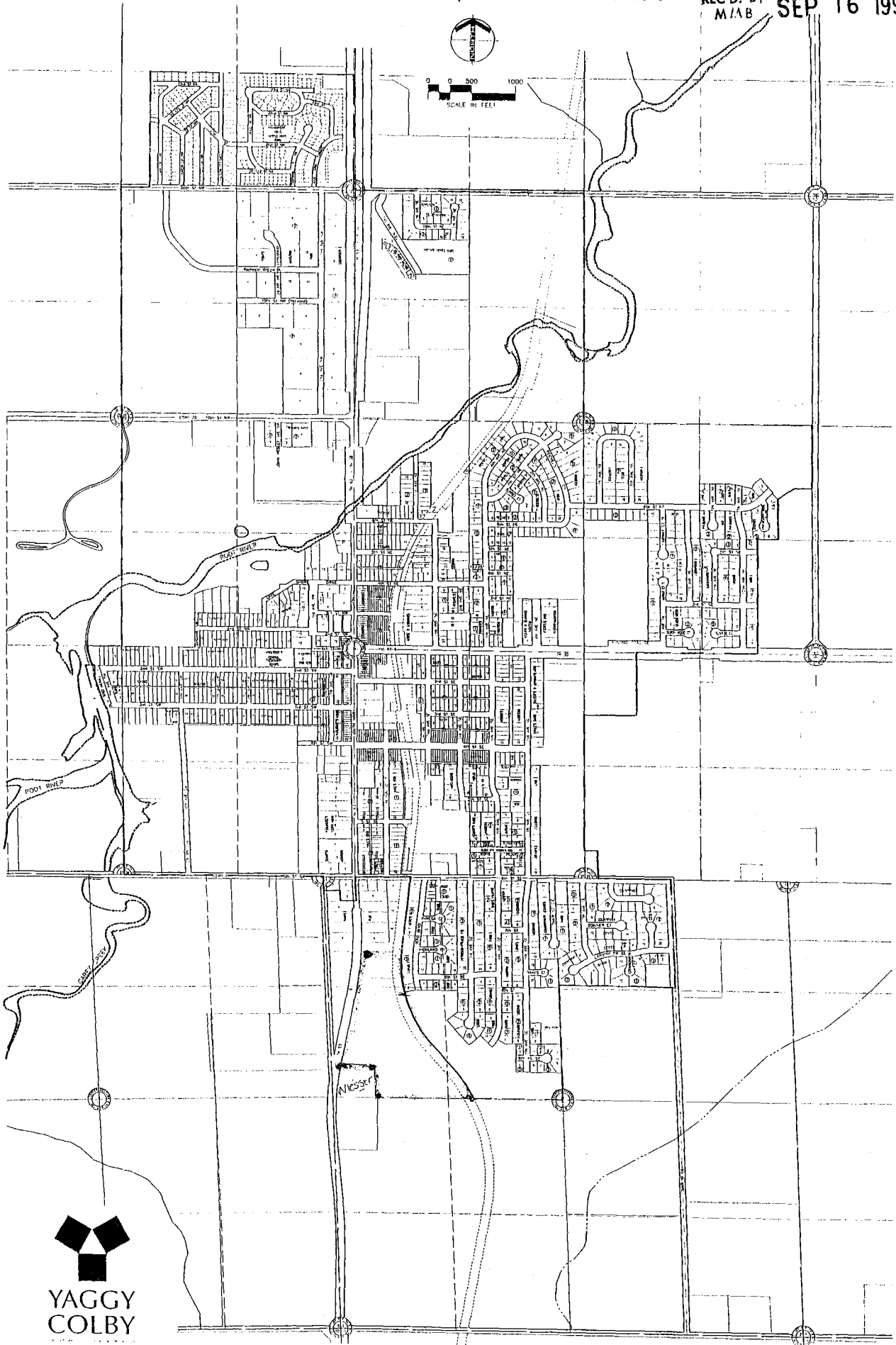
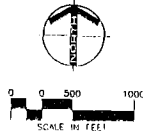

BUCKNELL PROPERTY

REC'D. BY
MMB AUG 11 1998

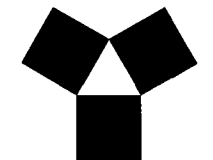
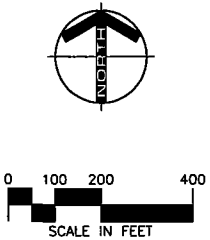
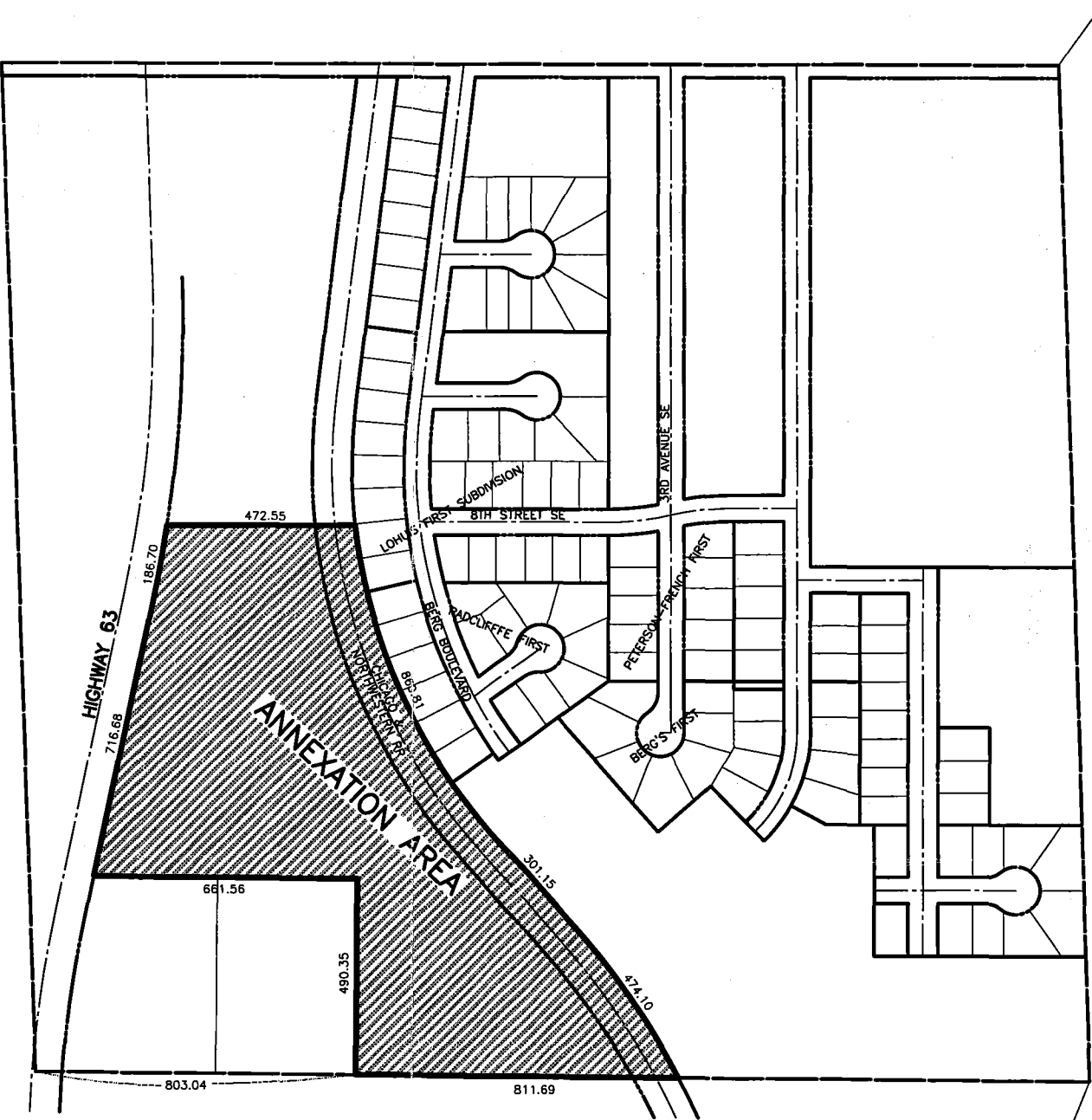

**YAGGY
COLBY**
ASSOCIATES

ENGINEERS • ARCHITECTS
SURVEYORS • PLANNERS
LANDSCAPE ARCHITECTS

717 3RD AVENUE SOUTHEAST
ROCHESTER, MINNESOTA 55904
507-288-6464
FAX 507-288-5058

BUCKNELL PROPERTY
STEWARTVILLE, MINNESOTA
ANNEXATION AREA

PROJECT NUMBER	6191
COMPUTER FILE	6191ANNX
DATE	07-15-98
DRAWN BY	WCD
CHECKED BY	
REVISIONS	

SHEET NUMBER
1
OF ONE SHEETS