

REC'D. BY  
M M R APR 30 1997

**ORDINANCE NO. 337**

**AN ORDINANCE EXTENDING THE CORPORATE LIMITS  
OF THE CITY OF CAMBRIDGE**

**AN ORDINANCE** extending the corporate limits of the City of Cambridge to include certain unincorporated territory abutting upon the limits of the city and consisting of 60 acres or less for which a Petition for Annexation has been received from all property owners of the land.

**WHEREAS**, the territory described below is not presently within the corporate limits of any incorporated city; and

**WHEREAS**, this territory abuts upon the corporate limits of the city along the north and east line of the property and is deemed to be urban or suburban in character or about to become so; and

**WHEREAS**, said lands are unplatted and are not presently served by public sewer facilities and public sewer facilities are not otherwise available; and

**WHEREAS**, this territory consists entirely of an area totaling 60 acres or less; and

**WHEREAS**, the municipality has received a valid Petition for Annexation from all the property owners of said land; and

**WHEREAS**, the population of said area to be annexed is 0;

The City Council of Cambridge ordains:

**SECTION 1. TERRITORY ANNEXED**

The corporate limits of the City of Cambridge are hereby extended to include the unplatted territory described as follows, which territory abuts the municipality, consists of 60 acres or less, and for which the municipality has received a valid Petition for Annexation from all the owners of said land:

That part of the Northeast Quarter of the Northwest Quarter, Section 8, Township 35, Range 23, Isanti County, Minnesota described as follows:

Commencing at a point on the south line of said Northeast Quarter of the Northwest Quarter, that is 18 feet east from the southwest corner of said Northeast Quarter of the Northwest Quarter; thence easterly along said south line a distance of 184.06 feet, more or less, to a point that is 184.00 feet easterly of said point of commencement, as measured along a line perpendicular to the west line of said Northeast Quarter of the Northwest Quarter and to the point of beginning of the property to be described; thence northerly parallel with the west line of said Northeast Quarter of the Northwest

Quarter to the south line of the plat of WOODLAND PARK, Isanti County, Minnesota; thence easterly along said south line of WOODLAND PARK a distance of 520.88 feet, more or less, to a point that is 722.92 feet easterly of the southwest corner of said plat of WOODLAND PARK, as measured along said south line; thence southerly, parallel with the east line of said Northeast Quarter of the Northwest Quarter a distance of 330 feet; thence westerly, at right angles to last described course, a distance of 145 feet; thence southwesterly to said point of beginning.

The above-described parcel consists of approximately five (5) acres.

**SECTION 2. FILING**

The City Clerk-Administrator is directed to file certified copies of this Ordinance with the Secretary of State, the County Auditor of Isanti County, the Town Clerk of Isanti Township and the Minnesota Municipal Board.

**SECTION 3. EFFECTIVE DATE OF ANNEXATION**

This Ordinance takes effect upon its passage and publication and the filing of certified copies as directed in Section 2 and final approval by the Minnesota Municipal Board.

Adopted by the City of Cambridge, Minnesota,  
this 21st day of April, 1997.

CITY OF CAMBRIDGE

By: \_\_\_\_\_

Its: \_\_\_\_\_

ATTEST:

By: \_\_\_\_\_

Its: \_\_\_\_\_

PUBLISHED IN \_\_\_\_\_ ON \_\_\_\_\_, 19\_\_\_\_.

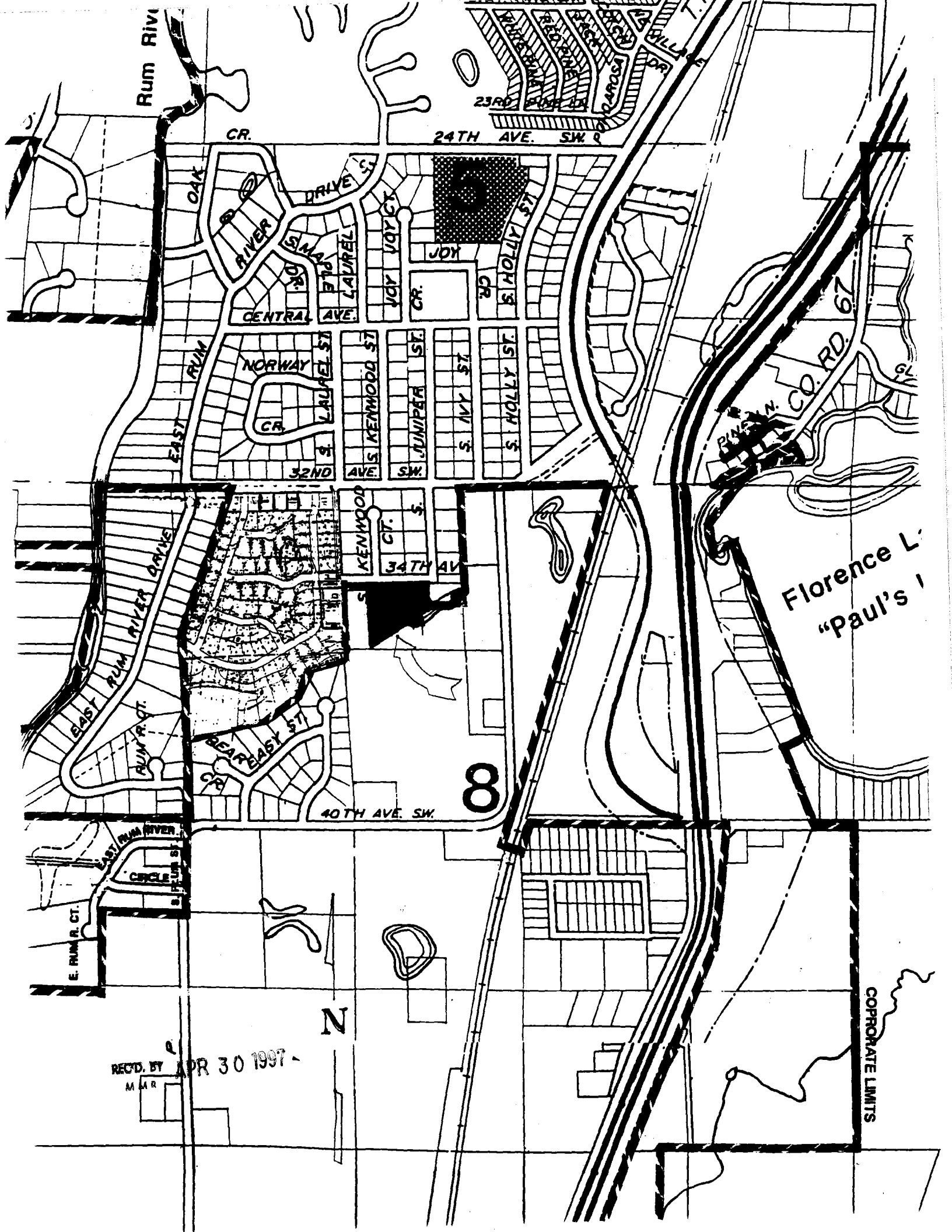

Rum River

CR.

24TH AVE. SW. R

OAK RIVER

DRIVE S.

JOY

CENTRAL AVE.

JOY CR.

S. HOLLY ST.

EAST RUM RIVER

NORWAY CR.

S. LAUREL ST.

S. KENWOOD ST.

S. JUNIPER ST.

S. IVY ST.

S. HOLLY ST.

32ND AVE.

S. KENWOOD ST.

S. JUNIPER ST.

S. IVY ST.

S. HOLLY ST.

34TH AVE.

Florence L. "Paul's"

PINE W. CO. RD. 67

EAST RUM RIVER DRIVE

RUM RIVER

BEAR CR.

40TH AVE. SW.

8

E. RUM R. CT.

EAST RUM RIVER CIRCLE

N

REC'D. BY APR 30 1997

M M R

CORPORATE LIMITS