

AN ORDINANCE ANNEXING PROPERTY ALONG WEST WINONA DRIVE
TO THE CORPORATE LIMITS OF THE CITY OF ALEXANDRIA

WHEREAS, the property owners located within the area described below petitioned the Alexandria City Council to annex this territory to the City of Alexandria, pursuant to Minnesota Statutes, Section 414.033, Subdivision 5, and

WHEREAS, the petitioners are all of the property owners within the territory, and

WHEREAS, the territory currently abuts upon the western boundary of the City Limits and none of the territory is presently a part of any incorporated city, and

WHEREAS, the territory is platted land containing 10.42 Acres in 1 parcel, and

WHEREAS, the Alexandria City Council finds the territory is urban in character, and

WHEREAS, the City of Alexandria has given 30 days notice to the affected property owners that the cost of electric utility service will not change as a result of the annexation.

NOW, THEREFORE, THE CITY COUNCIL OF THE CITY OF ALEXANDRIA HEREBY ORDAINS:

SECTION I. That the Corporate Limits of the City of Alexandria are hereby extended to include land as described and the same is hereby annexed and included within the City.

SECTION II. That the territory to be annexed is described as:

That part of the SE $\frac{1}{4}$ NE $\frac{1}{4}$ of Section 26, Township 128 North, Range 38 West, Douglas County, Minnesota, described as follows:

Beginning at the east quarter corner of said Section 26;

Thence South 89 degrees 50 minutes 26 seconds West, assumed bearing, along the south line of said SE $\frac{1}{4}$ NE $\frac{1}{4}$ 504.30 feet, said south line also being the centerline of a public roadway;

Thence North, parallel with the east line of said Section 26, a distance of 900.00 feet;

Thence North 89 degrees 50 minutes 26 seconds East 504.30 feet to the east line of said section;

Thence South, along said east line, 900.00 feet to the point of beginning.

The tract contains 10.42 acres more or less

SECTION III. The City Clerk is directed to file copies of this ordinance with the Minnesota Municipal Board, the Douglas County Auditor, and the LaGrande Township Board.

SECTION IV. This ordinance shall be in full force and effect from and after its passage, publication, and approval by the Minnesota Municipal Board.

ADOPTED by the City Council of the City of Alexandria, Minnesota this 9TH day of JUNE, 1997, by the following vote:

YES: HERMES, HELDT, WEISEL, BENSON, OSTERBERG

NO: NONE

ABSENT: NONE

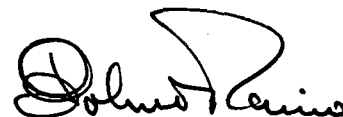
John O. Perino, Mayor

ATTEST: 
James P. Taddei, City Administrator

REC'D. BY APR 28 1997
M.A.B.

copy

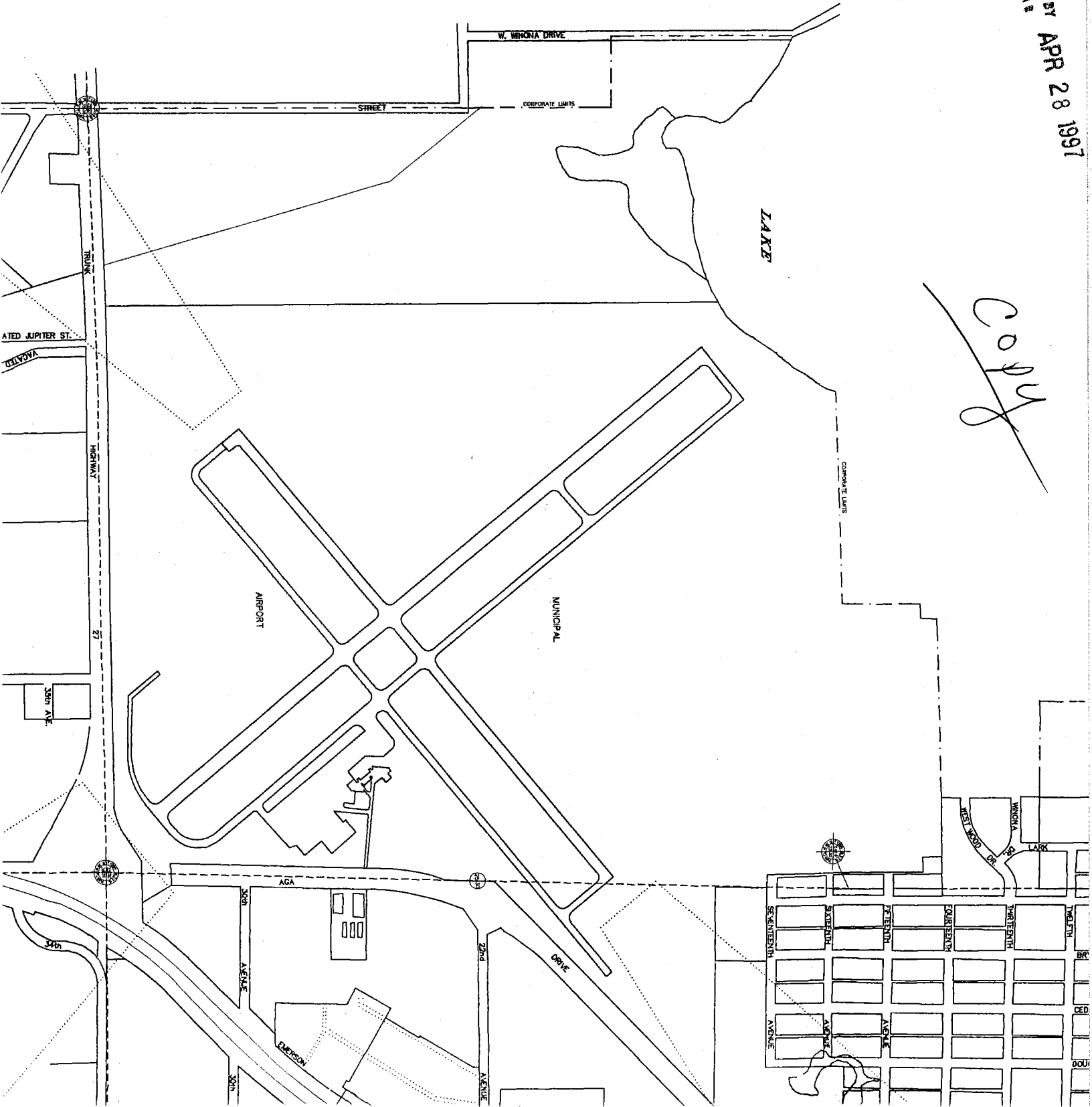

RECD BY APR 28 1997
H.M.M.

ROAD
TOWNSHIP WEST WINONA

2960-510

403.03'

2960-500
27-1710-000
N45°00'E

1200.0'

27-72-000

Subject
← SITE

NORHEASTERLY

4000'

27-723-000

East 1/4 Cor.
H.T.M.

450.0'

LANE

504.30'

NEVADA ST.

RODNEY F. ELDEVIK
COUNTY SURVEYOR
DOUGLAS COUNTY MINNESOTA

SCALE 1" = 200'