

**PETITION FOR ANNEXATION**

IN THE MATTER OF THE PETITION FOR ANNEXATION OF  
UNINCORPORATED ADJOINING PROPERTY LOCATED ALONG WEST WINONA ROAD  
TO THE CITY OF ALEXANDRIA, MINNESOTA.

**TO THE CITY OF ALEXANDRIA AND THE MINNESOTA MUNICIPAL  
BOARD:**

WE, THE UNDERSIGNED, the owners of the property described below, hereby petition the Alexandria City Council to annex this territory to the City of Alexandria, Minnesota and for that purpose respectfully state:

1. The petitioners are the owners of the subject property.
2. Pursuant to Minn. Stat. Section 414.022, Subdivision 5, the petition is signed by all the property owners within the affected area.
3. The property currently abuts upon the westerly boundaries of the Alexandria City Limits along the northerly and easterly boundary of the subject property and is not presently a part of any incorporated city.
4. This property consists of unplatted land in LaGrande Township, Douglas County, containing approximately 10.42 acres in 1 parcel owned by the property owners which is described as:

That part of the SE $\frac{1}{4}$ NE $\frac{1}{4}$  of Section 26, Township 128 North, Range 38 West, Douglas County, Minnesota, described as follows:

Beginning at the east quarter corner of said Section 26;

Thence South 89 degrees 50 minutes 26 seconds West, assumed bearing, along the south line of said SE $\frac{1}{4}$ NE $\frac{1}{4}$  504.30 feet, said south line also being the centerline of a public roadway;

Thence North, parallel with the east line of said Section 26, a distance of 900.00 feet;

Thence North 89 degrees 50 minutes 26 seconds East 504.30 feet to the east line of said section;

Thence South, along said east line, 900.00 feet to the point of beginning.

The tract contains 10.42 acres more or less

5. The petitioners state that this land has become suburban in character by usage.

6. The parties affected and which may be entitled to notice are the Township of LaGrande and Douglas County.
7. The reason for requesting annexation is for the affected property to be served with municipal water services.

Dated at Alexandria, Minnesota, this 11<sup>th</sup> day of April, 1997.

<u>PROPERTY OWNERS</u>	<u>P I N</u>	<u>SIGNATURE</u>	<u>DATE</u>
Tom Hayes	03-1721-000	<u>Tom Hayes</u>	<u>4/11/97</u>
Jayne Hayes	03-1721-000	<u>Jayne Hayes</u>	<u>4-11-97</u>

RECD. BY APR 28 1997  
M.A.B.

*copy*

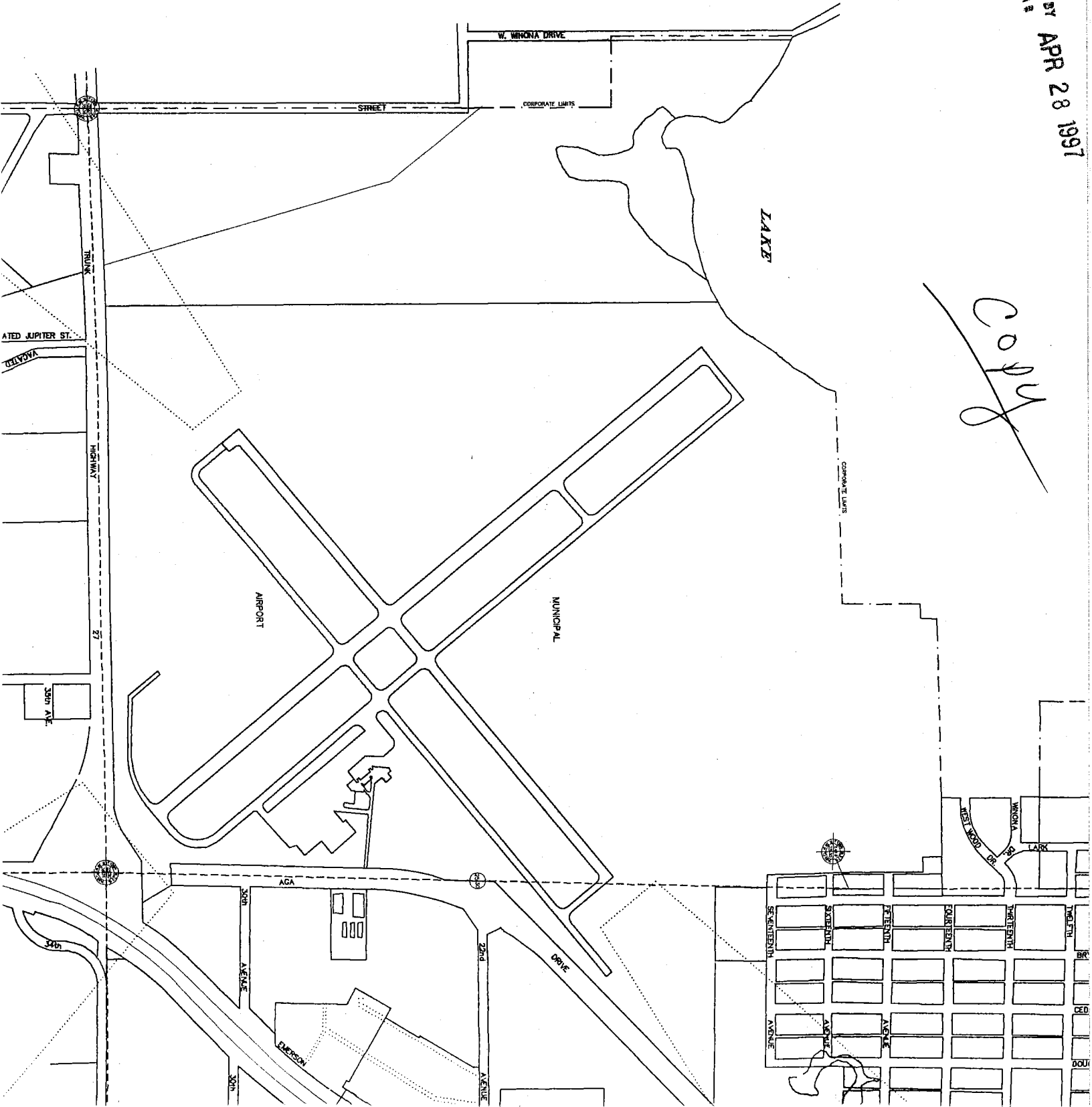

RECD BY APR 28 1997  
H.M.M.

ROAD  
TOWNSHIP WEST WINONA

2960-510

403.03'

2960-500

27-1710-000

N45°00'E

↓

↓

↓

↓

1200.0'

27-72-000

27-1720-000

Subject  
← SITE

NORHEASTERLY

4000'

27-723-000

East 1/4 Cor.  
H.T.M.

450.0'

LANE 504.30'

NEVADA ST.

RODNEY F. ELDEVIK  
COUNTY SURVEYOR  
DOUGLAS COUNTY MINNESOTA

SCALE 1" = 200'